

1/4" = 1'-0"
GRAPHIC SCALE IN FEET

M11.6 PARTIAL FLOOR PLAN - NEW CONDITIONS - ER - FIRE PROTECTION

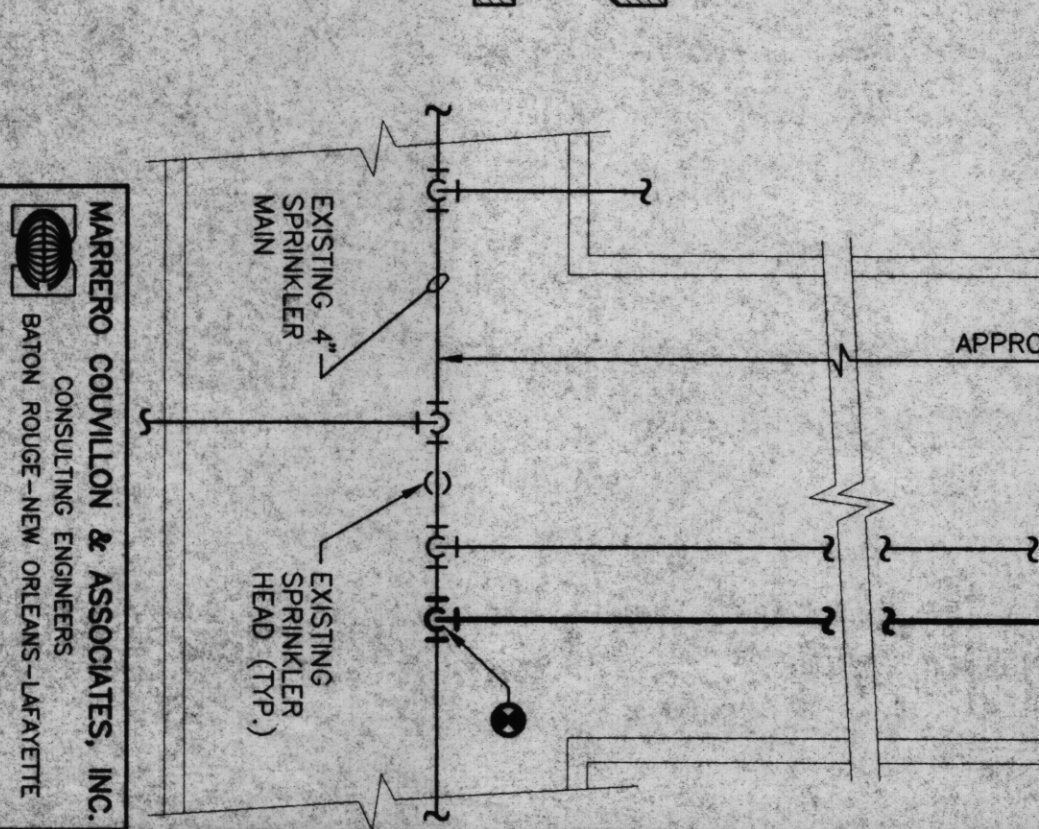

- GENERAL NOTES:**
1. DRAWINGS ARE NOT INTENDED TO BE SCALED. ALL LOCATIONS SHOWN ARE APPROXIMATE.
 2. LOCATIONS OF ALL EQUIPMENT SHALL BE DETERMINED BY THE CONTRACTOR. THE CONTRACTOR SHALL VERIFY THE LOCATION AND SIZE OF ALL EQUIPMENT. THE CONTRACTOR SHALL VERIFY THE LOCATION AND SIZE OF ALL EQUIPMENT. THE CONTRACTOR SHALL VERIFY THE LOCATION AND SIZE OF ALL EQUIPMENT.
 3. CONTRACTOR SHALL HAVE ADEQUATE SUPERVISION, MANPOWER AND MATERIALS AVAILABLE TO MAINTAIN THE LENGTH OF EACH SERVICE INTERRUPTION.
 4. CONTRACTOR SHALL HAVE ADEQUATE SUPERVISION, MANPOWER AND MATERIALS AVAILABLE TO MAINTAIN THE LENGTH OF EACH SERVICE INTERRUPTION.
 5. CONTRACTOR SHALL VERIFY THE LOCATION AND SIZE OF ALL EQUIPMENT. THE CONTRACTOR SHALL VERIFY THE LOCATION AND SIZE OF ALL EQUIPMENT.
 6. CONTRACTOR SHALL VERIFY THE LOCATION AND SIZE OF ALL EQUIPMENT. THE CONTRACTOR SHALL VERIFY THE LOCATION AND SIZE OF ALL EQUIPMENT.
 7. CONTRACTOR SHALL VERIFY THE LOCATION AND SIZE OF ALL EQUIPMENT. THE CONTRACTOR SHALL VERIFY THE LOCATION AND SIZE OF ALL EQUIPMENT.
 8. FOR LEGEND AND ABBREVIATIONS SEE DRAWING M11.5

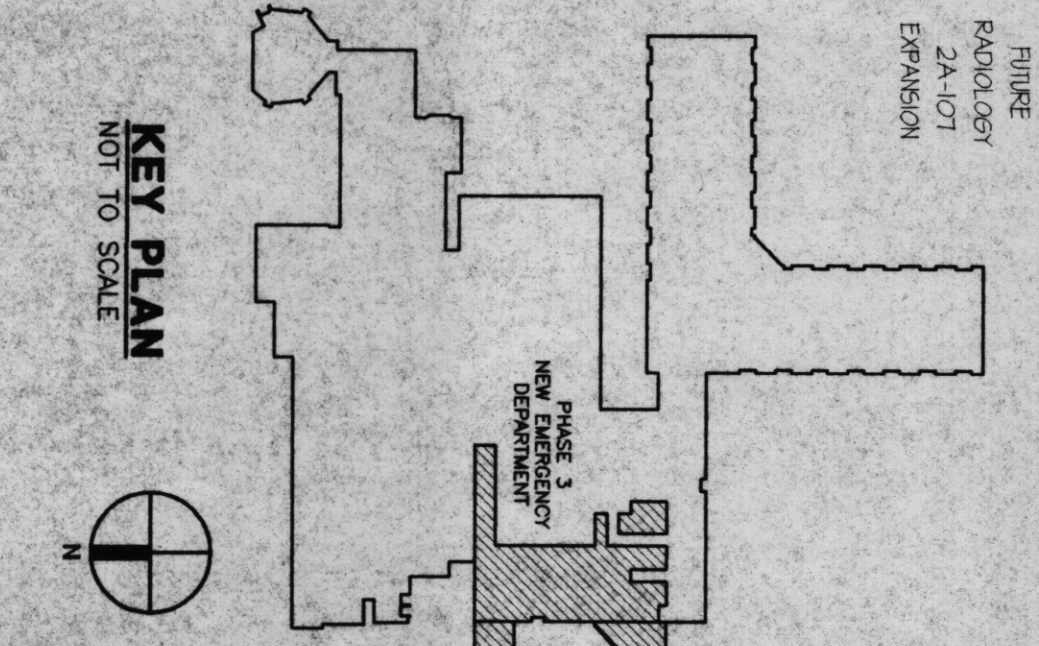

<p>ISSUE DATES</p> <table border="1"> <tr> <th>DATE</th> <th>REVISION</th> </tr> <tr> <td>11/21/12</td> <td>ISSUE FOR PERMIT</td> </tr> <tr> <td>02/27/13</td> <td>ISSUE FOR CONSTRUCTION</td> </tr> </table>	DATE	REVISION	11/21/12	ISSUE FOR PERMIT	02/27/13	ISSUE FOR CONSTRUCTION	<p>REVISIONS</p> <table border="1"> <tr> <th>DATE</th> <th>BY</th> <th>DESCRIPTION</th> </tr> <tr> <td></td> <td></td> <td></td> </tr> </table>	DATE	BY	DESCRIPTION				<p>PROGRESS PRINT NOT FOR CONSTRUCTION</p>	<p>PARTIAL RELEASE ONLY TO ENTER WORK AREAS. ALL OTHERS ARE TO REMAIN CLOSED.</p>	<p>FULL RELEASE THE DRAWING IS FULLY RELEASED BY THE ARCHITECT TO THE CONTRACTOR FOR CONSTRUCTION.</p>	<p>DATE: NOVEMBER 21, 2014</p> <p>ALL RIGHTS RESERVED. NO PART OF THIS DRAWING IS TO BE REPRODUCED OR TRANSMITTED IN ANY FORM OR BY ANY MEANS, ELECTRONIC OR MECHANICAL, INCLUDING PHOTOCOPYING, RECORDING, OR BY ANY INFORMATION STORAGE AND RETRIEVAL SYSTEM.</p> <p>CONTRACT # 10417 JOHN T. CAMPO & ASSOCIATES, INC. 1000 POND STREET NEW ORLEANS, LA 70112</p> <p>JOB NUMBER: 8257-104 DRAWN BY: JLM CHECKED BY: MWM</p>	<p>JOHN T. CAMPO & ASSOCIATES, INC. ARCHITECTS • PLANNERS THE LYONS CENTER, SUITE 2011 300 PONDRAVIA STREET NEW ORLEANS, LA 70112 (504) 588-6912</p>	<p>LIFESAFETY PHASE 1C LAB/ER RENOVATIONS SLIDELL MEMORIAL HOSPITAL 1001 GAUSE BLVD., SLIDELL, LA</p>
	DATE	REVISION																	
11/21/12	ISSUE FOR PERMIT																		
02/27/13	ISSUE FOR CONSTRUCTION																		
DATE	BY	DESCRIPTION																	
<p>SHEET M11.6 OF SHEETS</p>																			