

MATERIAL: ASPHALT SYSTEMS

ACCEPTABLE SYSTEMS: MODIFIED BITUMEN

ISSUE / REVISION DATE:

(800) 428-4511 www.holcimelevate.com

MAXIMUM WARRANTY: 20 YEARS

11/07/2022

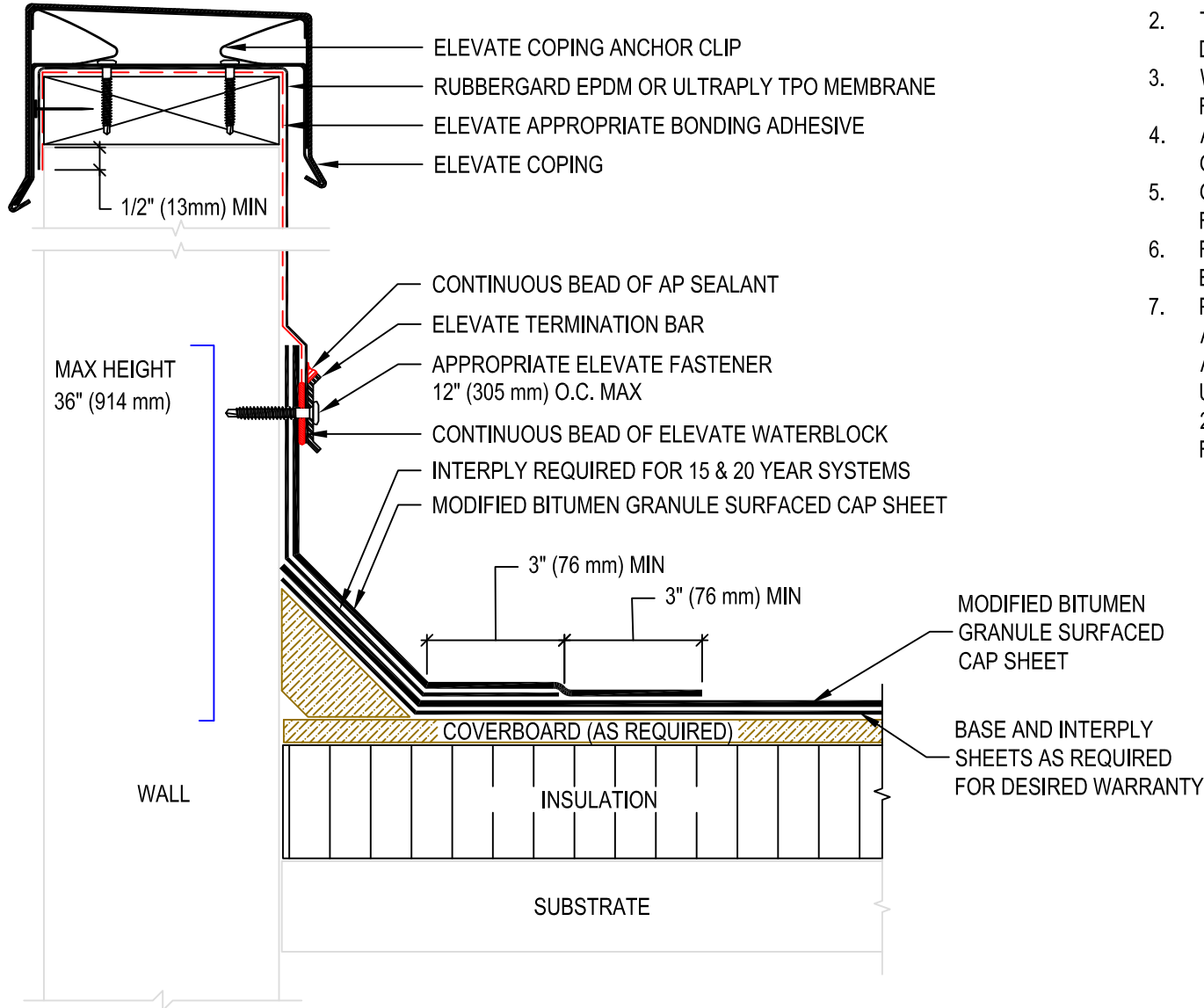

NOTES:

1. REFER TO HOLCIM ELEVATE WEBSITE FOR MOST CURRENT INFORMATION.
2. THIS DETAIL SHOULD BE USED ONLY WHERE THE DECK IS SUPPORTED BY THE OUTSIDE WALL.
3. WOOD NAILERS MUST BE INSTALLED WITH SUITABLE FASTENERS TO MEET APPLICABLE BUILDING CODES.
4. ALL SHEET METAL IS TO BE INSTALLED PER SMACNA GUIDELINES.
5. GRANULES MUST BE EMBEDDED WHEN THERMALLY FUSING GRANULE SURFACED CAP SHEET.
6. FLASHING LAPS MUST BE OFFSET FROM FIELD LAPS BY A MINIMUM OF 12" (305 mm).
7. PARAPETS WITH NAILABLE SUBSTRATES MUST HAVE A ELEVATE BASE SHEET MECHANICALLY ATTACHED IN ACCORDANCE WITH THE FOLLOWING SPACING:

UP TO 24" (305-610 mm)	9" (152 mm) ON CENTERS
24-36" (610-914 mm)	6" (228 mm) ON CENTERS
FIELD OF WALL	ONE PER FT ² (929 cm ²)