

**K BUILDING SECTION**  
SCALE: 1/8" = 1'-0"

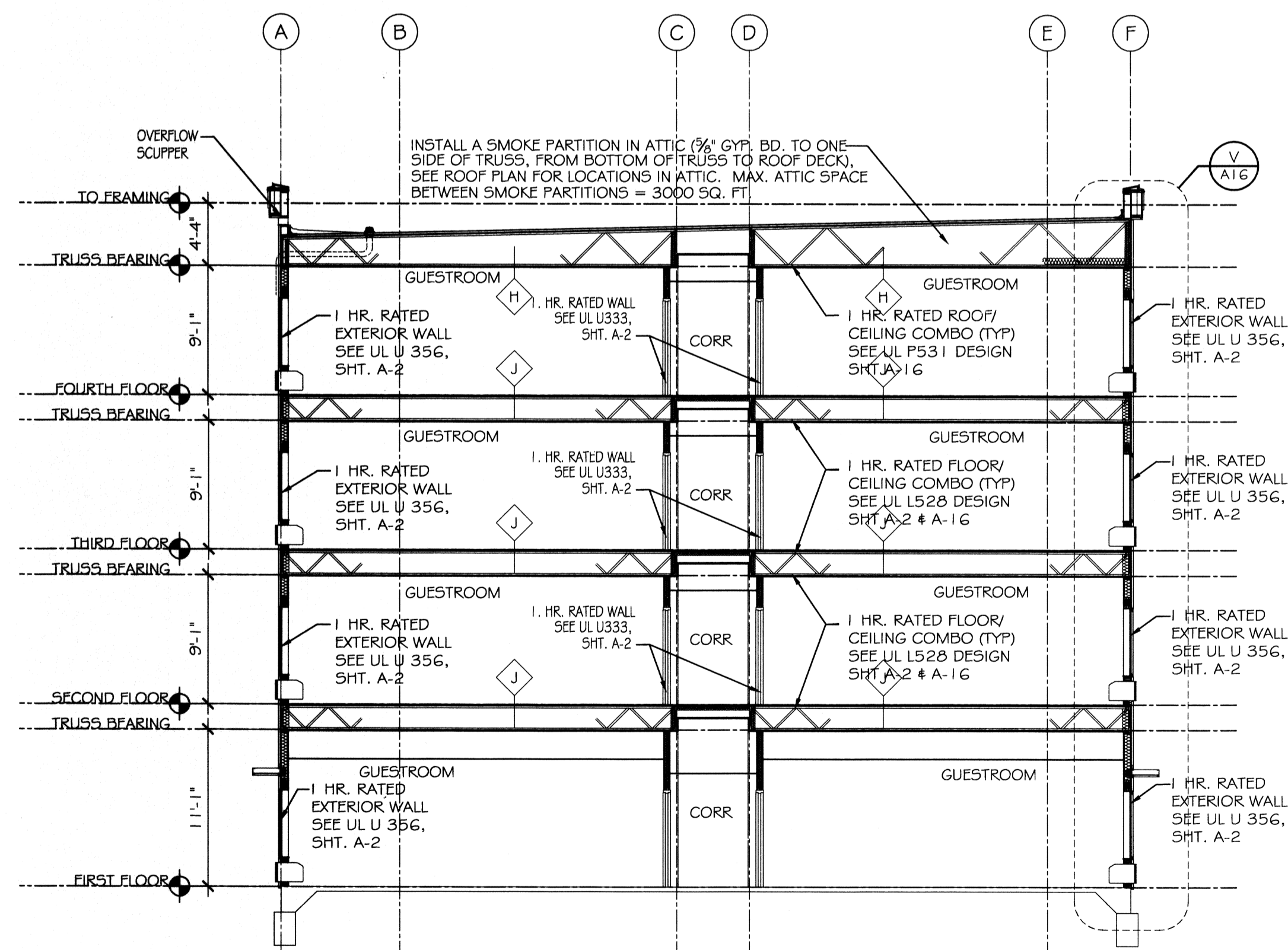

**J BUILDING SECTION (GUESTROOM)**  
SCALE: 1/8" = 1'-0"

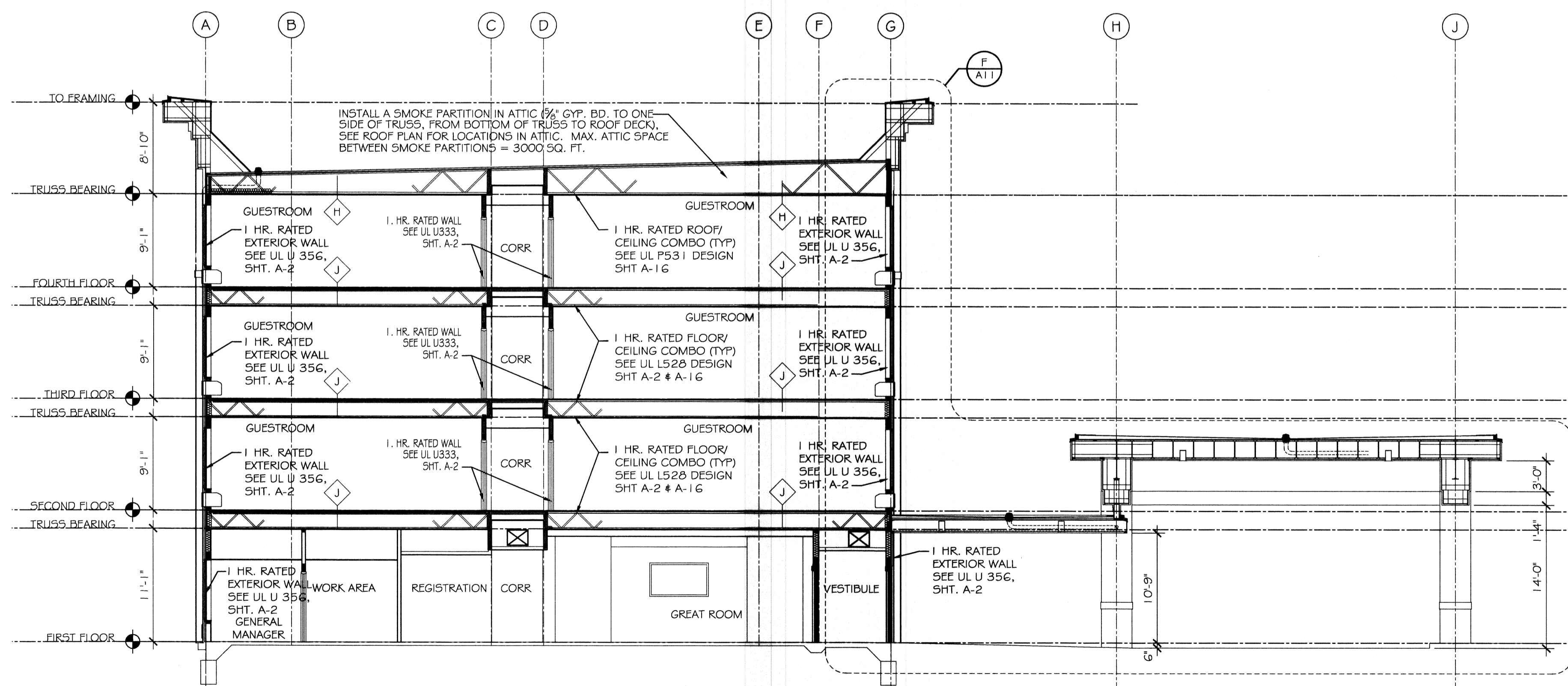

**H BUILDING SECTION @ LOBBY/ENTRY**  
SCALE: 1/8" = 1'-0"

**NOTE:**  
PRE FABRICATED ROOF,  
FLOOR, WALLS, BEAMS,  
AND COLUMNS PROVIDED  
BY OTHERS.

SEE SHEET A-2 FOR ALL WALL, FLOOR/ CEILING  
AND ROOF/ CEILING ASSEMBLY RATINGS AS  
REQUIRED BY LOCAL CODE AND  
ORDINANCES FOR BUILDING TYPE AND  
RATING SELECTED.

LAQUINTA INNS & SUITES

507 CONSTITUTION DRIVE  
WEST MONROE, LOUISIANA 71292

JOB No: 2196 DATE: 02-03-2014  
DRAWN BY: JTL CHECKED BY: CKD

#	DESCRIPTION	DATE



**BUILDING SECTIONS**

SHEET No: 20 OF 53

**A12**

**DAMMON**  
ENGINEERING, INC.  
Architects & Engineers

dammonengineering.com  
dammoneng@bellsouth.net  
PHONE: 985-649-5632  
FAX: 985-641-9950  
CHIEF ENGINEER: BRIAN MISTICH, P.E.  
CHIEF ARCHITECT: KEVIN KINCHEM  
554 OLD SPANISH TRAIL  
SUITE 100  
BUDAPELLE, LA 70459

**NOTE:** THIS DRAWING IS USED TO SHOW SPATIAL RELATIONSHIPS.  
REFER TO WALL SECTIONS, STRUCTURAL DRAWINGS, AND DETAILS  
FOR MORE DETAILED INFORMATION.