

**BOOSTER PUMPS SPECIFICATIONS**

FURNISH AND INSTALL A MODEL HBP-200-1BT TWO PUMP WATER PRESSURE BOOSTER SYSTEM AS DESIGNED AND MANUFACTURED BY HYDRONIC MODULES COMPANY. SYSTEM SHALL BE CAPABLE OF AUTOMATICALLY PROVIDING A CONSTANT SYSTEM PRESSURE OF 75 PSIG WHILE SUPPLYING A FLOW RATE OF 0 TO 175 GPM. SYSTEM SHALL AUTOMATICALLY PROVIDE COMPLETE PUMP SHUT DOWN DURING LOW FLOW CONDITIONS WHILE MAINTAINING CONSTANT SYSTEM PRESSURE. SYSTEM SHALL PROVIDE 55 PSI MINIMUM AT TOP FLOOR. UNIT SHALL STORE A MINIMUM OF 30 GALLONS OF USABLE WATER WHEN THE PUMPS ARE OFF.

PUMPS SHALL BE CONSTANT SPEED, CLOSE-COUPLED END SUCTION TYPE WITH MECHANICAL SEALS, BRONZE SHAFT SLEEVES AND BACK-PULLOUT DESIGN WITH FLANGED SUCTION AND DISCHARGE CONNECTIONS. EACH PUMP SHALL BE RATED AT 50% OF SYSTEM DESIGN.

SYSTEM SHALL INCLUDE A 119 GALLON PRECHARGED BLADDER TYPE PRESSURE TANK WITH A REPLACEABLE BLADDER. VESSEL SHALL BE ASME CODE CONSTRUCTED AND N.B. STAMPED FOR 125 PSIG. TANK SHALL BE FURNISHED WITH PRESSURE GAUGE AND RELIEF VALVE.

UNIT TO INCLUDE A NEMA CONTROL PANEL, U.L. LABELED.

ALL EQUIPMENT SHALL BE MOUNTED ON A STRUCTURAL STEEL FRAME COMPLETELY PIPED AND WIRED. THE ONLY FIELD CONNECTIONS REQUIRED SHALL BE SUPPLY AND DISCHARGE PIPING AND THE MAIN POWER LEAD. BLADDER TANK SHALL BE LOCATED ON TOP FLOOR.

THE SERVICE OF A FACTORY TRAINED REPRESENTATIVE SHALL BE MADE AVAILABLE ON THE JOBSITE TO CHECK INSTALLATION, PERFORM START UP AND TO INSTRUCT OPERATING PERSONNEL.

INSTALL PACKAGED PUMPS BEFORE WALLS ARE CLOSED UP.

FOR MORE INFORMATION CONTACT J.R. STEWART PUMP & EQUIPMENT INC. (501)735-2484.

**FIRE PROTECTION NOTES**

THIS PROJECT SHALL BE PROVIDED WITH A FULL SPRINKLER FIRE PROTECTION SYSTEM IN ACCORD WITH GOVERNING CODES & REGULATIONS. FIRE PROTECTION CONTRACTOR SHALL PREPARE COMPLETE PLANS & CALCULATIONS & SUBMIT SAME INCLUDING MATERIALS & METHODS OF INSTALLATION TO PROPER AUTHORITIES FOR REVIEW & APPROVAL PRIOR TO INSTALLATION. FIRE PROTECTION CONTRACTOR SHALL PROVIDE DETECTOR CHECK, PITS, PUMP, BACKFLOW DEVICES, ETC. AS REQ'D. FOR A COMPLETE INSTALLATION.

ALL PENDENT TYPE SPRINKLER HEADS IN FINISHED AREAS SHALL BE FULLY CONCEALED WITH COVERPLATE. COLOR OF COVERPLATE SHALL BE AS SELECTED BY ARCHITECT. EACH FLOOR SHALL BE PROVIDED WITH A SEPARATE FLOOR CONTROL ASSEMBLY. ALL SPRINKLER HEADS SHALL BE FAST RESPONSE. SYSTEM SHALL BE DESIGNED AS PER NFPA 13 AND ALL LOCAL AND STATE STANDARDS (NO EXCEPTIONS). SUBMIT APPROVED SHOP DRAWINGS FROM FIRE MARSHAL TO ARCHITECT. ALL MATERIALS SHALL BE U.L. LISTED AND FACTORY MUTUAL APPROVED.

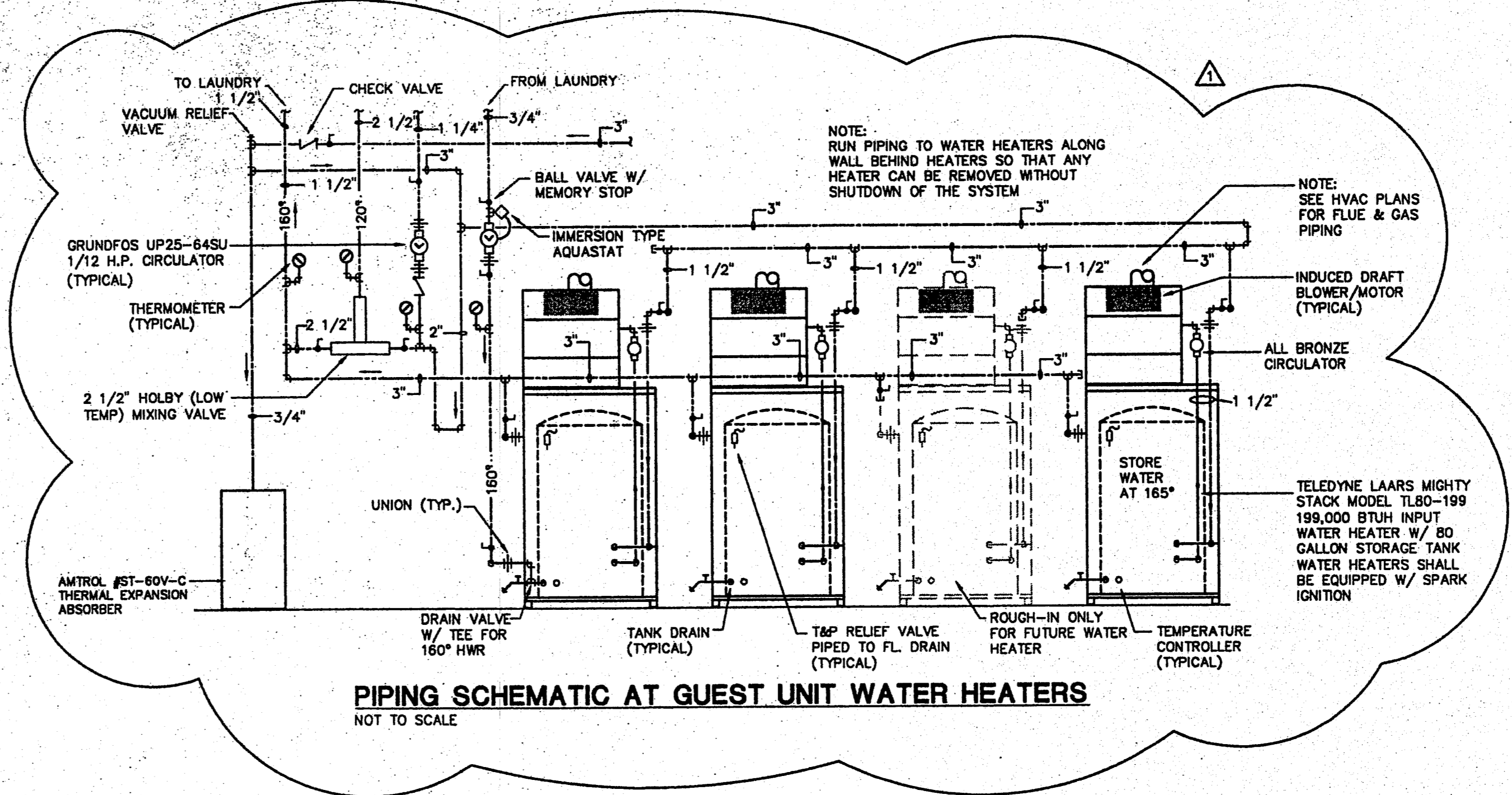

NOTE: SEE SHEET P1.5 FOR ENLARGED PLANS & RISER DIAGRAMS OF TYPICAL GUEST UNITS.

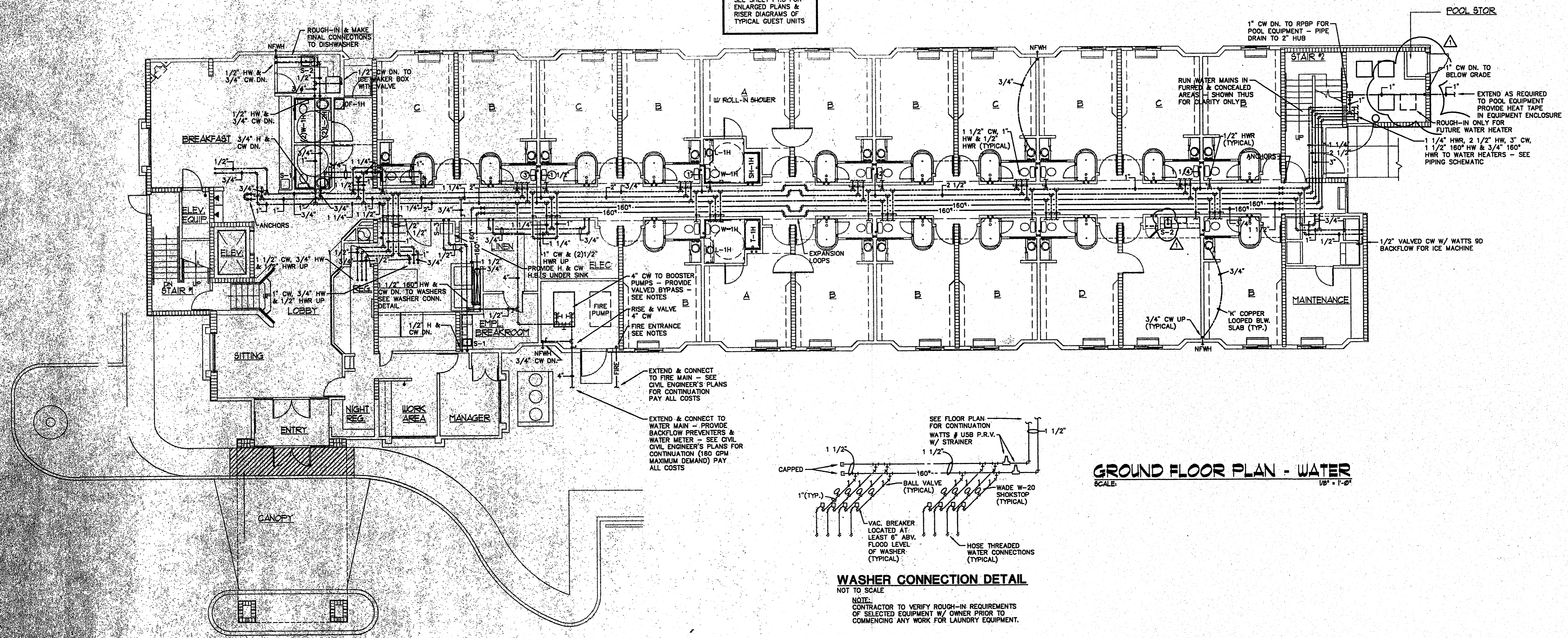

**LLW, Inc.**  
803 SOUTH MT. MORIAH, STE. 100B  
MEMPHIS, TENNESSEE 38117-5343  
901-683-7755/FAX 901-683-2385  
LEONARD MESSINA, ARCHITECT

revisions:  
REVIEW 10-24-97

seal:

**Step Inn**  
Jackson, Mississippi

title:  
**GROUND FLOOR PLAN - WATER**

date: 10-14-97  
job: 1697  
file: 1697-P12  
scale: 1/8" = 1'-0"

sheet  
**P1.2**  
of 34