

ELECTRICAL PLAN
SCALE: 3/32" = 1'-0"

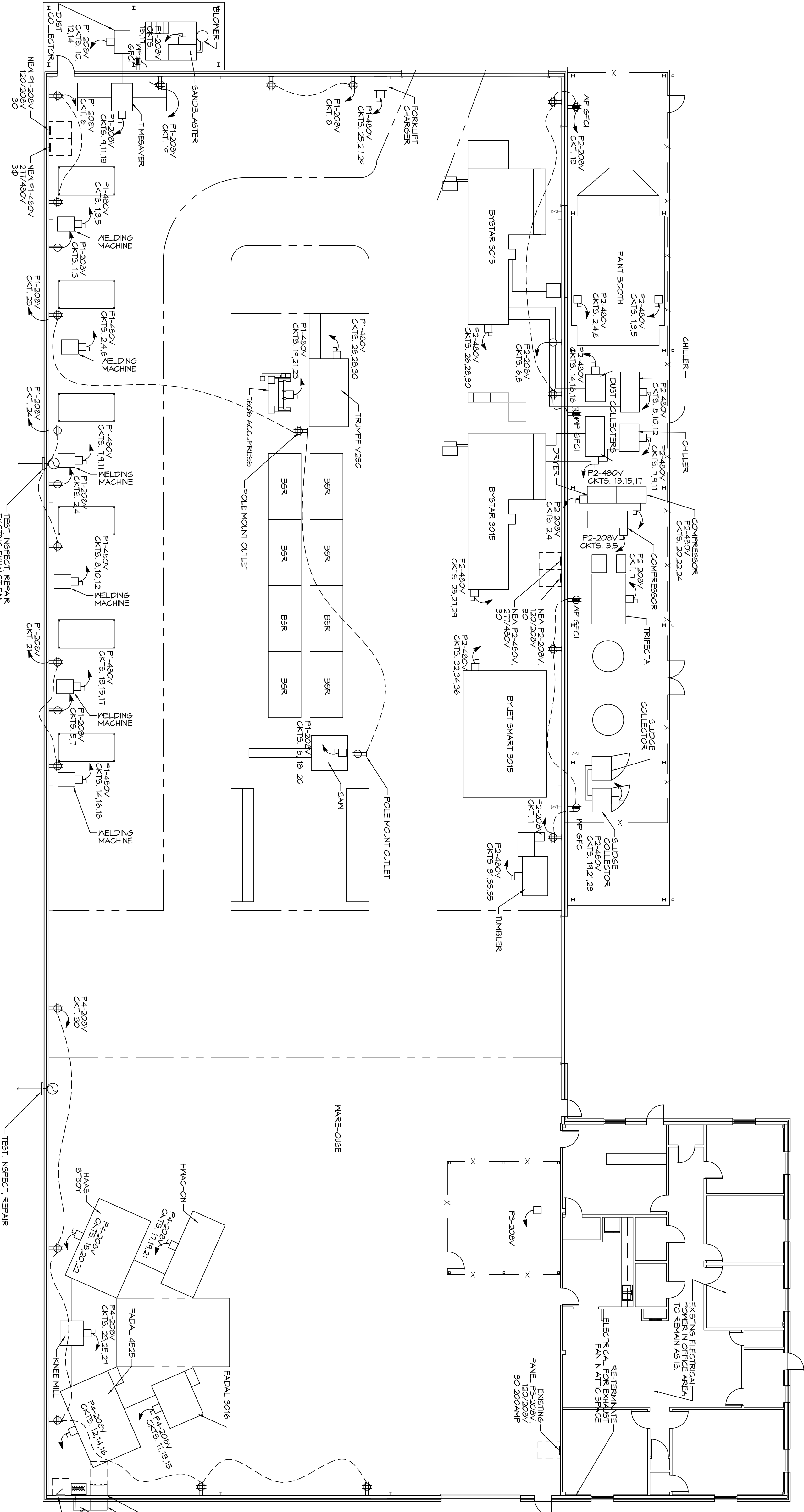

POWER LEGEND	
SYMBOL	DESCRIPTION
(Symbol: Standard 120V duplex receptacle)	STANDARD 120V DUPLEX RECEPTACLE 36" AFF (UNLESS OTHERWISE NOTED)
(Symbol: GFCI duplex receptacle)	GFCI DUPLEX RECEPTACLE
(Symbol: Weather-proof GFCI duplex receptacle)	WEATHER-PROOF GFCI DUPLEX RECEPTACLE MOUNTED AT 30" AFF (UNLESS OTHERWISE NOTED)
(Symbol: Standard quad receptacle)	STANDARD QUAD RECEPTACLE
(Symbol: Weather-proof quad receptacle)	WEATHER-PROOF QUAD RECEPTACLE MOUNTED AT 30" AFF
(Symbol: Junction box)	JUNCTION BOX
(Symbol: Power disconnect)	POWER DISCONNECT
(Symbol: Existing water heater)	EXISTING WATER HEATER

GENERAL POWER NOTES

- ALL WORK SHALL CONFORM TO THE LATEST EDITION OF THE NATIONAL ELECTRICAL CODE, THE GOVERNING ELECTRICAL CODE AND ALL OTHER APPLICABLE REGULATIONS AND ORDINANCES. OBTAIN CERTIFICATES OR APPROVAL WHERE REQUIRED.
- ALL MATERIALS FINISHED SHALL BE NEW AND SHALL BE LISTED.
- THE DRAWINGS INDICATE SIZE AND GENERAL LOCATION OF WORK SCALE DIMENSIONS SHALL NOT BE USED. THE EXACT LOCATION AND LOCATION OF ALL LIGHTING FIXTURES, RECEPTABLES AND TELEPHONE OUTLETS, ETC SHALL BE DETERMINED BY ACTUAL CONDITIONS IN THE FIELD.
- PRIOR TO BIDDING, CONTRACTOR SHALL VISIT THE JOB SITE AND FAMILIARIZE THEMSELVES WITH THE EXISTING CONDITIONS.
- ELECTRICAL CONTRACTOR SHALL COORDINATE HIS WORK WITH OTHER TRADES AND WITH OTHER CONTRACTORS WHOSE WORK MAY AFFECT THIS INSTALLATION.
- ELECTRICAL CONTRACTOR SHALL COORDINATE WORKING ELECTRICAL SERVICE WITH UTILTY COMPANY AND INCLUDE IN HIS BID ALL CHARGES INCURRED BY THE CONTRACTOR IN CONNECTION WITH THE TELEPHONE CONTRACTOR.
- ELECTRICAL CONTRACTOR SHALL COORDINATE THE TELEPHONE CONTRACTOR.
- ELECTRICAL CONTRACTOR BEFORE INSTALLING ANY OF THE WORK SHALL SEE THAT IT DOES NOT INTERFERE WITH CLEARANCES REQUIRED FOR FINISHED CEILING, HUNG CEILING, PLASTER, PARTITIONS, WALLS ETC AS SHOWN IN THE ARCH DRAWINGS AND DETAILS. IF ANY WORK IS INSTALLED AND IT LATER DEVELOPS THAT SUCH DETAILS OR DESIGN CANNOT BE FOLLOWED, THE CONTRACTOR, AT HIS OWN EXPENSE, SHALL BE RESPONSIBLE FOR THE NECESSARY CORRECTIONS. THE CONTRACTOR SHALL BE RESPONSIBLE FOR THE PROTECTION OF THE WORK AS SHOWN ON THE PLANS AND DETAILS.
- PERFORM TEST REQUIRED BY THE OWNER OR THE ENGINEER IN THE BUILDING.
- ALL TESTS SHALL BE MADE IN ACCORDANCE WITH THE LATEST STANDARD OF THE IEEE AND THE NATIONAL ELECTRIC CODE.
- ALL CONDUCTORS SHALL BE A MINIMUM OF #12 AWG UNLESS NOTED OTHERWISE. ALL 120V RUNS LONGER THAN 60 FEET SHALL BE #10 AWG AND 277V RUNS LONGER THAN 150 FEET SHALL BE #10 AWG UNLESS NOTED OTHERWISE.
- ALL CONDUCTORS SHALL BE COPPER.
- WHERE CONDUCTOR SIZES ARE NOTED ON DRAWINGS, THAT WIRE SIZE SHALL BE THROUGH THE ENTIRE RUN UNLESS OTHERWISE NOTED.
- MINIMUM WIRE SIZE SHALL BE #12 AWG UNLESS OTHERWISE NOTED.
- FOR INTERIOR USE, 1/2" RIGID ALUMINUM FOR EXTERIOR USE ABOVE GRADE MINIMUM 1" SCHEDULE 40 PVC FOR CONDUITS BELOW GRADE. SHALL BE INSTALLED ON 18" NON-VOLATILE THERMOPLASTIC RIGID FITTINGS SHALL BE CAST WHERE EXPOSED ON WALLS AND EXTERIOR FITTINGS SHALL BE CAST BOXES WITH NEMA 3R COVER(S).
- CONTRACTOR SHALL INSTALL WIRING AND OTHER CIRCUIT COMPONENTS TO MATCH EQUIPMENT ACTUALLY INSTALLED.
- INSTALL GROUND FAULT RECEPTABLES (GFCI) AT RECEPTACLE LOCATIONS WITHIN 5' OF SINKS OR LAVATORIES, AND AT EXTERIOR LOCATIONS. EXTERIOR RECEPTABLES SHALL ALSO BE WATERPROOF.
- BONDING AND GROUNDING SHALL BE IN ACCORDANCE WITH NFPA 70:200-68, NFPA 250-23, 250-71, & 250-72.
- GROUND NEUTRAL IN ACCORDANCE WITH NFPA 70:250-230.
- FUSES SHALL BE ITC CLASS K5, 250 VOLT, 200,000 AMP INTERRUPTING CAP.
- ALL ELECTRIC, MECHANICAL, AND PLUMBING PENETRATING FIRE PARTITIONS SHALL BE FIRE CALLED. PENETRATIONS THROUGH RATED CONSTRUCTION SHALL BE SEALED WITH A MATERIAL CAPABLE OF PREVENTING THE PASSAGE OF FLAMES AND HOT GASES WHEN TESTED IN ACCORDANCE WITH ASTM E814.
- ALL ELECTRICAL, MECHANICAL AND PLUMBING PIPES BELOW SLAB SHALL BE PLACED BELOW GRADE BEAMS AND SHALL NOT PENETRATE GRADE UNLESS OTHERWISE INDICATED BY THE ARCHITECT'S NOTES.
- ALL WALL MOUNTED OR POLE MOUNTED ELECTRICAL OUTLETS SHALL BE LOCATED 36" AFF IN THE WAREHOUSE UNLESS OTHERWISE NOTED.
- CONTRACTOR SHALL NOT SHAKE WIRELES BETWEEN DIFFERENT CIRCUITS. INDIVIDUAL NEUTRALS SHALL BE RUN FOR EACH CIRCUIT.

DAMMON ENGINEERING, INC.
LOUISIANA & MISSISSIPPI

Chief Engineer: Brian Mistic, PE
554 Old Spanish Trail
Slidell, LA 70458

www.dammonengineering.com
info@dammonengineering.com
PH: 985.649.5832

REVISIONS		
NO.	DESCRIPTION	DATE

RENOVATIONS AND ADDITIONS FOR ALLIANCE LASER

60207 CAMP VILLERE ROAD
SLIDELL, LA 70460

JOB No: 2248 DATE: 01-17-17

DRAWN BY: JTL CHECKED BY: CKD

SHEET TITLE:
ELECTRICAL POWER PLAN

DRAWING NUMBER:
E101

SHEET NO.: 3 OF 10