

TENANT BUILD-OUT FLOOR PLAN  
SCALE: 1/8"=1'

**GA FILE NO. WP 1072 GENERIC**

ONE LAYER 5/8" TYPE X GYPSUM WALLBOARD OR GYPSUM VENEER BASE APPLIED PARALLEL OR AT RIGHT ANGLES TO EACH SIDE OF 3-5/8" STEEL STUDS 24" O.C. WITH 1" TYPE S DRYWALL SCREWS 8" O.C. AT VERTICAL JOINTS AND 12" O.C. AT FLOOR AND CEILING RUNNERS AND INTERMEDIATE STUDS.  
JOINTS STAGGERED 24" ON EACH SIDE AND ON OPPOSITE SIDES. SOUND TESTED WITH 3-1/2" GLASS FIBER FRICTION FIT IN STUD SPACE. (NON-LOAD BEARING)

**1 HR SEPARATION DETAIL**  
NTS

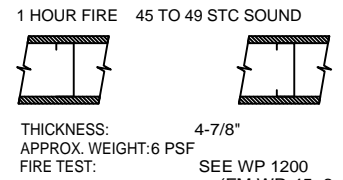

**GA FILE NO. WP 1522 GENERIC GYPSUM WALLBOARD, STEEL STUDS**

BASE LAYER 5/8" TYPE X GYPSUM WALLBOARD OR GYPSUM VENEER BASE APPLIED PARALLEL OR AT RIGHT ANGLES TO EACH SIDE OF 3 5/8" STEEL STUDS 24" O.C. WITH 1" TYPE S DRYWALL SCREWS 24" O.C. FACE LAYER 5/8" TYPE X GYPSUM WALLBOARD OR GYPSUM VENEER BASE APPLIED PARALLEL OR AT RIGHT ANGLES TO EACH SIDE WITH 1 5/8" TYPE S DRYWALL SCREWS 12" O.C.  
JOINTS STAGGERED 24" EACH LAYER AND SIDE. SOUND TESTED WITH 3 1/2" GLASS FIBER FRICTION FIT IN STUD SPACE (NLB).

**2 HR SEPARATION DETAIL**  
NTS

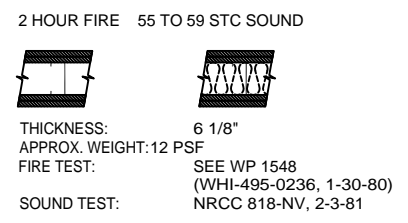

**LEGEND**

- 1 HR. SEPARATION WALL
- EXISTING 2 HR. TENANT SEPARATION WALL
- EXISTING

ROOM FINISH SCHEDULE SUITE 6						
NAME	FLOOR	BASE	WALL	CEILING	REMARKS	CLG. HGT.
600 RETAIL AREA	CARPET	GYPSUM BOARD	CONC. W/SPAL	CONC. W/SPAL	CONC. W/SPAL	11'-0"
601 RESTROOM	CARPET	CONC. W/SPAL	CONC. W/SPAL	CONC. W/SPAL	CONC. W/SPAL	8'-0"

ROOM FINISH SCHEDULE SUITE 7						
NAME	FLOOR	BASE	WALL	CEILING	REMARKS	CLG. HGT.
700 RETAIL AREA	CARPET	GYPSUM BOARD	CONC. W/SPAL	CONC. W/SPAL	CONC. W/SPAL	11'-0"
701 RESTROOM	CARPET	CONC. W/SPAL	CONC. W/SPAL	CONC. W/SPAL	CONC. W/SPAL	8'-0"

ROOM FINISH SCHEDULE SUITE 9						
NAME	FLOOR	BASE	WALL	CEILING	REMARKS	CLG. HGT.
900 RETAIL AREA	CARPET	GYPSUM BOARD	CONC. W/SPAL	CONC. W/SPAL	CONC. W/SPAL	11'-0"
901 RESTROOM	CARPET	CONC. W/SPAL	CONC. W/SPAL	CONC. W/SPAL	CONC. W/SPAL	8'-0"

DOOR & HARDWARE SCHEDULE							
NO.	SIZE	TYPE	FRAME	HINGE	LOCK	ACCESS.	REMARKS
1	3'0x7'0	S. G. WOOD	HOLLOW METAL	WOOD	BUTT	NONE	
2		HOLLOW METAL	WOOD	WOOD	NONE	NONE	
3		HOLLOW METAL	WOOD	WOOD	NONE	NONE	

**GENERAL NOTES**

1. INSULATION AND INSULATION ASSEMBLIES SHALL MEET THE REQUIREMENTS OF SECTION 719.
2. CONTRACTOR TO VERIFY ALL SITE CONDITIONS AND DIMENSIONS PRIOR TO CONSTRUCTION.
3. MATERIALS SHALL BE NEW AND U.L. LISTED.
4. NO WORK SHALL BE CONCEALED UNTIL APPROVED BY LOCAL INSPECTORS.
5. CONSTRUCTION SHALL COMPLY WITH ALL PARISH, STATE, AND LOCAL CODES.
6. CONTRACTOR TO GUARANTEE WORK FOR ONE YEAR.
7. CONTRACTOR SHALL FURNISH WATER AND POWER FROM EXISTING SOURCES.
8. EXTERIOR CAULKING SHALL BE THIOKAL CAULK.
9. PAINT GRADE TO SHALL BE SHERWIN WILLIAMS OR EQUIVALENT. ALL WORK TO RECEIVE 3 COATS. COLOR SELECTION BY OWNER.
10. PROVIDE CLEANUP ON A REGULAR BASIS. NO TRASH STORED IN BUILDING.
11. ALL BATT INSULATION SHALL HAVE A CLASS "A" (0-25) FLAME SPREAD IN COMPLIANCE WITH APPLICABLE CODE.
12. USE 6" STUDS, OR 4" STAGGERED STUDS AT ALL PLUMBING WALLS.
13. PROVIDE GALVANIZED METAL PAN WITH DRAIN AT WATER HEATER LOCATION.
14. ALL CORNERS SHALL BE PROPERLY BRACED FOR WIND LOADS. A 48" SHEATHING SHALL BE PROVIDED EVERY 20 FEET OF WALL LENGTH.
15. INTERIOR LOCKS ON DOORS IN MEANS OF EGRESS SHALL NOT REQUIRE THE USE OF A KEY, SPECIAL KNOWLEDGE, OR SPECIAL DEVICE TO OPEN IN THE DIRECTION OF EGRESS. ALL DOORS SHALL HAVE LEVER TYPE HANDLES.
16. INTERIOR WALLS AND CEILINGS SHALL HAVE A FLAME SPREAD OF 0-200 AND A SMOKE DEVELOPMENT RATING OF 0-450.
17. ALL WORK SHALL COMPLY WITH THE LATEST EDITION OF ALL LOCAL, STATE, AND NATIONAL CODES COVERING THE TYPE OF WORK BEING PERFORMED.
18. PROVIDE PORTABLE FIRE EXTINGUISHERS IN ACCORDANCE WITH NFPA 101. SEE APPENDIX "E" OF NFPA 101 FOR DISTRIBUTION OF EXTINGUISHERS.
19. ALL FIRE WALLS SHALL EXTEND TIGHT TO ROOF DECK AND BE SEALED WITH AN APPROVED FIRE CAULK.
20. ALL ELECTRICAL, MECHANICAL, AND PLUMBING MATERIALS PENETRATING FIRE WALLS SHALL BE FIRE CAULKED. (PENETRATIONS THROUGH RATED CONSTRUCTION SHALL BE SEALED WITH A MATERIAL CAPABLE OF PREVENTING THE PASSAGE OF FLAMES AND HOT GASES WHEN TESTED IN ACCORDANCE WITH ASTM-E814.)
21. SERVICE COUNTER SHALL HAVE A HCP ACCESSIBLE WRITING SURFACE, MAX. 36" FROM F.F. (ADAAG MANUAL 1998, PG 135)

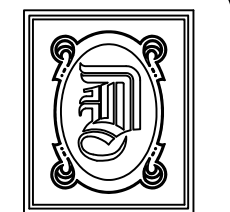

**DAMMON ENGINEERING, INC.**

CHIEF ENGINEER  
EMMETT DAMMON, P.E.

CHIEF ARCHITECT  
ROBERT WILTSE

1095 FLORIDA AVENUE  
SLIDELL, LA. 70458  
OFFICE: 985-649-5832  
FAX: 985-641-5950

WEBSITE:  
WWW.DAMMONENGINEERING.COM  
EMAIL:  
DAMMONENG@BELLSOUTH.NET

- ARCHITECTURE
- ENGINEERING
- STUDIES
- PLANNING
- INVESTIGATION
- EXPERT WITNESS

TENANT BUILD-OUT

J D PLAZA  
345 GAUSE BOULEVARD  
WEST  
SLIDELL, LA

FLOOR PLAN

REV:

SCALE: AS NOTED

JOB#: 2070

DATE: 06-25-10

SHEET 3

A-1

OF 10