

TENANT BUILD-OUT FLOOR PLAN
SCALE: 1/8"=1'

GA FILE NO. WP 1072 GENERIC

ONE LAYER 5/8" TYPE X GYPSUM WALLBOARD OR GYPSUM VENEER BASE APPLIED PARALLEL OR AT RIGHT ANGLES TO EACH SIDE OF 3-5/8" STEEL STUDS 24" O.C. WITH 1" TYPE S DRYWALL SCREWS 8" O.C. AT VERTICAL JOINTS AND 12" O.C. AT FLOOR AND CEILING RUNNERS AND INTERMEDIATE STUDS.
JOINTS STAGGERED 24" ON EACH SIDE AND ON OPPOSITE SIDES. SOUND TESTED WITH 3-1/2" GLASS FIBER FRICTION FIT IN STUD SPACE. (NON-LOAD BEARING)

1 HR SEPARATION DETAIL
NTS

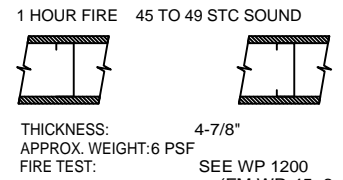

THICKNESS: 4-7/8"
APPROX. WEIGHT: 6 PSF
FIRE TEST: SEE WP 1200 (FM WP-45, 6-19-68); OSU T-1770, 8-61; ULC 79T484, 79T500, 79T497, 8-12-81, ULC DESIGN W415)
SOUND TEST: NRCC 816-NV, 2-3-81

GA FILE NO. WP 1522 GENERIC GYPSUM WALLBOARD, STEEL STUDS

BASE LAYER 5/8" TYPE X GYPSUM WALLBOARD OR GYPSUM VENEER BASE APPLIED PARALLEL OR AT RIGHT ANGLES TO EACH SIDE OF 3 5/8" STEEL STUDS 24" O.C. WITH 1" TYPE S DRYWALL SCREWS 24" O.C. FACE LAYER 5/8" TYPE X GYPSUM WALLBOARD OR GYPSUM VENEER BASE APPLIED PARALLEL OR AT RIGHT ANGLES TO EACH SIDE WITH 1 5/8" TYPE S DRYWALL SCREWS 12" O.C.
JOINTS STAGGERED 24" EACH LAYER AND SIDE. SOUND TESTED WITH 3 1/2" GLASS FIBER FRICTION FIT IN STUD SPACE (NLB).

2 HR SEPARATION DETAIL
NTS

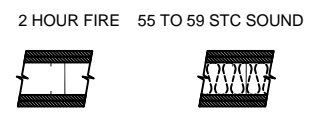

THICKNESS: 6 1/8"
APPROX. WEIGHT: 12 PSF
FIRE TEST: SEE WP 1548 (WHI-495-0236, 1-30-80)
SOUND TEST: NRCC 818-NV, 2-3-81

LEGEND

- 1 HR. SEPARATION WALL
- EXISTING 2 HR. TENANT SEPARATION WALL
- EXISTING

| ROOM FINISH SCHEDULE SUITE 6 | | | | | | |
|------------------------------|--------|--------|--------------|---------------|------------|---|
| NAME | FLOOR | BASE | WALL | CEILING | REMARKS | |
| 600 RETAIL AREA | CARPET | V.C.T. | CERAMIC TILE | CONC. W/SPALR | VINYL BASE | CERAMIC TILE |
| 601 RESTROOM | | | | | | |
| | | | | | | NOTE: INSTALL MOISTURE RESISTANT GYPSUM BOARD (PAINTED) ON WALLS ABOVE CERAMIC TILE IN RESTROOMS/BATHROOMS WITH CERAMIC TILE TO 42" HEIGHT. |
| | | | | | | CLG. HGT. 11'-0" |
| | | | | | | 8'-0" |

| ROOM FINISH SCHEDULE SUITE 7 | | | | | | |
|------------------------------|--------|--------|--------------|---------------|------------|---|
| NAME | FLOOR | BASE | WALL | CEILING | REMARKS | |
| 700 RETAIL AREA | CARPET | V.C.T. | CERAMIC TILE | CONC. W/SPALR | VINYL BASE | CERAMIC TILE |
| 701 RESTROOM | | | | | | |
| | | | | | | NOTE: INSTALL MOISTURE RESISTANT GYPSUM BOARD (PAINTED) ON WALLS ABOVE CERAMIC TILE IN RESTROOMS/BATHROOMS WITH CERAMIC TILE TO 42" HEIGHT. |
| | | | | | | CLG. HGT. 11'-0" |
| | | | | | | 8'-0" |

| ROOM FINISH SCHEDULE SUITE 9 | | | | | | |
|------------------------------|--------|--------|--------------|---------------|------------|---|
| NAME | FLOOR | BASE | WALL | CEILING | REMARKS | |
| 900 RETAIL AREA | CARPET | V.C.T. | CERAMIC TILE | CONC. W/SPALR | VINYL BASE | CERAMIC TILE |
| 901 RESTROOM | | | | | | |
| | | | | | | NOTE: INSTALL MOISTURE RESISTANT GYPSUM BOARD (PAINTED) ON WALLS ABOVE CERAMIC TILE IN RESTROOMS/BATHROOMS WITH CERAMIC TILE TO 42" HEIGHT. |
| | | | | | | CLG. HGT. 11'-0" |
| | | | | | | 8'-0" |

| DOOR & HARDWARE SCHEDULE | | | | | | | | | | | | | | | | | | | | | |
|--------------------------|-------|------------------|------------|--------------|----------|------|---------|---------|------|---------|---------|--------------|-----------|------|-----------|--------------|-----------|--------|-------------|------|----------|
| NO. | SIZE | TYPE | | FRAME | HINGE | LOCK | ACCESS. | REMARKS | | | | | | | | | | | | | |
| | | S.F. VINYL GLASS | S. G. WOOD | HOLLOW METAL | ALUMINUM | WOOD | BUTT | | NONE | PASSAGE | PRIVACY | KEYED HANDLE | FUSH PULL | NONE | THRESHOLD | WEATHERSTRIP | DOOR STOP | CLOSER | SELF-CLOSER | NONE | |
| 1 | 30x70 | | | | | | | | | | | | | | | | | | | | |
| 2 | 30x70 | | | | | | | | | | | | | | | | | | | | EXISTING |
| 3 | | | | | | | | | | | | | | | | | | | | | |

GENERAL NOTES

1. INSULATION AND INSULATION ASSEMBLIES SHALL MEET THE REQUIREMENTS OF SECTION 719.
2. CONCEALED INSULATION SHALL HAVE A FLAME SPREAD OF 0-25 AND SMOKE DEVELOPED INDEX OF 0-450. EXCEPT THAT IN COMBUSTIBLE (WOOD FRAME) CONSTRUCTION.
3. CONTRACTOR TO VERIFY ALL SITE CONDITIONS AND DIMENSIONS PRIOR TO CONSTRUCTION.
4. MATERIALS SHALL BE NEW AND U.L. LISTED.
5. NO WORK SHALL BE CONCEALED UNTIL APPROVED BY LOCAL INSPECTORS.
6. CONSTRUCTION SHALL COMPLY WITH ALL PARISH, STATE, AND LOCAL CODES.
7. CONTRACTOR TO GUARANTEE WORK FOR ONE YEAR.
8. CONTRACTOR SHALL FURNISH WATER AND POWER FROM EXISTING SOURCES.
9. EXTERIOR CAULKING SHALL BE THIOKAL CAULK.
10. PAINT GRADE TO SHALL BE SHERWIN WILLIAMS OR EQUIVALENT. ALL WORK TO RECEIVE 3 COATS. COLOR SELECTION BY OWNER.
11. PROVIDE CLEANUP ON A REGULAR BASIS. NO TRASH STORED IN BUILDING.
12. ALL BATT INSULATION SHALL HAVE A CLASS "A" (0-25) FLAME SPREAD IN COMPLIANCE WITH APPLICABLE CODE.
13. USE 6" STUDS, OR 4" STAGGERED STUDS AT ALL PLUMBING WALLS.
14. PROVIDE GALVANIZED METAL PAN WITH DRAIN AT WATER HEATER LOCATION.
15. ALL CORNERS SHALL BE PROPERLY BRACED FOR WIND LOADS. A 48" SHEATHING SHALL BE PROVIDED EVERY 20 FEET OF WALL LENGTH.
16. INTERIOR LOCKS ON DOORS IN MEANS OF EGRESS SHALL NOT REQUIRE THE USE OF A KEY, SPECIAL KNOWLEDGE, OR SPECIAL DEVICE TO OPEN IN THE DIRECTION OF EGRESS. ALL DOORS SHALL HAVE LEVER TYPE HANDLES.
17. INTERIOR WALLS AND CEILINGS SHALL HAVE A FLAME SPREAD OF 0-200 AND A SMOKE DEVELOPMENT RATING OF 0-450.
18. ALL WORK SHALL COMPLY WITH THE LATEST EDITION OF ALL LOCAL, STATE, AND NATIONAL CODES COVERING THE TYPE OF WORK BEING PERFORMED.
19. PROVIDE PORTABLE FIRE EXTINGUISHERS IN ACCORDANCE WITH NFPA 101. SEE APPENDIX "E" OF NFPA 101 FOR DISTRIBUTION OF EXTINGUISHERS.
20. ALL FIRE WALLS SHALL EXTEND TIGHT TO ROOF DECK AND BE SEALED WITH AN APPROVED FIRE CAULK.
21. ALL ELECTRICAL, MECHANICAL, AND PLUMBING MATERIALS PENETRATING FIRE WALLS SHALL BE FIRE CAULKED. (PENETRATIONS THROUGH RATED CONSTRUCTION SHALL BE SEALED WITH A MATERIAL CAPABLE OF PREVENTING THE PASSAGE OF FLAMES AND HOT GASES WHEN TESTED IN ACCORDANCE WITH ASTM-E814.)
22. SERVICE COUNTER SHALL HAVE A HCP ACCESSIBLE WRITING SURFACE, MAX. 36" FROM F.F. (ADAAG MANUAL 1998, PG 135)

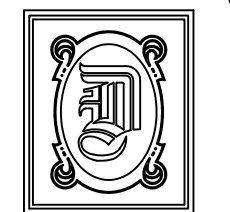

DAMMON ENGINEERING, INC.

CHIEF ENGINEER
EMMETT DAMMON, P.E.

CHIEF ARCHITECT
ROBERT WILTSE

1095 FLORIDA AVENUE
SLIDELL, LA. 70458
OFFICE: 985-649-5832
FAX: 985-641-5950

WEBSITE:
WWW.DAMMONENGINEERING.COM
EMAIL:
DAMMONENG@BELLSOUTH.NET

ARCHITECTURE

ENGINEERING

STUDIES

PLANNING

INVESTIGATION

EXPERT WITNESS

TENANT BUILD-OUT

J D PLAZA
345 GAUSE BOULEVARD
WEST SLIDELL, LA

FLOOR PLAN

REV:

SCALE: AS NOTED

JOB#: 2070

DATE: 06-29-10

SHEET 3

A-1

OF 8