

<b>PLANNING</b>
LOT 36A ZONED G-4 HIGHWAY COMMERCIAL
<b>PARKING</b>
1 SPACE PER 300 SQ. FT. OF SHOWROOM AREA: 1000 / 300 = 3 REQUIRED 1 SPACE PER 1000 SQ. FT. OF WAREHOUSE AREA: 3800 / 1000 = 4 REQUIRED TOTAL OF 5 PARKING SPACES PROVIDED

**DAMMON**  
ENGINEERING, INC.  
LOUISIANA & MISSISSIPPI

www.dammonengineering.com  
info@dammonengineering.com  
PH: 985.677.1828

Chief Engineer: Brian Michich, PE  
356 Old Spanish Trail  
Barringer, LA 70808

#	DESCRIPTION	REVISIONS	DATE

SEAL:

OFFICE WAREHOUSE RENOVATION  
**SURGI INVESTMENTS**

30255  
COAST BLVD.  
SLPELL, LA

JOB No: 07-17-2018  
DATE: 07-17-2018  
DRAWN BY: JMS  
CHECKED BY: CSD

SHEET TITLE:  
SITE PLAN

DRAWING NUMBER:  
**C101**

SHEET No: 1 of 1

COAST BOULEVARD

**1 SITE PLAN**  
SCALE: 1" = 10'-0"

P:\E-Draws\2018\07-17-2018\07-17-2018.dwg  
 PLOT DATE: 8/16/2018 10:13:28 AM  
 PLOT BY: JMS

FILE NAME: A:\Projects\2019\20190801\20190801.dwg PLOT DATE: 08/01/2019 10:30:40 AM

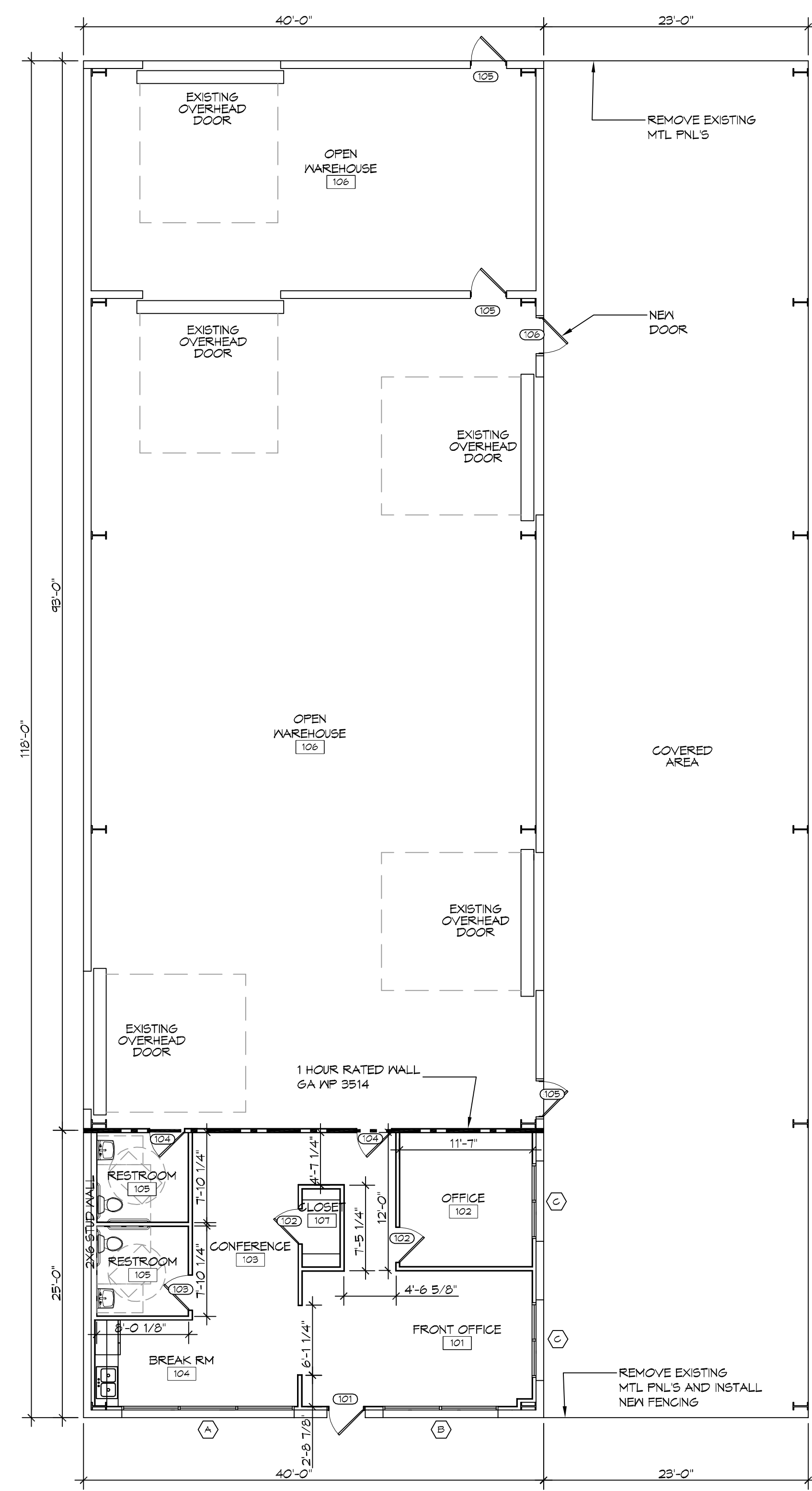

**22 FLOOR PLAN**  
SCALE: 1/8" = 1'-0"

**DOOR SCHEDULE**

MK	WIDTH	HEIGHT	THK	DOOR MAT	FRAME MAT	FR	REMARKS
101	3'-0"	6'-8"	1-3/4"	GLASS	STEEL	NR	WITH DOOR CLOSURE
102	3'-0"	6'-8"	1-3/4"	MASONITE	WOOD	NR	
103	3'-0"	6'-8"	1-3/4"	MASONITE	WOOD	NR	WITH DOOR CLOSURE
104	3'-0"	6'-8"	1-3/4"	STEEL	STEEL	45 MIN.	WITH DOOR CLOSURE
105	3'-0"	6'-8"	1-3/4"	STEEL	STEEL	NR	EXISTING TO REMAIN
106	3'-0"	6'-8"	1-3/4"	STEEL	STEEL	NR	NEW DOOR

**WINDOW SCHEDULE**

MK	SIZE	FRAME	TYPE	REMARKS
A	(3) 5'-0"W x 5'-0"H	ALUM	FIXED	TINTED / TEMPERED/DOUBLE INSULATED
B	(2) 5'-0"W x 5'-0"H	ALUM	FIXED	TINTED / TEMPERED/DOUBLE INSULATED
C	(2) 3'-0"W x 5'-0"H	ALUM	FIXED	TINTED / TEMPERED/DOUBLE INSULATED

1. ALL WINDOW ASSEMBLIES TO BE RATED FOR 140 MPH WINDS AND SHALL BE MISSILE IMPACT RESISTANT.

**FINISH SCHEDULE**

ROOM NAME	ROOM NO	FLOOR	BASE	WALL	CEILING	REMARKS
FRONT OFFICE	101	CARPET	VINYL	5/8" GYP BD	2X2 DROP CEILING	
OFFICE	102	CARPET	VINYL	5/8" GYP BD	2X2 DROP CEILING	
CONFERENCE	103	CARPET	VINYL	5/8" GYP BD	2X2 DROP CEILING	
BREAK RM	104	VCT	VINYL	5/8" GYP BD	2X2 DROP CEILING	
RESTROOM	105	VCT	VINYL	5/8" GYP BD	5/8" GYP BD	MOISTURE RESISTANT
WAREHOUSE	106	CONCRETE	N/A	FURLINS	FURLINS	
CLOSET	107	VCT	VINYL	5/8" GYP BD	2X2 DROP CEILING	

**GA FILE NO. WP 3514 GENERIC**

ONE LAYER 5/8" TYPE X GYPSUM WALLBOARD OR GYPSUM VENEER BASE APPLIED PARALLEL OR AT RIGHT ANGLES TO EACH SIDE OF 2X4 WOOD STUDS 16" O.C. WITH 1-1/4" TYPE W DRYWALL SCREENS 12" O.C.  
JOINTS STAGGERED 16" ON OPPOSITE SIDES. (LOAD BEARING)

1 HOUR FIRE 35 TO 39 STC SOUND



THICKNESS: 4-3/4"  
APPROX. WEIGHT: 7 PSF  
FIRE TEST: SNRI 01-4511-619, 8-19-02  
SOUND TEST: SEE WP 3520 (64H NG-246FT, T-2-65)

**23 DETAIL**  
SCALE: 3/8" = 1'-0"

ONE HOUR RATED WALL

**GENERAL NOTES**

- INSULATION AND INSULATION ASSEMBLIES SHALL MEET THE REQUIREMENTS OF IBC 2012 SECTION 714.
- CONCEALED INSULATION SHALL HAVE A FLAME SPREAD OF 0-25 AND SMOKE DEVELOPED INDEX OF 0-450, EXCEPT THAT IN COMBUSTIBLE (WOOD FRAME) CONSTRUCTION.
- FACING SHALL COMPLY WITH IBC 2012.
- ALL MATERIALS SHALL BE NEW AND UL LISTED.
- NO WORK SHALL BE CONCEALED UNTIL APPROVED BY LOCAL INSPECTORS.
- CONSTRUCTION SHALL COMPLY WITH ALL PARISH, STATE, AND LOCAL CODES.
- CONTRACTOR TO GUARANTEE WORK FOR ONE YEAR FROM DATE OF SUBSTANTIAL COMPLETION.
- CONTRACTOR SHALL FURNISH WATER AND POWER FROM EXISTING SOURCES.
- EXTERIOR CAULKING SHALL BE THICK CAULK.
- PAINT SHALL BE SHERWIN WILLIAMS OR EQUIVALENT AND APPROPRIATE FOR THE SUBSTRATE TO WHICH IT IS APPLIED AS RECOMMENDED BY PAINT MANUFACTURER. ALL WORK TO RECEIVE THREE COATS (ONE PRIMER COAT, TWO FINISH COATS) UNLESS OTHERWISE RECOMMENDED BY PAINT MANUFACTURER. COLORS TO BE SELECTED BY OWNER.
- PROVIDE CLEANUP ON A REGULAR BASIS. NO TRASH SHALL BE STORED INSIDE BUILDING PREMISES.
- ALL BATT INSULATION SHALL HAVE A CLASS "A" (0-25) FLAME SPREAD IN COMPLIANCE WITH IBC 2012.
- USE 2x6 STUDS OR TWO 2x4 STAGGERED STUDS WITH 2x6 SILL PLATE AT ALL WALLS WHERE 4" PIPE IS INDICATED. SEE PLUMBING RISER DIAGRAM FOR PIPE SIZE.
- PROVIDE GALVANIZED METAL PAN WITH DRAIN AT ALL WATER HEATERS.
- ALL FLOORING SHALL MEET OR EXCEED ADA GUIDELINES REQUIREMENTS FOR SLIP RESISTANCE.
- INTERIOR LOCKS ON DOORS IN MEANS OF EGRESS SHALL NOT REQUIRE THE USE OF A KEY, SPECIAL KNOWLEDGE, OR SPECIAL DEVICE TO OPEN IN THE DIRECTION OF EGRESS. ALL DOORS SHALL HAVE LEVER TYPE HANDLES.
- INTERIOR WALLS AND CEILINGS SHALL HAVE A FLAME SPREAD OF 0-200 AND A SMOKE DEVELOPMENT RATING OF 0-450.
- ALL WORK SHALL COMPLY WITH THE LATEST EDITION OF ALL LOCAL, STATE, AND NATIONAL CODES COVERING THE TYPE OF WORK BEING PERFORMED.
- PROVIDE PORTABLE FIRE EXTINGUISHERS IN ACCORDANCE WITH NFPA 101. SEE APPENDIX 'E' OF NFPA 101 FOR DISTRIBUTION OF EXTINGUISHERS.
- ALL FIRE WALLS SHALL EXTEND TIGHT TO ROOF DECK AND BE SEALED WITH AN APPROVED FIRE CAULK.
- ALL ELECTRICAL, MECHANICAL, AND PLUMBING MATERIALS PENETRATING FIRE WALLS SHALL BE FIRE CAULKED. (PENETRATIONS THROUGH RATED CONSTRUCTION SHALL BE SEALED WITH A MATERIAL CAPABLE OF PREVENTING THE PASSAGE OF FLAMES AND HOT GASES WHEN TESTED IN ACCORDANCE WITH ASTM-E814.)
- SERVICE COUNTERS SHALL HAVE AN ACCESSIBLE WRITING SURFACE IN COMPLIANCE WITH ADAAG ACCESSIBILITY GUIDELINES 2010, SECTION 402.3.

**DAMMON ENGINEERING, INC.**  
LOUISIANA & MISSISSIPPI

Chief Engineer: Brian Mettich, PE  
554 Old Spanish Trail  
Slidell, LA 70098  
www.dammonengineering.com  
info@dammonengineering.com  
PH: 985.649.5832

#	DESCRIPTION	DATE

SEAL:

**OFFICE WAREHOUSE RENOVATION**  
**SURVEY INSTRUMENTS**

90255  
COAST BLVD.  
SLIDELL, LA

JOB NO: 07-17-2019  
DATE: 07-17-2019  
DRAWN BY: JMS  
CHECKED BY: JMS

SHEET TITLE:  
FLOOR PLAN

DRAWING NUMBER:  
**A101**

SHEET No: 9 of 1

