

WORK THROUGH  
7-31-07  
9:13am

**Dammon Engineering Inc.**  
1095 Florida Ave.  
Slidell, LA 70458  
(985) 649-5832  
Fax: (985) 641-5950

**FAX COVER SHEET**

FAX NUMBER TRANSMITTED TO: 863-0666  
TO: Ray Masker  
FROM: Jennie Tiffany  
CLIENT/MATTER: \_\_\_\_\_  
REFERENCE: office Renovation  
DATE: 7-31-07 NO. OF PAGES INCLUDING COVER SHEET: 5

COMMENTS:

Ray,  
Here is the floorplan we discussed.  
Please take a look and let me know  
what you think.  
Thanks,  
Jennie

IF YOU EXPERIENCE ANY PROBLEMS RECEIVING THIS FAX, PLEASE CALL (985) 649-5832,  
OR FAX (985) 641-5950

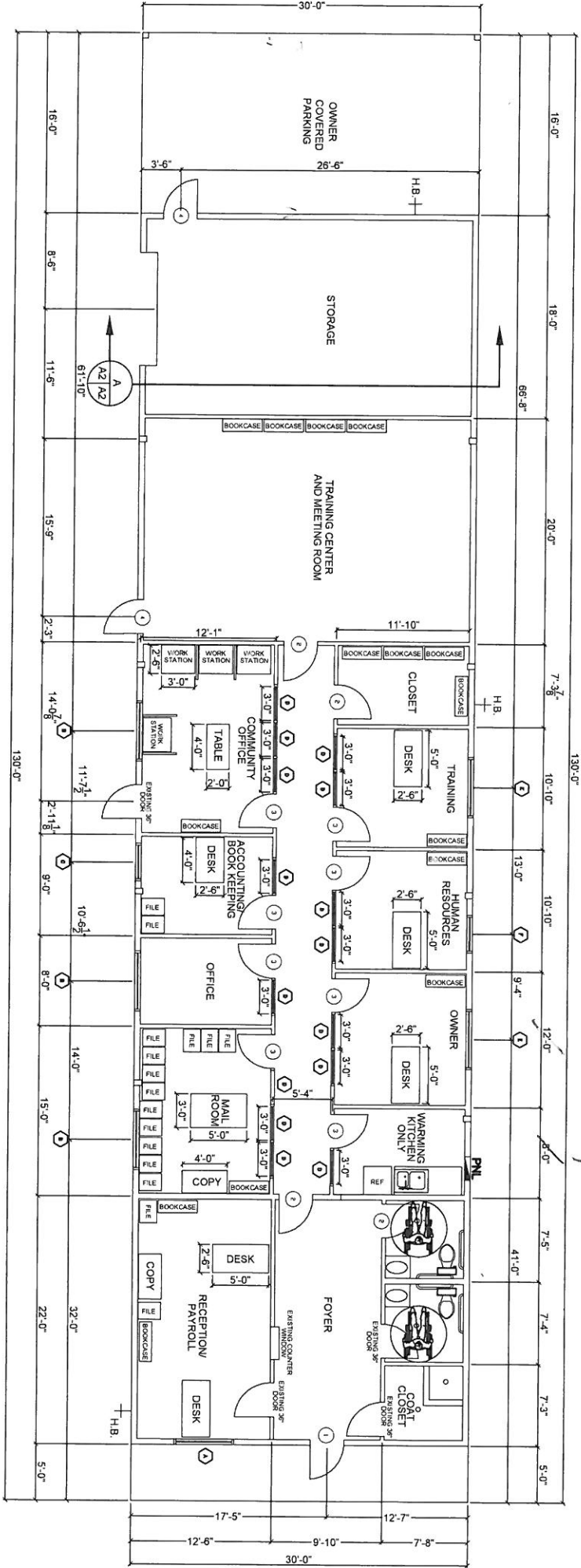

NEW FLOOR PLAN  
SCALE: 3/16"=1'-0"

*Bay measured from edge of wall  
Should be center*

11

## WINDOW SCHEDULE



WINDOW	FIXED	TYPE		FRAME		GLASS			LITES				ACCESSORIES				REMARKS		
		VERTICAL SLIDE	HORIZ SLIDE	STEEL	ALUMINUM	WOOD	TINTED	PLAIN	TEMPERED	WIREGLASS	NONE	2/2	4/4	6/6	8/8	ALARM		SCREEN	SHUTTER
A	3/0x5/0	●																	EXTERIOR
B	2/0x5/0	●																	TRANSOM
C	2/0x3/0	●																	TRANSOM
D	3/0x7/0	●																	INTERIOR
E	2/0x5/0	●																	TRANSOM - RATED
F	2/0x3/0	●																	TRANSOM- RATED

## DOOR AND HARDWARE SCHEDULE



#	SIZE	TYPE			FRAME		HINGE			LOCK				ACCESSORIES			REMARKS							
		WOOD	METAL	GLASS	STOREFRONT	STEEL	ALUMINUM	WOOD	DOUBLE SWING	BUTT	BURGLER PRF	PASSAGE	PRIVACY	DEADBOLT	KEYED HANDLE	PUSH PULL		PANIC BAR	THRESHOLD	WEATHERSTRIP	DOOR STOP	ALARM	PEEP HOLE	CLOSER
1	3/0x7/0			●																				STORE FRONT
2	3/0x7/0		●																					INTERIOR
3	3/0x7/0			●																				INTERIOR - GLASS FRONT
4	3/0x7/0		●																					EXTERIOR

1. DOORS IN PATH OF EGRESS SHALL BE READILY OPENABLE FROM THE EGRESS SIDE WITHOUT THE USE OF A KEY OR SPECIAL KNOWLEDGE OR EFFORT. (IBC 2003 - 1008.1.8)
2. A READILY VISIBLE SIGN SHALL BE POSTED ON THE EGRESS SIDE ON OR ADJACENT TO THE DOOR STATING: THIS DOOR SHALL REMAIN UNLOCKED WHEN BUILDING IS OCCUPIED.  
THE SIGN SHALL BE IN LETTERS 1" (25MM) HIGH ON A CONTRASTING BACKGROUND. (IBC 2003 - 1008.1.8.3.: 2.2.)
3. ALL HEADERS SHALL HAVE SOLID BLOCKING.

## FINISH SCHEDULE

NAME	FLOOR			BASE			WALLS			CEILING			REMARKS		
	CARPET	CONCRETE	VCT	CERAMIC TILE	CERAMIC TILE	RUBBER WALL BASE	WOOD BASE	NONE	CERAMIC TILE	GYPSON BOARD			2'x2' LAY-IN PANELS	GYPSON BOARD	
OFFICES				●	●					●			●		CEILING HEIGHT 9'

OWNER TO SELECT STYLE, COLOR, AND BRAND



