

FILE NAME: J:\Projects\02-09-2022\02-09-2022\C101 - Site Plan.dwg PLOT DATE: 4/10/2024 10:52:31 AM
 PLOT BY: JMS

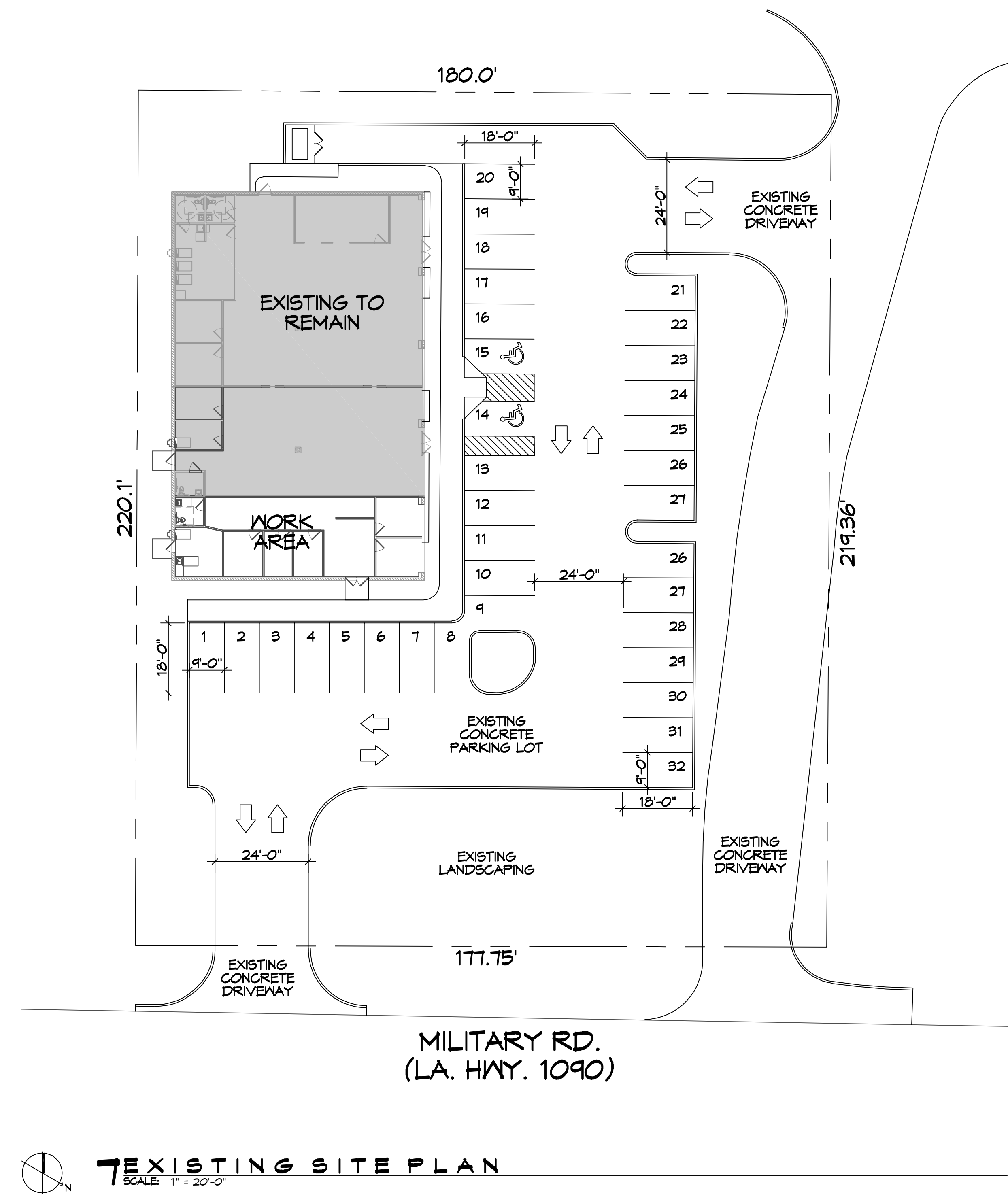

EXISTING SITE PLAN
 SCALE: 1" = 20'-0"

PARKING	
ACTION PHYSICAL THERAPY AND SPORTS MEDICINE	1 SPACE PER REQUIRED 200 SQ. FT. OF BUILDING AREA: 5071 SQ. FT. / 200 = 25 REQUIRED
OFFICE/PROFESSIONAL OFFICE AND/OR GROUPS OF BUILDINGS OF SIMILAR NATURE:	1 SPACE PER EACH 350 SQ. FT. OF GROSS FLOOR AREA EXCLUDING STORAGE AREAS WHICH SHALL NOT EXCEED 15 PERCENT OF THE GROSS SQUARE FOOTAGE.
	AREA: 1423 SQ. FT. / 350 = 4 REQUIRED
	24 REQUIRED PARKING PLACES FOR ALL SUITES
	32 PARKING SPACES PROVIDED FOR WHOLE SITE

DAMMON
ENGINEERING, INC.
 LOUISIANA & MISSISSIPPI

Chief Engineer: Brian Mistich, PE
 554 Old Spanish Trail
 Slidell, LA 70468
 www.dammonengineering.com
 info@dammonengineering.com
 PH: 985.649.5832

#	DESCRIPTION	DATE
1		

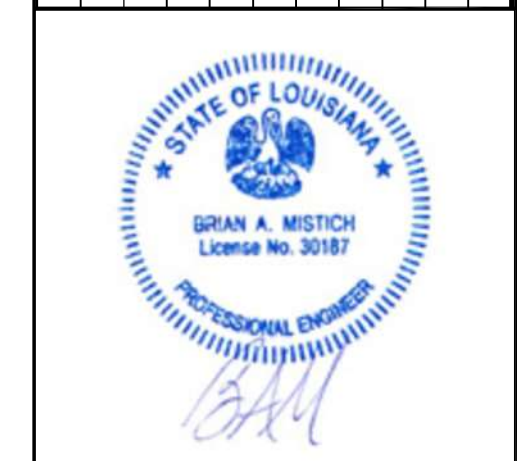

RENOVATION SUITE 3
SOUTHERN AMBIT
INSURANCE

107 SOUTH MILITARY RD.
 SLIDELL, LA 70461
 JOB No: 2021 DATE: 02-09-2022
 DRAWN BY: JMS CHECKED BY: CKD

SHEET TITLE:
EXISTING SITE PLAN

DRAWING NUMBER:
C101

SHEET No: 3 of 7