

FILE NAME: C:\Users\jms\OneDrive\Desktop\Drawings\2022\C101 - Site Plan.dwg DATE: 04/20/2022 10:45:14 AM

BOSWORTH STREET
N00°03'49"E 65.00'

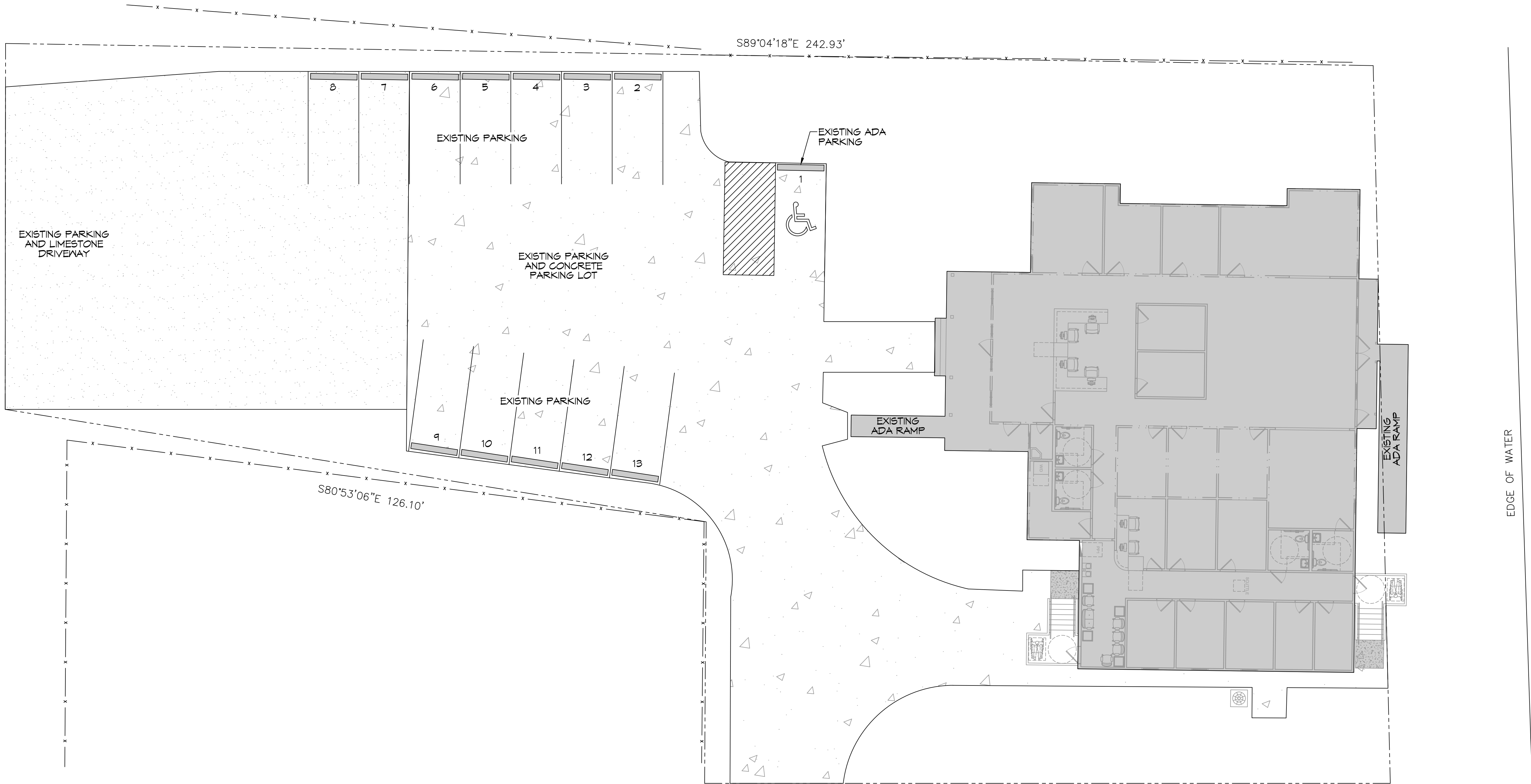

6 EXISTING SITE PLAN
SCALE: 1" = 10'-0"

PLANNING
ZONED G-2 COMMERCIAL DISTRICT
PARKING
MEDICAL AND DENTAL OFFICES AND CLINICS - 1 SPACE/DOCTOR'S OFFICE PLUS 1.5 SPACE/EXAMINING ROOM. = 14 REQUIRED = 15 PROVIDED

DAMMON ENGINEERING, INC.
LOUISIANA & MISSISSIPPI

Chief Engineer: Brian Misch, PE
554 Old Spanish Trail
Slidell, LA 70468
www.dammonengineering.com
info@dammonengineering.com
PH: 985.649.9832

#	DESCRIPTION	DATE



LSO LUTATIONS

54634 BOSWORTH ST.
SLIDELL, LA 70468

JOB No: DATE: 04-20-2022
DRAWN BY: JMS
CHECKED BY: JMS

SHEET TITLE:
SITE PLAN

DRAWING NUMBER:
C101

SHEET No: 3 of 12