

FILE NAME: J:\Projects\1818\1818.dwg PLOT DATE: 10/26/21 PLOT TIME: 10:06:21 AM

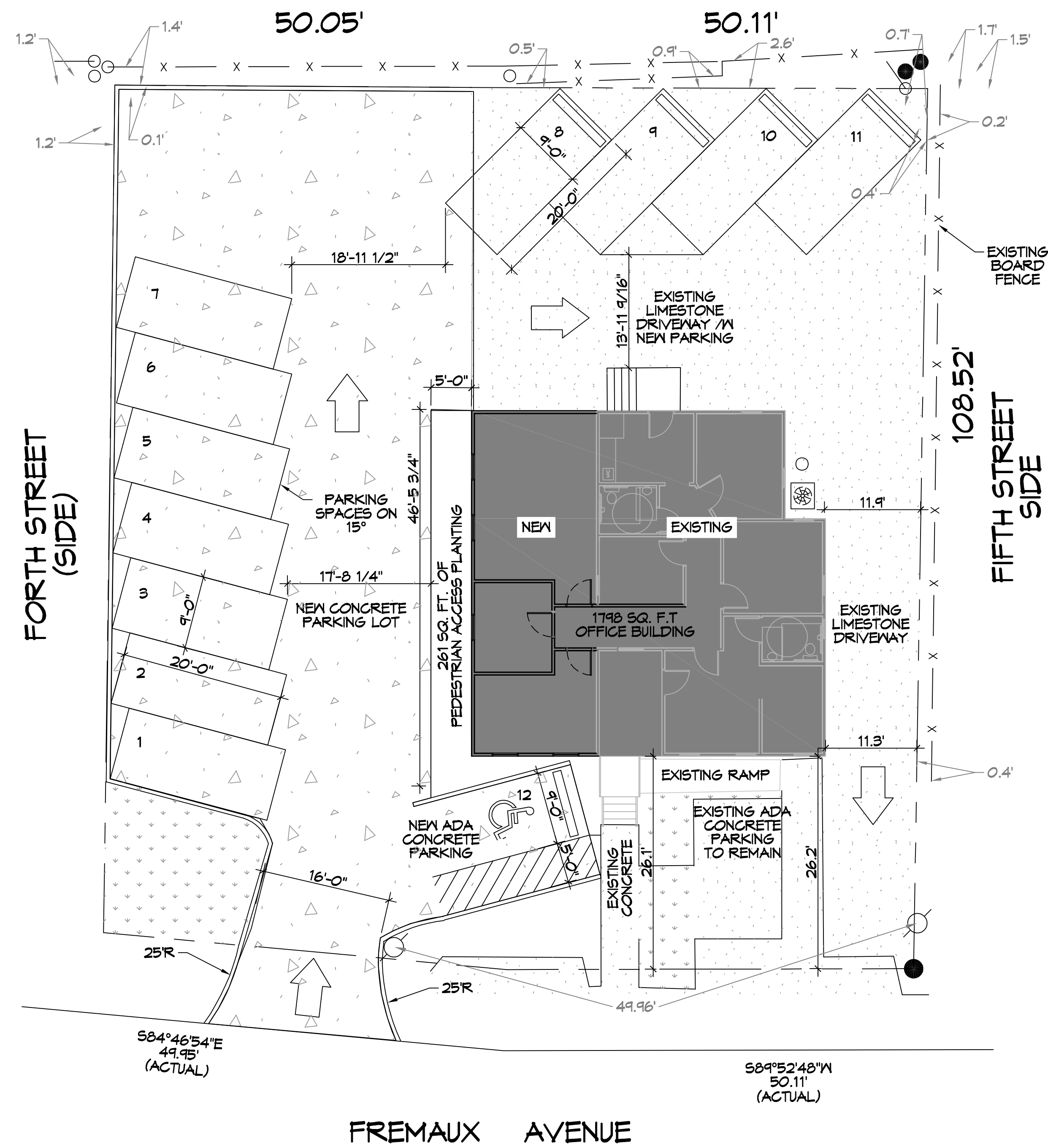

PLANNING
ZONED: G-2 COMMERCIAL DISTRICT
FLOOD ZONE
ZONE: "AE"
BUILDING ELEVATION
BASE FLOOD ELEVATION "AE" = 11.0' FINISHED FLOOR ELEVATION = 8.0'
PARKING
BUSINESS AND PROFESSIONAL OFFICES 1 SPACE FOR EACH 200 SQUARE FEET OF GROSS FLOOR AREA. 1798 / 200 = 9 PARKING REQUIRED = 9 ACTUAL PROVIDED = 12
SITE LIGHTING
EXTERIOR LIGHTING SHALL BE SHADED OR INWARDLY DIRECTED IN SUCH A MANNER SO THAT NO DIRECT LIGHTING OR GLARE BE CAST BEYOND THE PROPERTY LINE. THE INTENSITY OF SUCH LIGHTING SHALL NOT EXCEED ONE FOOT CANDLE AS MEASURED AT THE ADJUTING PROPERTY LINE.

DAMMON ENGINEERING, INC.
 LOUISIANA & MISSISSIPPI
 Chief Engineer: Brian Mistich, PE
 554 Old Spanish Trail
 Slidell, LA 70458
 www.dammonengineering.com
 info@dammonengineering.com
 PH: 985.449.9832

#	DESCRIPTION	DATE
1		

REVISIONS
 SEAL:

**FLEUR DE LIS
FIT COMPANY**
 442 FREMAUX AVE
 SLIDELL, LA 70458
 JOB No: 10-06-21
 DATE: 10-06-21
 DRAWN BY: JMS
 CHECKED BY: C&D

SHEET TITLE:
 SITE PLAN
 DRAWING NUMBER:
C101
 SHEET No: 3 of 1