

894 ROBERT BOULEVARD  
SLIDELL, LOUISIANA 70458  
PH: 504-643-2427  
FAX 504-643-2691  
ROTOLDBROTOLOCONSULTANTS.COM

**THE WOODLANDS APT. HOMES**  
PROVIDENT REALTY ADVISORS  
CHALMETTE, LA

Copyright 2011 Rotolo Consultants Inc.  
These drawings or parts thereof, may not be reproduced in any form, by any method, for any purpose, without prior written consent from Rotolo Consultants Inc.  
Contact: Rod Rotolo 985.643.2427  
Project No:

Revisions:		
No.	Date:	Description:

Date: 05/31/2011  
Drawn: BCF  
Checked:  
Sheet Title:

**POOL SITE PLAN**

Drawing No.  
**PL1.0**  
Sheet No.  
Of:

**POOL INFORMATION:**  
POOL AREA: ± 936 SF  
POOL PERIMETER: ± 156 LF  
POOL AVG. DEPTH: ± 4'  
POOL VOLUME: ± 28,010 GAL  
POOL TURNOVER: ± 78 GPM  
DECK AREA: ± 2,542 SF

**GENERAL NOTES:**

- 1) ALL PLUMBING SHALL BE SCH40 PVC, NSF APPROVED FOR POTABLE WATER.
- 2) DURING CONSTRUCTION, POOL AREA SHALL BE FENCED WITH 3'-4" ORANGE SAFETY FENCE.
- 3) ALL EQUIPMENT SHALL BE TESTED AND WORKING PROPERLY BEFORE HANDOFF TO OWNER IS COMPLETE.
- 4) PLUMBING LAYOUTS ARE SCHEMATIC AND FOR DIAGRAMMATIC PURPOSES ONLY. TO INSURE PROPER INSTALLATION, PROVIDE ADDITIONAL PLUMBING, FITTINGS OR VALVES NECESSARY FOR COMPLETION. ALL EQUIPMENT SHALL BE INSTALLED PER MANUFACTURER'S SPECS.
- 5) DECK HOSE BIB W/ VACUUM BRKR TO BE INSTALLED BY GENERAL CONTRACTOR.
- 6) POOL INITIAL FILL SOURCE WATER FROM HOSE BIB TIED TO CLUBHOUSE.
- 7) BACKWASH LINE TO BE TIED INTO STORM DRAINS.
- 8) AUTOFILL WILL BE TIED INTO THE IRRIGATION MAIN LINE.
- 9) DECK LIGHTING TO MEET ALL LOCAL HEALTH CODES BY GENERAL CONTRACTOR.
- 10) DECK RUNOFF AND SLOPING TO BE PER CODE.
- 11) BATHROOMS AND EMERGENCY PHONE TO BE LOCATED IN CLUBHOUSE.
- 12) ENTIRE POOL SYSTEM TO BE VGB COMPLIANT.
- 13) WATER VELOCITY NOT TO EXCEED 10 FPS FOR DISCHARGE PIPING AND 8 FPS FOR SUCTION.
- 14) FLOW METER, PRESSURE AND VACUUM GAUGES TO BE INSTALLED IN PUMP ROOM.
- 15) MAIN DRAIN GRATING AREA OF OPENING IS 4 TIMES GREATER THAN AREA OF DISCHARGE.
- 16) DEPTH MARKERS ON HORIZONTAL SURFACES TO BE SLIP RESISTANT. DEPTH MARKER SPACING NOT TO EXCEED 25' OR 2' INCREMENTS DEPTH CHANGE.
- 17) POOL FINISH TO BE WHITE SLIP RESISTANT PLASTER FINISH.
- 18) RCI TO INSTALL HANDICAP LIFT ANCHOR, ADA COMPLIANT LIFT BY OWNER
- 19) SELF-CLOSING GATE / SELF-CATCHING

**EQUIPMENT AREA NOTES:**

- 1) EQUIPMENT AREA SHALL BE PROTECTED FROM UNAUTHORIZED ENTRY.
- 2) THE EQUIPMENT AREA SHALL BE CONSTRUCTED OUT OF CONCRETE OR OTHER NON-ABSORBENT MATERIAL HAVING A SMOOTH SLIP-RESISTANT FINISH.
- 3) THE EQUIPMENT AREA SHALL BE SLOPED UNIFOMRLY TO A FLOOR DRAINAGE SYSTEM W/ SUMP PUMP IF NEEDED.
- 4) THE EQUIPMENT AREA SHALL HAVE A MINIMUM ACCESS OF 42".
- 5) CHEMICAL STORAGE SHALL BE PROTECTED FROM UNAUTHORIZED ENTRY AND PLACED IN A WELL VENTILATED AREA.
- 6) GFCI REQUIRED BY CODE IN EQUIPMENT ROOM
- 7) FILTER TO BE PENTAIR TR100C WITH 4.91 SF SURFACE AREA CAPABLE OF FILTERING AT 74 GPM.

**POOL ELECTRICAL NOTES:**

- 1) ALL ELECTRICAL WORK SHALL COMPLY WITH N.E.C. CODES, SIXTH EDITION 1996, AND LOCAL CITY AND PARISH CODES.
- 2) ALL STEEL REINFORCING IN CONCRETE TO BE BONDED BY ELECTRICIAN.
- 3) HANDICAP ANCHOR - LIFT TO BE PROVIDED BY OWNER
- 4) SWIMMING POOL LIGHTS SHALL PROVIDE A MINIMUM OF 1/2 WATT PER SQUARE FOOT OF POOL SURFACE AREA
- 5) ALL STEEL REINFORCING IN CONCRETE TO BE BONDED BY ELECTRICIAN.

**POOL SAFETY EQUIPMENT:**

- 1 - 8-16' TELEPOLE
- 1 - 22" COMM VACUUM HEAD
- 1 - PRO SERIES LEAF RAKE
- 1 - SKIMMER NET H.D. #128
- 1 - 18" METAL BACK BRUSH
- 1 - 1.5"x50' VAC HOSE
- 1 - CHEMICAL TEST KIT COMPLETE
- 1 - 24" WHITE RING BUGGY (CG APPROV.)
- 1 - 60' THROW LINE
- 1 - SAFETY LIFEHOOK
- 1 - BRASS WING BOLT-NUT #155
- 1 - 16' STRAIGHT POLE
- 1 - FIRST-AID KIT (COMMERCIAL GRADE)
- 1 - SIGN "POOL RULES"
- 1 - SIGN "NO DIVING ALLOWED"
- 1 - SIGN "WARNING NO LIFE GUARD"

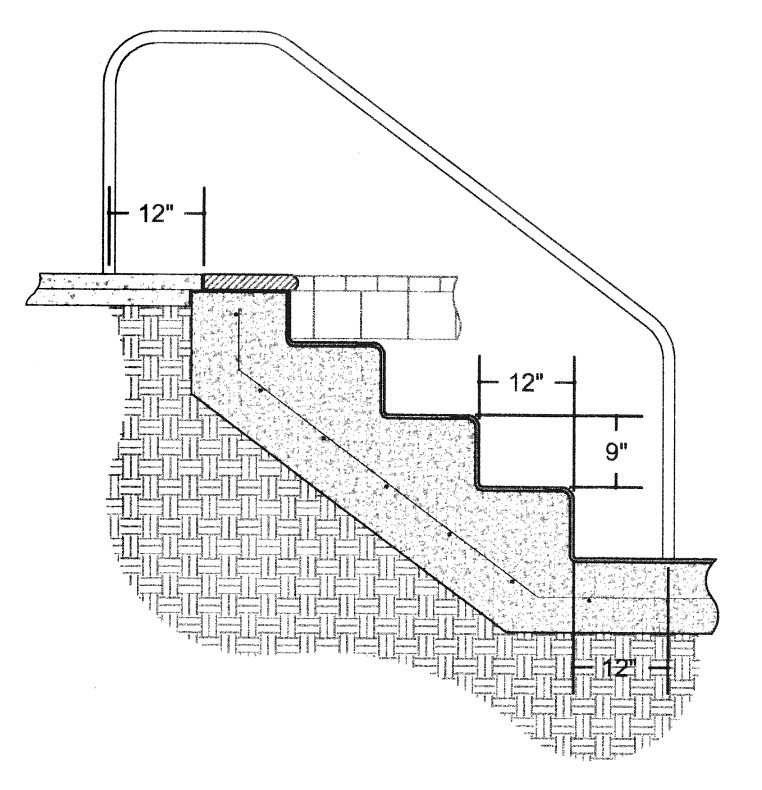

**4 POOL ENTRY DETAIL**  
SCALE: 1/2" = 1'-0"

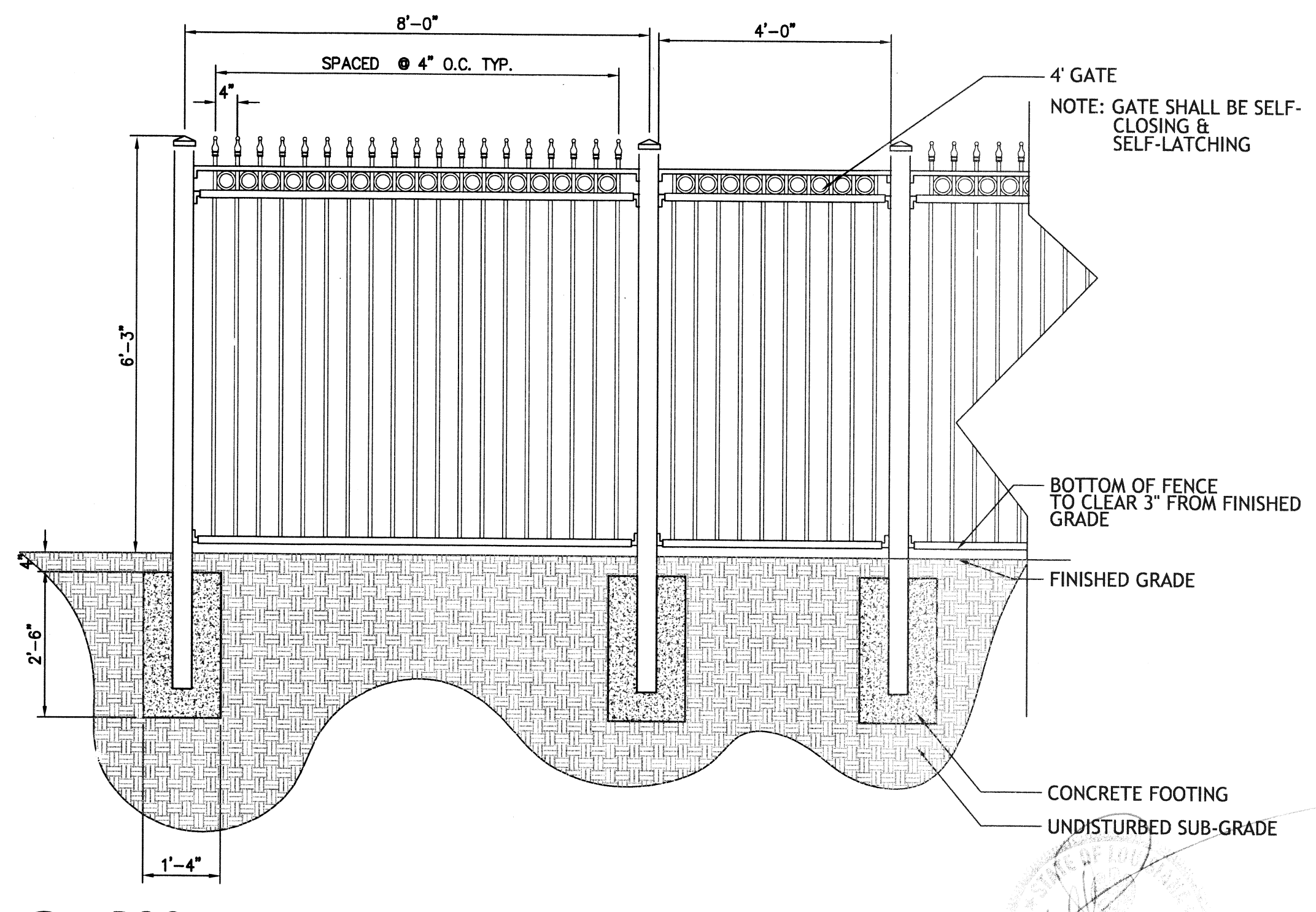

**3 POOL ENTRY DETAIL**  
SCALE: 1/2" = 1'-0"

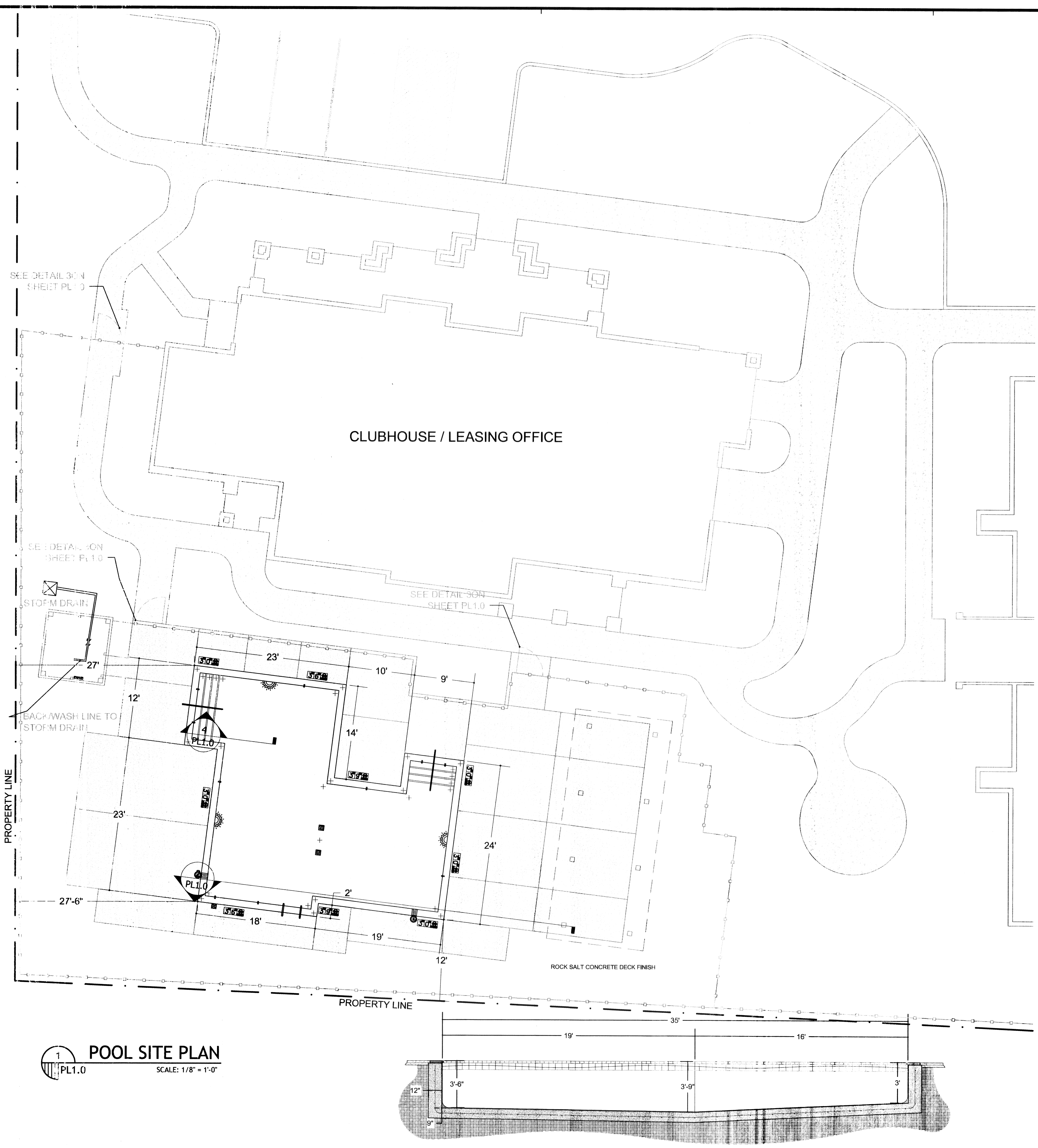

**1 POOL SITE PLAN**  
SCALE: 1/8" = 1'-0"

**2 POOL SECTION**  
SCALE: 1/4" = 1'-0"

FILE:-- XREFS:--