

DRAWN	
REVISED	
△ FIRE MARSHAL COMMENTS	04-01-09
△ COORDINATION	05-06-09
△ CLIENT COMMENTS	02-10-10

THE WOODLANDS
 APARTMENTS IN ST. BERNARD PARISH, LOUISIANA for
PROVIDENT REALTY ADVISORS

CONSTRUCTION ISSUE
 BEELER GUEST ARCHITECTS, INC.
 4245 N. CENTRAL EXPRESSWAY SUITE 300 DALLAS, TEXAS 75205 (214) 550-8878

DATE
01-30-09

PROJECT
08174

SHEET NUMBER
11.1
LEASING

BUILDING INFORMATION	
OCCUPANCY: A-3	
GROSS BLDG. AREA: 3,534 S.F.	
NET LEASABLE AREA: 2,752 S.F. A/C SPACE	
TYPE OF CONSTRUCTION:	V-B
OCCUPANCY CONTENT:	68
REQ'D EXITS:	2
FIRE SPRINKLERS:	NO
BREEZEWAY SPRINKLERS:	N/A
STAND PIPES:	NO
FIRE ALARMS:	YES
EMERGENCY LIGHTING:	YES
AGE OF BUILDING:	NEW
FIRE WALLS:	NO

HATCH INDICATES 5-1/2" BRICK LEDGE LOCATION

1 LEASING FLOOR PLAN
SCALE: 1/4" = 1'-0"

2,862 S.F. NET
3,643 S.F. GROSS

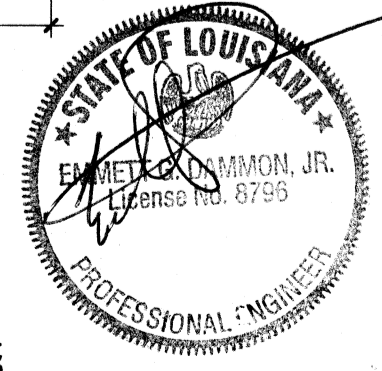
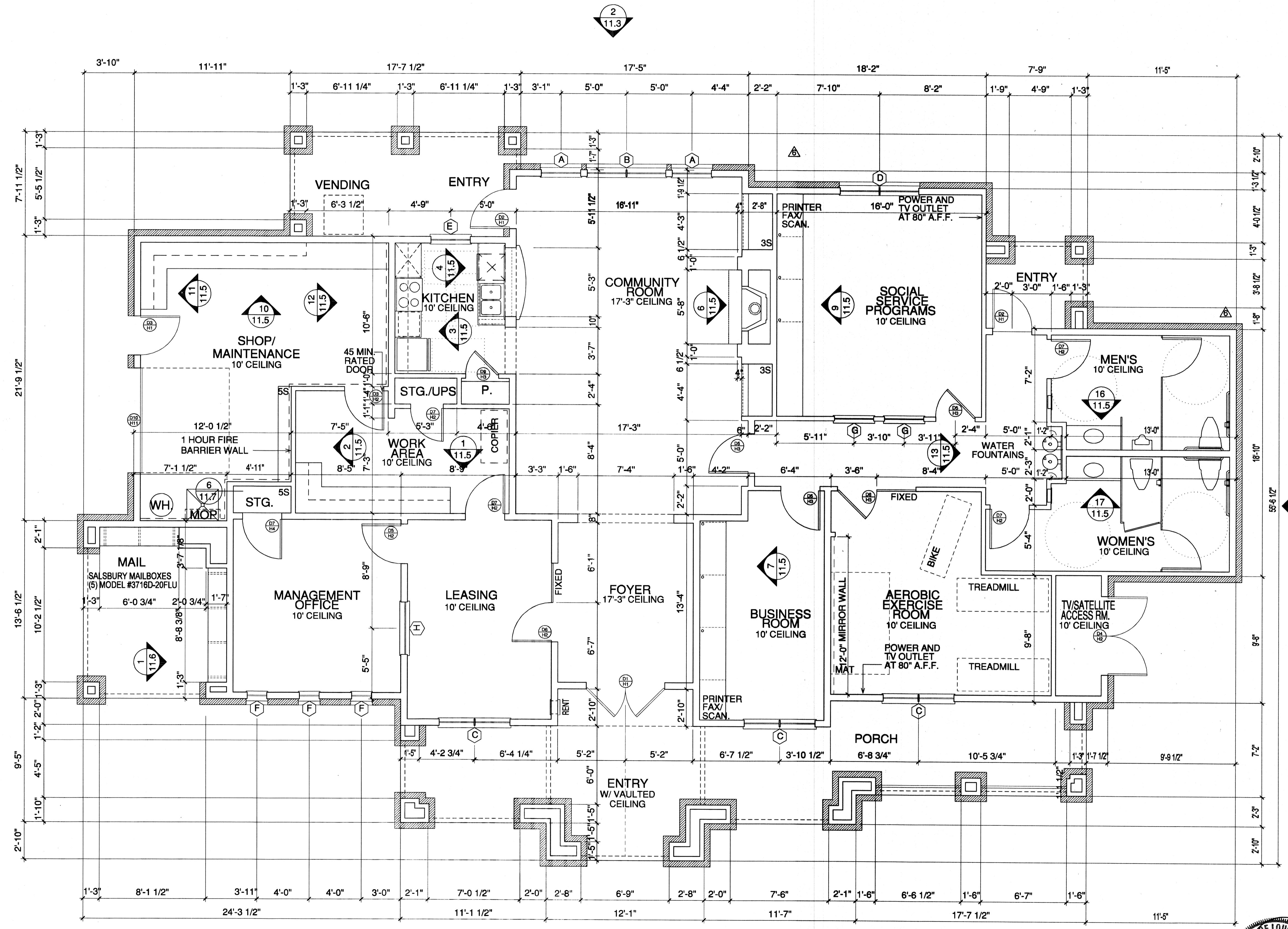

COPYRIGHT © Beeler Guest Architects, Inc. ALL RIGHTS RESERVED.