

894 ROBERT BOULEVARD
SLIDELL, LOUISIANA 70458
PH. 985-643-2427
FAX 985-643-2697
RROTULO@RROTULOCONSULTANTS.COM

APARTMENT HOMES BY TONTI
EDENBOURNE COURTS & GARDENS - WEST POOL
3312 EDENBOURNE AVE
METAIRIE, LOUISIANA 70002

Copyright 2016 © Rotolo Consultants Inc.
These drawings or parts thereof, may not be reproduced in any form, by any method, for any purpose, without prior written consent from Rotolo Consultants Inc.
Contact: Rod Rotolo 985-643-2427
Project No:

Revisions:		
No.	Date:	Description:
01	8-18-2016	BOH cmts addressed

Date: 6/21/2016
Drawn: TJH
Checked:

Sheet Title:
EXISTING POOL & DECK PLAN

Drawing No.

CI-1.0

Sheet No.
2 of 8

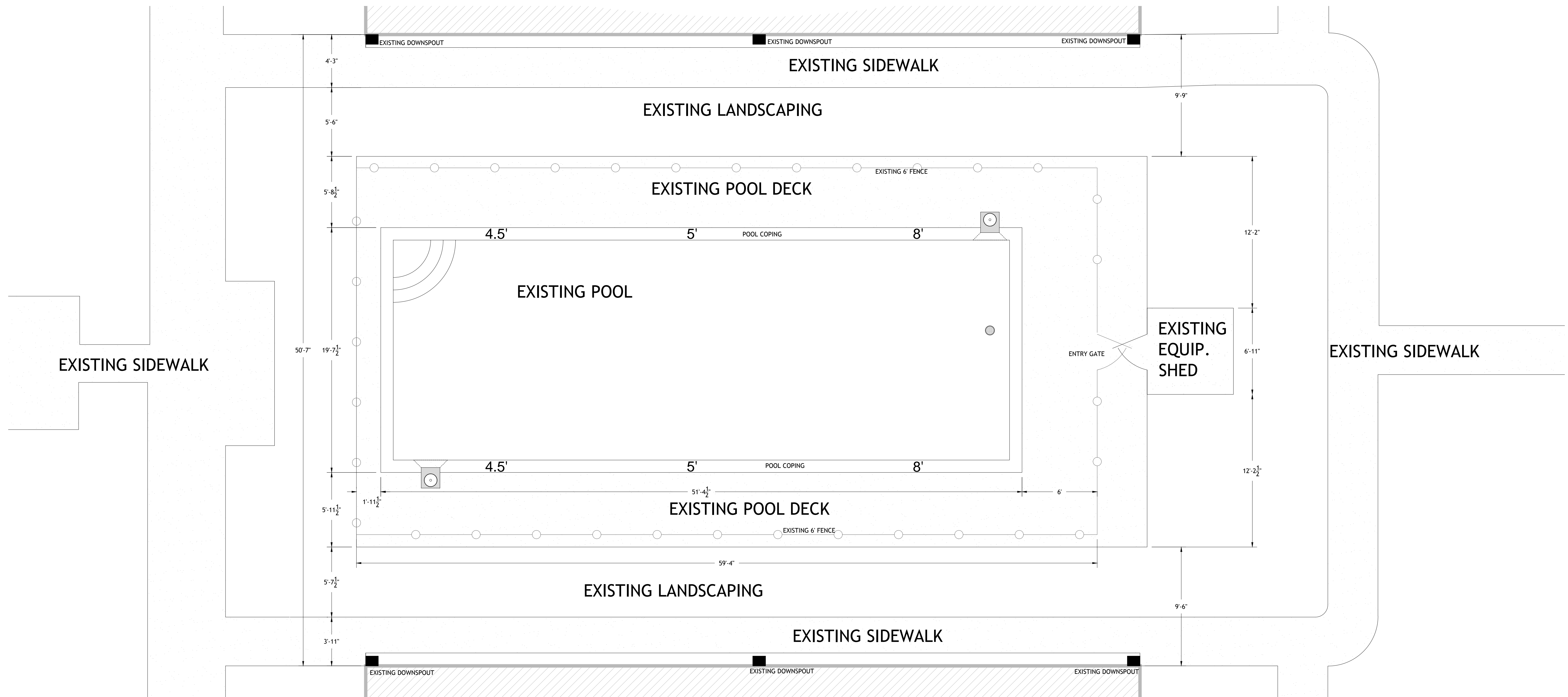

01
CI-1.0
EXISTING POOL & DECK CONDITIONS
SCALE: 1/4" = 1'-0"

SYMBOL IDENTIFICATION LEGEND

- EXISTING SKIMMER
- EXISTING DOWNSPOUT
- EXISTING MAIN DRAIN
- 4.5' EXISTING WATER DEPTH
- EXISTING POOL FENCE

- NOTES**
- ALL EXISTING POOL PIPING TO BE REMOVED AND REPLACED.
 - ORIGINAL POOL SHELL TO REMAIN, AND EXISTING SKIMMERS TO BE REMOVED. HOLES TO BE PUNCHED OR DRILLED AT 4' ON CENTER THROUGHOUT ENTIRE BOTTOM OF POOL.
 - POOL DECK AREA WITHIN THE EXISTING POOL FENCE LINE IS TO BE DEMOLISHED AND REMOVED ENTIRELY. IN ORDER TO RECONSTRUCT NEW POOL AND POOL DECK IN ACCORDANCE WITH THIS POOL PLAN SET.
 - EXISTING POOL FENCE WILL BE DEMOLISHED AND REMOVED ENTIRELY.
 - ONCE FENCE IS REMOVED, SAFETY BARRIERS SHALL IMMEDIATELY BE PLACED TO RESTRICT ACCESS TO THE AREA UNDER CONSTRUCTION / DEMOLITION UNTIL FENCE IS REINSTALLED IN NEW LOCATION PER THIS PLAN SET, AND CONSTRUCTION IS COMPLETED.
 - EXISTING EQUIPMENT SLAB IS TO BE DEMOLISHED, INCLUDING THE SHED STRUCTURE WHICH HOUSES THE POOL EQUIPMENT.
 - THE EXISTING POOL DECK SHALL BE SAW CUT WHERE POOL DECK PAVING IS SHARED WITH SIDEWALK PAVING. ALL SAW CUTS TO BE DETERMINED IN THE FIELD.
 - A CONSTRUCTION JOINT SHALL THEN BE PLACED TO ALLOW FOR NEW POOL DECKING TO BE POURED IN PLACE.

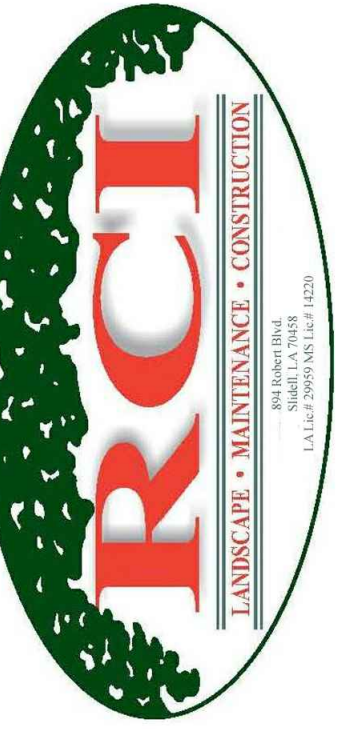

894 ROBERT BOULEVARD
SLIDELL, LOUISIANA 70458
PH: 985-643-2427
FAX 985-643-2691
RROTOL@ROTOLOCONSULTANTS.COM

APARTMENT HOMES BY TONTI

EDENBOURNE COURTS & GARDENS - WEST POOL
3312 EDENBOURNE AVE
METAIRIE, LOUISIANA 70002

Copyright 2016 Rotolo Consultants Inc.
These drawings or parts thereof, may not be reproduced in any form, by any method, for any purpose, without prior written consent from Rotolo Consultants Inc.
Contact: Rod Rotolo 985-643-2427
Project No:

Revisions:		
No:	Date:	Description:
01	8-18-2016	BORH cmts addressed

Date: 6/21/2016

Drawn: TJH

Checked:

Sheet Title:

POOL DECK GRADING / DECK JOINT LAYOUT PLAN

Drawing No:

CI-1.1

3 of 8

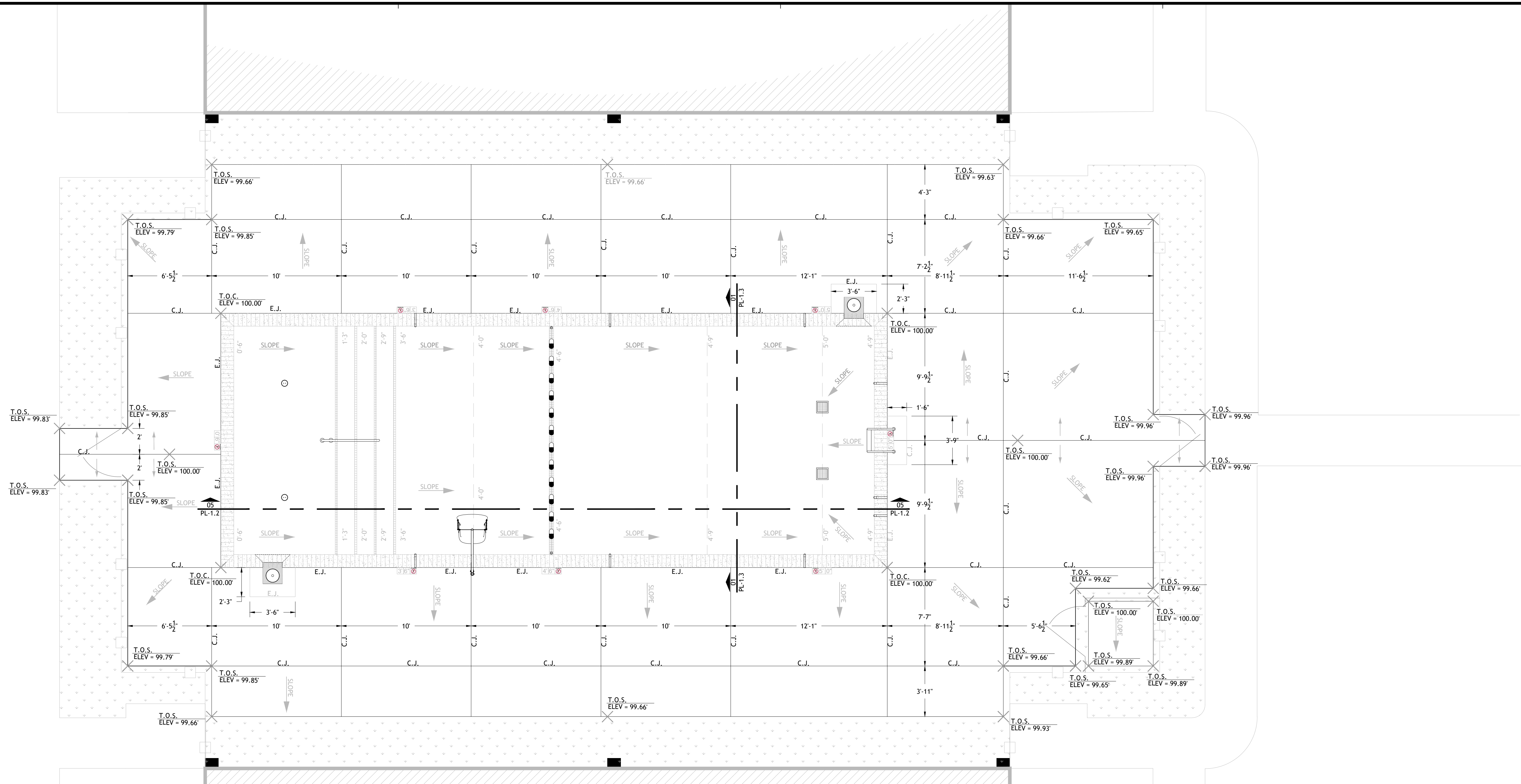

01 POOL AND POOL DECK LAYOUT & GRADING PLAN
PL-1.0 SCALE: 1/4" = 1'-0"

SYMBOL IDENTIFICATION LEGEND

- ADA POOL LIFT PER CODE
- EXISTING SKIMMER
- EXISTING DOWNSPOUT
- 9X9 MAIND DRAIN (VGB AND NSF COMPLIANT)
- 1.90" O.D. S.S. HANDRAIL PER CODE
- ADJUSTABLE FLOOR INLET
- EXISTING POOL FENCE
- DECK DEPTH MARKERS
- EXPANSION JOINT
- CONTROL JOINT
- INDICATES SLOPE DIRECTION
- TOP OF COPING
- TOP OF SLAB
- POOL LADDER

NOTES

1. ALL ARROWS SHOWN ON THIS PLAN VIEW INDICATE SLOPE DIRECTION.
2. ALL SLOPES WITHIN THE POOL SHALL NOT EXCEED 1:12 (MAXIMUM SLOPE FOR DEEP END SHALL BE 3:12), AND SHALL AT LEAST BE 1/8" PER FOOT MINIMUM.
3. ALL SLOPES ON THE POOL DECK SHALL BE A MINIMUM OF 1/8" PER FOOT, AND A MAXIMUM OF 1/4" PER FOOT.
4. A SHEPARD'S HOOK (LIFE SAVING HOOK) ALONG WITH ONE 1/2" MINIMUM FIXED POLE SHALL BE PLACED ON THE FENCE WITH HOOKS, ALLOWING FOR EASY ACCESS. THE POLE AND HOOK SHALL BE LOCATED AS CLOSE TO THE CENTER OF THE POOL AS POSSIBLE ON THE POOL FENCE.
5. ALL FINISHED GRADES SHOWN ON PLAN REPRESENT TOP OF FINISHED SURFACE.
7. DRAINAGE SHALL RUN OFF CONCRETE PAVED SURFACES AS INDICATED, AND INTO SURROUNDING LANDSCAPING.

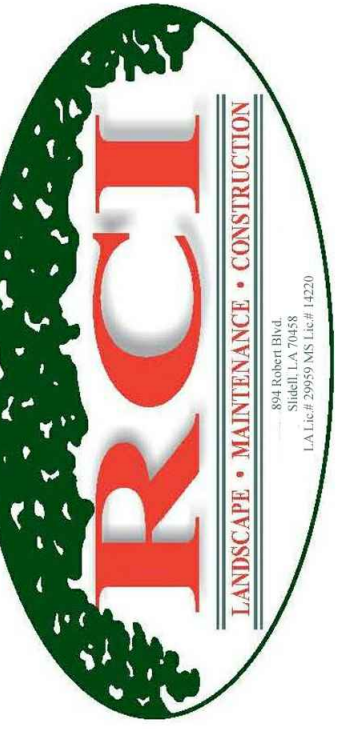

894 ROBERT BOULEVARD
SLIDELL, LOUISIANA 70458
PH: 985-643-2427
FAX: 985-643-2691
ROTOLO@ROTOLOCONSULTANTS.COM

APARTMENT HOMES BY TONTI

EDENBOURNE COURTS & GARDENS - WEST POOL
3312 EDENBOURNE AVE
METAIRIE, LOUISIANA 70002

Copyright 2016 © Rotolo Consultants Inc.
These drawings or parts thereof, may not be reproduced in any form, by any method, for any purpose, without prior written consent from Rotolo Consultants Inc.
Contact: Rod Rotolo 985-643-2427
Project No:

Revisions:		
No.	Date:	Description:
01	8-18-2016	BORH cmts addressed

Date: 6/21/2016

Drawn: TJH

Checked:

Sheet Title:

**POOL, &
POOL DECK
LAYOUT PLAN**

Drawing No.

PL-1.0

4 of 8

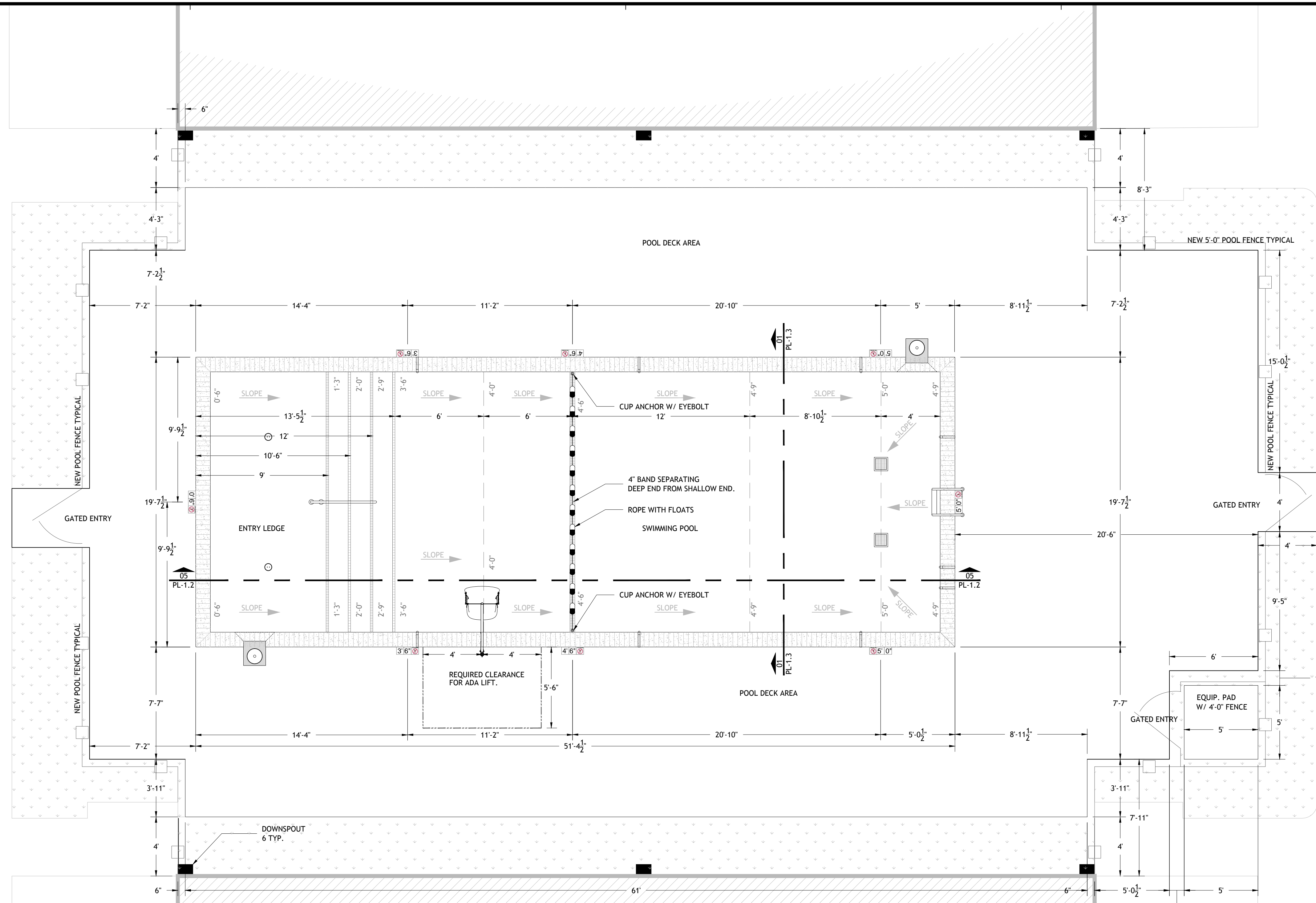

01 POOL AND POOL DECK LAYOUT & GRADING PLAN
PL-1.0 SCALE: 1/4" = 1'-0"

SYMBOL IDENTIFICATION LEGEND

- ADA POOL LIFT PER CODE
- EXISTING SKIMMER
- EXISTING DOWNSPOUT
- WATER DEPTH
- 9X9 MAIND DRAIN (VGB AND NSF COMPLIANT)
- 1.90" O.D. S.S. HANDRAIL PER CODE
- ADJUSTABLE FLOOR INLET
- EXISTING POOL FENCE
- DECK DEPTH MARKERS
- POOL LADDER

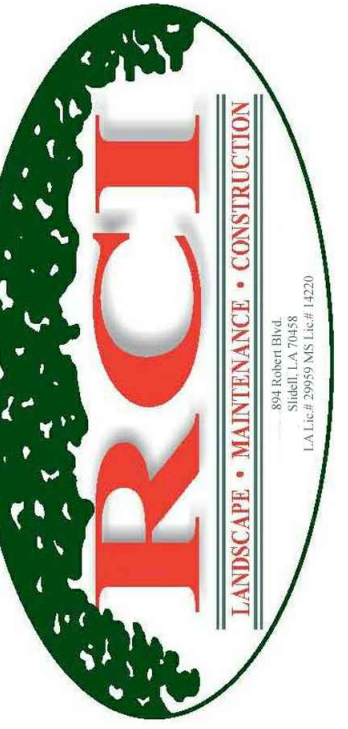

894 ROBERT BOULEVARD
SLIDELL, LOUISIANA 70458
PH: 985-643-2427
FAX 985-643-2691
ROTOLO@ROTOLOCONSULTANTS.COM

APARTMENT HOMES BY TONTI

EDENBOURNE COURTS & GARDENS - WEST POOL
3312 EDENBOURNE AVE
METAIRIE, LOUISIANA 70002

Copyright 2016 Rotolo Consultants Inc.
These drawings or parts thereof, may not be reproduced in any form, by any method, for any purpose, without prior written consent from Rotolo Consultants Inc.
Contact: Rod Rotolo 985-643-2427
Project No:

Revisions:		
No:	Date:	Description:
01	8-18-2016	BDR cmts addressed

Date: 6/21/2016

Drawn: TJH

Checked:

Sheet Title:

POOL PLUMBING PLAN

Drawing No:

PL-1.1

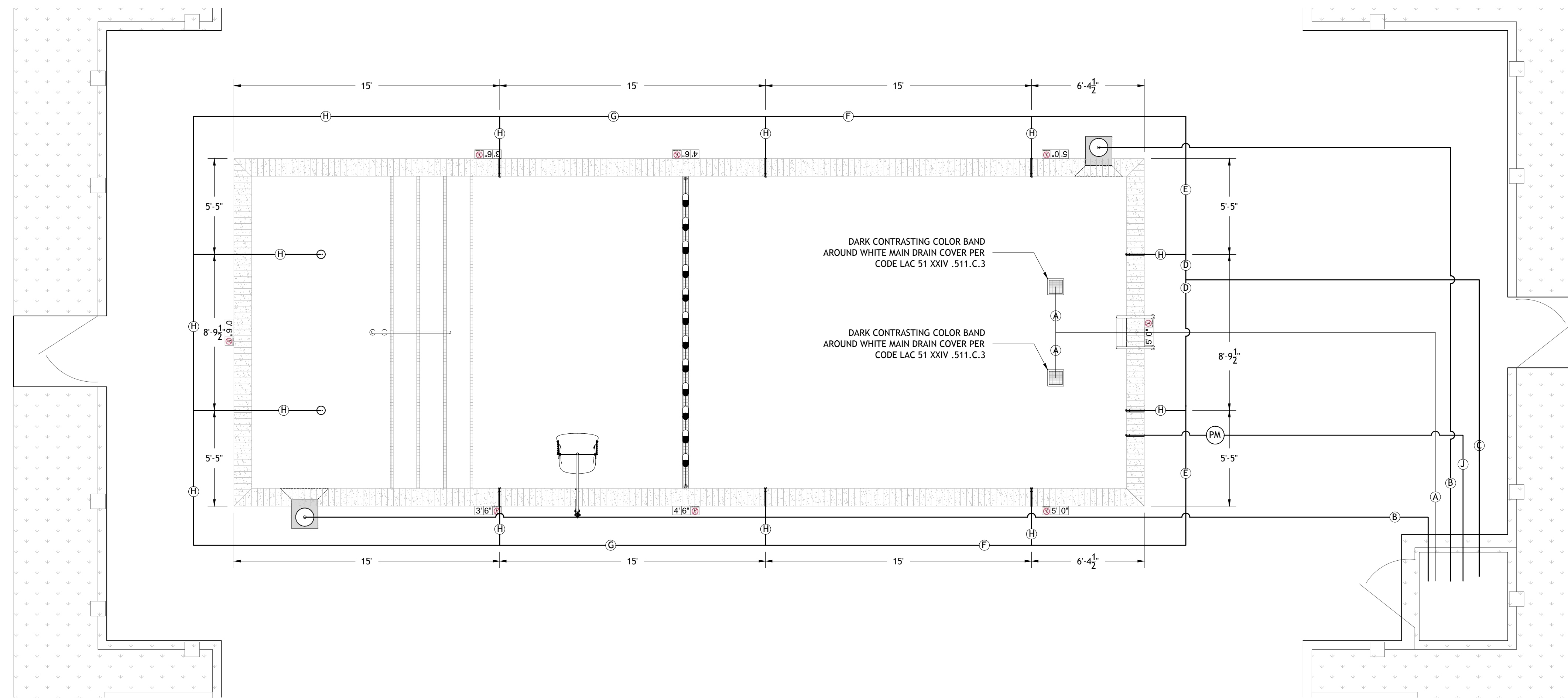

01 POOL PLUMBING LAYOUT PLAN
PL-1.1 SCALE: 1/4" = 1'-0"

SYMBOL IDENTIFICATION LEGEND

- ADA POOL LIFT PER CODE
- EXISTING SKIMMER
- EXISTING DOWNSPOUT
- WATER DEPTH
- 9X9 MAIND DRAIN (VGB AND NSF COMPLIANT)
- 1.90" O.D. S.S. HANDRAIL PER CODE
- ADJUSTABLE FLOOR INLET
- POOL INLET
- DECK DEPTH MARKERS
- POOL LADDER

PIPE SCHEDULE					
PIPE ID	DESCRIPTION	SIZE	TYPE	FLOW RATE	VELOCITY
A	MAIN DRAIN SUCTION	3.0 INCH	SCH 40 PVC	106 GPM	4.81 FPS
B	SKIMMER SUCTION	2.5 INCH	SCH 40 PVC	53 GPM	3.46 FPS
C	RETURN LINE 10 INLETS	2.5 INCH	SCH 40 PVC	106 GPM	6.93 FPS
D	RETURN LINE 5 INLETS	2.0 INCH	SCH 40 PVC	53 GPM	5.41 FPS
E	RETURN LINE 4 INLETS	2.0 INCH	SCH 40 PVC	42.4 GPM	4.33 FPS
F	RETURN LINE 3 INLETS	1.5 INCH	SCH 40 PVC	31.8 GPM	5.77 FPS
G	RETURN LINE 2 INLETS	1.5 INCH	SCH 40 PVC	21.2 GPM	3.85 FPS
H	RETURN LINE 1 INLET	1.5 INCH	SCH 40 PVC	10.11 GPM	4.13 FPS
J	FILL LINE	2.0 INCH	SCH 40 PVC	N/A	N/A

POOL DESIGN DATA	
WATER VOLUME =	23,966 GALLONS
TURNOVER RATE =	3.77 HOURS
FLOW RATE =	106 GPM
WATER SURFACE AREA =	870 SQ. FT.
POOL PERIMETER =	141 LN. FT.
TOTAL HEAD LOSS =	73.11 FT.
MAXIMUM BATHER LOAD =	34 PERSONS

- NOTES**
- ALL EXISTING POOL PIPING TO BE PRESSURE TESTED IN FULL ACCORDANCE WITH LAC TITLE 51 SWIMMING POOL CODE WHEN DETERMINING SUITABILITY TO BE USED, OR IF PLUMBING NEEDS TO BE REPLACED.
 - UPON INSTALLATION OF ALL PLUMBING, ALL PIPING SHALL BE PRESSURIZED IN ACCORDANCE WITH LAC TITLE 51 CODE REQUIREMENTS, AND REMAIN SO FOR THE DURATION OF THE CONSTRUCTION PROJECT.
 - ALL PLUMBING LINES ARE SHOWN ON PLAN FOR CLARITY, AND SHALL BE FIELD LOCATED AS NEEDED.

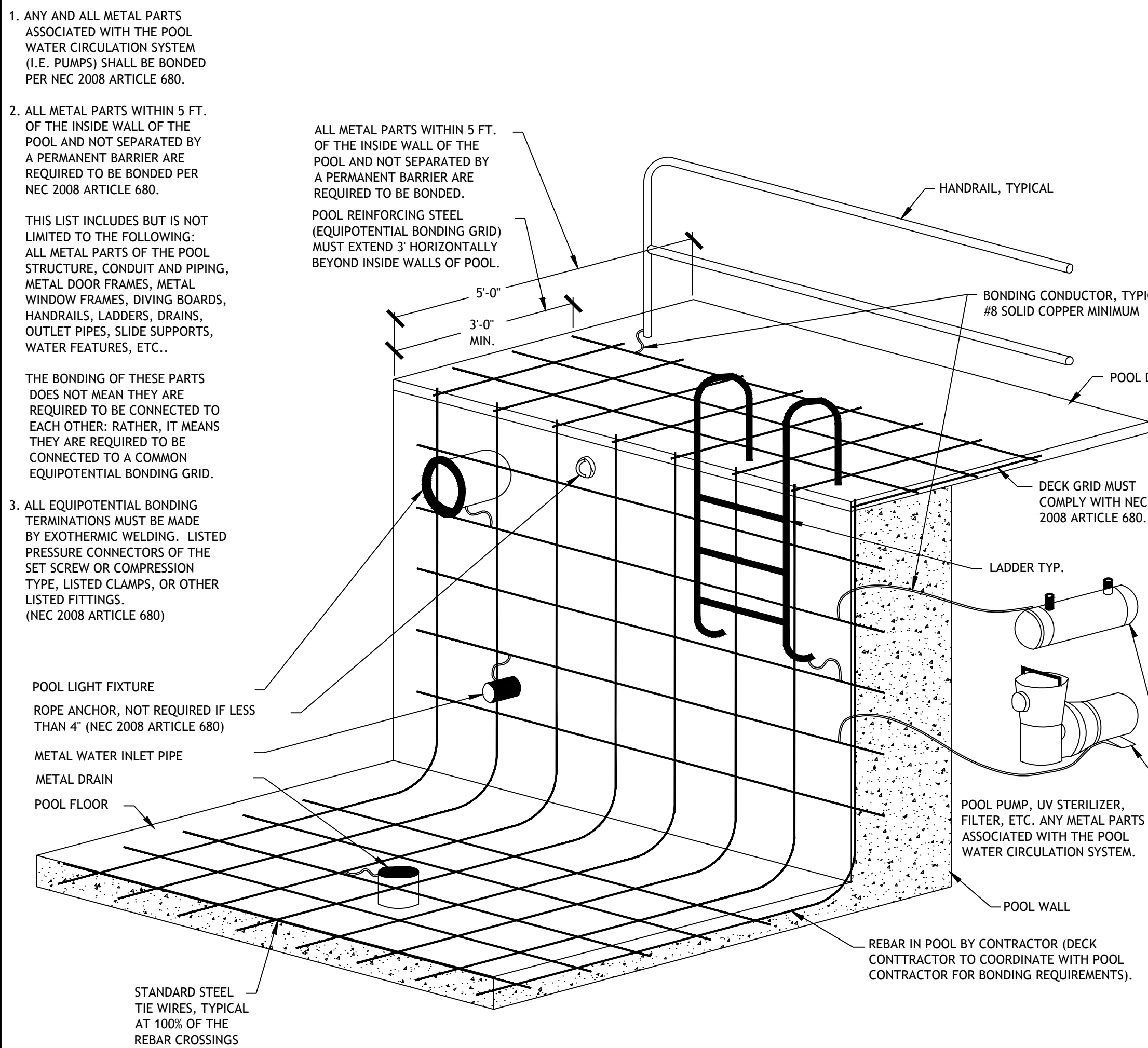

01 TYPICAL GROUNDING & BONDING DETAIL
PL-1.2 SCALE: NOT TO SCALE

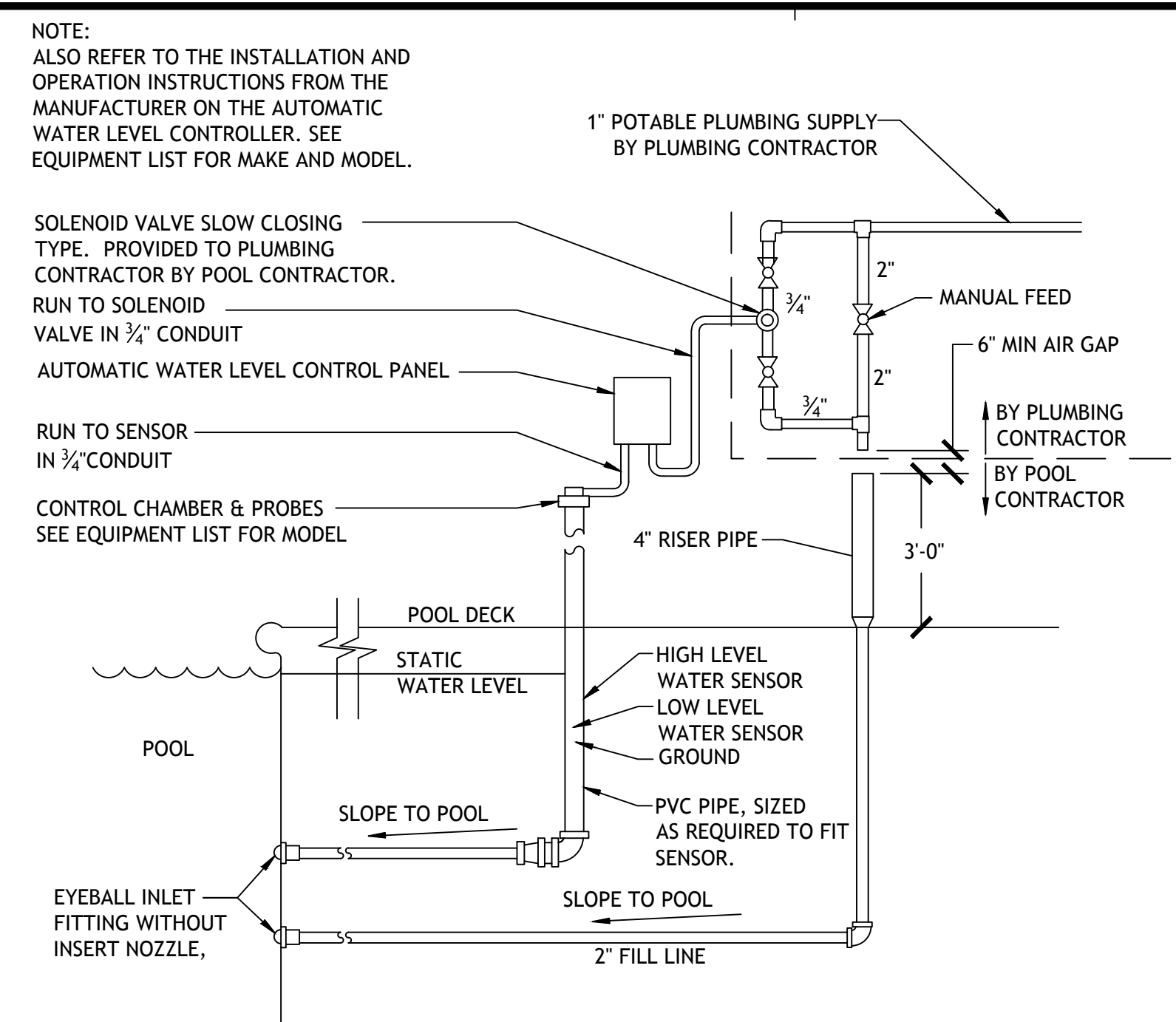

02 AUTOFILL DETAIL
PL-1.2 SCALE: NOT TO SCALE

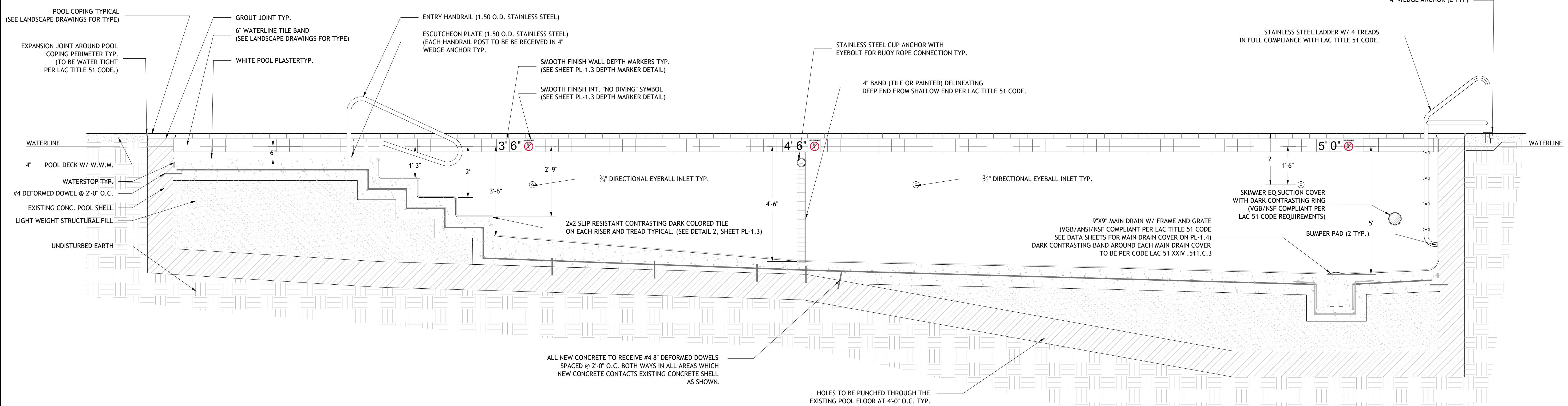
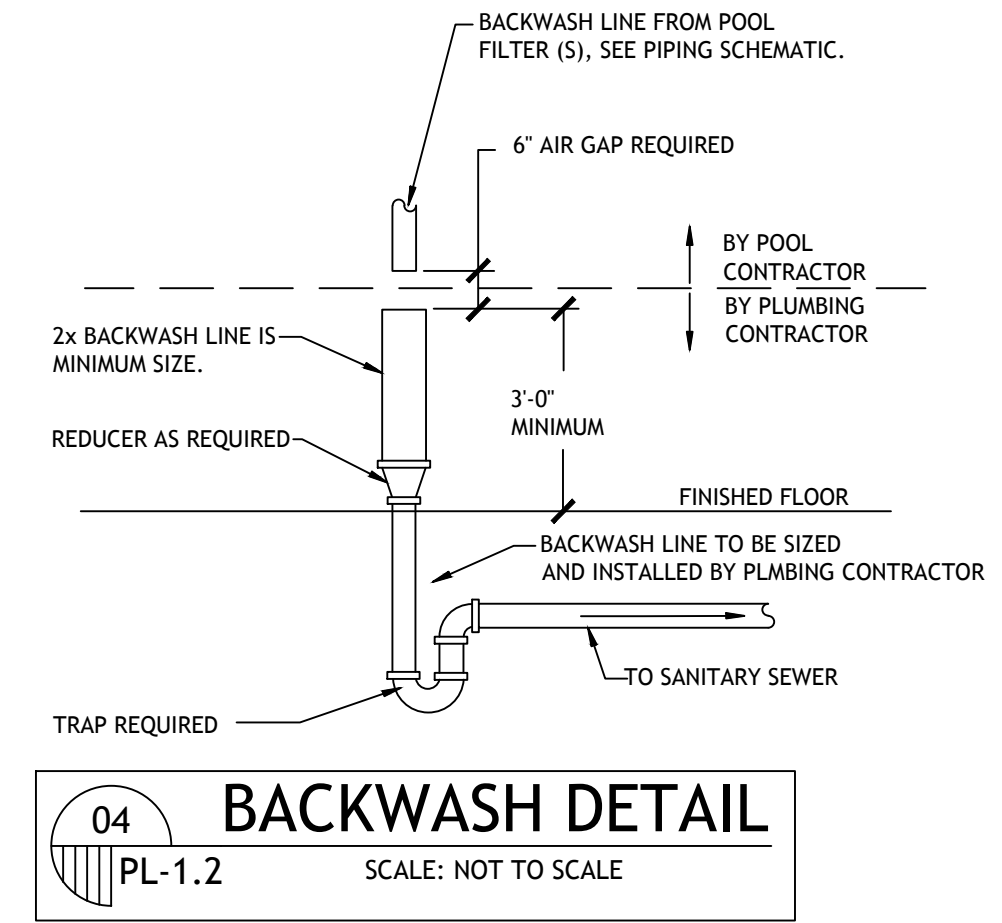
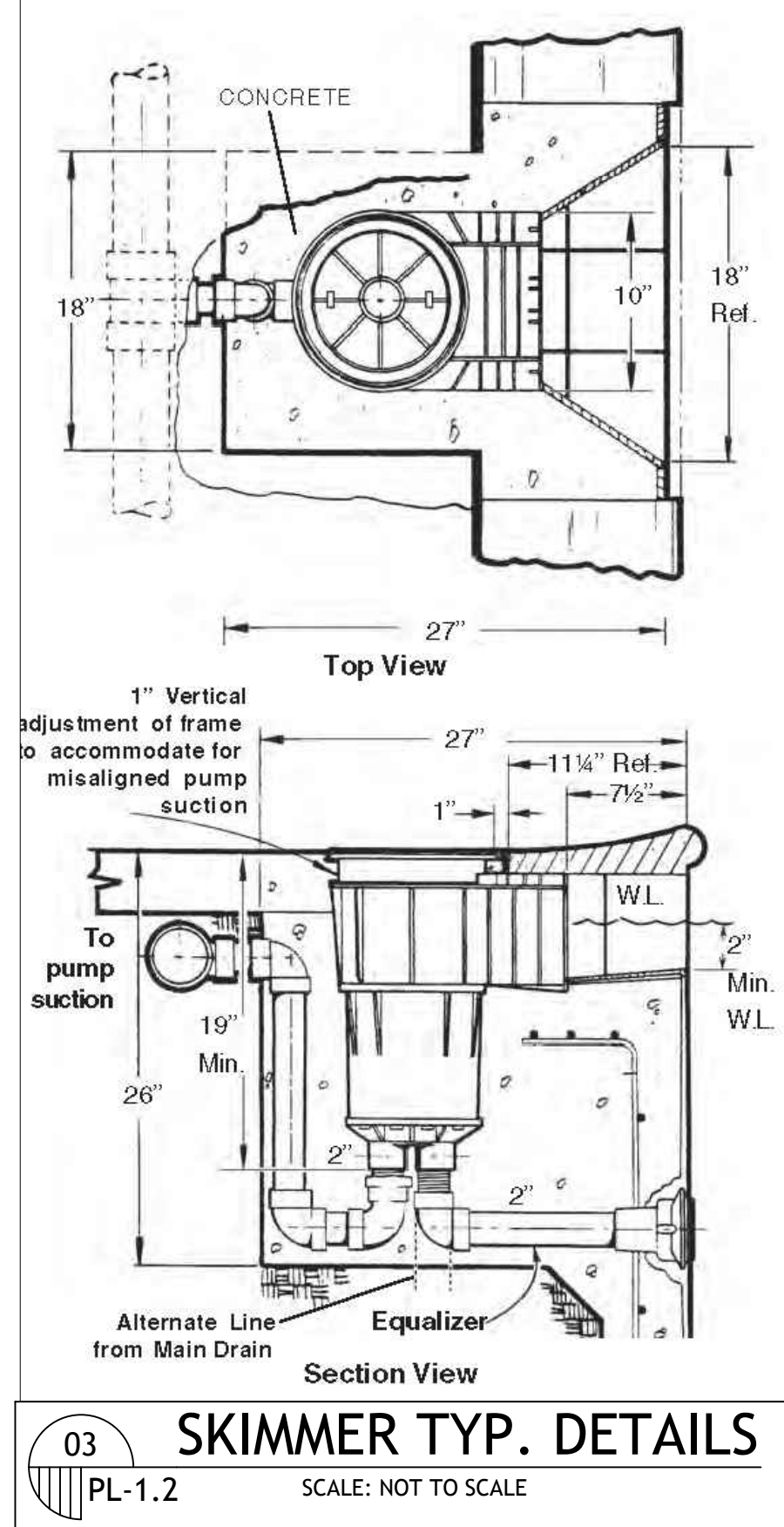

05 POOL CROSS SECTION
PL-1.2 SCALE: 1/2" = 1'-0"

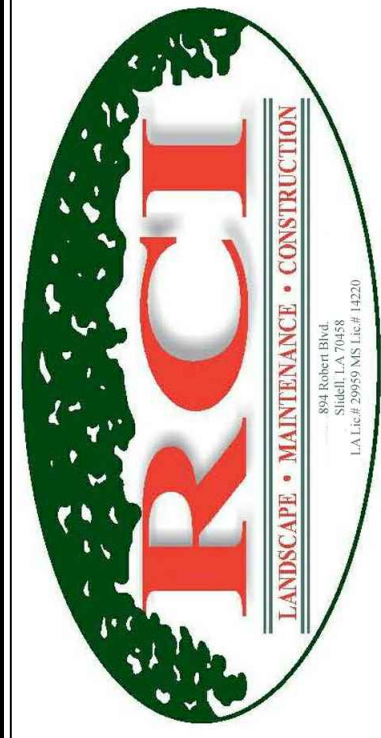

894 ROBERT BOULEVARD
SLIDEL, LOUISIANA 70458
PH: 985-643-2427
FAX: 985-643-2691
ROTOLO@ROTOLOCONSULTANTS.COM

APARTMENT HOMES BY TONTI
EDENBOURNE COURTS & GARDENS - WEST POOL
3312 EDENBOURNE AVE
METAIRIE, LOUISIANA 70002

Copyright 2016 RotoLo Consultants Inc.
These drawings or parts thereof, may not be reproduced in any form, by any method, for any purpose, without prior written consent from RotoLo Consultants Inc.
Contact: Rod RotoLo 985-643-2427
Project No:

Revisions:		
No.	Date:	Description:
01	8-18-2016	BOH cmts addressed

Date: 6/21/2016
Drawn: TJH
Checked:
Sheet Title:

POOL SECTIONS & TYPICAL DETAILS

Drawing No.
PL-1.2
Sheet No.
6 of 8

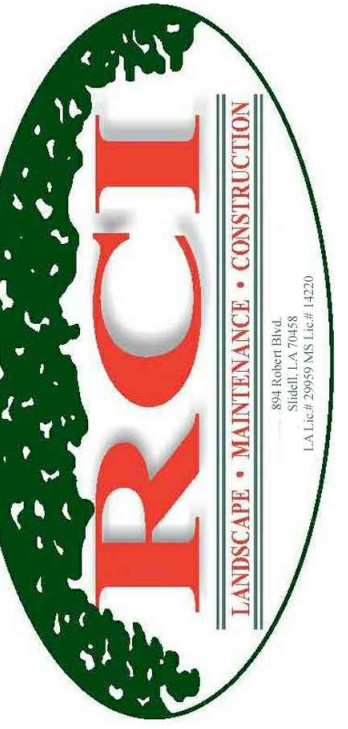

894 ROBERT BOULEVARD
SLIDELL, LOUISIANA 70458
PH: 985-643-2427
FAX: 985-643-2691
RROTOLO@ROTOCONSULTANTS.COM

APARTMENT HOMES BY TONTI

EDENBOURNE COURTS & GARDENS - WEST POOL
3312 EDENBOURNE AVE
METAIRIE, LOUISIANA 70002

Copyright 2016 © Rotolo Consultants Inc.
These drawings or parts thereof, may not be reproduced in any form, by any method, for any purpose, without prior written consent from Rotolo Consultants Inc.
Contact: Rod Rotolo 985-643-2427
Project No:

Revisions:		
No:	Date:	Description:
01	8-18-2016	BDR cmnts addressed

Date: 6/21/2016

Drawn: TJH

Checked:

Sheet Title:

POOL SECTIONS & TYPICAL DETAILS

Drawing No.

PL-1.3

7 of 8

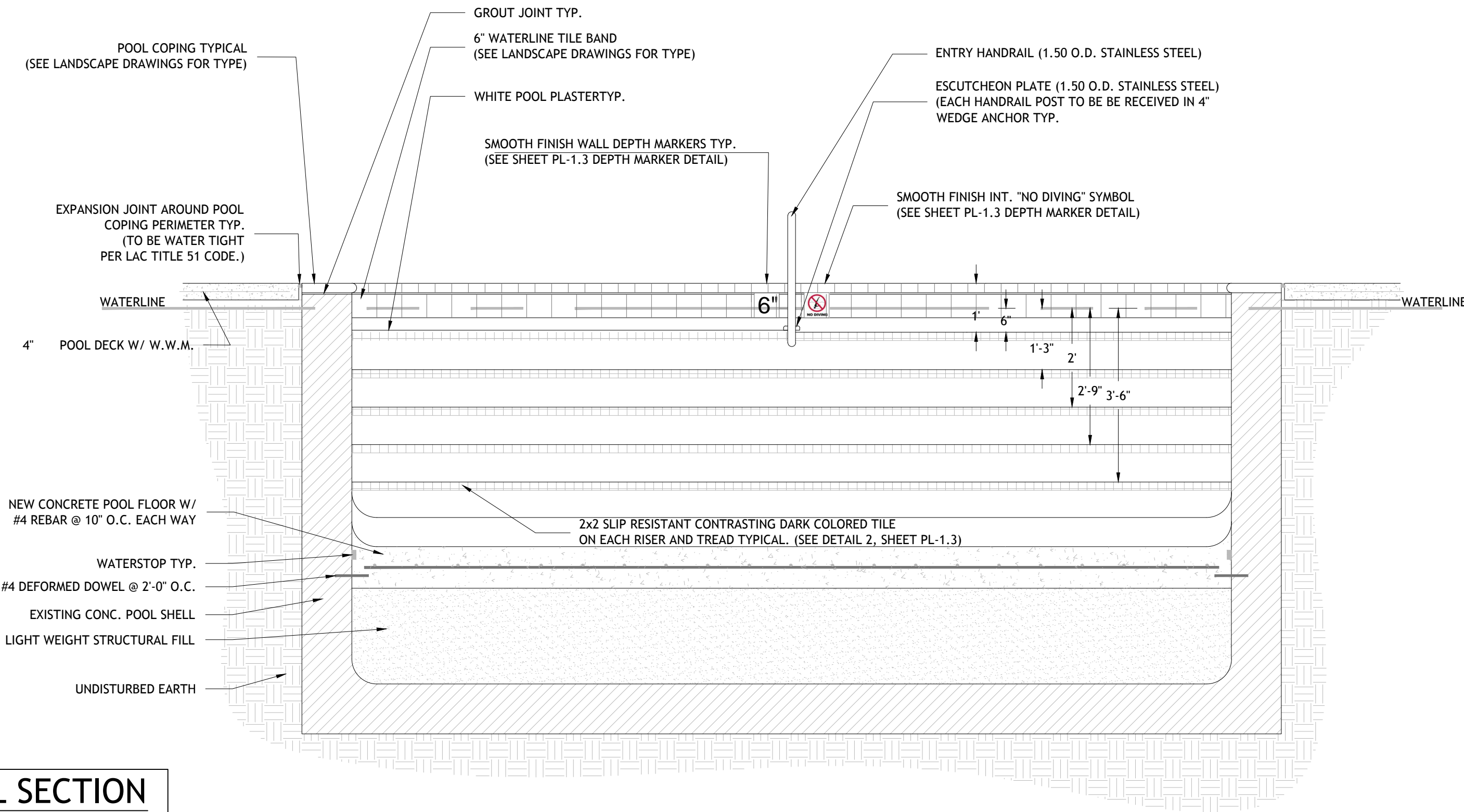

01 POOL SECTION
PL-1.3 SCALE: 1/2" = 1'-0"

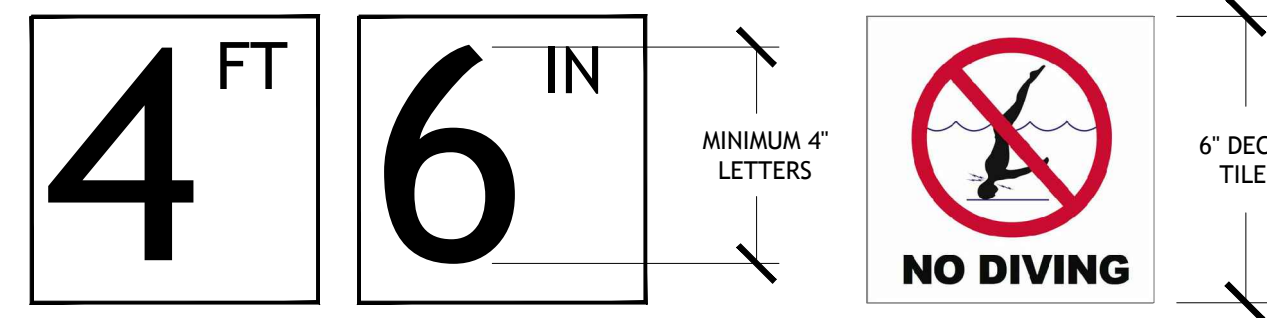

- DEPTH MARKERS**
MARKER REQUIREMENTS:
- DEPTH MARKERS BOTH SHOWING FEET AND INCHES
 - "NO DIVING" SYMBOL MARKER WITH EACH DEPTH MARKER.
- NOTES:
- DEPTH MARKERS SHALL BE PLACED ON THE DECK WITH SPACING NOT TO EXCEED 25'-0", NO MORE THAN 2 FOOT OF CHANGE IN SLOPE, AND TO ALSO PLACE A CORRESPONDING DEPTH MARKER IN DUPLICATE ON THE POOL WALL.
 - DECK TILES TO BE WITHIN 18" OF THE POOL WATER SURFACE
 - DECK TILES TO BE POSITIONED TO BE READ WHILE STANDING ON THE DECK FACING THE WATER.
 - DEPTH MARKERS TO BE IN ENGLISH.
 - NUMERICAL COLOR OF LETTERING TO BE BLACK, ON WHITE BACKGROUND.
 - "NO DIVING" INTERNATIONAL SYMBOL MARKER TO BE PLACED AT EVERY LOCATION WHERE A DEPTH MARKER IS LOCATED.
 - ALL DECK DEPTH MARKERS & NO DIVING SYMBOLS ARE TO HAVE A SLIP RESISTANT FINISH TYPICAL.
 - POOL WALL DEPTH MARKERS & NO DIVING SYMBOLS ARE TO HAVE A SMOOTH FINISH.

03 TYPICAL DEPTH MARKER DETAIL
PL-1.2 SCALE: NOT TO SCALE

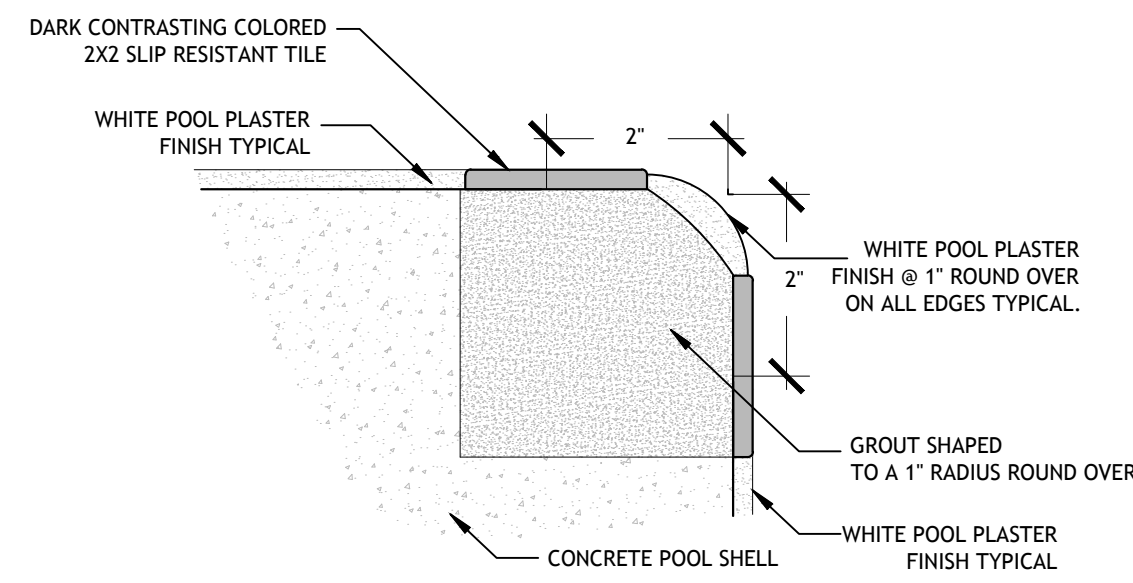

02 TRIM TILE DETAIL
PL-1.2 SCALE: NOT TO SCALE

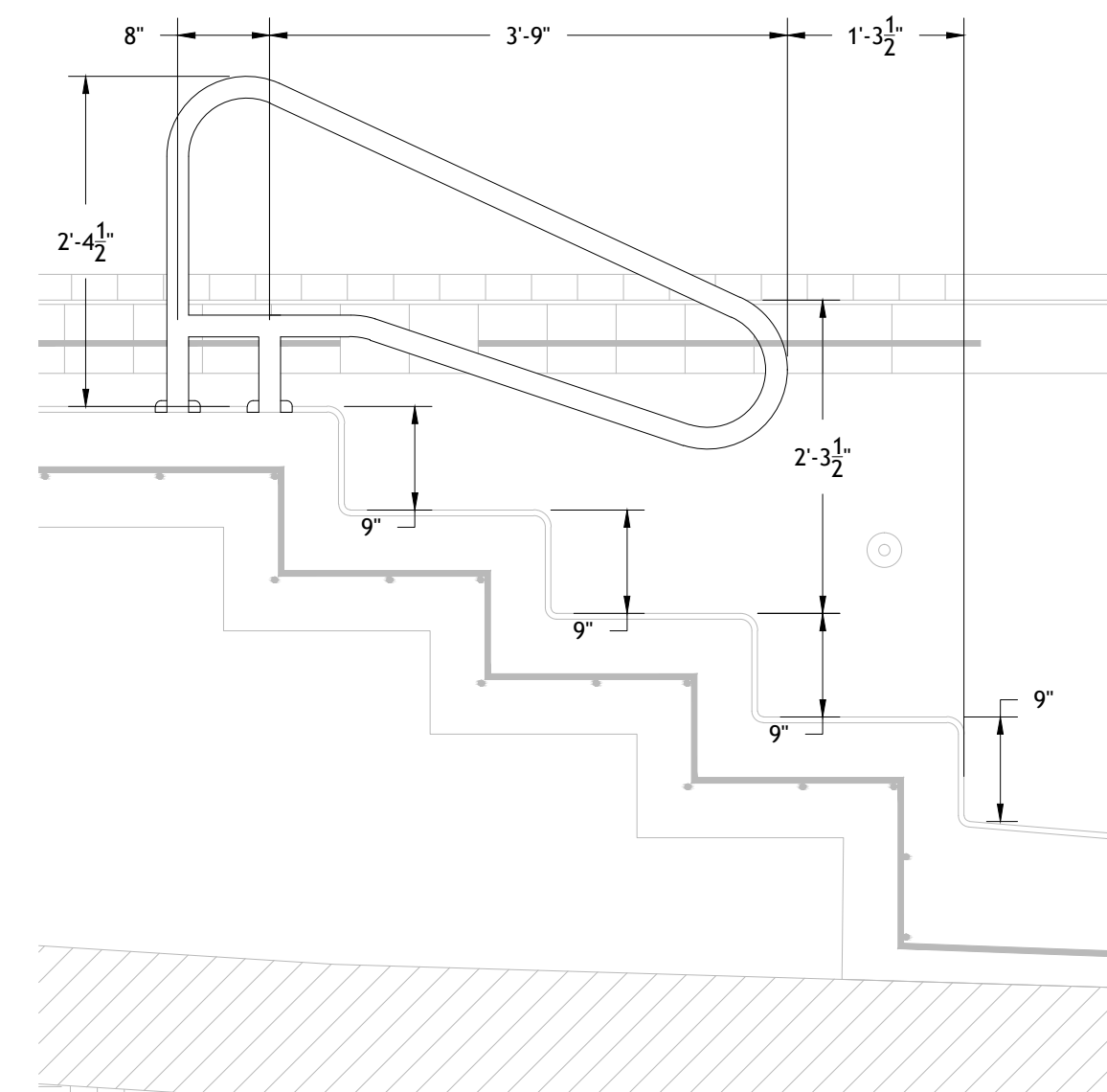

04 HAND RAIL DETAIL
PL-1.3 SCALE: 3/4" = 1'-0"

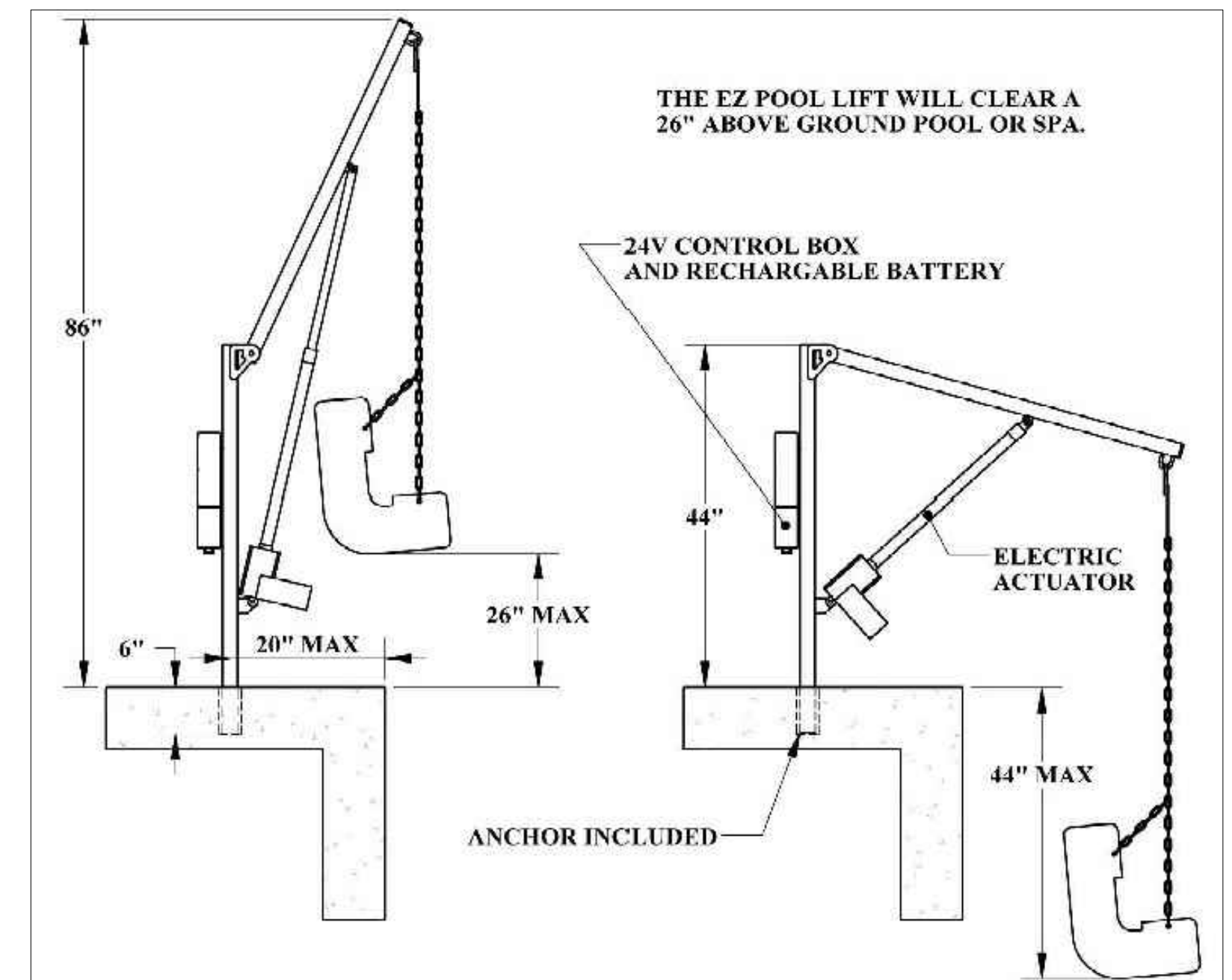

05 ADA POOL LIFT TYPICAL
PL-1.3 SCALE: NTS

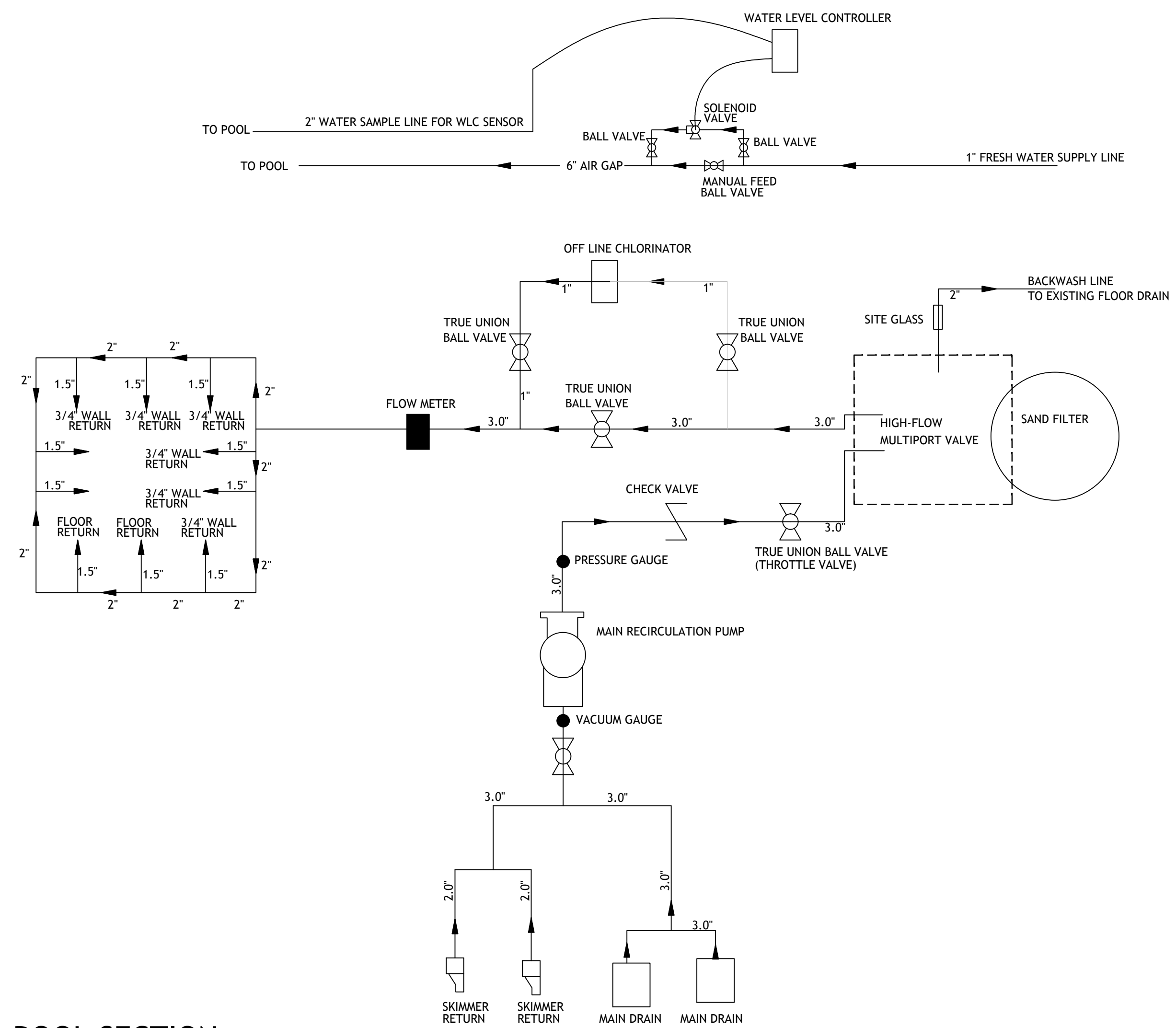

01 POOL SECTION
PL-1.3 SCALE: NO TO SCALE

POOL EQUIPMENT LEGEND

QTY	DESCRIPTION
1	TR-140 SAND FILTER BY PENTAIR
1	WHISPERFLO 3HP PUMP XFE-8 HIGH EFFICIENCY
1	HI-FLO MULTI-PORT VALVE (TO ACCEPT 2" PIPING)
2	9" MAIN DRAIN SUMP AND GRATE ASSEMBLY (NSF AND VGB COMPLIANT)
1	2.5" BLUE-WHITE IMPACT FLOW METER
1	RAINBOW CHLORINATOR MODEL #320 BY PENTAIR
5	SP1419D HAYWARD 3/4" DIRECTIONAL EYEBALL
7	HAY-25-1504 SP1022S INLET SLIP FITTING
2	U-3 SKIMMER
2	EQUALIZER SUCTION OUTLET COVER (NSF AND VGB COMPLIANT)
1	POOL MISER
2	TRUE-UNION BALL VALVES FOR PIPE SIZE 3" AND SMALLER
	SCH 40 PVC PIPE FOR ALL SUCTION, RETURN, AND EQUIPMENT ROOM PIPING
1	1.90" O.D. HANDRAIL, DMS-102 DECK MOUNTED
4	TREAD STAINLESS STEEL ECONOMY LADDER
1	TAYLOR TEST KIT K-2006 (DPD METHOD OF TESTING FOR CHLORINE RESIDUALS)
4	4" 1.90" WEDGE ANCHORS FOR HANDRAIL AND LADDER
4	1.90" O.D. ESCUTCHEONS FOR HANDRAIL AND LADDER
	1"X1 WATERLINE TILE (SEE HARDSCAPE PLAN FOR COLOR AND STYLE)
	2X2 KEYSTONE TILE FOR STEPS AND UNDERWATER BENCHES (SEE HARDSCAPE PLAN)
	6X6 DEPTH MARKERS, 4" BLACK LETTERING ON WHITE BACKGROUND (SLIP RESISTANT FINISH)
	6X6 INTERNATIONAL "NO DIVING" SYMBOL
	WHITE PLASTER

Hand & Stair Rails

Model	Material	Finish	Height	Length	Weight
DMS-102A	304 Stainless Steel	Brushed	42"	60"	15 lbs
DMS-102B	304 Stainless Steel	Polished	42"	60"	15 lbs
DMS-102C	304 Stainless Steel	Brushed	42"	90"	22 lbs
DMS-102D	304 Stainless Steel	Polished	42"	90"	22 lbs

05 HANDRAIL
PL-1.3 SCALE: NOT TO SCALE

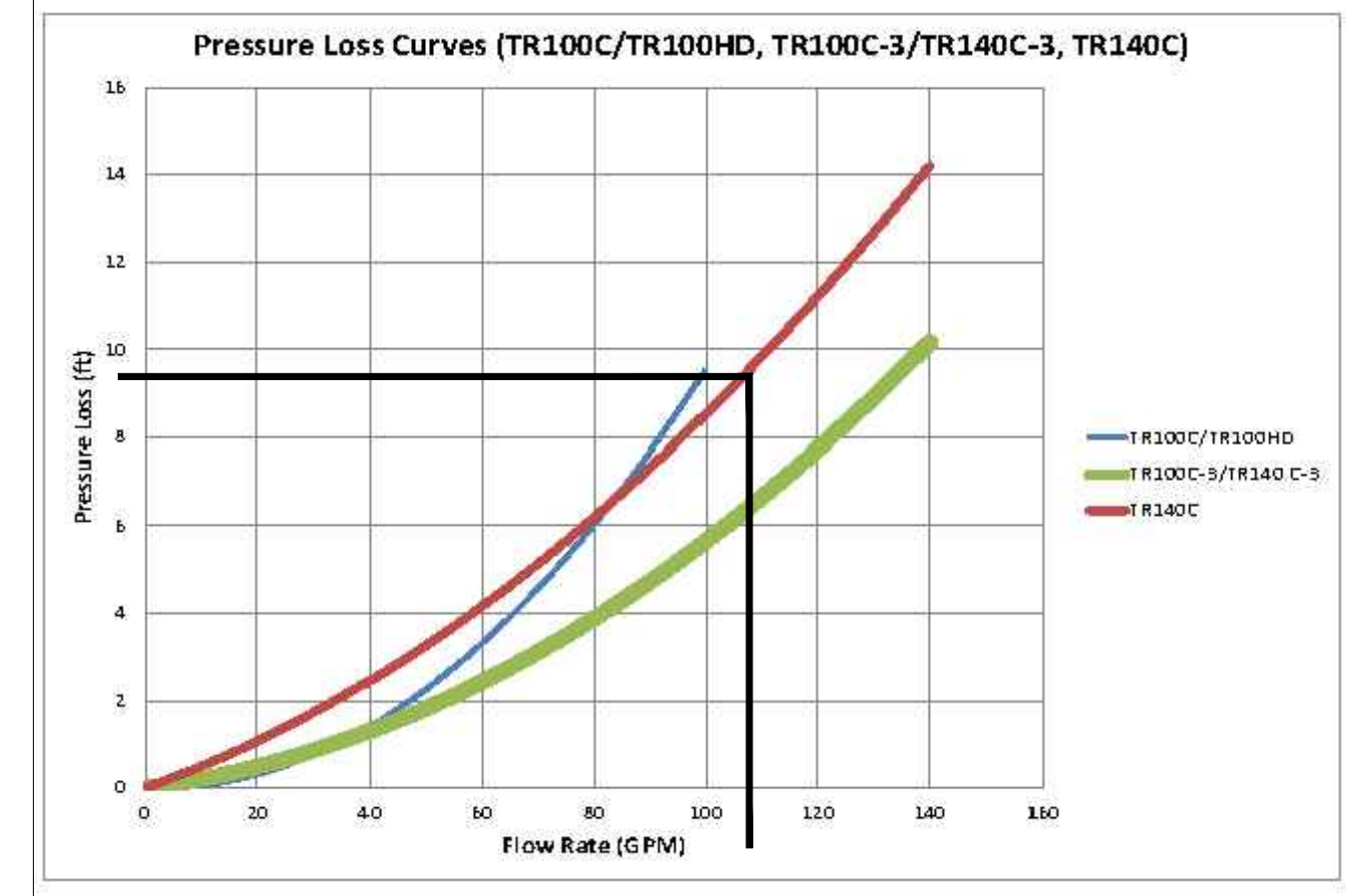

06 SAND FILTER PERFORMANCE CURVE
PL-1.3 SCALE: NOT TO SCALE

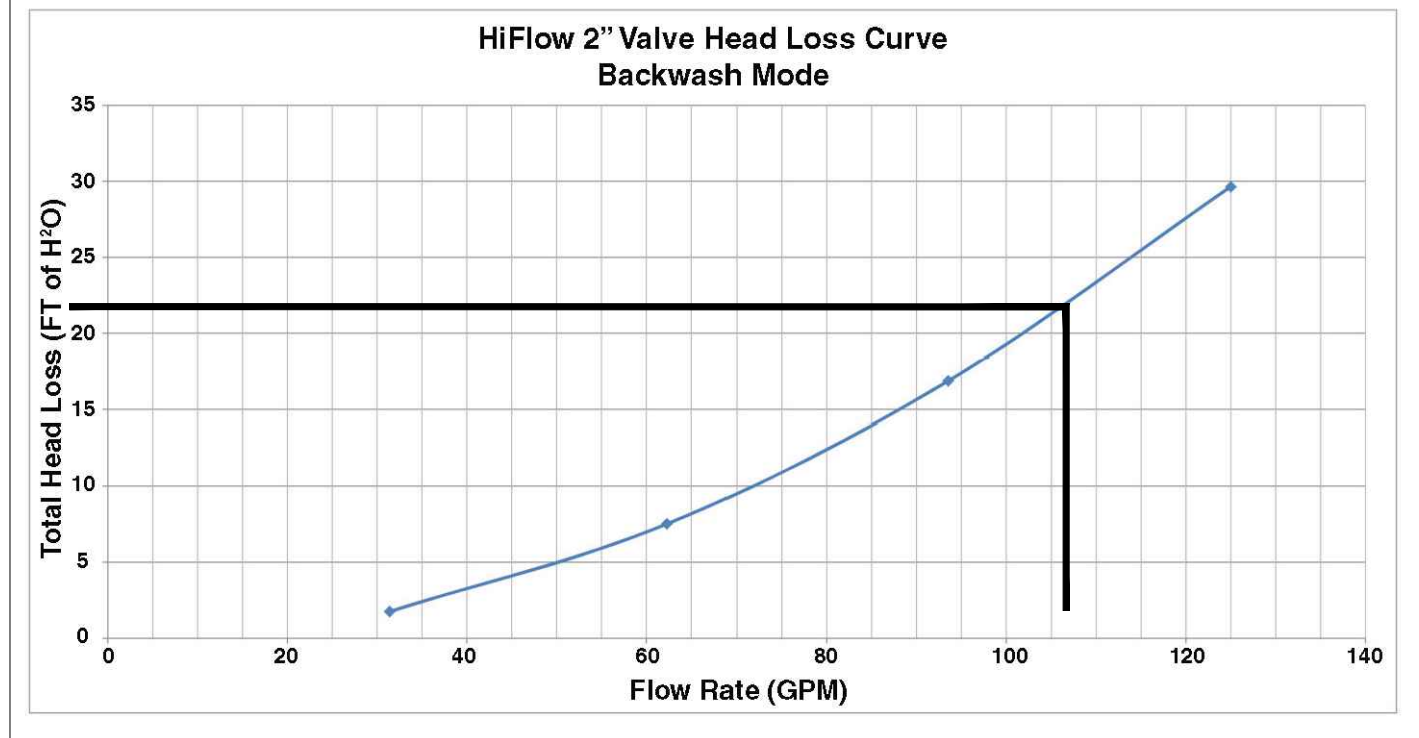

07 HI-FLO VALVE PERFORMANCE CURVE
PL-1.3 SCALE: NOT TO SCALE

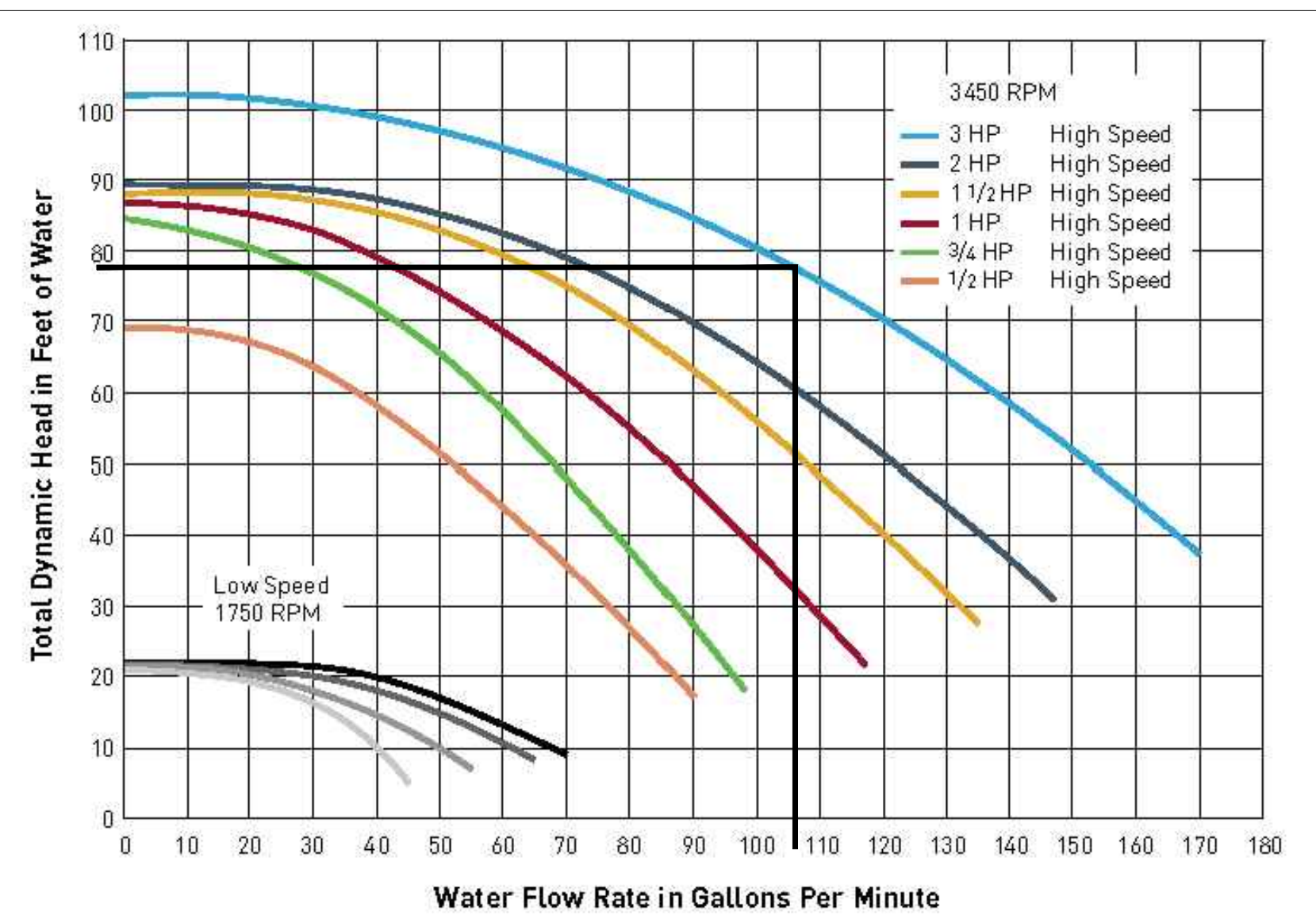

08 RECIRCULATION PUMP PERFORMANCE CURVE
PL-1.3 SCALE: NOT TO SCALE

AQUASTAR 9" SQUARE MORFLOW™ SUCTION OUTLET COVER AND MUD FRAME

VGB Series

NOTE: MAIN DRAIN COVER TO BE WHITE, AND FRAME TO BE BLACK TO PROVIDE FOR A DARK COLORED CONTRASTING BAND AROUND THE MAIN DRAIN COVER.

02 MAIN DRAIN COVER
PL-1.3 SCALE: NOT TO SCALE

ADDITIONAL PRODUCT CONFIGURATIONS FOR 4" X 6" X 6" VGB Series

AQUASTAR 4" ROUND HOCKEY PUCK SUMPLESS SUCTION OUTLET COVER

VGB Series

No sump required!

NOTE: SKIMMER EQUALIZER COVER TO BE WHITE WITH FRAME PLATE TO BE BLACK FORMING A DARK CONTRASTING COLOR AROUND THE COVER.

03 SKIMMER EQ LINE COVER
PL-1.3 SCALE: NOT TO SCALE

ADDITIONAL PRODUCT CONFIGURATIONS FOR 4" X 6" X 6" VGB Series

POOLLINE CHLORINATOR (BROWNE FEEDER PARTS INCLUDE CHLORINATOR)

CAUTION: Do not feed feeder into copper plumbing. Pipe damage could occur. Never install feeder before heater. Heater settings could occur.

04 IN-LINE CHLORINATOR
PL-1.3 SCALE: NOT TO SCALE

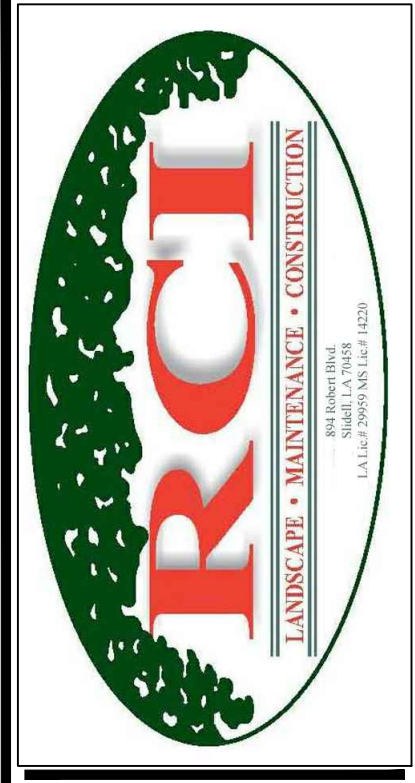

894 ROBERT BOULEVARD
SLIDELL, LOUISIANA 70458
PH: 985-643-2427
FAX: 985-643-2691
ROTOLO@ROTOLOCONSULTANTS.COM

APARTMENT HOMES BY TONTI

EDENBOURNE COURTS & GARDENS - WEST POOL
3312 EDENBOURNE AVE
METAIRIE, LOUISIANA 70002

Copyright 2016 Rotolo Consultants Inc.
These drawings or parts thereof, may not be reproduced in any form, by any method, for any purpose, without prior written consent from Rotolo Consultants Inc.
Contact: Rod Rotolo 985-643-2427
Project No:

Revisions:

No:	Date:	Description:
01	8-18-2016	BOR cmnts addressed

Date: 6/21/2016
Drawn: TJH
Checked:
Sheet Title:

EQUIPMENT DATA & PIPING SCHEMATIC

Drawing No:
PL-1.4
Sheet No:
8 of 8