

**PHILLIPS**

Phone 770.394.1616 Fax 770.394.1314

CONSULTANT \_\_\_\_\_

SEAL \_\_\_\_\_

ISSUE & REVISION RECORD

#	DATE	DESCRIPTION
07/07/14		BID SET

This document is © Phillips Partnership, PC and is considered an instrument of service only to society for use with respect to the project on national basis. All rights reserved. This document may not be reproduced without the prior written consent of Phillips Partnership, PC.

PROJECT

**SPRINGS AT FREMAUX TOWN CENTER**  
SLIDELL, LA

CLIENT

CONTINENTAL PROPERTIES  
CONTINENTAL 294 FUND LLC  
W134 N8675 EXECUTIVE PARKWAY  
MENOMONEE FALLS, WI 53051  
262.502.5500 • FAX 262.502.5522

PHILLIPS JOB NUMBER 1333104

ISSUE DATE 07/07/14

DRAWN BY/CHECKED BY ATL/DEB

DRAWING TITLE

**ARCHITECTURAL SITE PLAN**

SHEET NUMBER

**GO.10**

NORTH TERRACES  
400 PERIMETER CENTER TERRACE  
SUITE 650  
ATLANTA, GEORGIA 30346



2 VICINITY MAP  
SCALE: N.T.S.

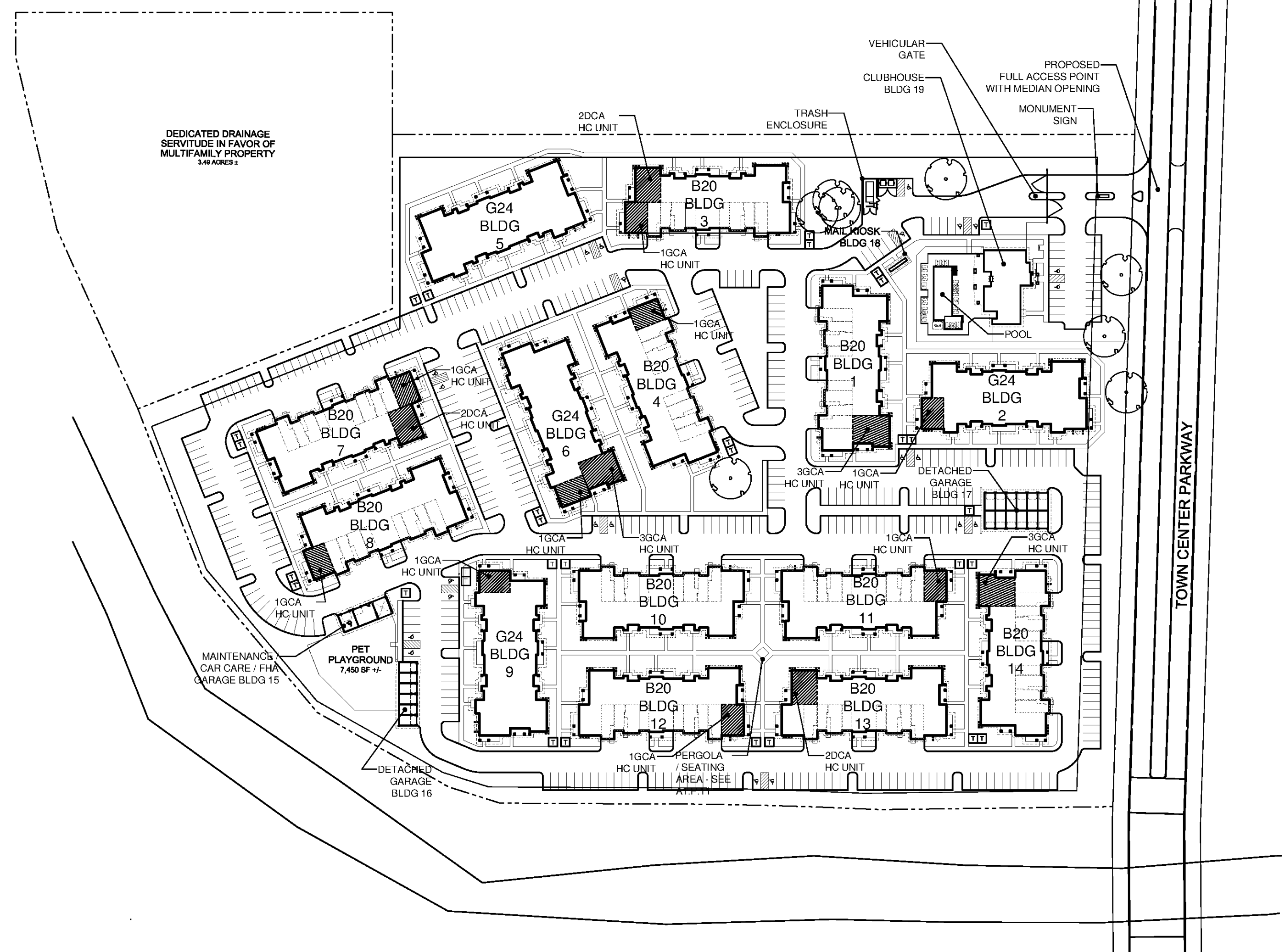

1 ARCHITECTURAL SITE PLAN  
SCALE: 1"=100'  
NORTH

BUILDING NUMBER	BUILDING TYPE	BUILDING AREA (SQ.FT.)
1	BUILDING TYPE B20	25,146
2	BUILDING TYPE G24	25,146
3	BUILDING TYPE G24	25,146
4	BUILDING TYPE B20	25,146
5	BUILDING TYPE B20	25,146
6	BUILDING TYPE G24	25,146
7	BUILDING TYPE B20	25,146
8	BUILDING TYPE B20	25,146
9	BUILDING TYPE B20	25,146
10	BUILDING TYPE B20	25,146
11	BUILDING TYPE B20	25,146
12	BUILDING TYPE B20	25,146
13	BUILDING TYPE B20	25,146
14	BUILDING TYPE G24	25,146
15	MAINTENANCE / FHA GARAGE	1,210
16	GARAGE TYPE 1 (6 BAY)	1,494
17	GARAGE TYPE 2 (12 BAY)	2,966
18	MAIL KIOSK	227
19	CLUBHOUSE	4,246
<b>TOTAL BUILDING AREA</b>		<b>362,187</b>

UNIT TYPE	BEDRM QUANTITY	BATHROOM QUANTITY	UNIT COND. SQFT	BLDG TYPE B20 UNIT QTY	BLDG TYPE G24 UNIT QTY	TOTAL UNITS
1DC*	1	1	760	20	8	28
1DO	1	1	857	20	8	28
1GC*	1	1	816	14	5	19
1GCA**	1	1	816	6	3	9
1GO	1	1	909	20	8	28
2DC	2	2	1062	7	4	11
2DCA**	2	2	1062	3	0	3
2DO	2	2	1151	10	4	14
2GC*	2	2	1088	20	16	36
2GO	2	2	1185	40	16	56
3GC*	3	2	1334	8	3	11
3GCA**	3	2	1334	2	1	3
3GO	3	2	1430	10	4	14
S1*	1 (STUDIO)	1	525	0	8	8
SO	1 (STUDIO)	1	623	20	8	28
<b>TOTALS</b>				<b>200</b>	<b>96</b>	<b>296</b>

\* ALL GROUND FLOOR UNITS TO COMPLY WITH THE FAIR HOUSING ACT (FHA UNITS).  
 \*\* (15) UNITS (5% OF TOTAL UNITS) TO COMPLY WITH 203.3.1.1 (ADA UNITS):  
 (9) 1GCA, (3) 2DCA, AND (3) 3GCA. SEE SITE PLAN FOR LOCATIONS  
 2% OF RESIDENTIAL UNITS SHALL PROVIDE COMMUNICATION FEATURES COMPLYING WITH 203.3.1.2 (2004 ADA-ABA)  
 \*\*\* ALL UNITS IN BUILDING #4 TO BE UPGRADE/CONCIERGE UNITS