

MATCHLINE (SEE SHEET C-4.3)

MATCHLINE (SEE SHEET C-4.2)

MATCHLINE (SEE SHEET C-4.6)

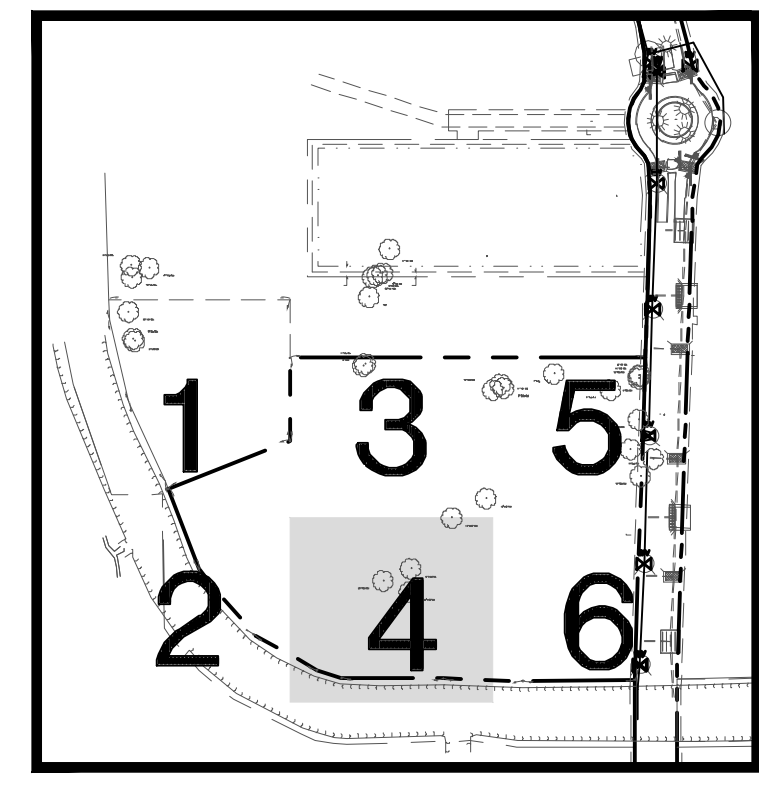

KEY MAP
N.T.S.

LEGEND - PROPOSED

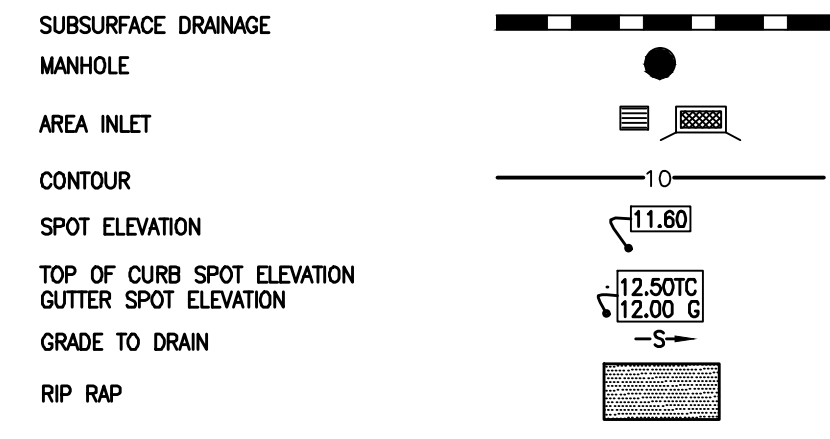

LEGEND-EXISTING

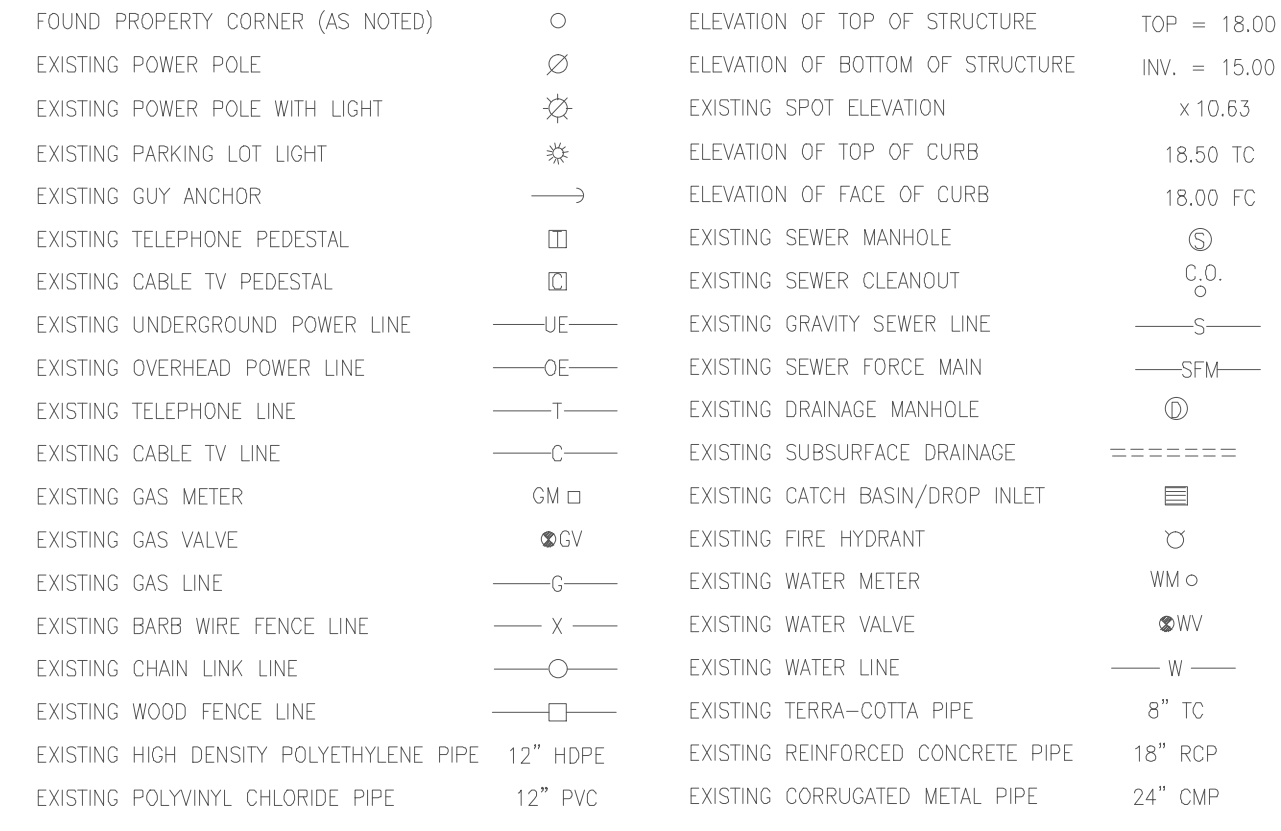

STRUCTURE NUMBER		TYPE	GLUTTER/ CASTING ELEV	INVERT IN	ELEVATION OUT	PIPE LENGTH	PIPE TYPE	PIPE SLOPE
6	5-6	TEE	9.65	5.59 (7) 6.09 (8A)	5.59 (5)	51.86	36" PVC	0.19%
7	6-7	MANHOLE	11.55	5.71 (8)	5.71 (6)	58.24	36" PVC	0.21%
8	7-8	TEE	9.65	5.79 (9) 6.16 (8A)	5.79 (7)	37.87	36" PVC	0.21%
8B	8A-8B	90° BEND	9.65		6.44 (8A)	101.78	15" PVC	0.00%
9	8-9	AREA INLET	10.40	5.88 (10)	5.88 (8)	45.34	36" PVC	0.20%
10	9-10	AREA INLET	10.15	7.80 (11) 6.27 (29)	6.27 (9)	195.54	30" PVC	0.20%
11	10	90° BEND	9.69		8.08 (10)	137.65	15" PVC	0.20%
43	42-43	MANHOLE	10.29	5.75 (44) 5.75 (52)	5.75 (42)	161.50	30" PVC	0.20%
44	43-44	AREA INLET	10.20	6.18 (45)	6.18 (43)	213.42	30" PVC	0.20%
45	44-45	AREA INLET	10.65	6.42 (46) 6.95 (53)	6.42 (44)	119.39	30" PVC	0.20%
46	45-46	AREA INLET	10.25	6.75 (47)	6.75 (45)	163.92	30" PVC	0.20%
47	46-47	TEE	9.84	6.92 (47A) 6.92 (55)	6.92 (46)	86.09	30" PVC	0.20%
52	43-52	AREA INLET	10.65		6.08 (43)	165.61	24" PVC	0.20%
53	45-53	45° BEND	9.65	7.04 (54)	7.04 (45)	17.88	18" PVC	0.50%
54	53-54	TEE	9.65	7.72 (54A)	7.72 (53)	136.99	18" PVC	0.50%
54A	54-54A	90° BEND	10.03		8.24 (54)	104.72	15" PVC	0.50%
55	47-55	TEE	10.36	8.57 (55A) 8.57 (55B)	8.27 (47)	150.34	18" PVC	0.90%
55A	55-55A	OPEN PIPE	10.93		9.14 (55)	119.95	15" PVC	0.48%

GRADING PLAN
SECTION 4

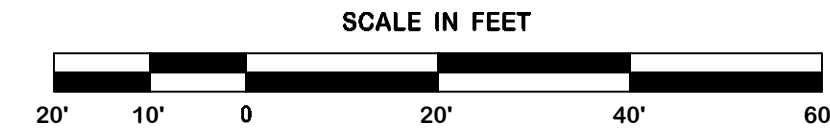

REVISION	BY
7-24-14 ADDENDUM #1	SMT
8-13-14 CITY COMMENTS	SMT
10/09/14 BUILDING UPDATE	SMT

DDG
DUPLANTIS DESIGN GROUP, PC
CIVIL ENGINEERING - ARCHITECTURE
34 LOUIS PRIMA DRIVE COVINGTON, LA 70433
WWW.DDGPC.COM PHONE: 985-249-6860 | FAX: 985-249-6190
THIBODAUX | COVINGTON | HOUSTON | BATON ROUGE | HOUMA

Signature: *And E. Alford*
DATE: 10-09-2014
Professional Engineer Seal: STATE OF LOUISIANA, DOUGLAS E. BARREILLEAU, License No. 34541

SPRINGS AT FREMAUX TOWN CENTER
SLIDELL, LOUISIANA
ST. TAMMANY PARISH
FOR CONTINENTAL 294 FUND LLC
MEMONONIE FALLS, WI

DRAWN: DGS
CHECKED: DEB
ISSUED DATE: 10/09/2014
ISSUED FOR PERMITTING
PROJECT NO.: 14-248
FILE: 14-248 C-4 GRADING
SHEET: C-4.4

14-248 C-4 GRADING.dwg