

REVISION	BY
▽ 8-27-15	DJG
▽ 10-28-15 CONSTRUCTION SET	SMT

DDG
 DUPONTIS DESIGN GROUP, PC
 CIVIL ENGINEERING - ARCHITECTURE
 34 LOUIS PRIMA DRIVE COVINGTON, LA 70433
 WWW.DDGP.COM PHONE: 985-249-6860 FAX: 985-249-6790
 THIBODAX | COVINGTON | HOUSTON | BATON ROUGE | HOUMA | DALLAS

Shirley Bell
 SIGNATURE: _____
 DATE: 10/28/2015
 STAMP: STATE OF LOUISIANA
 THOMAS H. BUCKEL
 PROFESSIONAL ENGINEER
 IN CIVIL ENGINEERING

SPRINGS @ RIVER CHASE
 COVINGTON, LA
 ST. TAMMANY PARISH
 FOR CONTINENTAL 339 FUND LLC
 COVINGTON, LA

DRAWN: DJG
 CHECKED: THB
 ISSUED DATE: 10/28/2015
 ISSUED FOR CONSTRUCTION
 PROJECT NO.: 14-697
 FILE GRADING
 SHEET: C-2.5

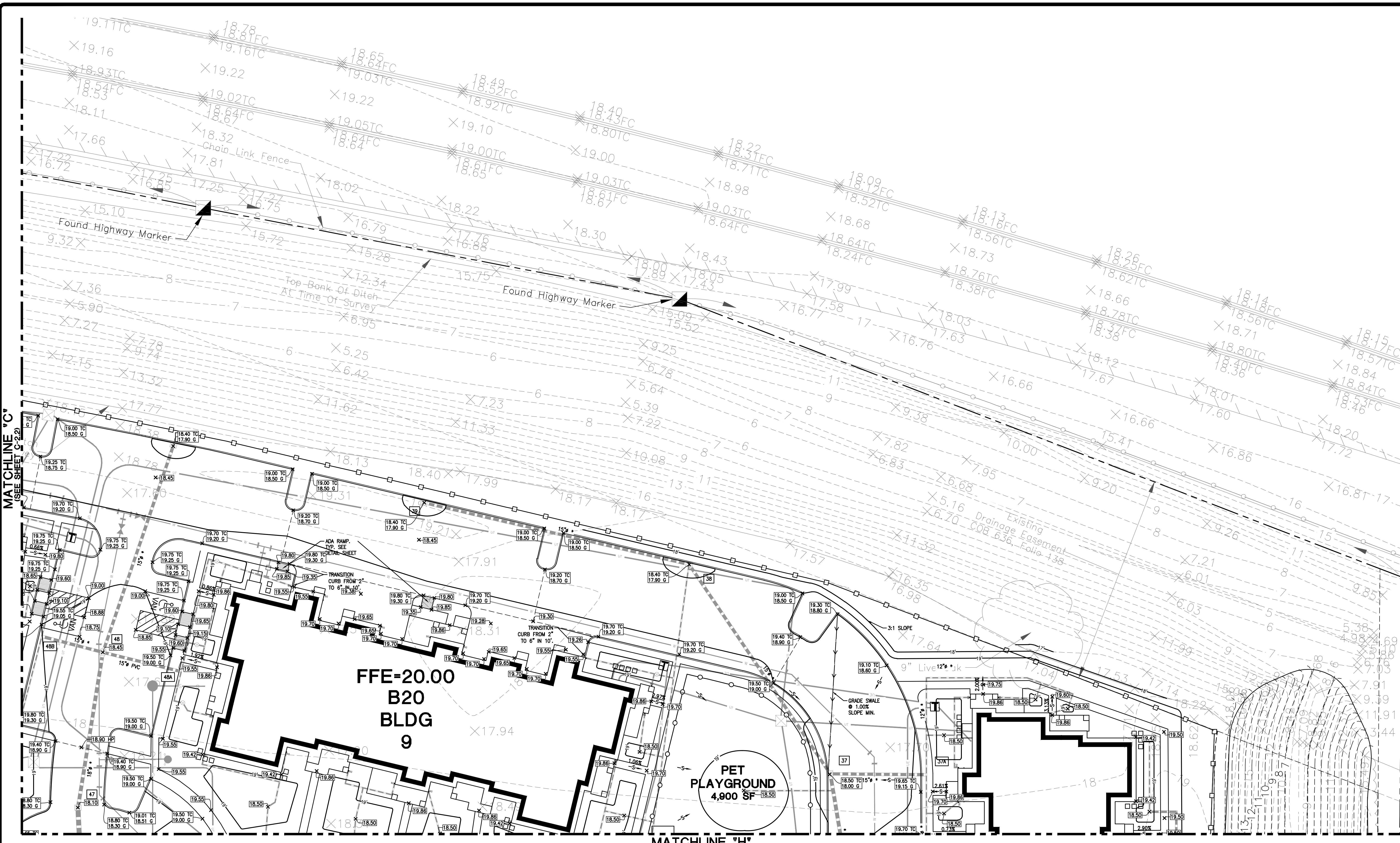

MATCHLINE "C"
 (SEE SHEET C-2.2)

MATCHLINE "H"
 (SEE SHEET C-2.6)

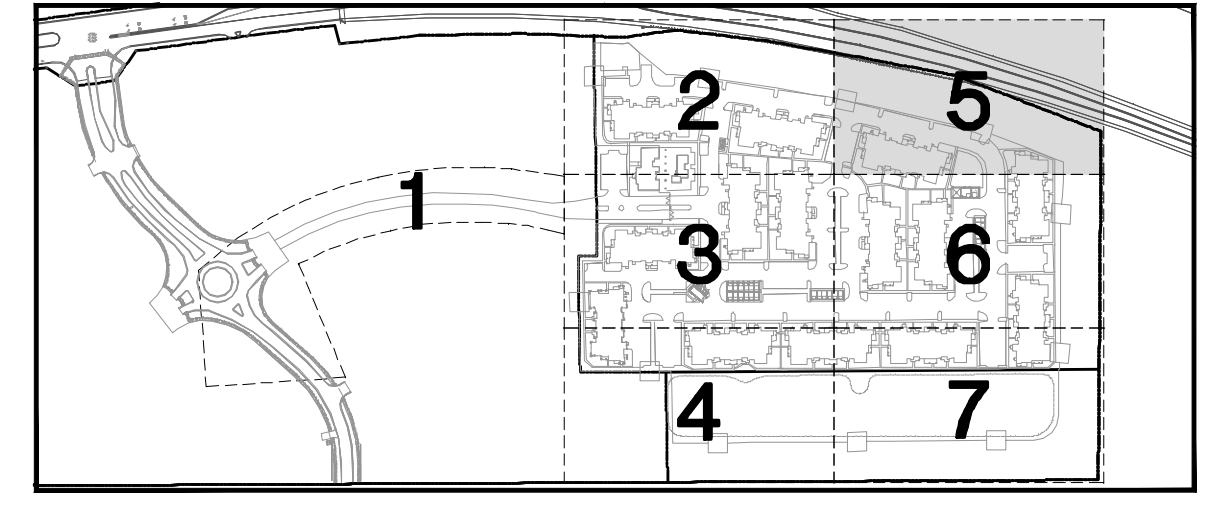

KEY MAP
 NTS

LEGEND - EXISTING

○	FOUND 3/4" G.I.P.	○	ELEVATION OF TOP OF STRUCTURE	TOP = 18.00
⊗	EXISTING POWER POLE	○	ELEVATION OF BOTTOM OF STRUCTURE	BV. = 15.00
⊕	EXISTING POWER POLE WITH LIGHT	○	EXISTING SPOT ELEVATION	x 1.59
⊙	EXISTING GUY ANCHOR	○	ELEVATION OF TOP OF CURB	18.50 TC
—	EXISTING OVERHEAD POWER LINE	—	ELEVATION OF FACE OF CURB	18.00 FC
⊕	EXISTING GAS METER	—	EXISTING SUBSURFACE DRAINAGE	
⊕	EXISTING GAS VALVE	—	EXISTING CATCH BASIN/DROP INLET	
—	EXISTING GAS LINE	—	EXISTING REINFORCED CONCRETE PIPE	18" RCP
⊕	EXISTING SEWER MANHOLE	—	EXISTING CORRUGATED METAL PIPE	24" CMP
—	EXISTING GRAVITY SEWER LINE	—	EXISTING SEWER FORCE MAIN	SFM

LEGEND - NEW IMPROVEMENTS

—	SUBSURFACE DRAINAGE	—	12"
○	MANHOLE	○	12"
⊕	AREA INLET	⊕	12"
⊕	CLEANOUT	⊕	12"
—	CONTOUR	—	12"
○	SPOT ELEVATION	○	12.00
—	SLOPE	—	12.00
—	STRUCTURE NUMBER	—	12.00
—	RIP RAP	—	12.00



GRADING PLAN 5

