

STRUCTURE TABLE							
STRUCTURE NUMBER	TYPE	GUTTER/CASTING ELEV	INVERT IN	ELEVATION OUT	PIPE LENGTH	PIPE TYPE	PIPE SLOPE
202	MANHOLE	19.00	9.27 (203)	9.17 (EX. 201)	140	10" PVC	0.28%
202-201	MANHOLE	19.00	10.27 (204)	10.17 (202)	323	10" PVC	0.28%
203	MANHOLE	19.00	11.33 (205)	11.23 (203)	344	10" PVC	0.28%
204	MANHOLE	18.74	11.84 (205B)	11.74 (204)	147	10" PVC	0.28%
205	MANHOLE	18.93	12.09 (206)	11.99 (205)	53	10" PVC	0.28%
205B-205A	MANHOLE	18.45	12.50 (207)	12.40 (205B)	110	10" PVC	0.28%
206	MANHOLE	18.30	12.88 (215)	12.78 (206)	101	10" PVC	0.28%
207-206	MANHOLE	18.55	13.82 (213)	13.82 (209)	303	10" PVC	0.28%
208	MANHOLE	18.50	14.80 (209A)	14.70 (208)	310	10" PVC	0.28%
209-208	MANHOLE	19.20	13.98 (216)	13.88 (207)	250	8" PVC	0.40%
209A-209	MANHOLE	18.90	15.30 (210)	15.20 (209)	101	8" PVC	0.40%
210	MANHOLE	18.60	15.92 (212)	15.92 (210)	31	8" PVC	0.40%
211-210	CLEANOUT	17.91	16.12 (219)	16.12 (211)	50	8" PVC	0.40%
212	CLEANOUT	19.10	14.63 (214)	14.53 (208)	177	8" PVC	0.40%
212-211	CLEANOUT	18.90	15.28 (213)	15.28 (213)	164	8" PVC	0.40%
213	MANHOLE	19.20	13.98 (216)	13.88 (207)	250	8" PVC	0.40%
213-208	MANHOLE	18.80	14.66 (215)	14.66 (215)	170	8" PVC	0.40%
214	MANHOLE	18.90	14.57 (215)	14.57 (215)	148	8" PVC	0.40%
214-213	MANHOLE	18.90	14.57 (215)	14.57 (215)	148	8" PVC	0.40%
215	MANHOLE	18.80	14.66 (215)	14.66 (215)	170	8" PVC	0.40%
215-207	MANHOLE	18.80	14.66 (215)	14.66 (215)	170	8" PVC	0.40%
216	MANHOLE	18.80	14.66 (215)	14.66 (215)	170	8" PVC	0.40%
216-215	MANHOLE	18.80	14.66 (215)	14.66 (215)	170	8" PVC	0.40%
217	CLEANOUT	18.90	14.57 (215)	14.57 (215)	148	8" PVC	0.40%
217-215	CLEANOUT	18.90	14.57 (215)	14.57 (215)	148	8" PVC	0.40%

STRUCTURE TABLE							
STRUCTURE NUMBER	TYPE	GUTTER/CASTING ELEV	INVERT IN	ELEVATION OUT	PIPE LENGTH	PIPE TYPE	PIPE SLOPE
219	CLEANOUT	19.50	16.21 (220)	16.21 (212)	21	8" PVC	0.40%
219-218	CLEANOUT	19.50	16.21 (220)	16.21 (212)	21	8" PVC	0.40%
220	CLEANOUT	19.75	16.28 (219)	16.28 (219)	19	8" PVC	0.40%
220-219	CLEANOUT	19.75	16.28 (219)	16.28 (219)	19	8" PVC	0.40%
222	CLEANOUT	18.35	16.13 (209A)	16.13 (209A)	91	8" PVC	0.40%
222-209A	CLEANOUT	18.35	16.13 (209A)	16.13 (209A)	91	8" PVC	0.40%
EX. 201	MANHOLE	19.78	8.78 (202)				

- ### WATER TABLE LEGEND
- ① 8" - 90° BEND
  - ② 8" X 45° BEND
  - ③ 8"-22.5° BEND
  - ④ 8"-11.25° BEND
  - ⑤ 8" X 6" TEE
  - ⑥ 8" X 4" TEE
  - ⑦ 8" X 8" TEE
  - ⑧ 8" GATE VALVE
  - ⑨ 6" GATE VALVE
  - ⑩ 8" PLUG
  - ⑪ 10" X 8" TEE

- ### LEGEND - NEW IMPROVEMENTS
- WATERLINE
  - SANITARY SEWERLINE
  - UNDERGROUND ELECTRIC
  - GAS LINE
  - UNDERGROUND TELEPHONE
  - STORM DRAIN SYSTEM
  - FIRE HYDRANT
  - SEWER MANHOLE
  - GATE VALVE
  - DOMESTIC WATER METER
  - SITE LIGHTING POLES (BY SITE CONTRACTOR)
  - SANITARY SEWER CLEANOUT

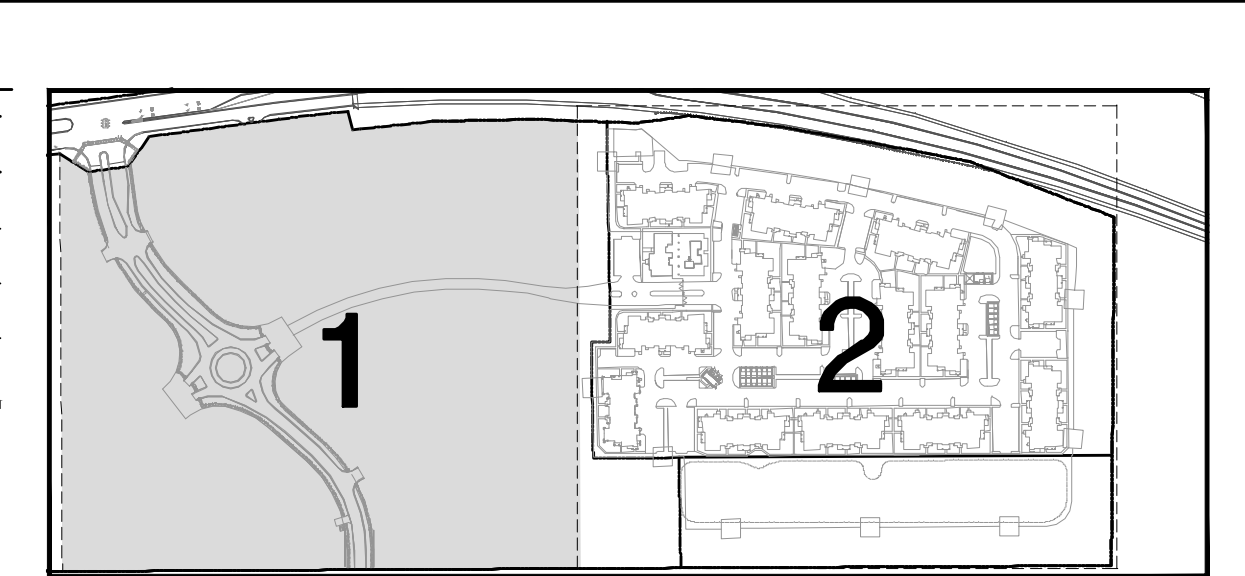

### KEY MAP NTS

- ### UTILITY NOTES:
- CONTRACTOR IS RESPONSIBLE FOR VERIFYING ALL UTILITIES & NOTIFYING THE APPROPRIATE UTILITY COMPANY PRIOR TO BEGINNING CONSTRUCTION.
  - THE CONTRACTOR IS SPECIFICALLY CAUTIONED THAT THE LOCATION &/OR ELEVATION OF EXISTING UTILITIES AS SHOWN ON THESE PLANS IS BASED ON RECORDS OF THE VARIOUS UTILITY COMPANIES & WHERE POSSIBLE, MEASUREMENTS TAKEN IN THE FIELD. THE INFORMATION IS NOT TO BE RELIED ON AS BEING EXACT OR COMPLETE. THE CONTRACTOR MUST CALL THE APPROPRIATE UTILITY COMPANY AT LEAST 72 HOURS BEFORE ANY EXCAVATION TO REQUEST EXACT FIELD LOCATION OF THE UTILITIES. IT SHALL BE THE RESPONSIBILITY OF THE CONTRACTOR TO RELOCATE ALL EXISTING UTILITIES WHICH CONFLICT WITH THE PROPOSED IMPROVEMENTS SHOWN ON THE PLANS.
  - CONTRACTOR SHALL VERIFY HORIZONTAL & VERTICAL LOCATION OF ALL EXISTING STORM SEWER STRUCTURES, PIPES, & ALL UTILITIES PRIOR TO CONSTRUCTION.
  - CONTRACTOR TO REMOVE OR RELOCATE WHEN APPLICABLE, ALL EXISTING BUILDINGS, FOUNDATIONS, EASEMENTS, & CONNECTING IMPROVEMENTS, DRAIN PIPES, SANITARY SEWER PIPE, POWER POLES & GUY WIRES, WATER METERS & WATER LINES, SIDEWALKS, SIGN POLES, UNDERGROUND GAS, & ASPHALT, SHOWN & NOT SHOWN, WITHIN CONSTRUCTION LIMITS & WHERE NEEDED, TO ALLOW FOR FILL MATERIAL, UNLESS OTHERWISE DENOTED, TO BE REMOVED AS UNCLASSIFIED EXCAVATION.
  - CONTRACTOR IS RESPONSIBLE FOR REPAIRS OF DAMAGE TO ANY EXISTING IMPROVEMENTS DURING CONSTRUCTION, SUCH AS, BUT NOT LIMITED TO, UTILITIES, PAVEMENT, STRIPING, CURBS, ETC. REPAIRS SHALL BE EQUAL TO OR BETTER THAN EXISTING CONDITIONS.
  - CONTRACTOR SHALL REFER TO ARCHITECT'S PLANS & SPECIFICATIONS FOR ACTUAL LOCATION OF ALL UTILITY ENTRANCES TO INCLUDE SANITARY SEWER LATERALS, DOMESTIC & FIRE PROTECTION WATER SERVICE, ELECTRICAL, TELEPHONE, CABLE T.V., & GAS SERVICE. CONTRACTOR SHALL COORDINATE INSTALLATION OF UTILITIES IN SUCH A MANNER AS TO AVOID CONFLICTS & ASSURE PROPER DEPTHS ARE ACHIEVED AS WELL AS COORDINATING WITH CITY UTILITY REQUIREMENTS AS TO LOCATIONS & SCHEDULING FOR TIE-INS/CONNECTIONS PRIOR TO CONNECTING EXISTING FACILITIES.
  - CONTRACTOR SHALL COORDINATE WITH ARCHITECTURAL PLANS, POWER COMPANY, & TELEPHONE COMPANY FOR ACTUAL ROUTING OF POWER & TELEPHONE SERVICE TO BUILDING.
  - CONSTRUCTION SHALL COMPLY WITH ALL GOVERNING CODES & BE CONSTRUCTED TO SAME.
  - SEE GEOTECHNICAL REPORT, UTILITIES, INC. SPECIFICATIONS, & DETAIL SHEETS FOR BACKFILLING & COMPACTION REQUIREMENTS ON UTILITY TRENCHES.
  - CONTRACTOR SHALL COMPLY TO THE FULLEST EXTENT WITH THE LATEST STANDARD OF OSHA DIRECTIVES OR ANY OTHER AGENCY HAVING JURISDICTION FOR EXCAVATION & TRENCHING PROCEDURES. THE CONTRACTOR SHALL USE SUPPORT SYSTEMS, SLOPING, BENCHING, & OTHER MEANS OF PROTECTION. THIS TO INCLUDE BUT NOT LIMITED TO, ACCESS & EGRESS FROM ALL EXCAVATION & TRENCHING. CONTRACTOR IS RESPONSIBLE TO COMPLY WITH PERFORMANCE CRITERIA FOR OSHA.
  - STEWOR FOR THIS PROJECT SHALL MEET OR EXCEED THE ST. TAMMANY PARISH STANDARD SITEWORK SPECIFICATIONS.
  - CONTRACTOR SHALL COORDINATE WITH OTHER UTILITIES TO ASSURE PROPER DEPTH & PREVENT ANY CONFLICT OF UTILITIES.
  - THE MINIMUM HORIZONTAL SEPARATION BETWEEN THE CLOSEST TWO POINTS OF THE WATER & SEWER LINE IS TEN (10) FEET, OR MINIMUM VERTICAL SEPARATION BETWEEN THE CLOSEST TWO POINTS OF THE WATER & SEWER LINE IS EIGHTEEN (18) INCHES.
  - CONTRACTOR SHALL GROUT AROUND ALL PIPE ENTRANCES TO SANITARY SEWER MANHOLES WITH NON-SHRINKING GROUT TO ASSURE CONNECTION IS WATER TIGHT.
  - CONTRACTOR SHALL ON ALL UTILITIES, COORDINATE INSPECTION WITH THE APPROPRIATE AUTHORITIES PRIOR TO COVERING TRENCHES AT INSTALLATION.
  - CONSTRUCTION SHALL COMPLY WITH ALL GOVERNING CODES & REQUIREMENTS. THE CONTRACTOR SHALL CONDUCT ALL REQUIRED TESTS TO THE SATISFACTION OF THE RESPECTIVE UTILITY COMPANIES & OWNERS INSPECTING AUTHORITIES.
  - SITE CONTRACTOR TO COORDINATE PROPOSED RECONNECTION OF ALL UTILITIES WITH ARCHITECTURAL PLANS AS WELL AS UTILITY COMPANIES & BUILDING CONTRACTOR.
  - ALL NECESSARY INSPECTIONS &/OR CERTIFICATIONS REQUIRED BY CODES &/OR UTILITY SERVICE COMPANIES SHALL BE PERFORMED PRIOR TO ANNOUNCED BUILDING POSSESSION & THE FINAL CONNECTION OF SERVICES.

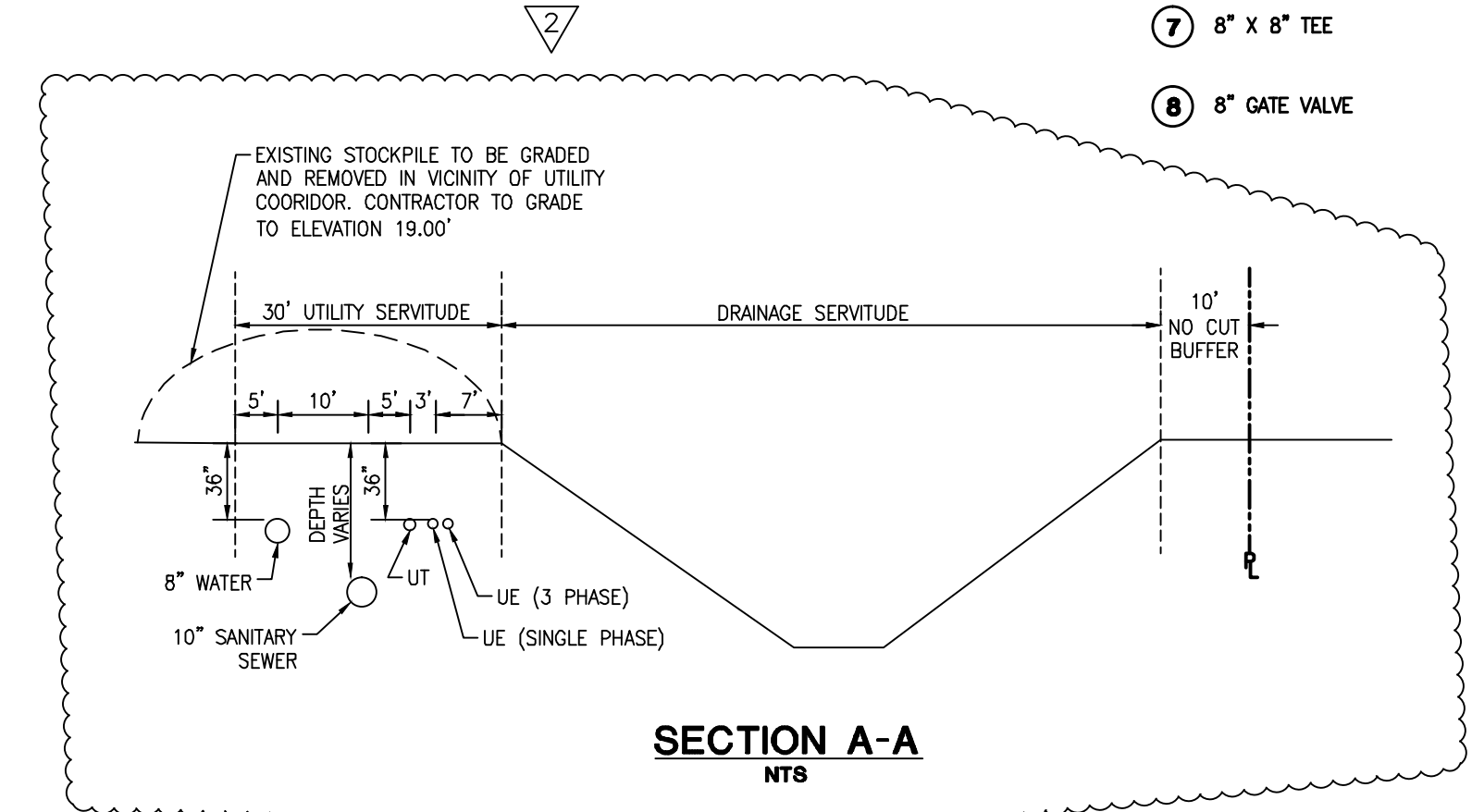

### LEGEND - EXISTING

- FOUND 3/4" IRON PIPE
- ⊙ FOUND 5/8" IRON ROD
- B = BOLLARD
- BM = PROJECT BENCHMARK
- FH = FIRE HYDRANT
- FL = FLOW LINE
- FO = FIBER OPTIC CABLE
- G = GUY WIRE
- MHST = MANHOLE STORM
- MHSS = MANHOLE SEWER
- PP = POWER POLE
- ROP = REINFORCED CONCRETE PIPE
- S = STOP SIGN
- WV = WATER VALVE

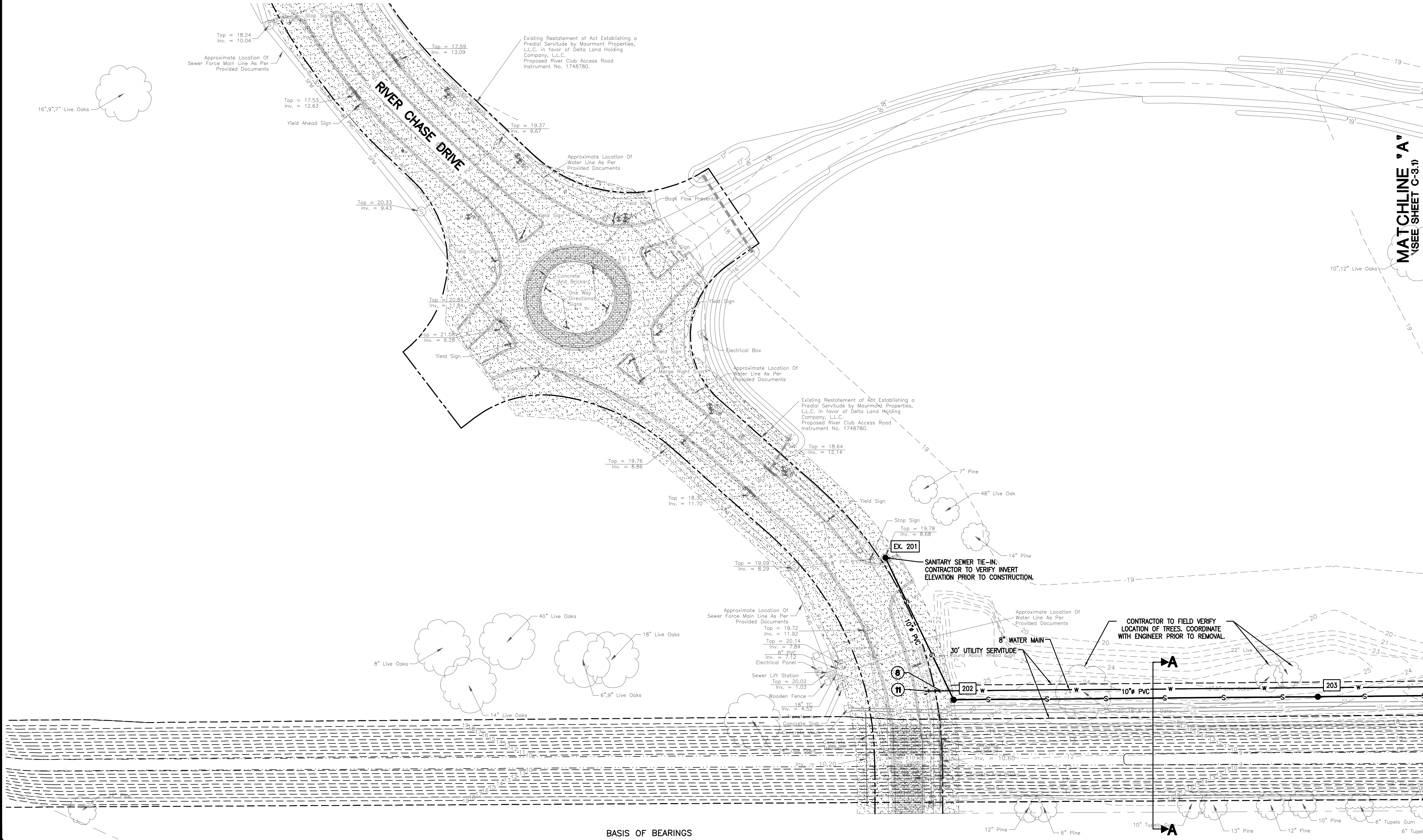

- ### WATER NOTES:
- ALL WORK SHALL BE DONE TO THE UTILITIES INC. STANDARD SPECIFICATIONS AND DETAILS. CONTRACTOR SHALL COORDINATE WITH DELOS WILLIAMS (#985-893-5772) WITH UTILITIES INC. OF LA PRIOR TO COMMENCING WITH CONSTRUCTION.
  - REFERENCE ARCHITECT'S PLANS FOR ALL BUILDING FIRE SERVICE & DOMESTIC SERVICE CONNECTION LOCATIONS.
  - CONTRACTOR SHALL CONSTRUCT WATER SERVICES AS SHOWN, & CONSTRUCT METERS, PITS, & INSTALL CHECK VALVE & DOMESTIC LEADS TO BUILDING SHALL END AT THE FACE OF BUILDING WALL, UNLESS NOTED, & SHALL BE PROVIDED WITH A TEMPORARY PLUG AT END (FOR OTHERS TO REMOVE & EXTEND AS NECESSARY).
  - ALL VERTICAL BENDS ON WATER MAIN SHALL BE RESTRAINED WITH A MECHANICAL JOINT FITTING SUPPLIED WITH THE RETAINER GLANDS. ANY JOINTS 25 FEET OR LESS FROM EITHER SIDE OF VERTICAL BEND SHALL BE RESTRAINED WITH A RETAINER GLAND.
  - DIMENSIONS SHOWN ARE TO CENTERLINE OF PIPE OR FITTINGS.
  - ALL VALVES SHALL BE INSTALLED IN A CAST IRON VALVE BOX WITH COVER.
  - THRUST BLOCKS SHALL BE PROVIDED AT ALL HORIZONTAL BENDS, TEES, & FIRE HYDRANTS. SEE UTIL SPECIFICATIONS.
  - THE MINIMUM COVER ON WATER MAINS SHALL BE 3 FEET.
  - PIPE SIZES 3" & SMALLER SHALL BE PVC. FITTINGS SHALL BE BRASS. SEE SPECIFICATIONS.
  - PIPE SIZES 4" & LARGER SHALL BE PVC C-900 WATER PIPE. ALL FITTINGS 4" & LARGER SHALL BE CAST IRON CONFORMING TO ANSI & ANMA STANDARD SPECIFICATIONS.
  - GATE VALVES 3/4" THROUGH 3" SHALL BE BRONZE WEDGE TYPE GATE VALVE. VALVES SHALL HAVE NON-RISING STEM WITH SOLID TEE HEAD OPERATING NUT UNLESS NOTED OTHERWISE.
  - GATE VALVES 4" & LARGER SHALL BE CAST IRON GATE VALVE WITH PARALLEL DOUBLE DISC. VALVES SHALL HAVE MECHANICAL JOINT ENDS & NON-RISING STEM WITH SQUARE OPERATING NUT.
  - ALL NEW LINES TO BE PRESSURE TESTED, DISINFECTED, AND HAVE A BACTERIOLOGICAL SAMPLE TAKEN IN ACCORDANCE WITH UTILITY INC.'S REQUIREMENTS AND IAC 51:00.353.A.

- ### SANITARY SEWER NOTES:
- ALL WORK SHALL BE DONE TO THE UTILITIES INC. STANDARD SPECIFICATIONS AND DETAILS. CONTRACTOR SHALL COORDINATE WITH DELOS WILLIAMS (#985-893-5772) WITH UTILITIES INC. OF LA PRIOR TO COMMENCING WITH CONSTRUCTION.
  - REFERENCE ARCHITECT'S PLANS FOR ALL BUILDING SERVICE CONNECTIONS.
  - CONTRACTOR SHALL PAY ALL FEES & CHARGES PERTINENT TO SANITARY SEWER CONSTRUCTION & SHALL COORDINATE WITH UTILITIES, INC. PRIOR TO COMMENCING WITH CONSTRUCTION.
  - ALL STUB-OUTS & WYE LATERALS SHALL BE PLUGGED WITH A STANDARD TYPE PLUG.
  - SANITARY SEWER PIPE OF DIFFERENT MATERIAL SHALL BE JOINED BY A RUBBER SLEEVE WITH STAINLESS STEEL COUPLING, MADE FOR TRANSITIONS FROM ONE MATERIAL TO ANOTHER.
  - DIMENSIONS SHOWN ARE TO CENTERLINE OF PIPE OR TO CENTERLINE OF MANHOLE.
  - THE SANITARY SEWER PIPE MATERIAL SHALL BE PVC, SDR 35, SEWER PIPE UNLESS OTHERWISE NOTED ON PLAN.

Not For Construction  
For Permitting Only



# WET UTILITY PLAN 1

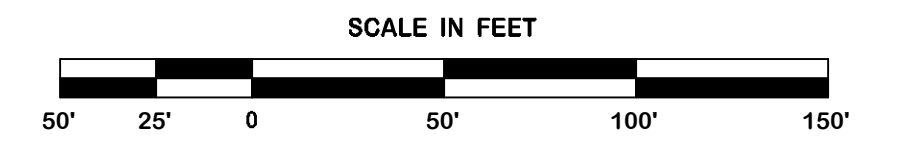

REVISION	BY
9-30-2015 PERMIT COMMENTS	SMT

**DDG**  
DUPLANTIS DESIGN GROUP, PC  
CIVIL ENGINEERING - ARCHITECTURE  
34 LOUIS PRIMA DRIVE COVINGTON, LA 70433  
WWW.DDGP.COM PHONE: 985-249-6980 FAX: 985-249-6190  
THIBODAUX | COVINGTON | HOUSTON | BATON ROUGE | HOUMA | DALLAS

THOMAS H. BUCKEL  
PROFESSIONAL ENGINEER  
CIVIL ENGINEERING  
STATE OF LOUISIANA  
10/28/2015  
DATE

SPRINGS @ RIVER CHASE  
COVINGTON, LA  
ST. TAMMANY PARISH  
FOR CONTINENTAL 339 FUND LLC  
COVINGTON, LA

DRAWN DJG
CHECKED THB
ISSUED DATE 10/28/2015
ISSUED FOR CONSTRUCTION
PROJECT NO. 14-597
FILE WET UTILITY
SHEET C-3.0