

TYPICAL PLAN KEY NOTES

1. CONTINUOUS 4" HIGH CONCRETE CURB AT EXTERIOR WALL.
2. GALVANIZED LADDER TO ACCESS MEZZ.
3. PROTECTIVE ANGLE AT CONC EDGE WITH TRUCK BUMPERS.
4. OVERHEAD PROJECTION SCREEN WITH PROJECTOR.
5. SEE A510 FOR PARKING STRIPING DETAILS. TYP
6. DOUBLE SIDED FIREPLACE, VENT TO EXTERIOR.
7. CONFORM TO ENERGY REQUIREMENTS FOR TRANSFORMER VAULT.
8. PREFABRICATED METAL CANOPY WITH INTEGRAL GUTTER. (PRICE BASIN ST. AS ADD ALT.)
9. MECHANICAL PLATFORM ABOVE. SEE A1 & A2/A116. SEE STRUCT. FOR FRAMING
10. STAMPED AND SEALED TOPPING SLAB OVER WATERPROOFING MEMBRANE IN COURTYARD.
11. PAINTED TREATED WOOD PERGOLA. SEE D1 & D3/A254
12. OUTDOOR KITCHEN ISLAND
13. ELEVATED POOL WITH ADA TRANSFER WALL.
14. POOL LADDER.
15. POOL EQUIP. PAD WITH ENCLOSURE, SURROUNDED BY PLANTER WITH LANDSCAPING.
16. RAISED ARTIFICIAL PUTTING GREEN.
17. ALUMINUM PICKET FENCE.
18. GLAZING TO HAVE 45 MIN. RATING.
19. WINDOW INSET WITH FREE STANDING LANDSCAPING PLANTERS
20. TRASH AND RECYCLING RECEPTACLE. SEE STANDARDS
21. COURTYARD AND POOL BELOW
22. PRE-FINISHED MTL. GUTTER WITH DOWNSPOUT AND BOOT. SEE PLUMBING FOR SIZE.
23. OVERFLOW DRAIN TYP. SEE PLUMBING FOR SIZING. INSURE 100% REDUNDANT CAPACITY
24. PRIMARY DRAIN TYP. SEE PLUMBING FOR SIZING. INSURE 100% REDUNDANT CAPACITY
25. OPENING IN 2ND. FLOOR PRECAST DOUBLE T, WHICH ALLOWS WATER TO DRAIN INTO 1st. FLOOR PARKING AREA IN WORST CASE SCENARIO. SEE A1/A307
26. PAINTED VEHICULAR BOLLARDS.
27. PREFINISHED FIXED ALUMINUM SHUTTERS ABOVE
28. BALCONY SEE STRUCTURAL
29. GENERATOR PLATFORM ABOVE, SEE C1/A116. 2HR. FIRE RATING REQUIRED AT DECK.
30. SEE ELECT FOR GENERATOR REQUIREMENTS. ROUTE EXHAUST TO EAST EXTERIOR WALL
31. SEE BRAND STANDARDS FOR FITNESS ROOM AND GUEST LAUNDRY REQUIREMENTS.
32. LOAD BEARING COURTYARD WALL AT 4TH FLOOR ONLY, SEE STRUCT. INSURE THAT STRUCTURAL MEMBERS ARE 1HR FIRE RATED.
33. DEPOSIT BOX-CONTRACTOR TO INSTALL.
34. PROVIDE CONDUIT FOR FUTURE CAR CHARGING STATION AT FRONT OF PARKING SPACE.

GENERAL PLAN NOTES:

1. ALL DIMENSIONS ARE TO FACE OF STUD, FACE OF MASONRY, OR CENTER OF STRUCTURAL MEMBER UNLESS NOTED OTHERWISE.
2. SEE A601-A602 FOR PARTITION TYPES
3. ENSURE THAT ALL VERTICAL CHASES ARE SEALED AIRTIGHT
4. ALL FLOOR AND WALL OPENINGS AND ROOF PENETRATIONS ARE TO BE COORDINATED WITH ALL TRADES INVOLVED. PROVIDE STEEL FRAMES, SLEEVES, AND LINTELS REQUIRED AROUND PENETRATIONS IN WALLS OR FLOORS. FIRE SEAL WHERE THROUGH FIRE-RATED CONSTRUCTION.
5. SEE A371 & A372 FOR ENLARGED STAIR PLANS AND SECTIONS
6. SEE A373 FOR ELEVATOR HOISTWAY PLANS AND SECTION
7. SEE A311-A318 FOR WALL SECTIONS. REFERENCE TAGS LOCATED ON ELEVATIONS A201
8. SEE A504 & A505 FOR SHAFT DETAILS.

AI 2ND. FLOOR PLAN - WEST  
 AI12 SCALE: 1/8" = 1'-0"

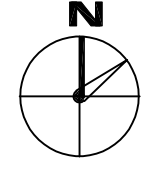
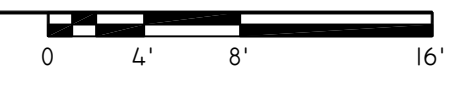

**HCI** architecture  
**PALMISANO** CONTRACTORS  
**RAMPART HOMEWOOD**  
 317 NORTH RAMPART ST. NEW ORLEANS, LA  
 AI12  
 9 5 3% S E T  
 11-09-2015  
 PROJECT NO. 436  
 DRAWING FILE A12.FP.PDF  
 DES  
 GCM

01/17/2015 10:00:00 AM 2015/01/17 10:00:00 AM 2015/01/17 10:00:00 AM

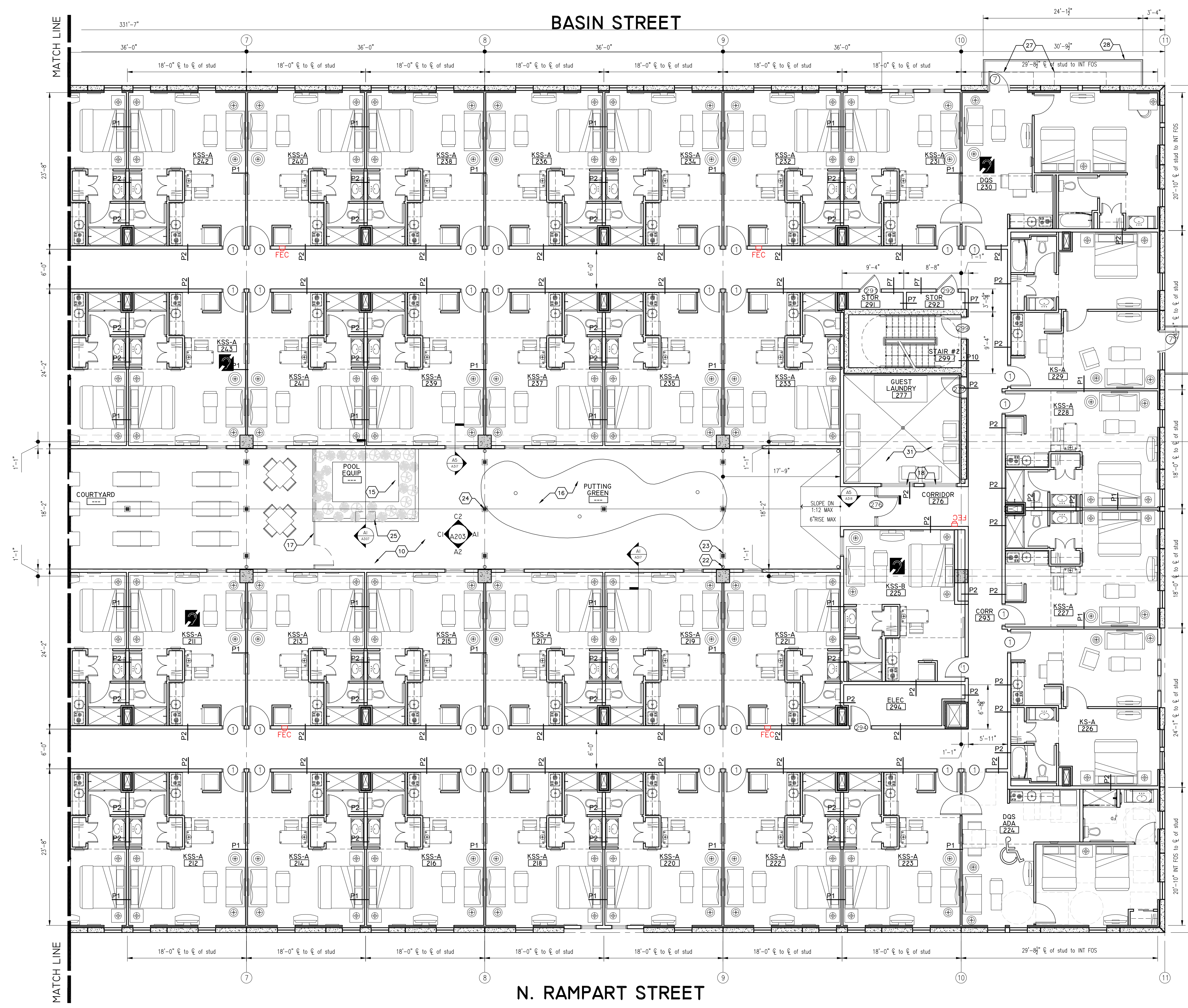

**TYPICAL PLAN KEY NOTES**

1. CONTINUOUS 4" HIGH CONCRETE CURB AT EXTERIOR WALL.
2. GALVANIZED LADDER TO ACCESS MEZZ.
3. PROTECTIVE ANGLE AT CONC EDGE WITH TRUCK BUMPERS.
4. OVERHEAD PROJECTION SCREEN WITH PROJECTOR.
5. SEE A510 FOR PARKING STRIPING DETAILS. TYP
6. DOUBLE SIDED FIREPLACE, VENT TO EXTERIOR.
7. CONFORM TO ENERGY REQUIREMENTS FOR TRANSFORMER VAULT.
8. PREFABRICATED METAL CANOPY WITH INTEGRAL GUTTER. (PRICE BASIN ST. AS ADD ALT.)
9. MECHANICAL PLATFORM ABOVE. SEE A1 & A2/A116. SEE STRUCT. FOR FRAMING
10. STAMPED AND SEALED TOPPING SLAB OVER WATERPROOFING MEMBRANE IN COURTYARD.
11. PAINTED TREATED WOOD PERGOLA. SEE D1 & D3/A254
12. OUTDOOR KITCHEN ISLAND
13. ELEVATED POOL WITH ADA TRANSFER WALL.
14. POOL LADDER.
15. POOL EQUIP. PAD WITH ENCLOSURE, SURROUNDED BY PLANTER WITH LANDSCAPING.
16. RAISED ARTIFICIAL PUTTING GREEN.
17. ALUMINUM PICKET FENCE.
18. GLAZING TO HAVE 45 MIN. RATING.
19. WINDOW INSET WITH FREE STANDING LANDSCAPING PLANTERS
20. TRASH AND RECYCLING RECEPTACLE. SEE STANDARDS
21. COURTYARD AND POOL BELOW
22. PRE-FINISHED MTL. GUTTER WITH DOWNSPOUT AND BOOT. SEE PLUMBING FOR SIZE.
23. OVERFLOW DRAIN TYP. SEE PLUMBING FOR SIZING. INSURE 100% REDUNDANT CAPACITY
24. PRIMARY DRAIN TYP. SEE PLUMBING FOR SIZING. INSURE 100% REDUNDANT CAPACITY
25. OPENING IN 2ND. FLOOR PRECAST DOUBLE T, WHICH ALLOWS WATER TO DRAIN INTO 1st. FLOOR PARKING AREA IN WORST CASE SCENARIO. SEE A1/A307
26. PAINTED VEHICULAR BOLLARDS.
27. PREFINISHED FIXED ALUMINUM SHUTTERS ABOVE
28. BALCONY SEE STRUCTURAL
29. GENERATOR PLATFORM ABOVE, SEE C1/A116. 2HR. FIRE RATING REQUIRED AT DECK.
30. SEE ELECT FOR GENERATOR REQUIREMENTS. ROUTE EXHAUST TO EAST EXTERIOR WALL
31. SEE BRAND STANDARDS FOR FITNESS ROOM AND GUEST LAUNDRY REQUIREMENTS.
32. LOAD BEARING COURTYARD WALL AT 4TH FLOOR ONLY, SEE STRUCT. INSURE THAT STRUCTURAL MEMBERS ARE 1HR FIRE RATED.
33. DEPOSIT BOX-CONTRACTOR TO INSTALL.
34. PROVIDE CONDUIT FOR FUTURE CAR CHARGING STATION AT FRONT OF PARKING SPACE.

CONTI STREET

**GENERAL PLAN NOTES:**

1. ALL DIMENSIONS ARE TO FACE OF STUD, FACE OF MASONRY, OR CENTER OF STRUCTURAL MEMBER UNLESS NOTED OTHERWISE.
2. SEE A601-A602 FOR PARTITION TYPES
3. ENSURE THAT ALL VERTICAL CHASES ARE SEALED AIRTIGHT
4. ALL FLOOR AND WALL OPENINGS AND ROOF PENETRATIONS ARE TO BE COORDINATED WITH ALL TRADES INVOLVED. PROVIDE STEEL FRAMES, SLEEVES, AND LINTELS REQUIRED AROUND PENETRATIONS IN WALLS OR FLOORS. FIRE SEAL WHERE THROUGH FIRE-RATED CONSTRUCTION.
5. SEE A371 & A372 FOR ENLARGED STAIR PLANS AND SECTIONS
6. SEE A373 FOR ELEVATOR HOISTWAY PLANS AND SECTION
7. SEE A311-A318 FOR WALL SECTIONS. REFERENCE TAGS LOCATED ON ELEVATIONS A201
8. SEE A504 & A505 FOR SHAFT DETAILS.

AI 2ND. FLOOR PLAN - EAST  
 AI12.1 SCALE: 1/8" = 1'-0"

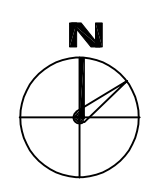
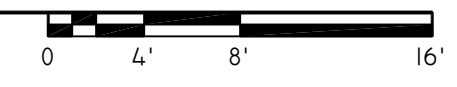

HCL Architecture

PALMISANO CONTRACTORS

317 NORTH RAMPART ST. NEW ORLEANS, LA

AI12.1

2ND. FLOOR PLAN

PLOT DATE  
11-09-2015

PROJECT NO.  
436

DRAWING FILE  
AI12.FP.rvt

DES  
GCM

© Copyright 2015 HCL ARCHITECTURE INCORPORATED, A PROFESSIONAL CORPORATION

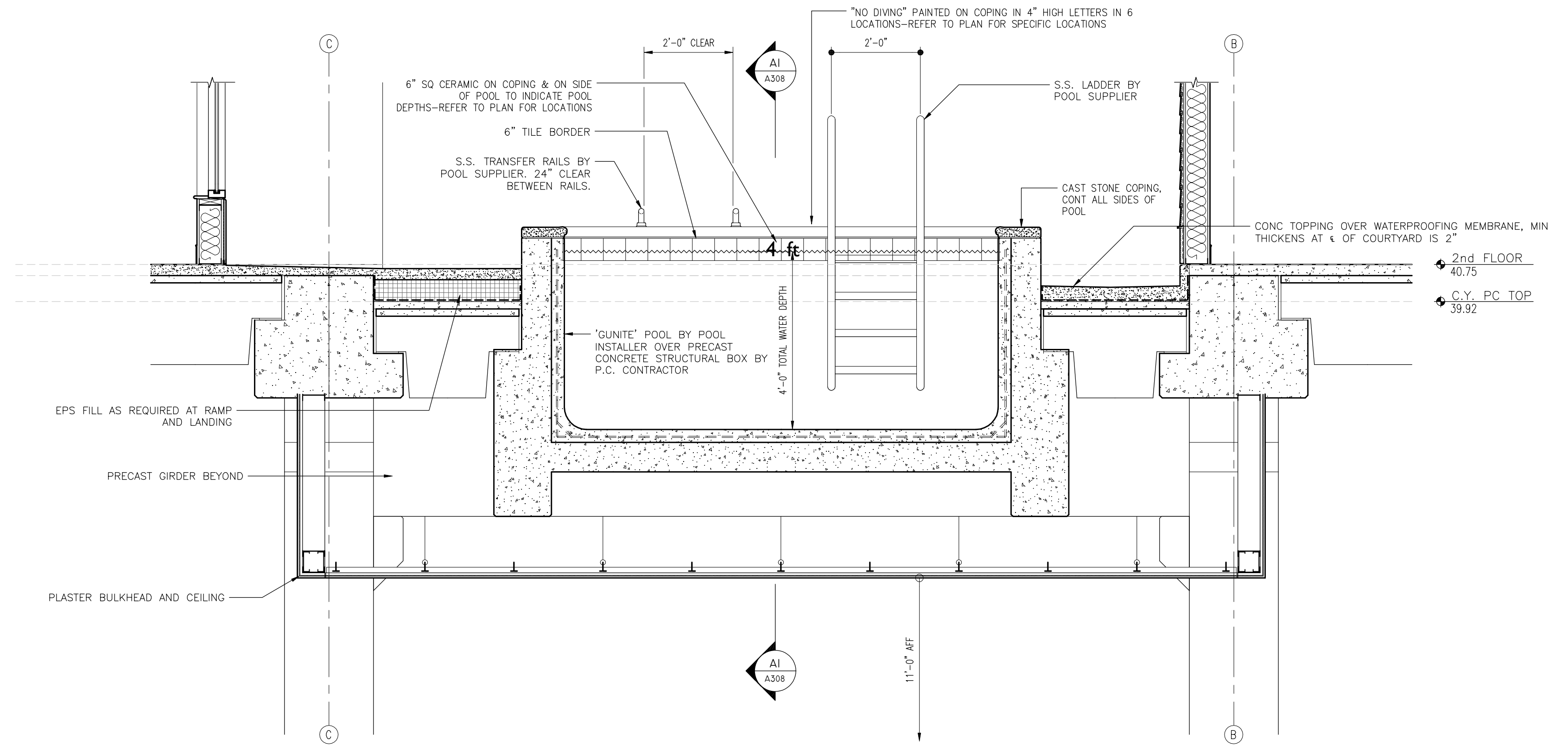

**C3**  
**A308** POOL SECTIONS  
 SCALE: 1/2" = 1'-0"

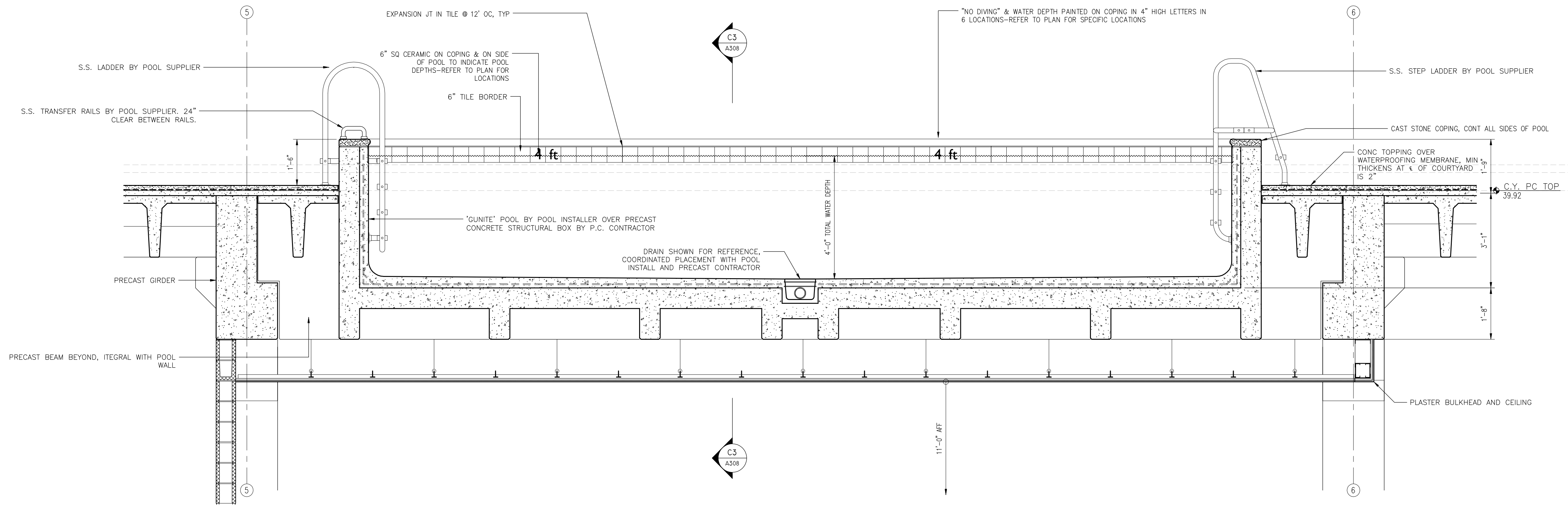
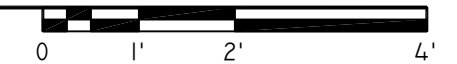

**A1**  
**A308** POOL SECTIONS  
 SCALE: 1/2" = 1'-0"



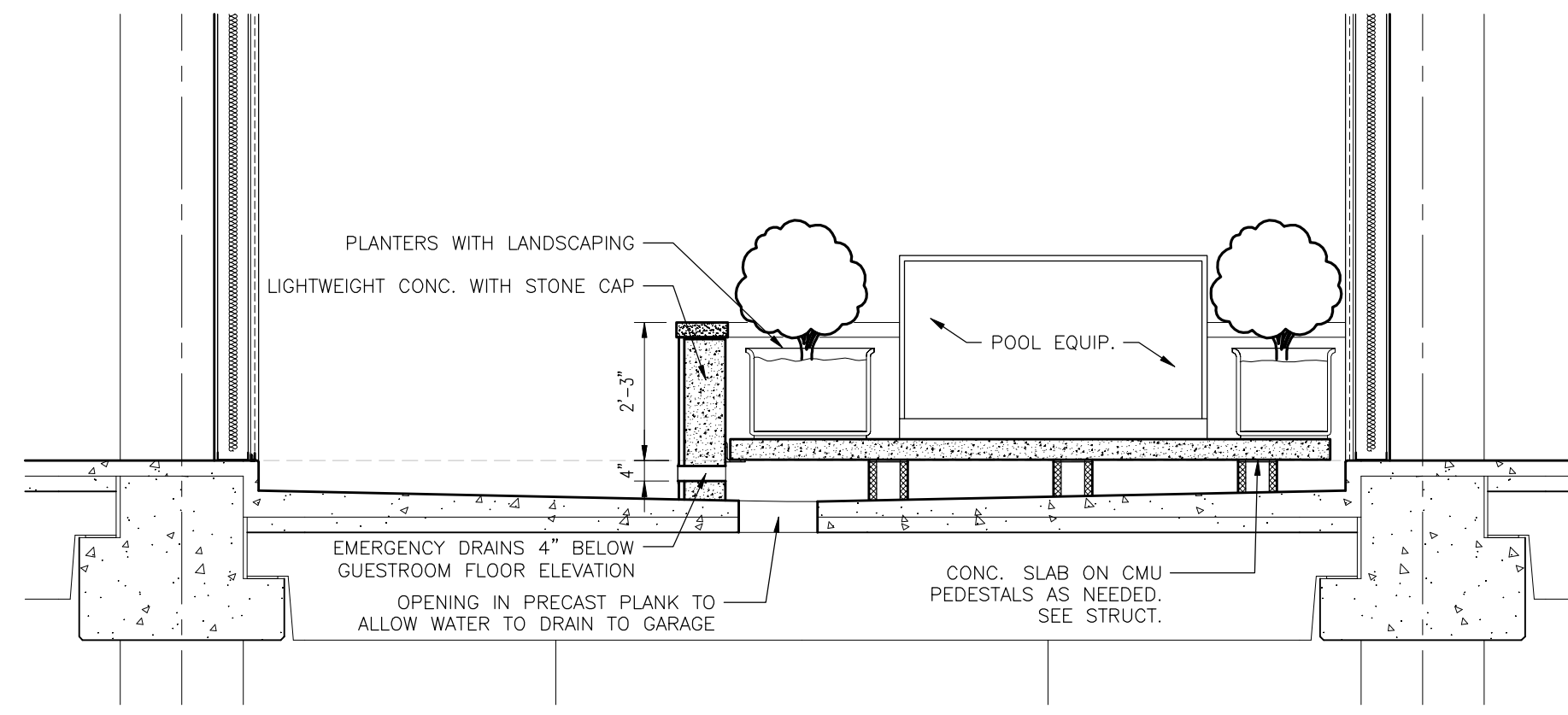

**A1**  
**A307** POOL EQUIPMENT PLATFORM SECTION  
 SCALE: 3/8" = 1'-0"

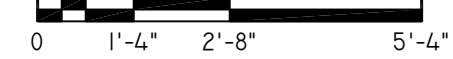

|             |                        |                         |                    |                          |            |                                 |  |                            |
|-------------|------------------------|-------------------------|--------------------|--------------------------|------------|---------------------------------|--|----------------------------|
| <b>A307</b> | MISCELLANEOUS SECTIONS | PLOT DATE<br>11-09-2015 | PROJECT NO.<br>436 | DRAWING FILE<br>A307.rvt | DES<br>GCM | <b>PALMISANO</b><br>CONTRACTORS | <b>RAMPART HOMEWOOD</b><br>317 NORTH RAMPART ST. NEW ORLEANS, LA | <b>HCL</b><br>architecture |
|             |                        |                         |                    |                          |            |                                 |  |                            |