

WAX MUSEUM CONDOS

917 CONTI STREET
 NEW ORLEANS, LA.

THESE PLANS AND SPECIFICATIONS HAVE BEEN PREPARED BY THE ARCHITECT AND TO THE BEST OF HIS KNOWLEDGE AND BELIEF THEY COMPLY WITH ALL CITY, STATE AND FEDERAL REQUIREMENTS AND ALL APPLICABLE CODES AND REGULATIONS. THE ARCHITECT MAKES NO WARRANTY OR REPRESENTATION, EXPRESSED OR IMPLIED, AS TO THE ACCURACY, COMPLETENESS OR SUFFICIENCY OF THESE PLANS AND SPECIFICATIONS. THE ARCHITECT'S RESPONSIBILITY IS LIMITED TO THE DESIGN AND CONSTRUCTION OF THE WORK SHOWN ON THESE PLANS AND SPECIFICATIONS. THE ARCHITECT IS NOT RESPONSIBLE FOR THE DESIGN OR CONSTRUCTION OF ANY OTHER WORK SHOWN ON THESE PLANS AND SPECIFICATIONS. THE ARCHITECT'S LIABILITY IS LIMITED TO THE DESIGN AND CONSTRUCTION OF THE WORK SHOWN ON THESE PLANS AND SPECIFICATIONS. THE ARCHITECT'S LIABILITY IS LIMITED TO THE DESIGN AND CONSTRUCTION OF THE WORK SHOWN ON THESE PLANS AND SPECIFICATIONS.

CERTIFIED CORRECT

REVISION	DATE	DESCRIPTION
1	06/20/16	SCHEMATIC DESIGN
2	07/14/16	DESIGN DEVELOPMENT
3	08/19/16	FOUNDATION PERMIT
4	09/30/16	VCC PERMIT REVIEW
5	11/07/16	FIRE MARSHALL RESPONSE
6	11/29/16	VCC FINAL PERMIT REVIEW
7	01/17/17	ARCH. PERMIT REVIEW

FOURTH FLOOR PLAN

PROJECT#: 1435
 PHASE: PERMIT
 DRAFTER: RUMBLEY
 CHECKER: SMITH
 SCALE: AS NOTED
 ISSUED: 11/17/2017
 SHEET#:

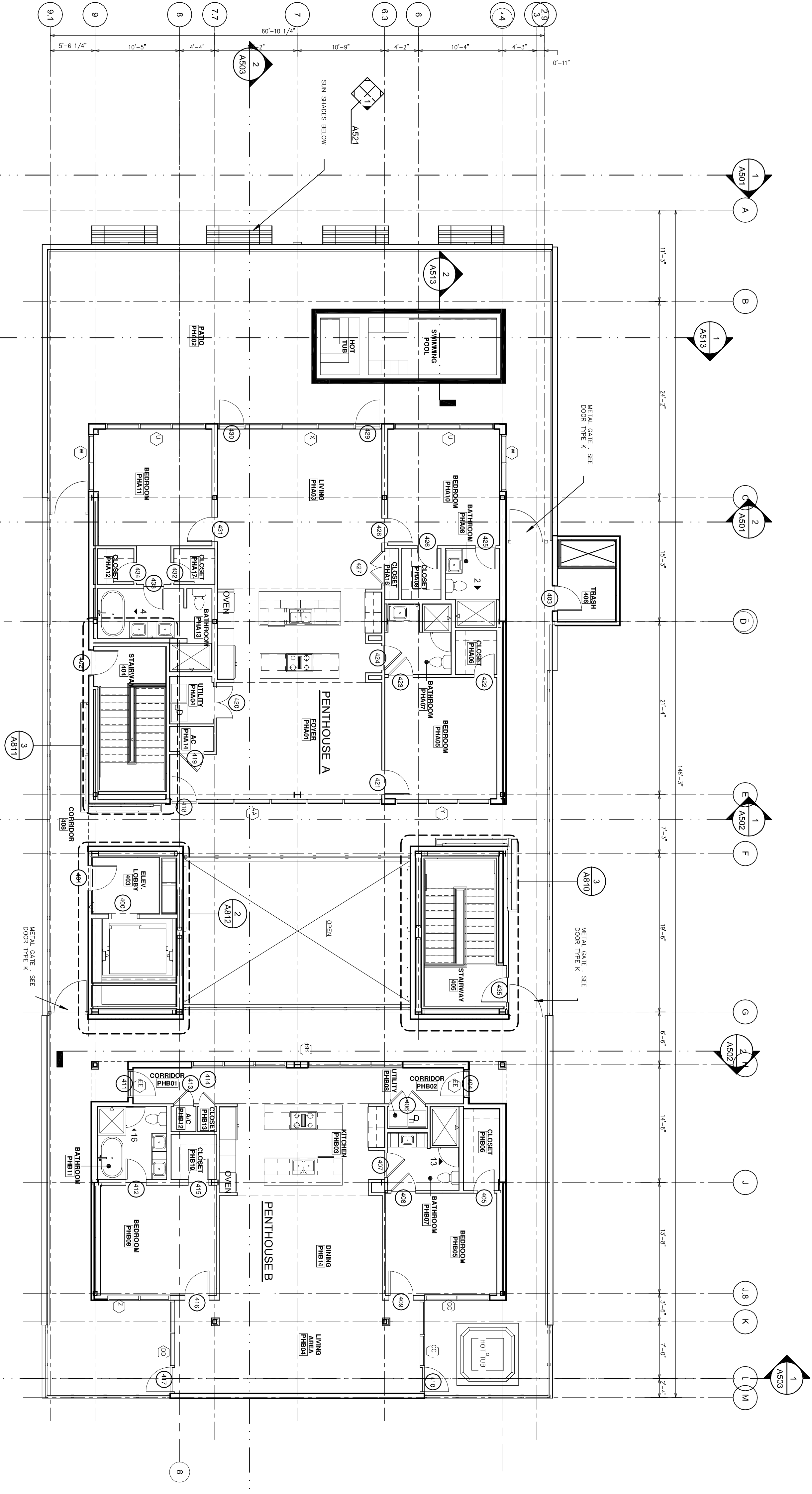

FOURTH FLOOR PLAN
 SCALE: 1/8" = 1'-0"

