

WAX MUSEUM CONDOS
 917 CONTI STREET
 NEW ORLEANS, LA.

THESE PLANS AND SPECIFICATIONS HAVE BEEN PREPARED BY ME OR UNDER MY CLOSE PERSONAL SUPERVISION AND TO THE BEST OF MY KNOWLEDGE AND BELIEF THEY COMPLY WITH ALL CITY, STATE AND FEDERAL REQUIREMENTS, AND I AM PROVIDING CONTRACT ADMINISTRATION.

CERTIFIED CORRECT

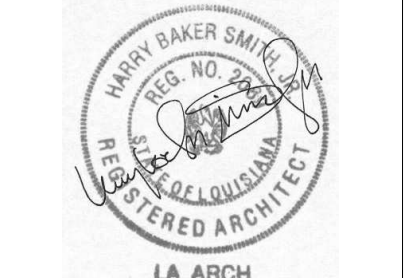

THIS DRAWING IS CONFIDENTIAL AND NOT BE LOANED, REPRODUCED, COPIED, EITHER WHOLLY OR IN PART, OR MADE PUBLIC IN ANY MANNER WITHOUT THE WRITTEN CONSENT OF HBSA II ARCHITECTS, A PROFESSIONAL L.L.C. ALL RIGHTS OF DESIGN OR INVENTION ARE RESERVED AND WILL REMAIN THE SOLE PROPERTY OF HBSA II ARCHITECTS A PROFESSIONAL L.L.C.

REVISION HISTORY						
NO.	DATE	DESCRIPTION	BY	CHKD	APP'D	REVISED
1	06/20/16	SCHEMATIC DESIGN				
2	07/14/16	DESIGN DEVELOPMENT				
3	08/19/16	FOUNDATION PERMIT				
4	09/30/16	VCC PERMIT REVIEW				
5	11/07/16	FIRE MARSHALL RESPONSE				
6	11/29/16	VCC FINAL PERMIT REVIEW				
7	01/17/17	ARCH. PERMIT REVIEW				

FIRST FLOOR PLAN
 PROJECT#: 1435
 PHASE: PERMIT
 DRAFTER: GR
 CHECKER: HS
 SCALE: AS NOTED
 ISSUED: 11/17/2017
 SHEET#:

A101

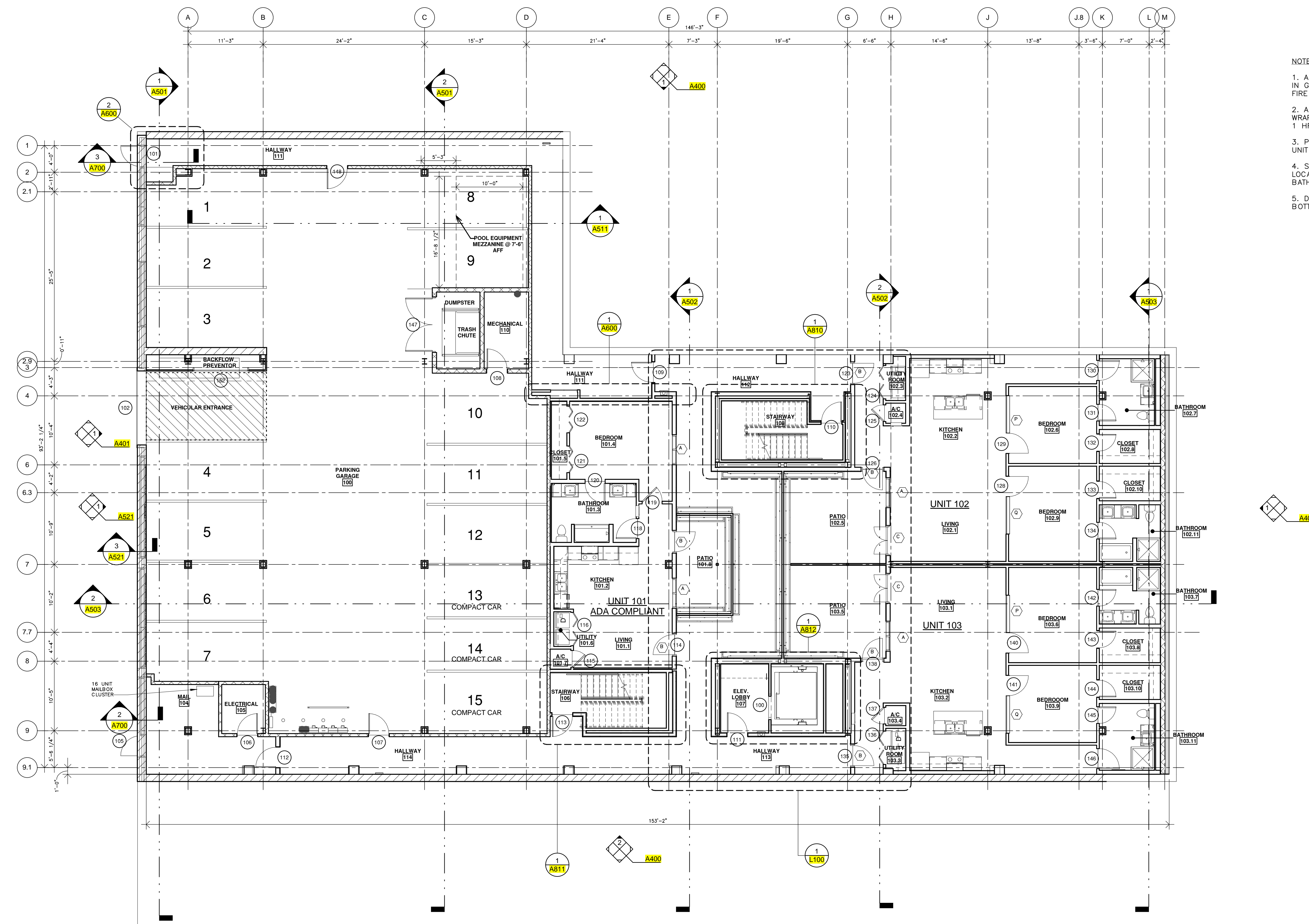

- NOTES:
1. ALL EXPOSED HORIZONTAL STRUCTURE IN GARAGE TO BE SPRAYED FOR 1HR. FIRE RATING PER CODE.
 2. ALL COLUMNS IN GARAGE TO BE WRAPPED W. FIRE RATED GYP. TO MEET 1 HR. RATING.
 3. PROVIDE ADA BLOCKING IN WALL IN UNIT 101
 4. SEE INTERIOR ELEVATIONS FOR LOCATIONS OF ALL HALF WALLS IN BATHROOMS
 5. DEMISING WALLS TO EXTEND UP TO BOTTOM OF SLAB

1 FIRST FLOOR PLAN
 SCALE: 1/8" = 1'-0"

