

**WAX MUSEUM CONDOS**  
 917 CONTI STREET  
 NEW ORLEANS, LA.

THESE PLANS AND SPECIFICATIONS HAVE BEEN PREPARED BY ME OR UNDER MY CLOSE PERSONAL SUPERVISION AND TO THE BEST OF MY KNOWLEDGE AND BELIEF THEY COMPLY WITH ALL CITY, STATE AND FEDERAL REQUIREMENTS, AND I AM NOT PROVIDING CONTRACT ADMINISTRATION.

CERTIFIED CORRECT

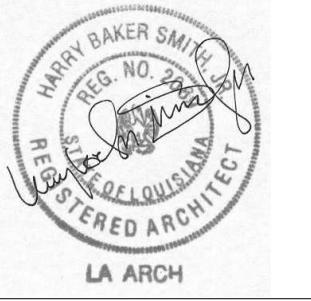

THIS DRAWING IS CONFIDENTIAL AND NOT BE LOANED, REPRODUCED, COPIED, EITHER WHOLLY OR IN PART, OR MADE PUBLIC IN ANY MANNER WITHOUT THE WRITTEN CONSENT OF HBSA II ARCHITECTS, A PROFESSIONAL L.L.C. ALL RIGHTS OF DESIGN OR INVENTION ARE RESERVED AND WILL REMAIN THE SOLE PROPERTY OF HBSA II ARCHITECTS A PROFESSIONAL L.L.C.

| REVISION HISTORY |                                  |
|------------------|----------------------------------|
| 1                | 06/20/16 SCHEMATIC DESIGN        |
| 2                | 07/14/16 DESIGN DEVELOPMENT      |
| 3                | 08/19/16 FOUNDATION PERMIT       |
| 4                | 09/30/16 VCC PERMIT REVIEW       |
| 5                | 11/07/16 FIRE MARSHALL RESPONSE  |
| 6                | 11/29/16 VCC FINAL PERMIT REVIEW |
| 7                | 01/17/17 ARCH. PERMIT REVIEW     |

**SECOND FLOOR PLAN**

PROJECT#: 1435  
 PHASE: PERMIT  
 DRAFTER: Author  
 CHECKER: Checker  
 SCALE: AS NOTED  
 ISSUED: 11/17/2017  
 SHEET#:

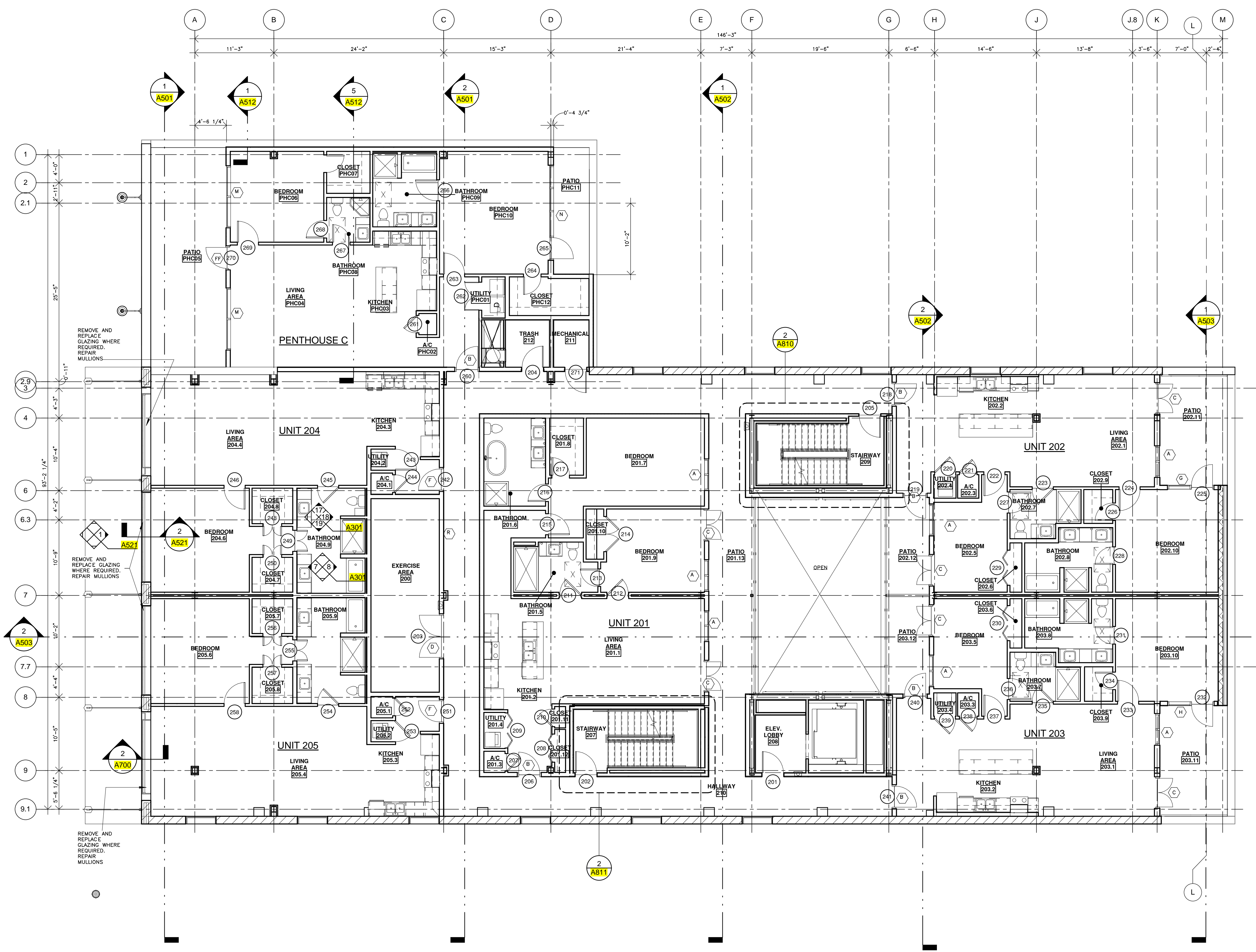

**1 SECOND FLOOR PLAN**  
 SCALE: 1/8" = 1'-0"

