

**OPTIONAL METAL ROOFING**  
 OPTIONAL METAL ROOFING SHALL BE 29 GAUGE OVER ONE PLY 15# FELT OVER 1/2" OSB SHEATHING WITH 29 GAUGE RIDGE CAP, EAVE TRIM AND RAKE TRIM. SCREEN CLOSURE OVER RIDGE OPENING.

**ROOF SHEATHING**  
 TRUSSES 16" O.C. 1/2" OSB  
 TRUSSES 24" O.C. 5/8" OSB  
**ROOF VENT**  
 FIBERGLASS: ALUMINUM RIDGE CAP W/ SCREEN  
 METAL: 26 GAUGE RIDGE CAP W/ SCREEN BELOW  
 FASTENERS SHALL COMPLY WITH TABLE R602.3(1) AND SHALL BE GALVANIZED RING SHANK.

NOTES:  
 WOOD TRUSSES SHALL COMPLY WITH R 502.11 AND DESIGN SHALL COMPLY WITH ANSI/ TPI 1 AND APPROVED ACCORDING TO R 106.1. (R = INTERNATIONAL BUILDING CODE)

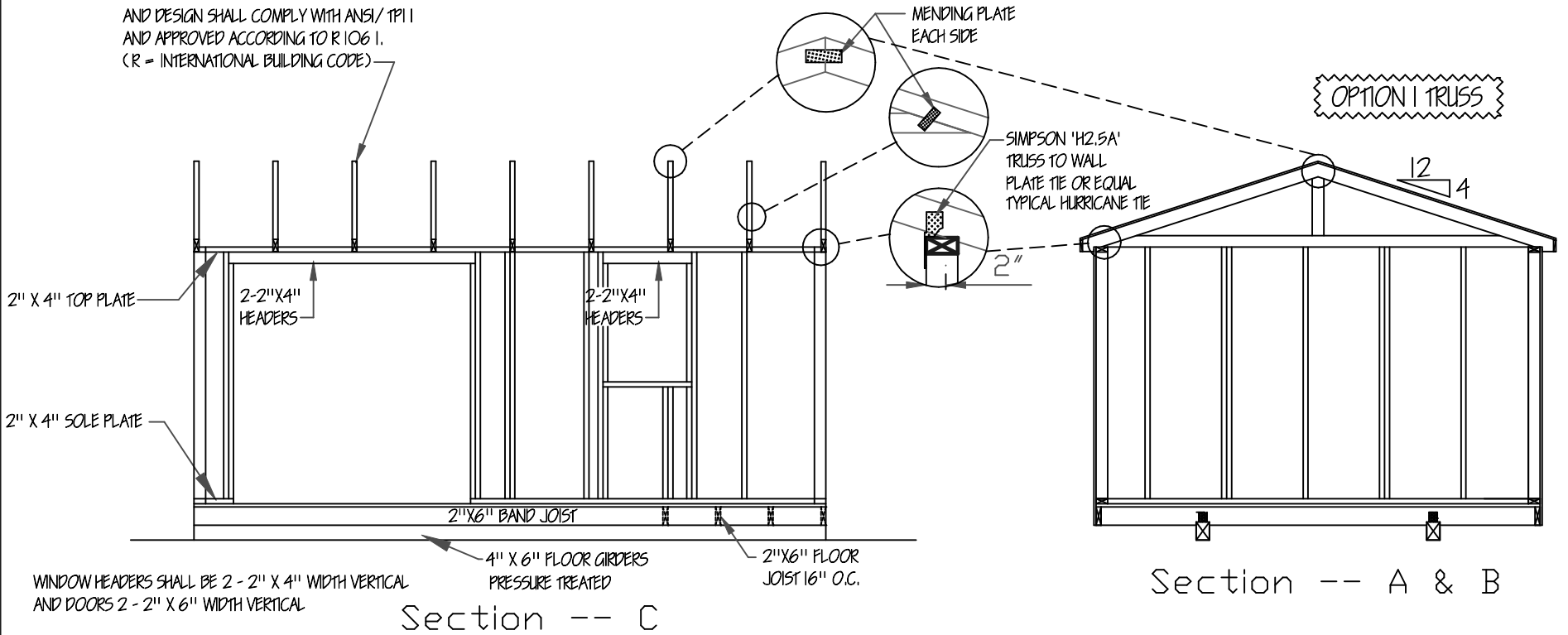

NOTES:  
 WOOD TRUSSES SHALL COMPLY WITH R 502.11 AND DESIGN SHALL COMPLY WITH ANSI/ TPI 1 AND APPROVED ACCORDING TO R 106.1. (R = INTERNATIONAL BUILDING CODE)

30 YEAR FIBERGLASS SHINGLES OVER ONE PLY 15# FELT OVER 1/2" OSB SHEATHING. (5/8" TRUSSES 24" O.C.)

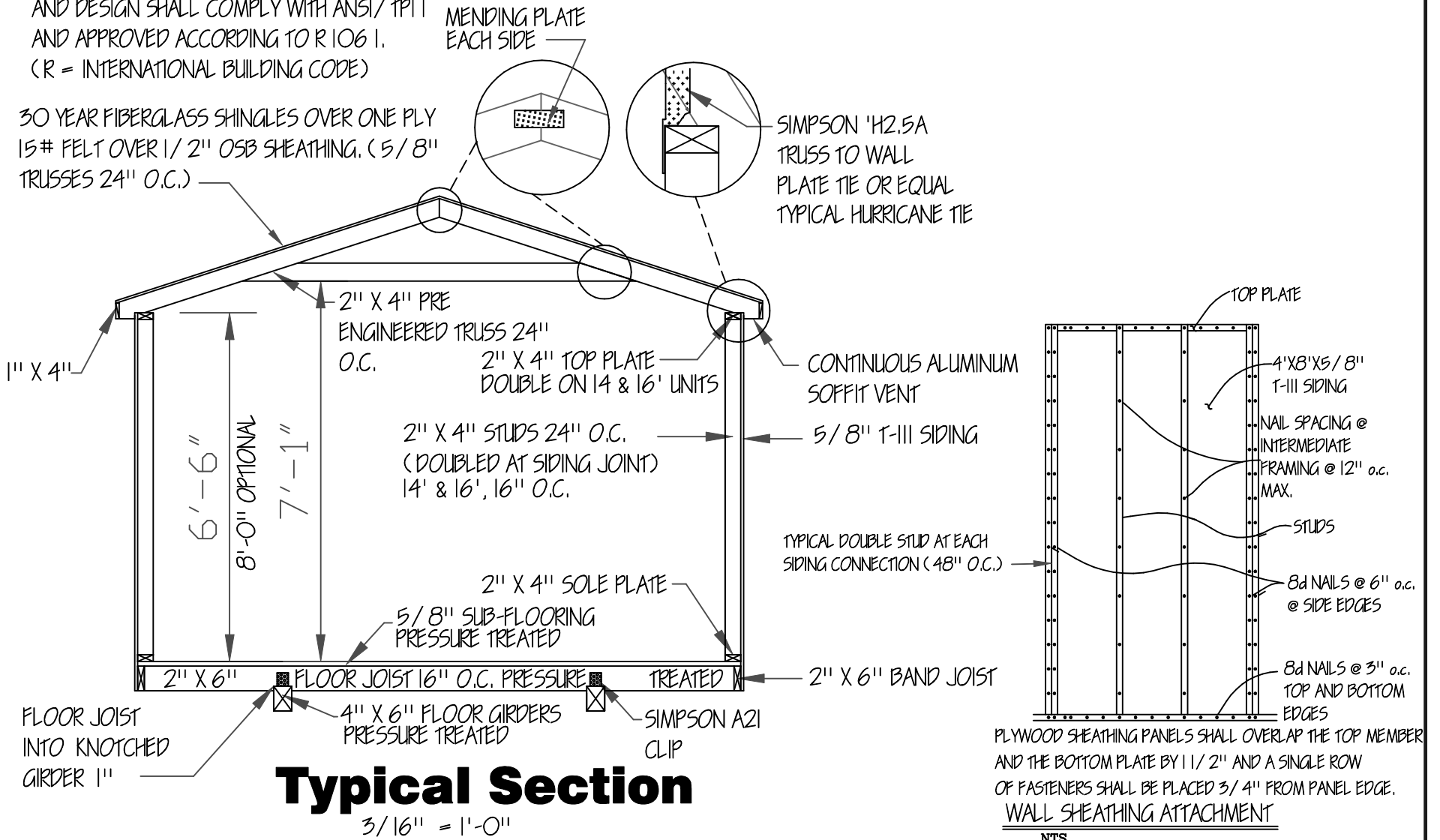

**Typical Section**  
 3/16" = 1'-0"

**GARDEN SHED**

ENGINEERS' NOTES:  
 1. FOUNDATIONS PIERS, TIE-DOWNS AND ANCHORS SHALL MEET THE REQUIREMENTS OF THE "PERMANENT FOUNDATIONS GUIDE OF MANUFACTURED HOUSING" AS PUBLISHED BY HUD IN SEPTEMBER 1996, AND THE HUD HANDBOOK 4145.1 REV. 2.  
 2. NO FIELD SUPERVISION PROVIDED UNDER THIS SEAL.  
 3. NO ADMINISTRATION PROVIDED UNDER THIS SEAL.

**DAMMON ENGINEERING**  
 1095 FLORIDA AVE.  
 SLIDELL, LOUISIANA  
 985 - 649 - 5832



doug's  
 plan  
 Service

4210 Stewart Lane  
 Perkinston, MS 39573  
 228/255-5259

**GRACELAND PROPERTIES LLC**  
 P.O. BOX 665  
 CUNNINGHAM, KY 42035  
 601 - 799 - 4545

Copyright (C) 2008 by Graceland Properties LLC  
 All Rights Reserved, including the rights of reproduction in whole or in part in any form.

MISSISSIPPI-LOUISIANA