

SUGA SCOOPS CAFE

SUGA SCOOPS CAFE LLC.
1823 S.W. RAILROAD AVE.
SUITE C
HAMMOND LA 70403

TOTAL SQ FT. - 1,110 S.F.
BUILDING TYPE - IIB
OCCUPANCY - GROUP M
OCCUPANCY DINING RM 420
S.F. - 14
OCCUPANCY SERVICE AREA
396 S.F. - 4
LONGEST DISTANCE TO EXIT -
33'-2"
EXITS - 2 EA. 3'-0"

- A - MOP SINK 24"x24"
- B - WALK IN COOLER 4'x6'
- C - WALK IN FREEZER 6'x6'
- D - 3 COMP SINK 7'-6"x1'-10"
- E - ICE CREAM
DISPLAY/REACH-IN
3'-5"x2'-1"
- F - ICE CREAM DIPPING CABINET
W/SINK
- G - SODA FOUNTAIN
- H - ICE MACHINE
- I - UNDER COUNTER TRASH RECP.
- J - CASH REGISTER
- K - ICE CREAM MACHINE
- L - GRANITA MACHINE
- M - HAND SINK
- N - ESPRESSO MACHINE
- O - REFRIGERATOR
- P - HOT DOG WARMER
- Q -
- R - CREP MAKER
- S - FLIP UP COUNTER
- T - UNDER COUNTER MICROWAVE
- U - UNDER COUNTER TRASH
RECP.

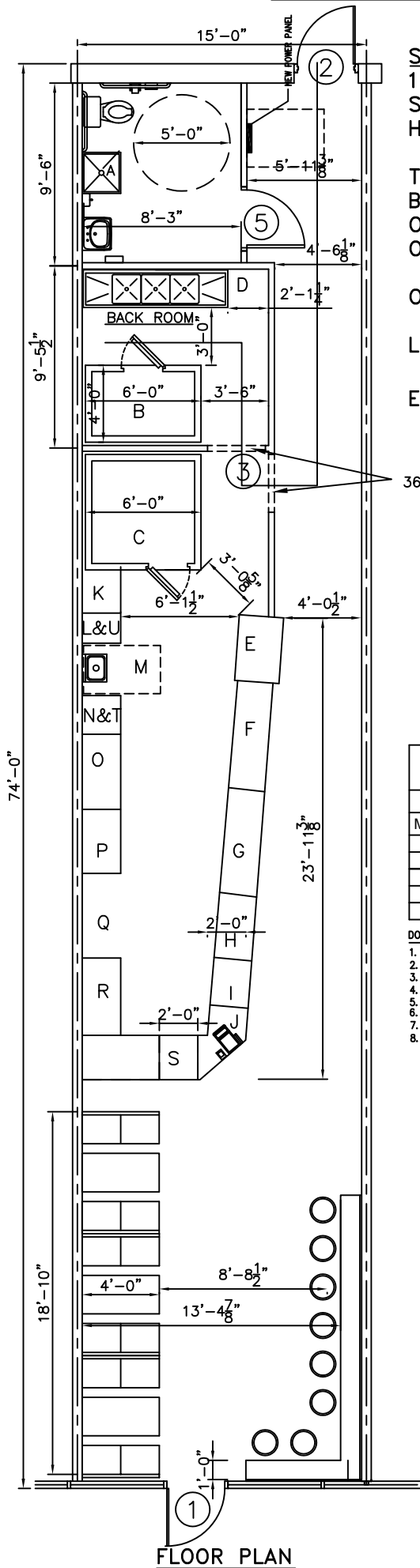

DOOR SCHEDULE (X)

DOOR						REMARKS
MK.	TYPE	MAT'L	SIZE	THK	FIN	
1	EXISTING	-	3'-0"x6'-8"	-	-	NOTES 1, 2, 6 AND 8
2	EXISTING	-	3'-0"x6'-8"	-	-	NOTE 8
3	EXISTING	-	3'-0" x 6'-8"	-	-	CASSED OPENING
4	1	SCW	3'-0"x6'-8"	1 3/4"	-	
5	EXISTING	SCW	3'-0"x6'-8"	1 3/4"	-	NOTE 7

- DOOR/FRAME SCHEDULE NOTES: (NOTE: ELIASON DOOR INFORMATION TO BE USED ONLY IF AN ELIASON DOOR IS SHOWN).
- DOOR TO HAVE A SIGN THAT READS "DOOR TO REMAIN UNLOCKED DURING REGULAR BUSINESS HOURS".
 - EXISTING DOOR AND FRAME TO MATCH EXISTING STOREFRONT CONFIGURATION, COLOR AND FINISH.
 - ELIASON DOOR - DOOR IS NOT SUPPLIED WITH FRAME. PROVIDE HOLLOW METAL FRAME WITH NO STOPS.
 - ELIASON LWP 6 EASY SWING DOUBLE ACTION DOOR WITH 14"x16" CLEAR VINYL WINDOW, COLOR DARK BROWN.
 - ELIASON EASY SWING DOOR PROVIDED BY NATIONAL RESTAURANT SUPPLY. FOR MORE INFO VISIT WWW.ELIASONCORP.COM
 - EXISTING HARDWARE TO REMAIN, VERIFY WITH OWNER ANY ADDITIONAL HARDWARE REQUIRED.
 - UNDERCUT RESTROOM DOORS 3/4".
 - LOCKS ON DOORS IN MEANS OF EGRESS SHALL NOT REQUIRE THE USE OF A KEY (INTERIOR SIDE), SPECIAL DEVICE OR SPECIAL KNOWLEDGE TO OPEN IN THE DIRECTION OF EGRESS. ALL DOORS SHALL HAVE LEVER TYPE HANDLES.

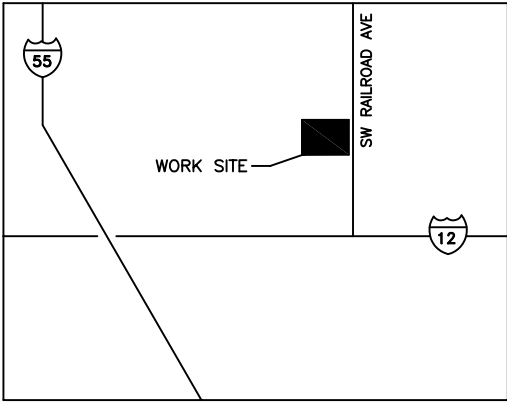

VICINITY MAP
N.T.S.