

LIFE-SAFETY INFORMATION

APPLICABLE CODES
 NFPA 101 LIFE-SAFETY CODE 2012
 OCCUPANCY TYPE(S) AND CHAPTER(S)
 STORAGE (CHAPTER 42), BUSINESS (CHAPTER 38)
 MULTIPLE, MIXED, OR SEPARATE OCCUPANCY (REFERENCE CHAPTER 6)
 N/A

OCCUPANT LOAD FACTOR (REFERENCE TABLE 7.3.1.2)
 12,804 SF / 100 SF PER OCCUPANT = 128 OCCUPANTS
 4,630 SF / 300 SF PER OCCUPANT = 15 OCCUPANTS

CLASSIFICATION OF HAZARD OF CONTENTS
 (REFERENCE: OCCUPANCY CHAPTER AND 6.2.2. SPECIFY LOW, ORDINARY, OR HIGH)
 CONSTRUCTION TYPE(S) (REFERENCE: CHAPTERS, TABLE A.9.2.1.2 AND COMMENTARY TABLE 8.1 IN HANDBOOK)
 III(200)

MINIMUM EXIT SEPARATION DISTANCE FOR REMOTELY LOCATED EXITS
 (REFERENCE: SECTION 7.5; SPECIFY 1/2 OR 1/3 DIAGONAL DISTANCE OF AREA SERVED)
 1/2 DIAGONAL = N/A

MAXIMUM DEAD-END CORRIDORS (REFERENCE: OCCUPANCY CHAPTER AND TABLE A.7.6)
 20'

MAXIMUM COMMON PATH OF TRAVEL DISTANCE (REFERENCE: OCCUPANCY CHAPTER AND TABLE A.7.6)
 75'

MAXIMUM TRAVEL DISTANCE TO EXITS (REFERENCE: OCCUPANCY CHAPTER AND TABLE A.7.6)
 200'

*MAIN ENTRANCE MUST BE SIGNED TO ACCOMMODATE 1/2 OCCUPANT LOAD OF BUILDING

EXTINGUISHMENT REQUIREMENTS SPRINKLER NOT REQUIRED

DETECTION, ALARM, AND COMMUNICATION SYSTEMS NO

ALLOWABLE HEIGHT AND BUILDING AREA PER IBC EQUIVALENT CONSTRUCTION TYPE

BUILDING CODE INFORMATION

APPLICABLE CODES
 IBC 2012

BUSINESS GROUP B (IBC 2012 CHAPTER 13)
 ORDINARY-HAZARD STORAGE 5-2

OCCUPANT LOAD CALCULATIONS (TABLE 1004.1.1)
 BUSINESS = 12,804 SQ FT 100 SF PER OCCUPANT (GROSS) 128 OCCUPANTS
 ACCESSORY STORAGE = 4,630 SQ FT 300 SF PER OCCUPANT (GROSS) 15 OCCUPANTS

CONSTRUCTION TYPE(S) (TABLE 603)
 IIB (SECTION 603)

ALLOWABLE HEIGHT AND BUILDING AREA LIMITED BY TYPE OF CONSTRUCTION
 MAXIMUM HEIGHT IN STOREYS (SECTION 603 & 604, TABLE 603) 2
 MAXIMUM AREA IN SQUARE FEET (SECTION 603, 606 & 607, TABLE 603) 13,500

WIND SPEED DESIGN REQUIREMENTS

THIS BUILDING SHALL BE DESIGNED WITH IBC SEC 1609 AS A FULLY ENCLOSED BLDG USING THE FOLLOWING INFORMATION:

WIND DESIGN DATA:
 DETERMINATION OF WIND LOADS SHALL BE IN ACCORDANCE WITH IBC SEC 1609.3 (A), (B), OR (C) DEPENDING ON THE RISK CATEGORY

WIND SPEED V_{ULT} (3 SECOND GUST) = 143 MPH (IBC FIG 1609A)
 NOMINAL DESIGN WIND SPEED V_{REF} = 111 MPH (V_{ULT} x (0.6)^{1/2})

RISK CATEGORY: CATEGORY II BLDG SURFACE ROUGHNESS = C
 TOPOGRAPHIC FACTOR = 1 EXPOSURE = C

DESIGN WIND PRESSURE (ASCE 7-10 TABLE 26.6-1): 43.8 PSF
 INTERNAL PRESSURE COEFFICIENT (ASCE 7-10 TABLE 26.11-1): ± 0.18

LIVE LOADS (IBC SEC 1607):
 OFFICE LOBBIES & CORRIDORS 1ST FLOOR (IBC TABLE 1607.1): 100 PSF
 OFFICES (IBC TABLE 1607.1): 50 PSF
 ROOF LIVE LOADS (IBC TABLE 1607.1): 20 PSF UNIFORM, 300 LB CONCENTRATED

SNOW LOADS (IBC SEC 1608):
 GROUND SNOW LOAD (IBC FIG 1608.2): 5 PSF

FLOOD ZONE INFORMATION

REFERENCE PLANS: 1) PLAN OF SURVEY BY J. J. KREBS & SONS, INC., DATED FEB. 1, 1994, RECERTIFIED MAY 28, 1996. 2) PLAN OF SURVEY OF LOTS A & B, BY ALBERT A. LOVELL & ASSOCIATES, INC., DATED 10/21/97.

FIRM, COMMUNITY NO. 225205, PANEL 0535 D, DATED APRIL 2, 1991.

FLOOD ZONE: V12 BASE FLOOD ELEVATION: 14 NGVD

ELEVATIONS REFER TO NGVD 1929 DATUM

GRAPHIC SYMBOLS

<p>CEILING HEIGHT</p> <p>CEILING MATERIAL</p> <p>AREA OF DETAIL TO BE ENLARGED</p> <p>SHEET NUMBER</p> <p>DETAIL NUMBER</p> <p>DETAIL NUMBER</p> <p>DETAIL NUMBER</p> <p>DETAIL NUMBER</p>	<p>FINISHED CEILING DESIGNATION SYMBOL</p> <p>DETAIL TAG</p> <p>ELEVATION TAG</p> <p>SECTION TAG</p> <p>COLUMN GRID IDENTIFIER</p> <p>REVISION TAG & CLOUD</p>	<p>DRAWING NO. — DRAWING TITLE</p> <p>1 PLAN — SCALE SCALE</p> <p>TRUE NORTH — DRAWING SCALE</p> <p>PLAN NORTH — DRAWING SUBTITLE</p> <p>DRAWING NO. — DRAWING TITLE</p> <p>1 PLAN — DRAWING SCALE</p> <p>DRAWING SUBTITLE</p> <p>ROOM NAME</p> <p>ROOM NUMBER</p> <p>FLOOR FINISH</p> <p>BASE</p> <p>LEVEL X</p> <p>XX-XXX</p> <p>XXX</p> <p>KEY NOTE (SHEET SPECIFIC)</p>
--	--	---

LIFE-SAFETY LEGEND

SYMBOL	DESCRIPTION
	EXITS
	DOOR FIRE RATING (MINUTES)
	DOOR WIDTH/EGRESS CAPACITY
	EXIT LIGHT
	FIRE EXTINGUISHER AND CABINET
	FIRE EXTINGUISHER W/ WALL MTD BRACKET
	COMMON PATH OF TRAVEL
	TRAVEL DISTANCE
	DECISION POINT
	SMOKE PARTITION
	ONE-HOUR FIRE RATED PARTITION
	TWO-HOUR FIRE RATED PARTITION
	TWO-HOUR FIRE/SMOKE PARTITION
	FOUR-HOUR RATED PARTITION

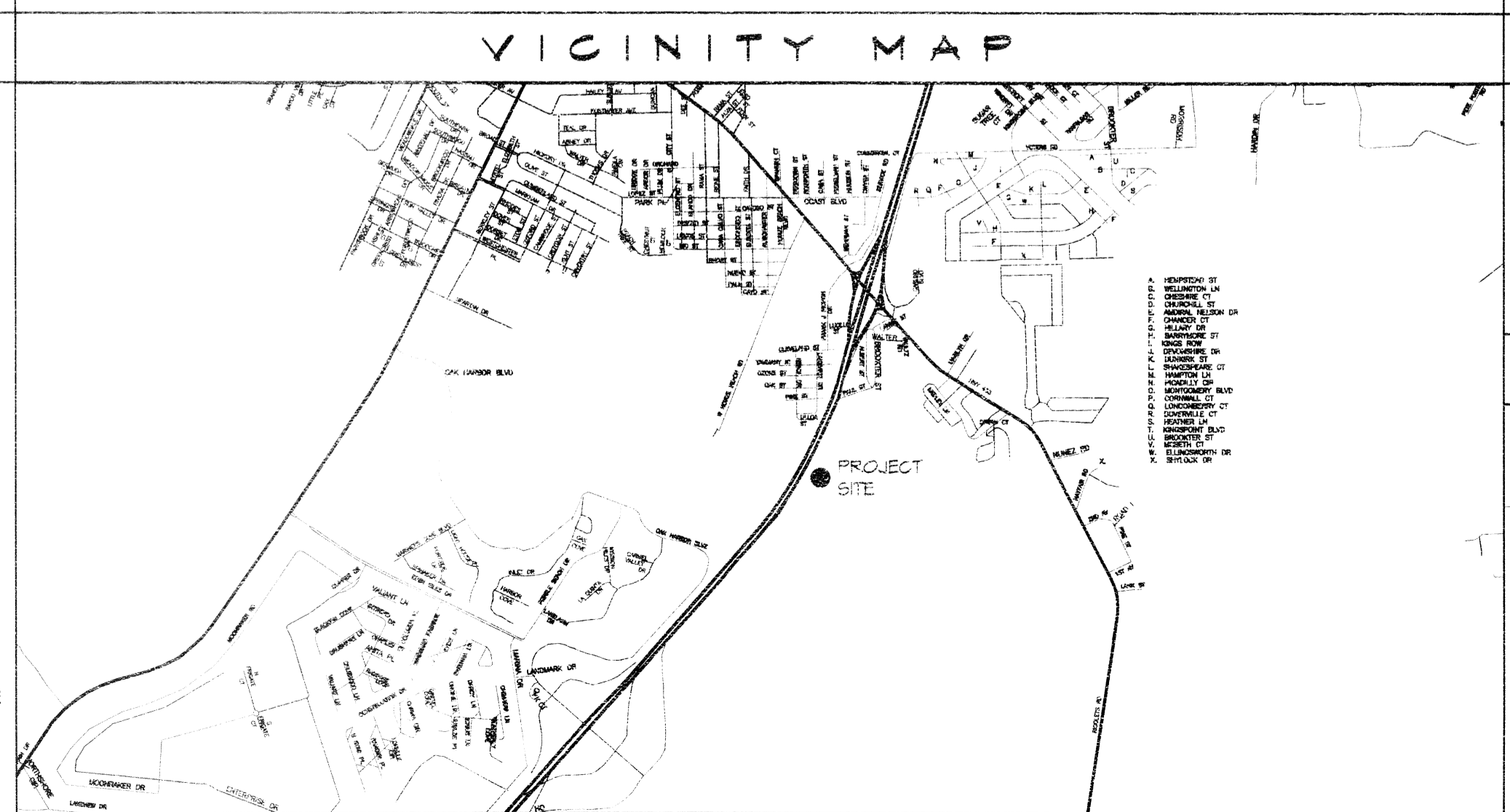
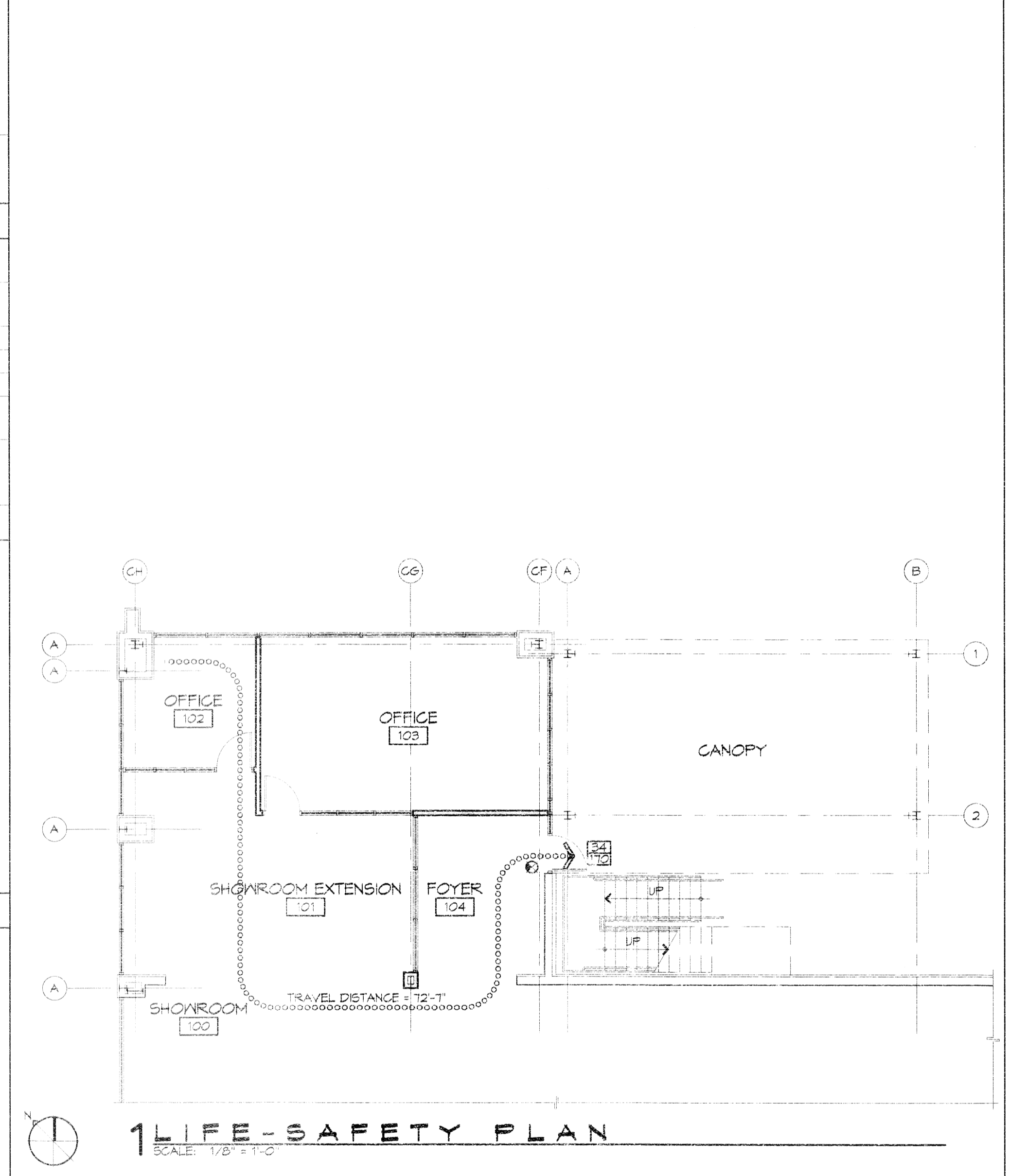

RENOVATIONS TO:

Honda

of Slidell

510 EAST HOWZE BEACH ROAD
 SLIDELL, LA 70461

REVISIONS	DATE

467778

REVIEWED FOR STATE FIRE MARSHAL BY PERMITS DIVISION CHIEF BY CHASSAN HADJID

MAY 1, 2015

467778

SHEET INDEX

SHEET #	SHEET TITLE
G001	GENERAL, LIFE-SAFETY AND CODE INFORMATION SHEET
G002	ADAAGS INFORMATION
G101	SITE PLAN
A101	ARCHITECTURAL FLOOR PLAN AND REFLECTED CEILING PLAN
A102	DOOR FRAME AND STOREFRONT ELEVATIONS
ME101	MECHANICAL AND ELECTRICAL PLANS AND DETAILS

PROJECT STATISTICS

SQUARE FOOTAGE	
EXISTING	28,674 SF
NEW	1,104 SF
TOTAL ENCLOSED SPACE	29,778 SF

PROJECT LOCATION:
 510 HOWZE BEACH ROAD
 SLIDELL, LA 70461
 OWNER:
 HONDA OF SLIDELL
 510 HOWZE BEACH ROAD
 SLIDELL, LA 70461
 (987) 644-9091
 email: keri@hondaofslidell.com

- ### GENERAL NOTES
- ALL MATERIALS AND WORK, INCIDENTAL TO THE CONSTRUCTION OF THIS PROJECT, SHALL CONFORM TO ALL GOVERNING CODES, AND REGULATIONS OF AGENCIES IN AUTHORITY.
 - CONTRACTOR SHALL PROVIDE ALL PUBLIC PROTECTIONS NECESSARY AS REQUIRED BY LAW.
 - THE DRAWINGS, SPECIFICATIONS AND ANY SUBSEQUENTLY ISSUED ADDENDA, AMENDMENTS OR SUCH CHANGE ORDERS APPROVED BY THE OWNER AND THE CONTRACTOR ARE PART OF THESE CONTRACT DOCUMENTS.
 - DO NOT SCALE DRAWINGS. CONSULT WITH THE ARCHITECT REGARDING ANY ITEMS IN THE CONTRACT DOCUMENTS THAT REQUIRE CLARIFICATION.
 - TRASH SHALL BE REMOVED FROM THE SITE NOT LESS THAN TWICE MONTHLY.
 - THE GENERAL CONTRACTOR SHALL VERIFY EXISTING CONDITIONS PRIOR TO COMMENCING WORK AND REPORT ANY AND ALL DISCREPANCIES TO THE ARCHITECT.
 - CONTRACTOR VEHICLES AND EQUIPMENT NECESSARY FOR CONSTRUCTION MAY BE PARKED ON THE SITE. OTHER VEHICLES PARKED ON THE SITE REQUIRE THE OWNER'S PERMISSION.
 - NAMING A CERTAIN BRAND, MAKE OR MANUFACTURER IS TO DESIGNATE THE GENERAL STYLE, TYPE, CHARACTER AND QUALITY STANDARD OF THE PRODUCT DESIRED. SUBSTITUTION REQUESTS MUST BE SUBMITTED PRIOR TO BIDDING.
 - ALL MATERIALS/EQUIPMENT SHALL BE INSTALLED PER MANUFACTURER'S RECOMMENDATIONS. WORK NOT CONSISTENT WITH MANUFACTURER'S RECOMMENDATIONS WILL BE REJECTED BY OWNER/ARCHITECT.

DAMMON ENGINEERING, INC.

Architects & Engineers
 www.dammonengineering.com
 Chief Architect: Kevin J. Kinchen, NCAAB
 Chief Engineer: Brian Mitchell, PE
 554 Old Spanish Trail
 Slidell, LA 70461
 P: 987-644-9091
 F: 987-644-3952

RENOVATIONS TO: HONDA OF SLIDELL

510 EAST HOWZE BEACH ROAD
 SLIDELL, LA 70461
 JOB NO.: 2239
 DATE: MAY 1, 2015
 DRAWN BY: KLS
 CHECKED BY: KLS

SHEET TITLE:
GENERAL INFORMATION,
LIFE-SAFETY AND CODE
INFORMATION

DRAWING NUMBER:
G001

SHEET No: 1 of 6