

PLUMBING FIXTURE SCHEDULE						
ITEM	DESCRIPTION	SOIL OR WASTE	VENT	COLD WATER	HOT WATER	NOTES
WC	WATER CLOSET	4"	4"	1"	—	1 & 3
LAV	LAVATORY	1-1/2"	2"	1/2"	1/2"	1, 2 & 3
MS	MOP SINK	3"	2"	1/2"	1/2"	
FD	FLOOR DRAIN	3"	2"	—	—	
FCO	FLOOR CLEAN OUT	—	—	—	—	
WCO	WALL CLEAN OUT	—	—	—	—	
WH	WATER HEATER	—	—	1-1/2"	1-1/2"	

1. PROVIDE ADA FIXTURE.  
 2. FIXTURE REQUIRES TEMPERATURE CONTROL DEVICE FOR SCALD PROTECTION.  
 3. INSULATE PIPING FOR HANDICAP FIXTURE.

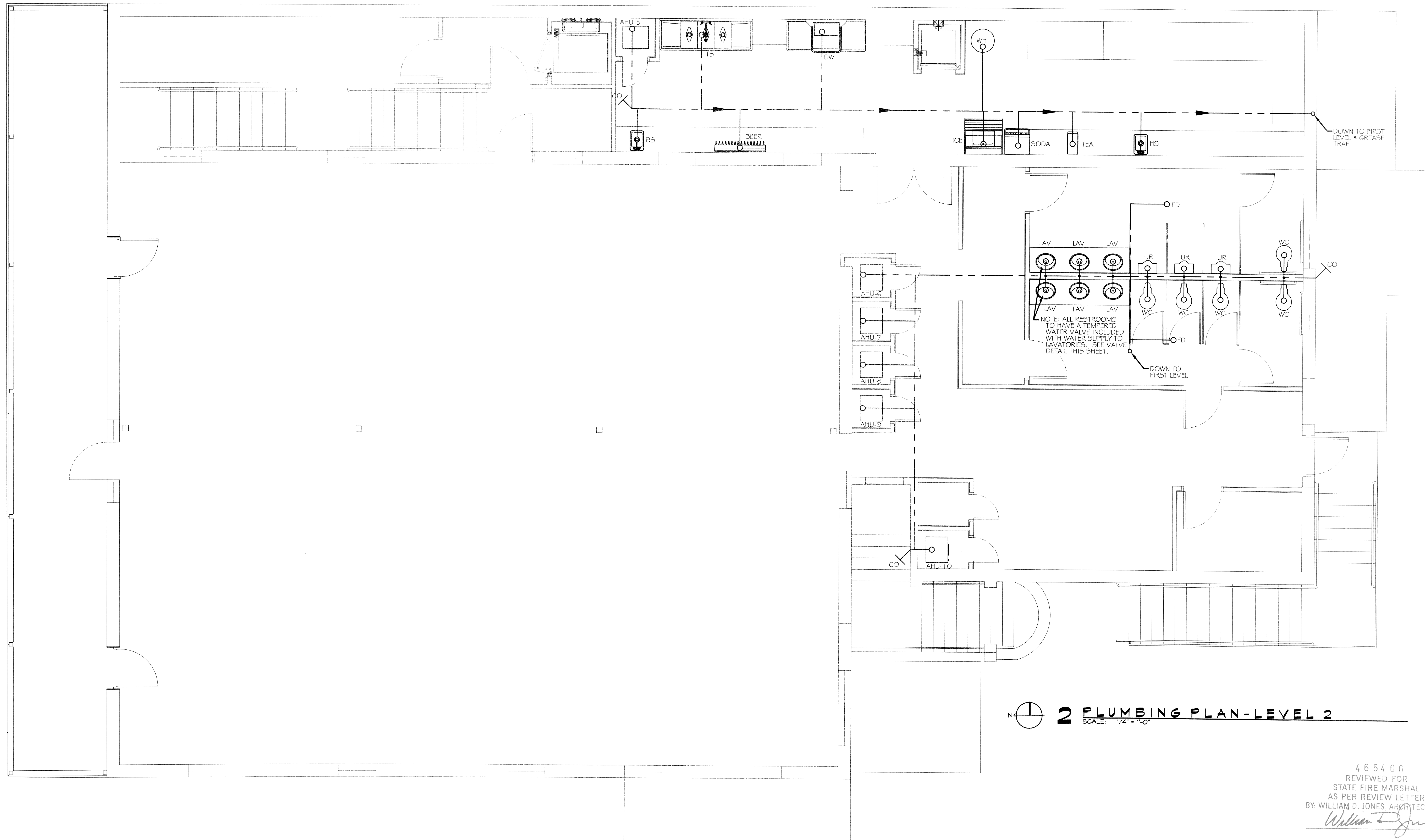
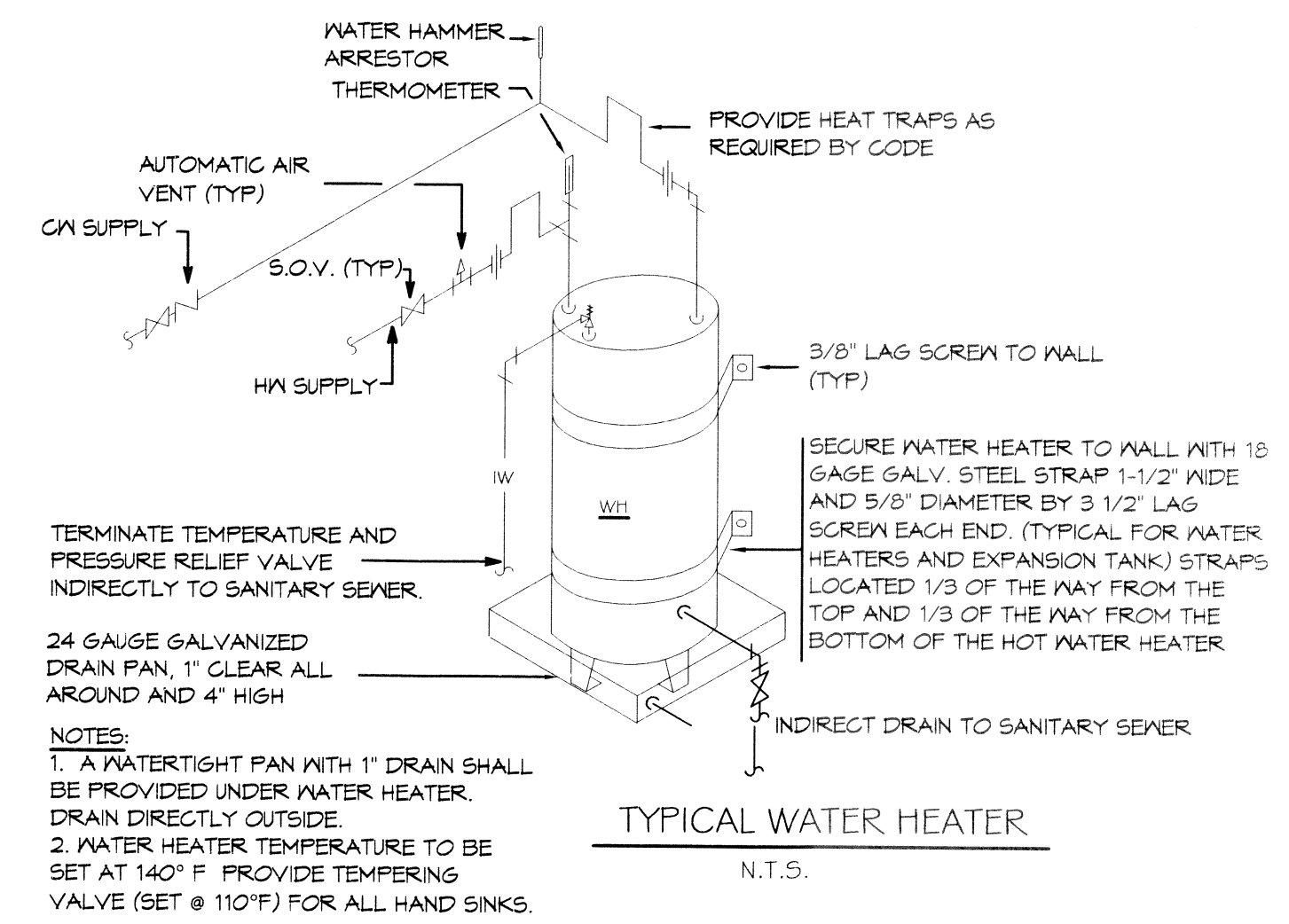

**DAMMON ENGINEERING, INC.**  
 Architects & Engineers  
 www.dammonengineering.com  
 info@dammonengineering.com  
 Ph: 985.649.5832  
 F: 985.641.1990

Chief Architect: Kevin J. Kinchen, NCARB  
 Chief Engineer: Brian Wistich, PE  
 354 Old Spanish Trail  
 Suwanee, GA 30086

REVISIONS	DATE
#	DESCRIPTION

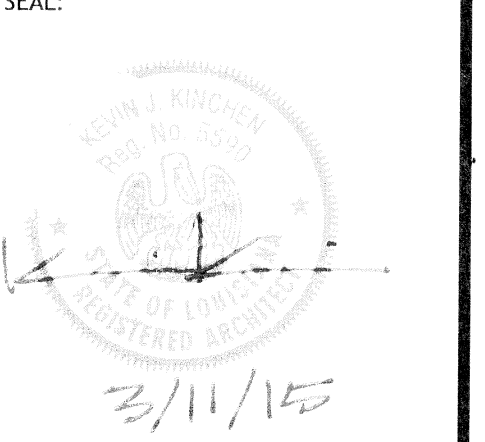

RECEPTION HALL RENOVATION FOR:  
**BEV, INCORPORATED**  
 211 COHEN STREET  
 SUWANEE, LOUISIANA 70459  
 JOB No: 2220 | DATE: MARCH 08-2015  
 DRAWN BY: K-K | CHECKED BY: KCD

SHEET TITLE:  
 PLUMBING PLAN  
 LEVEL 2

DRAWING NUMBER:  
**02**

SHEET No: 10 of 19

2 PLUMBING PLAN-LEVEL 2  
 SCALE: 1/4" = 1'-0"

465406  
 REVIEWED FOR  
 STATE FIRE MARSHAL  
 AS PER REVIEW LETTER  
 BY: WILLIAM D. JONES, ARCHITECT, CBC  
*William D. Jones*