

SCALE: 1"=10'-0"

SITE UTILITY PLAN

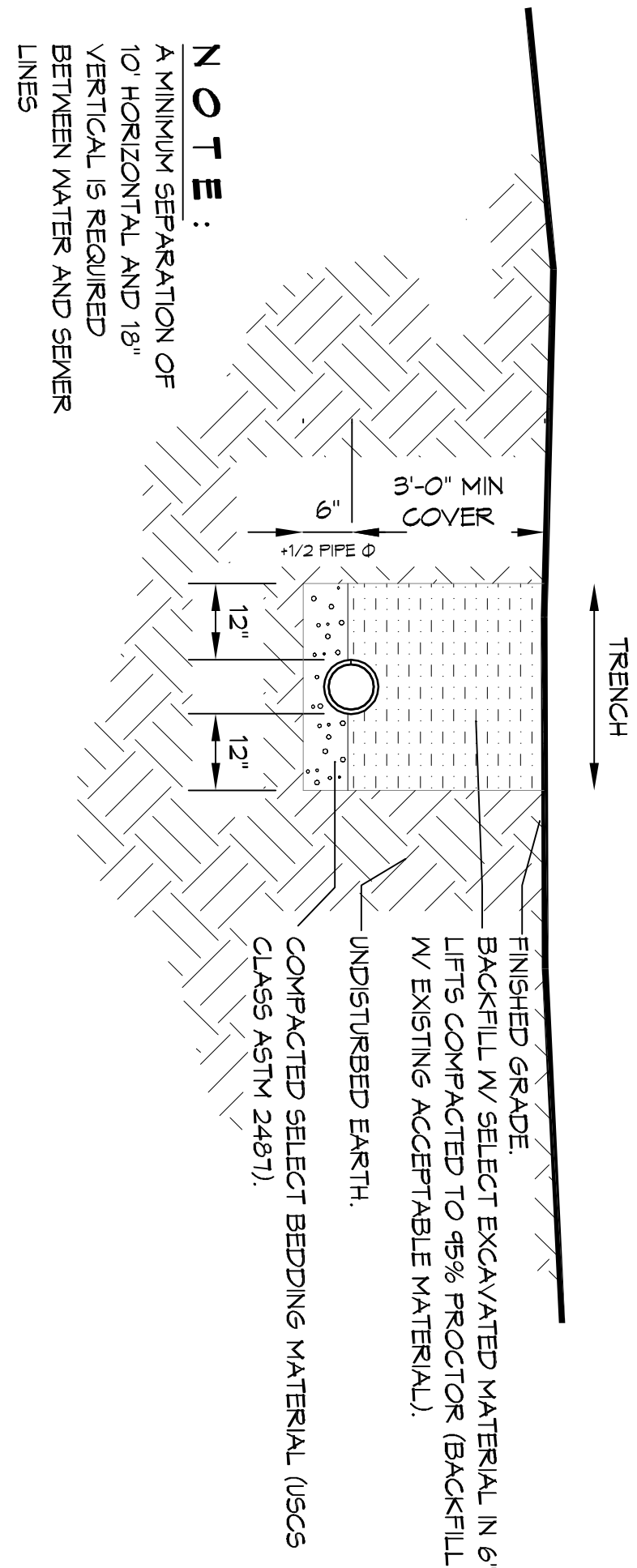
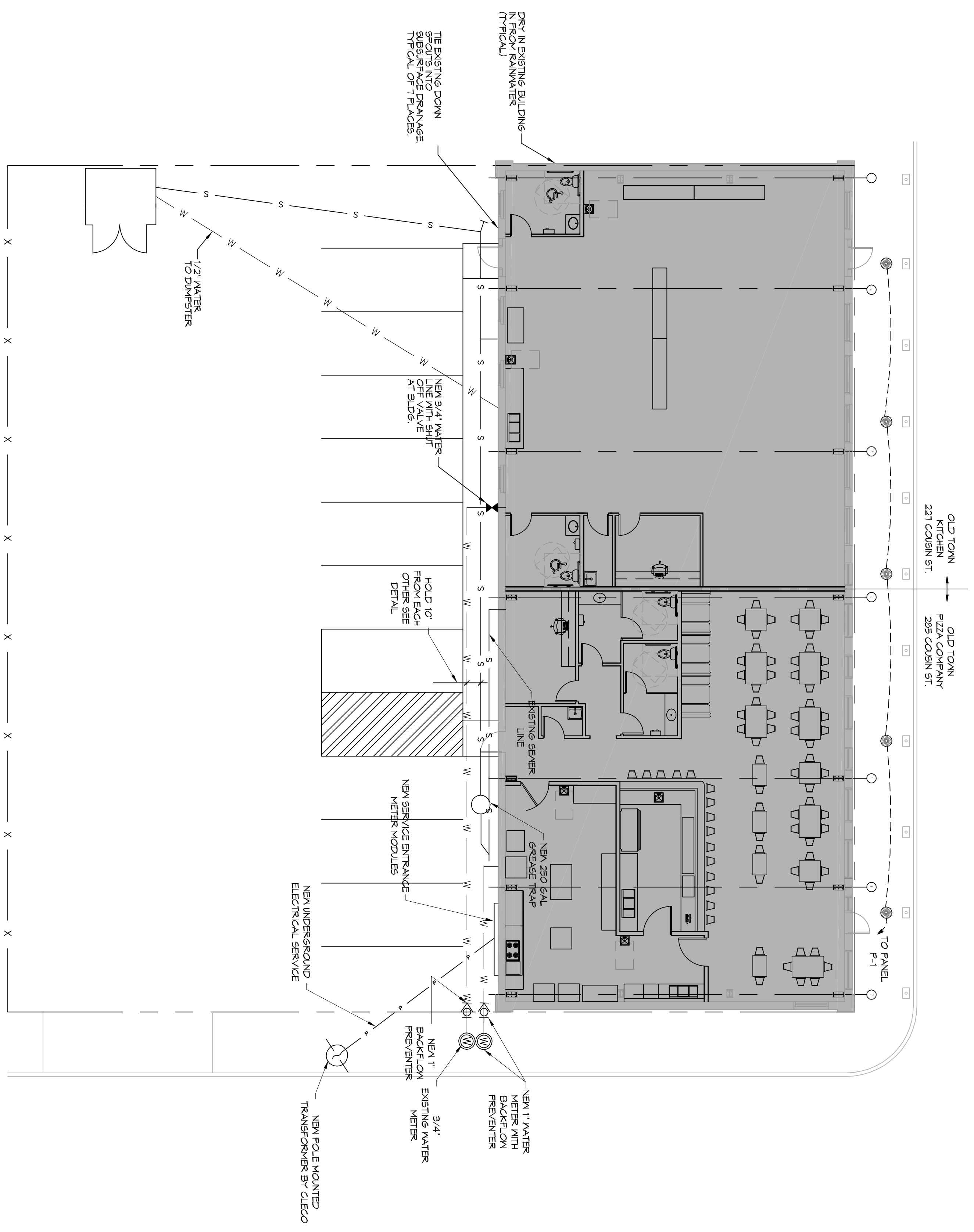

NOTE:
A MINIMUM SEPARATION OF 10\"/>

- ### GENERAL SITE NOTES
1. PROVIDE ALL LABOR, MATERIAL AND EQUIPMENT FOR A COMPLETE OPERATING SYSTEM. CONTRACTOR IS TO FIELD VERIFY ALL EXISTING UTILITY LOCATIONS, ELEVATIONS, AND INVERTS PRIOR TO COMMENCING ANY WORK. CONTRACTOR SHALL PAY NECESSARY FEES FOR THE UTILITIES CONNECTIONS.
 2. CONTRACTOR TO BE RESPONSIBLE TO VERIFY ANY INVERTS AND SET NEW INVERTS OF SEWAGE AND DRAINAGE PIPES.
 3. ALL WORK AND MATERIAL TO COMPLY STRICTLY TO THE LATEST LOCAL CITY PARISH, STATE AND NATIONAL GOVERNING CODES.
 4. SEWAGE LINES 3\"/>

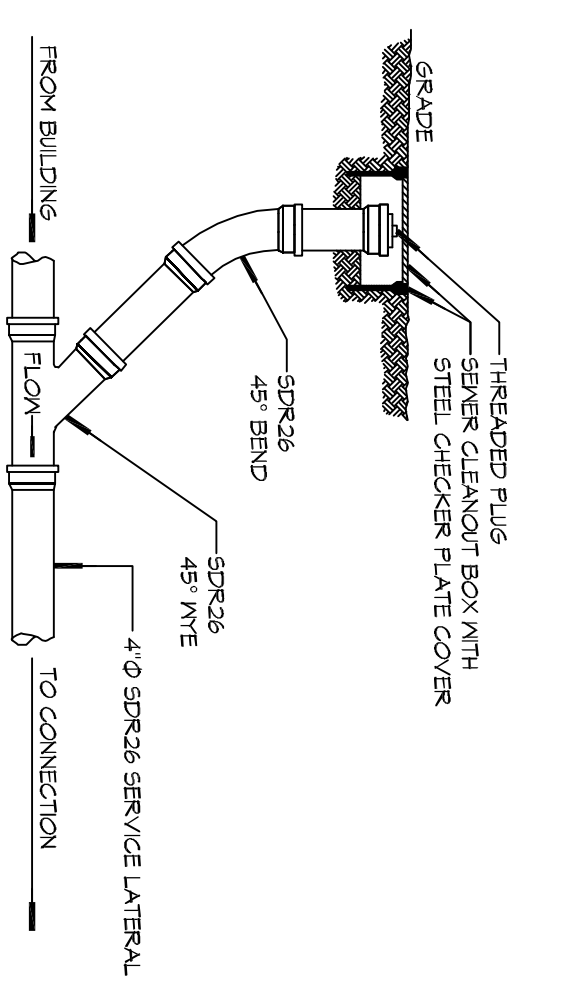
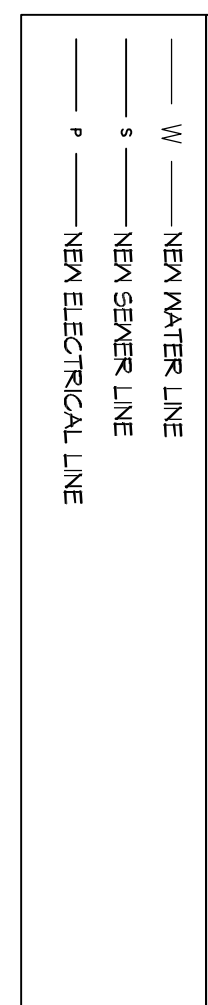

2 DETAIL
SCALE: N.T.S.
SEWER AND WATER SEPARATION

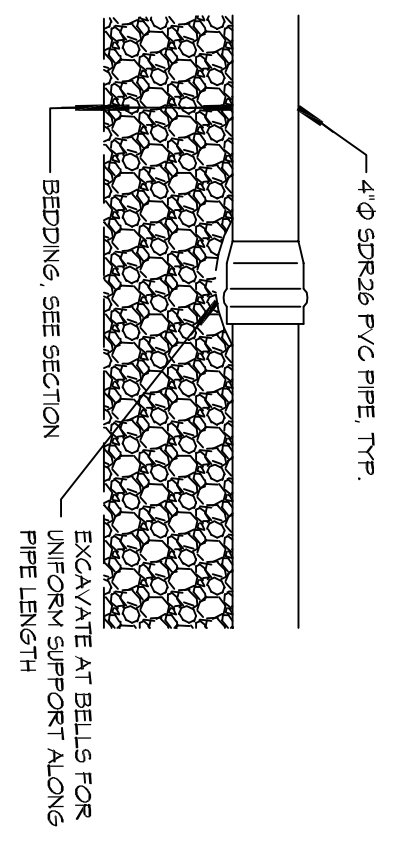

4 DETAIL
SCALE: N.T.S.
TYPICAL PIPE BEDDING

DAMMON ENGINEERING, INC.

LOUISIANA & MISSISSIPPI

Chief Engineer: Brian Mistich, PE
554 Old Spanish Trail
Slidell, LA 70458

www.dammonengineering.com
info@dammonengineering.com
PH: 985.649.5832

REVISIONS		DATE
#	DESCRIPTION	

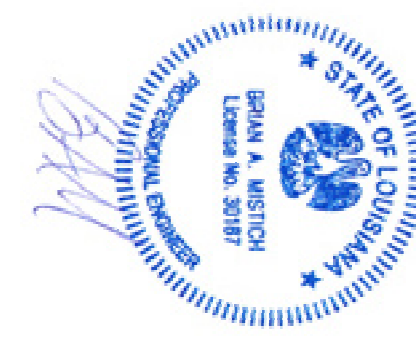

NEW PREP FACILITY
OLD TOWN KITCHEN

221 COUSIN STREET
SLIDELL, LA 70458

JOB No: 2324 DATE: 11-21-17

DRAWN BY: CKD CHECKED BY: CKD

SHEET TITLE:
SITE UTILITY PLAN

DRAWING NUMBER:
C102

SHEET NO.: 4 OF 4