

STONE VENEER WALL AND ARCH (SEAL W/HEALTH DEPARTMENT APPROVED SEALER)

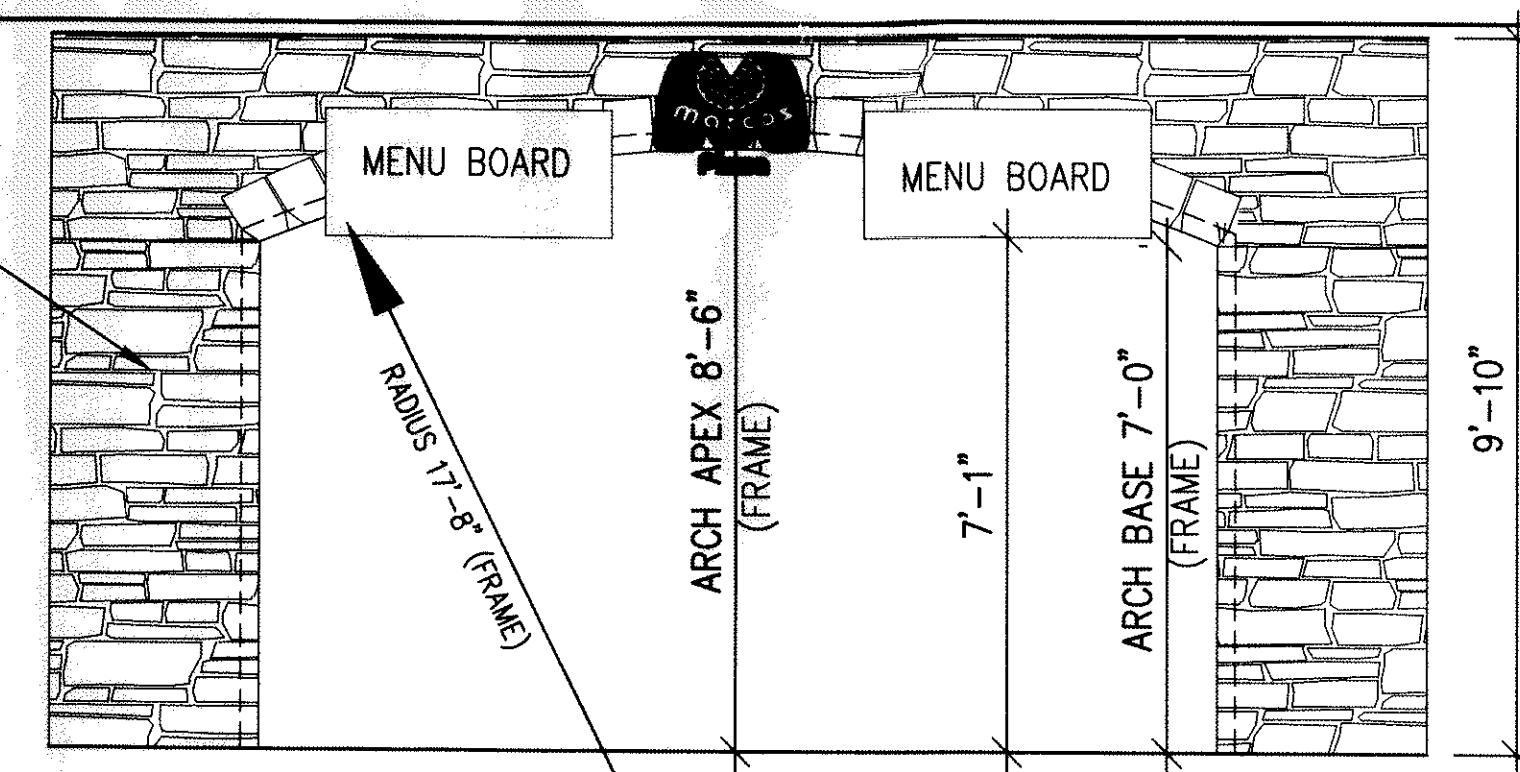

VENEER WALL
SCALE: 3/8" = 1'-0"

EQUIPMENT SCHEDULE

ITEM #	QTY.	MFG.	MODEL	SPECIFICATION DESCRIPTION	ELECTRICAL			PLUMBING												
					VOLTS	Ø	RATED AMP.	K.W.	H.P.	CONN.	C.W.	H.W.	WASTE	GAS	BTU/HR.					
1	1 EA.	RUBBERMAID	PS10FPX	SCALE, PORTION, DIGITAL																
1A	1 EA.	SILVER KING	SKP292	PIZZA PREP TABLE REFRIGERATED	120	1	8.5		1/2	PLUG										
1B	1 EA.	BK RESOURCES	CUSTOM	S/S WALL SHELF (18" X 96")																
2	1 EA.	FRANKLIN CABINET CO.	CUSTOM	SALES & PHONE COUNTER																
2A	1 EA.	LPI	SHELVING	SALES & PHONE COUNTER SHELVING																
3	1 EA.	BK RESOURCES	VTTR-3030	18 GA S/S WORK TABLE (30" X 30")																
4	1 EA.	TRUE	TG1R-1G	UPRIGHT DOUGH RE-PROOFER	120	1	9.0		1/3	PLUG										
5	1 EA.	EAGLE GROUP	T30120B-BS	18 GA S/S PIZZA STRETCH TABLE (120" X 30")																
5A	1 EA.	SSP, INC.	EWMS1448-X	18 GA S/S WALL SHELF (48" X 14")																
6	1 EA.	SOMERSET	CDR-500	DOUGH ROLLER / SHEETER	120	1	5.0		1/2	PLUG										
7	1 EA.	MIDDLEBY	PS360 WB-D	CONVEYOR OVEN - DOUBLE DECK (2 CONNECTIONS FOR GAS & ELECTRIC)	(2) 208	(2)	(2)12.0	(2) 2.5		DIRECT										2" (2) 170,000
8	1 EA.	LARKIN INDUSTRIES	CHI	CONVEYOR OVEN EXHAUST SYSTEM (VERIFY W/ HOOD DRAWINGS)	208	3	2.50	0.9	1/2	DIRECT										
8A	1 EA.	LARKIN INDUSTRIES	ARS-12	SUPPLY FAN (VERIFY W/ HOOD DRAWINGS)	208	3	2.50	0.9	1/2	DIRECT										
8B	2 EA.	LARKIN INDUSTRIES	180R6B	EXHAUST FAN (VERIFY W/ HOOD DRAWINGS)	208	3	3.70	1.3	3/4	DIRECT										
9	1 EA.	FRANKLIN CABINET CO.	CUSTOM	CUT TABLE BASE W/ CASTERS																
10	1 EA.	JOHN BOOS	CUSTOM	MAPLE BAKERS TOP (84" X 36") W/ SS STEEL CATCHER BOX & OVERSHELF																
11	1 EA.	MIDWEST	CUSTOM	CUTTING TABLE OVERSHELF																
12	2 EA.	BK RESOURCES	BKHS-W-1410-F	S-S HAND SINK							1/2"	1/2"	1-1/2" DIR.							
13	1 EA.	SSP, INC.	14-1C16X20-0-X	S-S ONE COMPARTMENT SINK W/ BASKET DRAIN																
13B	1 EA.	T&S BRASS	B-2030-LN	FAUCET							1/2"	1/2"								
14	1 EA.	MCGUNN	QD1613	SAFE																
15	1 EA.	HATCO	GRA-6003	FOOD WARMER (CORD & PLUG BY OWNER)	120	1	12.3	2.1		PLUG										
16	1 EA.	SNOWMAN WALK-IN	CUSTOM	WALK-IN COOLER (VERIFY W/ WALK-IN DRAWINGS)																
16A	1 EA.	SNOWMAN WALK-IN	CUSTOM	CONDENSER (VERIFY W/ WALK-IN DRAWINGS)	208	1				DIRECT										
17	1 EA.	BK RESOURCES	BKS-3-1620-12-181	THREE COMPARTMENT SINK																
17A	3 EA.	BK RESOURCES	CUSTOM	BASKET DRAIN / LEVER WST WASTE																
17B	1 EA.	T&S BRASS OR =	B-0133	PRE RINSE ASSEMBLY																
18	1 EA.	HOBART	P-660	60 QUART MIXER	208	3	8.6	3.1	2.5	DIRECT										
19	1 EA.	ADV. TABCO	VLG-307	14 GA S/S WORK TABLE (84" X 30")																
19A	1 EA.	NEMCO	N55200AN-6	EASY SLICER, MANUAL																
19B	1 EA.	EDLUND	1S	MANUAL CAN OPENER																
20	1 EA.	ARTIC AIR	F22CW	REACH-IN FREEZER W/ CASTERS	120	1	15	1.8	1/3	PLUG										
21	1 EA.			GREASE INTERCEPTOR REF. PLUMBING SHEETS																
21A				OPEN																
22	5 EA.	CAMBRO	DR5480-480	DUNNAGE RACKS																
22A	2 EA.	NATIONAL CART	ALDR244812HD	HEAVY DUTY ALUMINUM DUNNAGE RACK																
22B		NATIONAL CART	ALDR246012HD	HEAVY DUTY ALUMINUM DUNNAGE RACK																
23	2 EA.	SSP, INC.	LGS1830-X	WIRE SHELVING W/ CASTERS																
24	1 EA.	HODGES OR =	EPOXY	12" X 42" WALL SHELVING (MIXER SHELF)																
24A	2 EA.	HODGES OR =	EPOXY	14" X 42" WALL SHELVING (3 COMP. SINK SHELF)																
25	1 EA.	METRO OR =	CUSTOM	ROUTING TABLE W/ CASTERS																
25A	1 EA.			OVERHEAD FOOD WARMER																
26	2 EA.	SSP, INC.	CUSTOM	WALK-IN SHELVING W/ CASTERS																
27	2 EA.	LARSENS	5 LB	WALL HUNG DRY CHEMICAL FIRE EXTINGUISHER PER LOCAL CODE (BY OWNER)																
28	1 EA.	TRUE	GDM-33SSL-54	MERCHANDISER REFRIGERATOR	120	1	7.8	0.9	1/3	PLUG										
29	1 EA.	HOWARD CO		MENU BOARD (VERIFY MECHANICALS W/ OWNER)																
30	1 EA.	BY OTHERS		POS CASH REGISTER STATION (VERIFY MECHANICALS W/ OWNER)	120	1				PLUG										
30A	1 EA.	BY OTHERS		POS CASH REGISTER PRINTER (VERIFY MECHANICALS W/ OWNER)	120	1				PLUG										
31	1 EA.	BY PC		MOP SINK (INSTALLED BY G.C.) (VERIFY MECHANICALS W/ OWNER)							1/2"	1/2"	3" DIR.							
32	0 EA.	BY OTHERS		BOTTLED WATER DISPENSER-BY OTHERS																
33	2 EA.	BY PC		TANKLESS WATER HEATER																
34	1 EA.	BY OTHERS		PIZZA BAG WARMING SYSTEM																
35	1 EA.	BY OTHERS		BEVERAGE STATION																
36	8 EA.	WAYMAR		FOUR TOP TABLE AND CHAIRS																
36A	2 EA.	WAYMAR		TWO TOP TABLE AND CHAIRS																
36B	2 EA.	WAYMAR		4 PERSON BOOTH																
37	2 EA.	CASEWORK		TRASH RECEPTICAL																
38	2 EA.	BY OTHERS		WIRE SHELVING																
39	1 EA.	BY OTHERS		WAITING BENCH BY OWNER																
41	1 EA.	BY OTHERS		POS ORDER STATION #1 (VERIFY MECHANICALS W/ OWNER)	120	1				PLUG										
41A	1 EA.	BY OTHERS		POS ORDER STATION #2 (VERIFY MECHANICALS W/ OWNER)	120	1				PLUG										
41B	1 EA.	BY OTHERS		POS ORDER STATION #3 (VERIFY MECHANICALS W/ OWNER)	120	1				PLUG										
42	0 EA.	BY OTHERS		POS FULL PAGE PRINTER (VERIFY MECHANICALS W/ OWNER)	120	1				PLUG										
43	1 EA.	BY OTHERS		POS PRINTER (AT OUT TABLE) (VERIFY MECHANICALS W/ OWNER)	120	1				PLUG										
44	1 EA.	BY OTHERS		POS STRETCH MONITOR #1 (VERIFY MECHANICALS W/ OWNER)	120	1				PLUG										
45	1 EA.	BY OTHERS		POS DRIVER STATION #1 (VERIFY MECHANICALS W/ OWNER)	120	1				PLUG										
45B	1 EA.	BY OTHERS		POS PRINTER (AT DRIVER STATION) (VERIFY MECHANICALS W/ OWNER)	120	1				PLUG										
46	1 EA.	BY OTHERS		POS OFFICE STATION (VERIFY MECHANICALS W/ OWNER)	120	1				PLUG										
47	1 EA.	BY OTHERS		PHONE SYSTEM																
48	1 EA.	BY OTHERS		WALL MOUNTED LOCKABLE CABINET																
49	1 EA.	FRANKLIN CABINET CO.	CUSTOM	COUNTER TOP DESK																

NOTE: ARCHITECT/CONTRACTOR TO CALCULATE RATED LOADS & SIZE REQUIRED FOR SERVICE AND PROTECTIVE DEVICES.

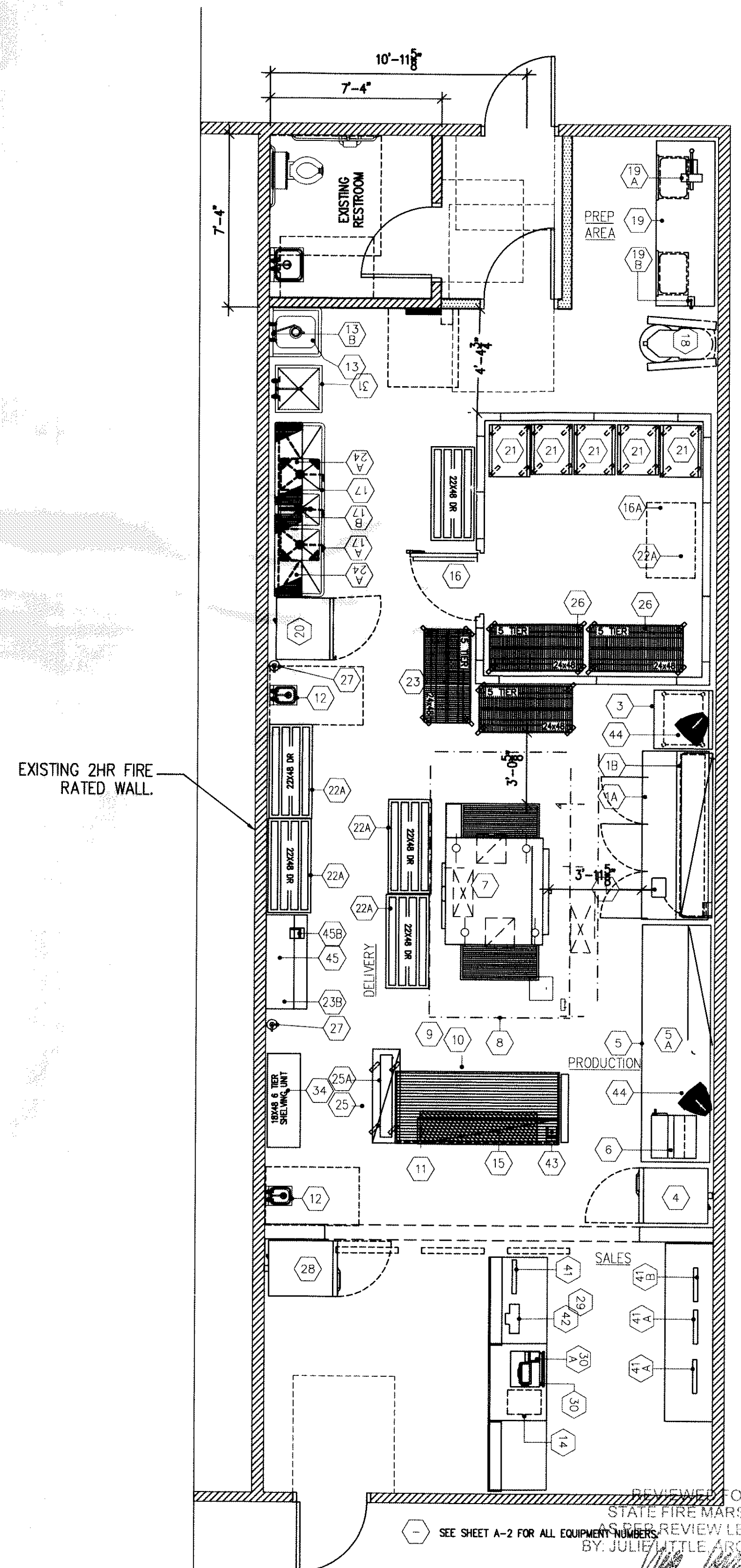

FLOOR PLAN
SCALE: 1/4" = 1'-0"

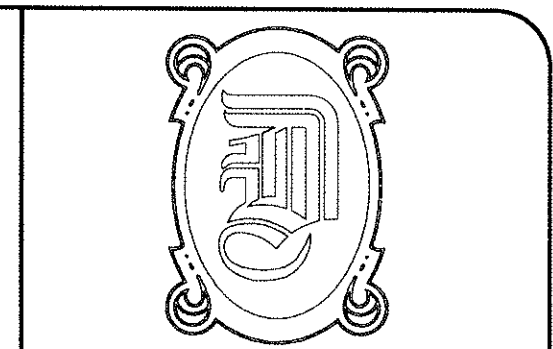

DAMMON ENGINEERING, INC.
EMMETT DAMMON

ARCHITECT
ROBERT WILTSE

1095 FLORIDA AVENUE
SLIDELL, LA. 70458
985-649-5832

WEBSITE:
WWW.DAMMONENGINEERING.COM
EMAIL:
DAMMONENG@BELLSOUTH.NET

ARCHITECTURE
ENGINEERING
STUDIES
PLANNING
INVESTIGATION
EXPERT WITNESS

MARCO'S PIZZA TENANT BUILDOUT

2349 E. GAUSE BLVD
SUITE 1
SLIDELL, LA
70461

EQUIPMENT PLAN

Robert Wiltse

SCALE: AS NOTED

JOB#: 2082

DATE: 11-1-10

SHEET 3

A-2

OF 10