

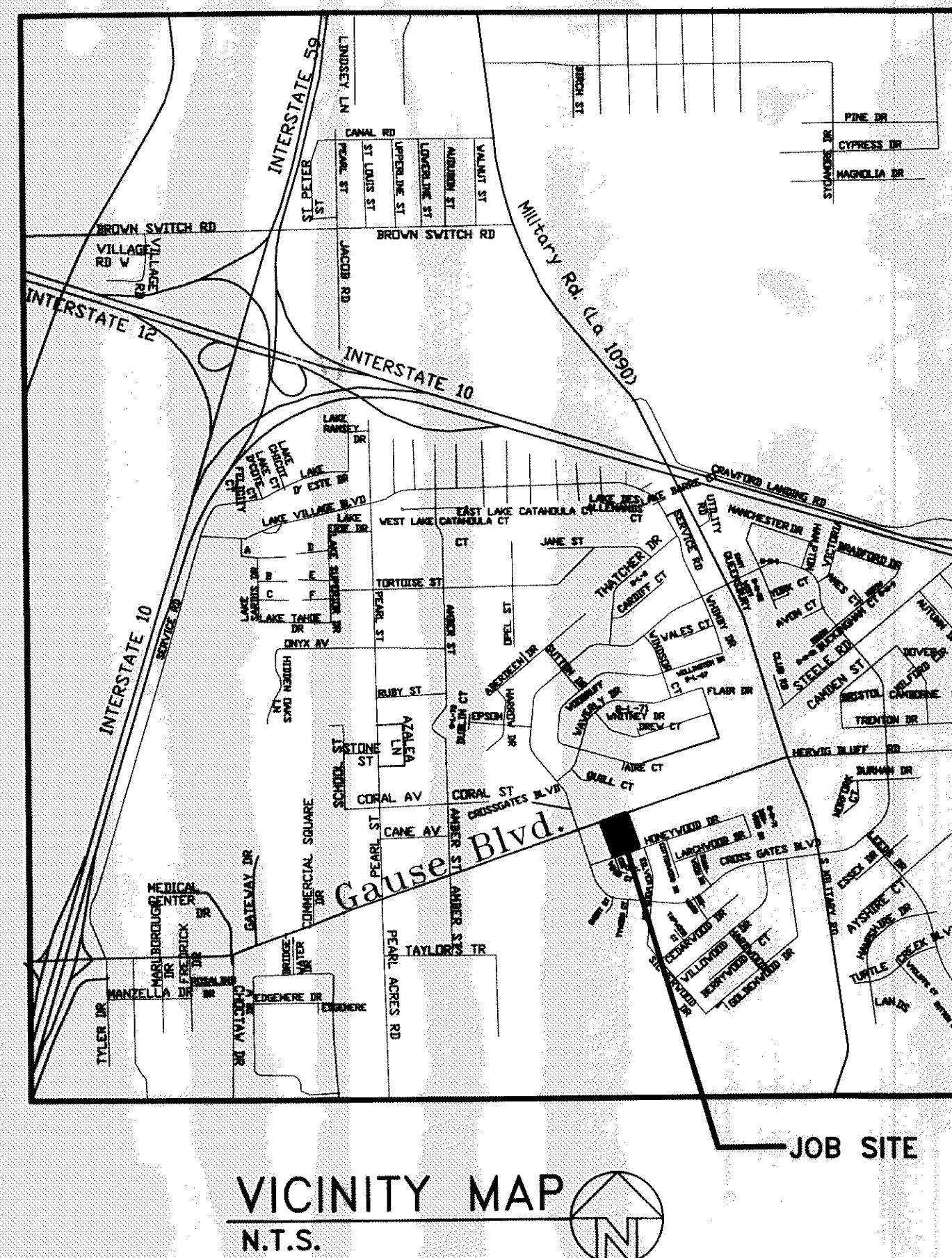

STORE LOCATION  
 2349 GAUSE BLVD.  
 SUITE 1  
 SLIDELL, LA 70461

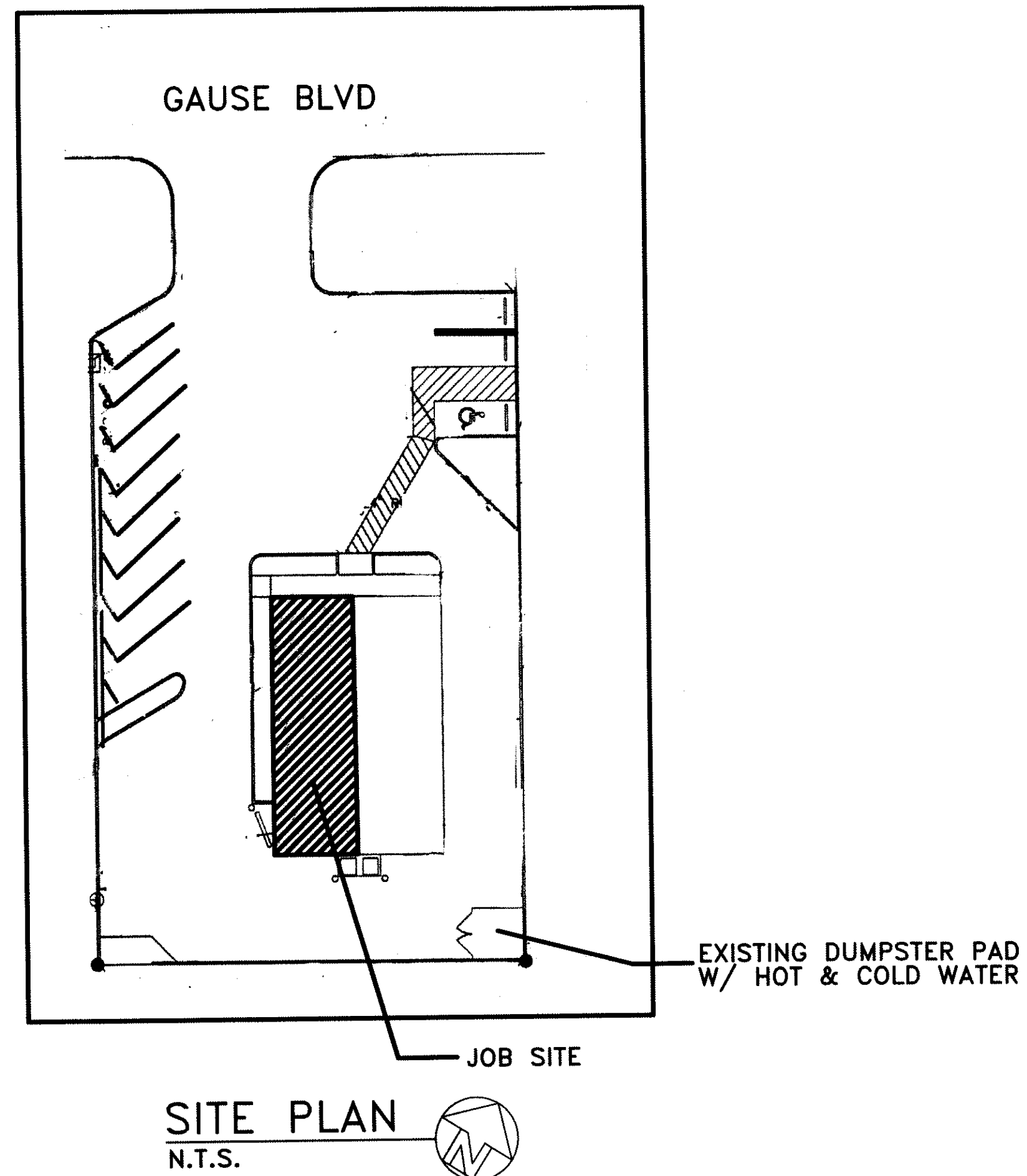

**CODE SUMMARY**

TOTAL BUILDING AREA:	2,400 SQ. FT.
LEASE BUILDING AREA:	1,200 SQ. FT.
OCCUPANCY CLASSIFICATION SECTION 304.1	GROUP M (LESS THAN 50 OCCUPANTS)-LIFE SAFETY CODE NFPA 101, 2009 GROUP B (LESS THAN 50 OCCUPANTS A-2) INTERNATIONAL BUILDING CODE, 2006
BUILDING TYPE SECTION 503	TYPE V-B (WOOD FRAME)
OCCUPANT LOAD: IBC TABLE 1004.1.1 LIFE SAFETY CODE TABLE 7.3.1.2	TOTAL SQ. FOOTAGE 1,172 SQ. FT. OCCUPANT LOAD: FRONT COUNTER      STANDING NO SEATING      95 SQ. FT. = 19 KITCHEN/SERVICE AREA      904 SQ. FT. = 9 28 OCCUPANTS
MEANS OF EGRESS:	NO. OF EXITS      2 (NFPA 101, 36.2.4.3) (IBC 2006, TBL. 1019.2) EXIT WIDTH PROVIDED      3'-0" (FRONT) (EXIT WIDTH REQUIRED 3'-0")      3'-0" (REAR)  MAXIMUM DISTANCE TO EXITS      39'-5" (2 OR MORE EGRESS - 150'-0" ALLOWED) (SINGLE EGRESS - 75'-0" ALLOWED)

**SHEET INDEX**

- TITLESHEET  
 A-1 FLOOR PLAN  
 A-2 EQUIPMENT PLAN  
 A-3 FINISHED AND CEILING PLAN  
 M-1 MECHANICAL PLAN  
 M-2 MECHANICAL DETAILS  
 E-1 POWER & LIGHTING PLAN  
 F-2 ELECTRICAL SCHEDULES  
 P-1 PLUMBING PLAN  
 P-2 PLUMBING DETAILS

**PROJECT DIRECTORY**

FRANCHISEE: SELA PIZZA 1LLC  
 (OWNERS) DBA: MARCO'S PIZZA  
 1001 CHICORY CT.  
 SLIDELL, LA 70460  
 CONTACT: BOBBY CURTIS  
 (504) 416-6689  
 whachamean@aol.com

FRANCHISER: MARCO'S FRANCHISING, LLC  
 5252 MONROE STREET  
 TOLEDO, OH 43623-3140  
 (419) 885-7000 (PHONE)  
 (419) 885-5215 (FAX)

LANDLORD: TRIAD LLC.  
 ATTN: DON NASH  
 2349 GAUSE BLVD.  
 SLIDELL, LA 70461  
 (985) 285-4048

ARCHITECT: DAMMON ENGINEERING INC.  
 ARCHITECTS AND ENGINEERS  
 ROBERT WILTSE  
 1095 Florida Avenue  
 Slidell, Louisiana 70458  
 (985) 649-5832  
 (985) 641-5950 FAX

REVIEWED FOR  
 STATE FIRE MARSHAL  
 AS PER REVIEW LETTER  
 BY: JULIE WITTLE ARCHITECT

389436

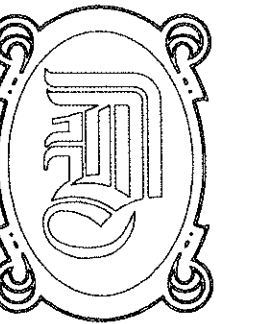

**DAMMON**  
 ENGINEERING, INC.  
 EMMETT  
 DAMMON

ARCHITECT  
 ROBERT  
 WILTSE

1095 FLORIDA AVENUE  
 SLIDELL, LA. 70458  
 985-649-5832

WEBSITE:  
 WWW.DAMMONENGINEERING.COM

EMAIL:  
 DAMMONENG@BELLSOUTH.NET

- ARCHITECTURE  
 ENGINEERING  
 STUDIES  
 PLANNING  
 INVESTIGATION  
 EXPERT WITNESS

**MARCO'S**  
**PIZZA**  
 TENANT  
 BUILDOUT

2349 E. GAUSE BLVD  
 SUITE 1  
 SLIDELL, LA  
 70461

RECEIVED  
 NOV 8 2010  
 STATE FIRE MARSHAL  
 ARCHITECTURAL SECTION

TITLE  
 SHEET

REV: Robert Wiltse

SCALE: AS NOTED

JOB #: 2082

DATE: 11-1-10

SHEET 1

**TS-1**

OF 10