

(2) 6" 20 GA. MTL. STUDS  
AND (2) 6" 20 GA. MTL.  
RUNNER TRACK TO FORM  
CONTINUOUS BOX BEAM

6" 20 GA. MTL.  
STUDS @ 16" o.c.

5/8" GYP BOARD

NEW GRID AND TILE  
REF. FINISH PLAN

CEILING ELEV.  
10'-0" A.F.F.

5/8" CDX PLYWOOD

KITCHEN  
AREA

NEW GRID AND TILE  
REF. FINISH PLAN

CEILING ELEV.  
11'-0" A.F.F.

5/8" CDX PLYWOOD

THIN SET SYNTHETIC  
STONE ON METAL LATHE  
AND CEMENTOUS MUDSET

MENU BOARD BY OTHERS,  
PROVIDE BLOCKING IN  
WALL AS REQUIRED

BULKHEAD  
ELEV. VARIES

SALES/  
PICK-UP

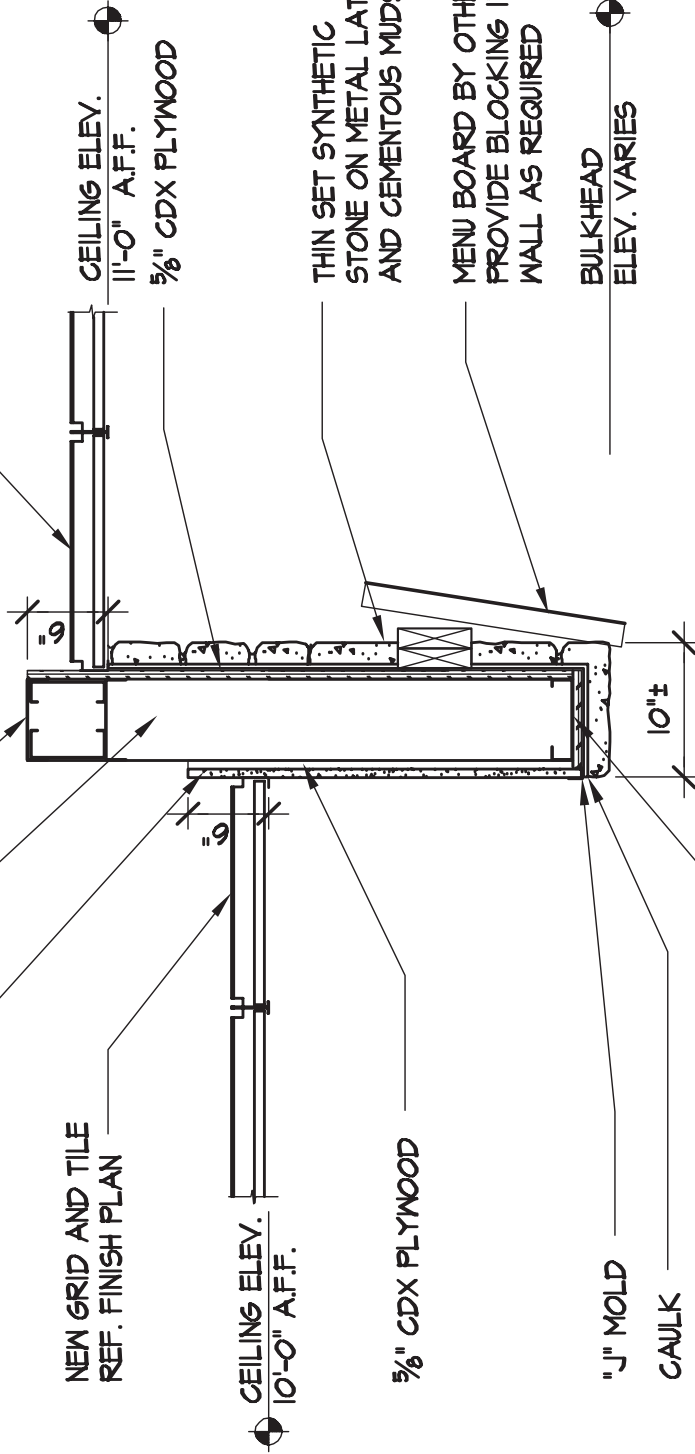

6" RUNNER TRACK- CLIP  
LEGS @ 4" o.c. TO FORM  
RADIUS - SEE ELEVATIONS

"J" MOLD

CAULK

# SECTION @ STONE ARCH

2  
A-2

SCALE: 3/4" = 1'-0"