

DAMMON
ENGINEERING, INC.
CHIEF ENGINEER
ENNETT
DAMMON, P.E.
CHIEF ARCHITECT
ROBERT
WILTSE

554 OLD SPANISH TRAIL
SUITE 11, LA 70456
OFFICE: 985-649-5632
FAX: 985-641-5950

WEBSITE:
WWW.DAMMONENGINEERING.COM
EMAIL:
DAMMONENG@Bellsouth.net

ARCHITECTURE
ENGINEERING
STUDIES
PLANNING
INVESTIGATION
EXPERT WITNESS

MARCOS
PIZZA
TENANT
BUILDOUT

9212 WEST
JUDGE PEREZ DR.
CHALMETTE, LA

EQUIPMENT
PLAN

REV:
SCALE: AS NOTED
JOB#: 2126
DATE: 12-08-11
SHEET 3

OF 11
A-2

EQUIPMENT SCHEDULE

ITEM #	QTY.	MFG.	MODEL	DESCRIPTION	ELECTRICAL			PLUMBING								
					VOLTS	# AMP.	K.W.	H.P.	CONN.	C.W.	H.W.	WASTE	GAS	BTU/HR.		
1	1 EA.	AVERY BEND	6112	SOFT THERM. SIGAL												
1A	1 EA.	RAMBOLD	RE1119	PIZZA PREP TABLE REFRIGERATED	120	1	12.8									
1B	1 EA.	BR RESOURCES	CUSTOM	5/2 WALL SHELF (18" X 8")												
2	1 EA.	RAMBOLD	CUSTOM	SALES & PHONE COUNTER												
2A	1 EA.	SHREVEPORT	CUSTOM	SALES & PHONE COUNTER SHELVING												
3	1 EA.	BR RESOURCES	CUSTOM	18 GA 5/2 WORK TABLE (30" X 30")												
4	1 EA.	TRIPLE	TRIPLE-110	UPRIGHT DOUGH RE-PROOFER	120	1	8.0									
5	1 EA.	ESQZ GROUP	1002028-BIS	18 GA 5/2 WALL SHELF (24" X 30")												
5A	1 EA.	SPER, INC.	EMW5148-X	18 GA 5/2 WALL SHELF (14" X 14")												
6	1 EA.	SCOFFERET	COM-4200	DOUGH ROLLER / SHEETER	120	1	5.0									
7	1 EA.	WOLFELEY	PRE-SERV 9879-D	CONNECTOR OVEN - DOUBLE DECK (2 CONNECTORS FOR GAS & ELECTRIC)	208	208	2.5									
8	1 EA.	LEARN INDUSTRIES	AMS-12	CONNECTOR OVEN DELIVERY SYSTEM (VERIFY W/ HOOD DRAWINGS)	208	3	2.50	0.8	1/2							
8A	1 EA.	LEARN INDUSTRIES	THORBER	SUPPLY FAN (VERIFY W/ HOOD DRAWINGS)	208	3	3.70	1.3	3/4							
8B	1 EA.	LEARN INDUSTRIES	THORBER	EXHAUST FAN (VERIFY W/ HOOD DRAWINGS)	208	3	3.70	1.3	3/4							
9	1 EA.	RAMBOLD	CUSTOM	CUT TABLE BASE W/ CASTERS												
10	1 EA.	JOHN BOES	CUSTOM	LAURE BAKERS TOP (24" X 30") W/ SS STEEL CATCHER BOX & OVERSHELF												
11	1 EA.	WINDJET	CUSTOM	CUTTING TABLE OVERSHELF												
12	3 EA.	COMMERCE	HSS-1402	S-S HAND SINK												
13	1 EA.	SPER, INC.	14-COR-24-1	S-S ONE COMPARTMENT SINK W/ BASKET DRAIN												
13B	1 EA.	ESQZ GROUP	14-COR-24-1	S-S ONE COMPARTMENT SINK W/ BASKET DRAIN												
14	1 EA.	ESQZ GROUP	14-COR-24-1	S-S ONE COMPARTMENT SINK W/ BASKET DRAIN												
14A	1 EA.	WOLFELEY	COM-4200	DOUGH ROLLER / SHEETER												
15	1 EA.	WOLFELEY	COM-4200	DOUGH ROLLER / SHEETER												
16	1 EA.	SWANSON WALK-IN	CUSTOM	WALK-IN COOLER (COOL & FLOOD BY OWNERS)	120	1	12.3									
17	1 EA.	COMMERCE	COM-4200	THREE COMPARTMENT SINK (VERIFY W/ WALK-IN DRAWINGS)	208	1										
17A	3 EA.	BR RESOURCES	CUSTOM	BASKET DRAIN / LEVER W/ WASTE (VERIFY W/ WALK-IN DRAWINGS)	208	1										
17B	1 EA.	KE RESOURCES	BI-013	PRE RINSE ASSEMBLY												
18	1 EA.	HOHART	PI-480	80 QUART W/ WASTE	208	3	8.8	3.1	2.5							
19	1 EA.	ADV. FABCO	VIS-307	14 GA 5/2 WORK TABLE (24" X 30")												
19A	1 EA.	NECICO	MS3000M-4-8	EASY SLIDER, MANUAL												
19B	1 EA.	EDLING	15	MANUAL OIL CRACKER												
20	1 EA.	ARTIC AIR	FE220R	REACH-IN FREEZER W/ CASTERS	120	1	15	1.8	1/2							
21	1 EA.			GRABER TRAY												
21A	1 EA.			807 PLUMBING SHEETS												
22	8 EA.	COMBERG	305-581-180	DRAINAGE DOORS												
22A	7 EA.	WATSON, DAVE	ADP24-48-200	HEAVY DUTY ALUMINUM DRAINAGE DOOR												
22B	1 EA.	WATSON, DAVE	ADP24-48-200	HEAVY DUTY ALUMINUM DRAINAGE DOOR												
23	4 EA.	SPER, INC.	LSR180-4	WIRE SHELVING W/ CASTERS												
24	2 EA.	HOODS PAK	EPLOY	12" X 42" WALL SHELVING (MUR SHELF)												
24A	2 EA.	HOODS PAK	EPLOY	14" X 42" WALL SHELVING (3 COMP. SINK SHELF)												
25	2 EA.	METRO DR	CUSTOM	ROLLING TABLE W/ CASTERS												
25A	2 EA.			OVERHEAD FOOD WARMER												
26	4 EA.	SPER, INC.	CUSTOM	WALK-IN SHELVING W/ CASTERS												
27	2 EA.	LABRENS	3 1/2	WALL MOUNTED OPEN/SHUT FIRE EXTINGUISHER PER LOCAL CODE (BY OWNER)	120	1	7.8	0.8	1/2							
28	1 EA.	HEWARD CO		HEAVY DUTY												
29	2 EA.	BY OTHERS		POS CASH REGISTER STATION (VERIFY MECHANICALS W/ OWNERS)	120	1										
30A	2 EA.	BY OTHERS		POS CASH REGISTER PRINTER (VERIFY MECHANICALS W/ OWNERS)	120	1										
31	1 EA.	BY OTHERS		MFD SINK (INSTALLED BY O.C.) (VERIFY MECHANICALS W/ OWNERS)												
32	0 EA.	BY OTHERS		BOTTLED WATER DISPENSER-BY OTHERS												
33	0 EA.	BY OTHERS		TANKLESS WATER HEATER												
34	1 EA.	BY OTHERS		PIZZA BAG WARMING SYSTEM												
35	1 EA.	BY OTHERS		BEVERAGE STATION												
36	1 EA.	BY OTHERS		FOUR TOP TABLE AND CHAIRS												
36A	13 EA.	BY OTHERS		FOUR TOP TABLE AND CHAIRS												
36B	0 EA.	BY OTHERS		4 PERSON BOOTH												
37	1 EA.	CASWORK		TWASH RECEPTAL												
38	0 EA.	BY OTHERS		WIRE SHELVING												
39	0 EA.	BY OTHERS		WAITING BENCH												
41	5 EA.	BY OTHERS		POS ORDER STATION (VERIFY MECHANICALS W/ OWNERS)	120	1										
42	1 EA.	BY OTHERS		POS FULL PAGE PRINTER (VERIFY MECHANICALS W/ OWNERS)	120	1										
43	1 EA.	BY OTHERS		POS PRINTER (AT CUT TABLE) (VERIFY MECHANICALS W/ OWNERS)	120	1										
44	3 EA.	BY OTHERS		POS STRETCH MONITOR #1 (VERIFY MECHANICALS W/ OWNERS)	120	1										
45	1 EA.	BY OTHERS		POS STRETCH MONITOR #2 (VERIFY MECHANICALS W/ OWNERS)	120	1										
46	0 EA.	BY OTHERS		POS PRINTER (AT ORDER STATION) (VERIFY MECHANICALS W/ OWNERS)	120	1										
47	1 EA.	BY OTHERS		PHONE STATION (VERIFY MECHANICALS W/ OWNERS)	120	1										
48	0 EA.	BY OTHERS		WALL MOUNTED LOCKABLE CABINET												
49	0 EA.	BY OTHERS		COUNTER TOP DESK												

*NOTE: ARCHITECT/CONTRACTOR TO OBTAIN RATED LOADS & SEE REQUIRED PERMITS AND PROTECTIVE DEVICES **

GENERAL NOTES:

- CONTRACTOR SHALL EMPLOY A LICENSED SPRINKLER COMPANY TO INSTALL THE FIRE EXTINGUISHING SYSTEM FOR THE HOOD SYSTEM.
- CONTRACTOR TO VERIFY ALL SITE CONDITIONS AND ALL DIMENSIONS PRIOR TO CONSTRUCTION. ALL WORK SHALL CONFORM TO ALL LOCAL AND STATE CODES AND REGULATIONS.
- GENERAL CONTRACTOR SHALL INSTALL ALL REQUIRED BLOCKING FOR ALL EQUIPMENT, HANGERS, ETC.
- INSULATION AND INSULATION ASSEMBLIES SHALL MEET THE REQUIREMENTS OF SECTION 719, INTERNATIONAL BUILDING CODE, 2006.
 - CONCEALED INSULATION SHALL HAVE A FLAME SPREAD OF NOT MORE THAN 25 AND A SMOKE DEVELOPED INDEX 0-450.
 - INSULATION SHALL CONFORM WITH IBC 719.2.1.
- INTERIOR WALL AND CEILING FINISHES SHALL HAVE A CLASS A RATING WITH A FLAME SPREAD OF 0-25 AND A SMOKE DEVELOPED INDEX OF NOT MORE THAN 5. DIMENSIONS ARE TO CENTER LINE OR FACE OF STUDS, CENTER LINES OF COLUMNS.
- MATERIALS SHALL BE NEW AND U.L. LISTED.
- NO WORK SHALL BE CONCEALED UNTIL APPROVED BY LOCAL INSPECTORS.
- CONSTRUCTION SHALL CONFORM WITH ALL CITY, STATE AND LOCAL CODES.
- CONTRACTOR TO GUARANTEE WORK FOR ONE YEAR.
- CONTRACTOR SHALL FURNISH WATER AND POWER FROM EXISTING SOURCES.
- PAINT GRADE TO BE SHERMAN-WILLIAMS OR EQUIVALENT. ALL WORK TO RECEIVE 2 COATS.
- PROVIDE CLEANUP ON A REGULAR BASIS. NO TRASH STORED IN BUILDING.
- USE 6" STUDS AT ALL PLUMBING WALLS.
- PROVIDE GALV. METAL PAN WITH DRAIN AT WATER HEATER LOCATION.
- LOCKS ON DOORS IN VEHICLES OF EGRESS SHALL NOT REQUIRE THE USE OF A KEY (INTERIOR SIDE), SPECIAL DEVICE OR SPECIAL KNOWLEDGE TO OPEN IN THE DIRECTION OF EGRESS.
- ALL DOORS SHALL CONFORM WITH THE LATEST EDITION OF ALL LOCAL, STATE AND NATIONAL CODES THAT COVER THE SECTION OF WORK BEING PERFORMED.
- PROVIDE PORTABLE FIRE EXTINGUISHERS IN ACCORDANCE WITH NFPA 110. SEE APPENDIX "E" OF NFPA 101 FOR DISTRIBUTION OF EXTINGUISHERS.
- GENERAL CONTRACTOR TO INSTALL PLYWOOD BACKING BEHIND ALL SHELVING AND SINKS AS NEEDED TO SUPPORT SUCH ITEMS. (VERIFY LOCATIONS WOMEN)
- ALL FIRE PARTITIONS SHALL EXTEND TIGHT TO ROOF SHEATHING & SEALING WITH APPROVED FIRE CAULK. CONTRACTOR TO VERIFY.
- ALL ELECTRICAL, MECHANICAL & PLUMBING PENETRATING FIRE PARTITIONS SHALL BE FIRE CALKED. (PENETRATIONS THROUGH RATED CONSTRUCTION SHALL BE SEALED WITH A MATERIAL CAPABLE OF PREVENTING THE PASSAGE OF FLAMES AND HOT GASES WHEN TESTED IN ACCORDANCE WITH ASTM E 154.)

EQUIPMENT PLAN
SCALE: 3/8" = 1'-0"

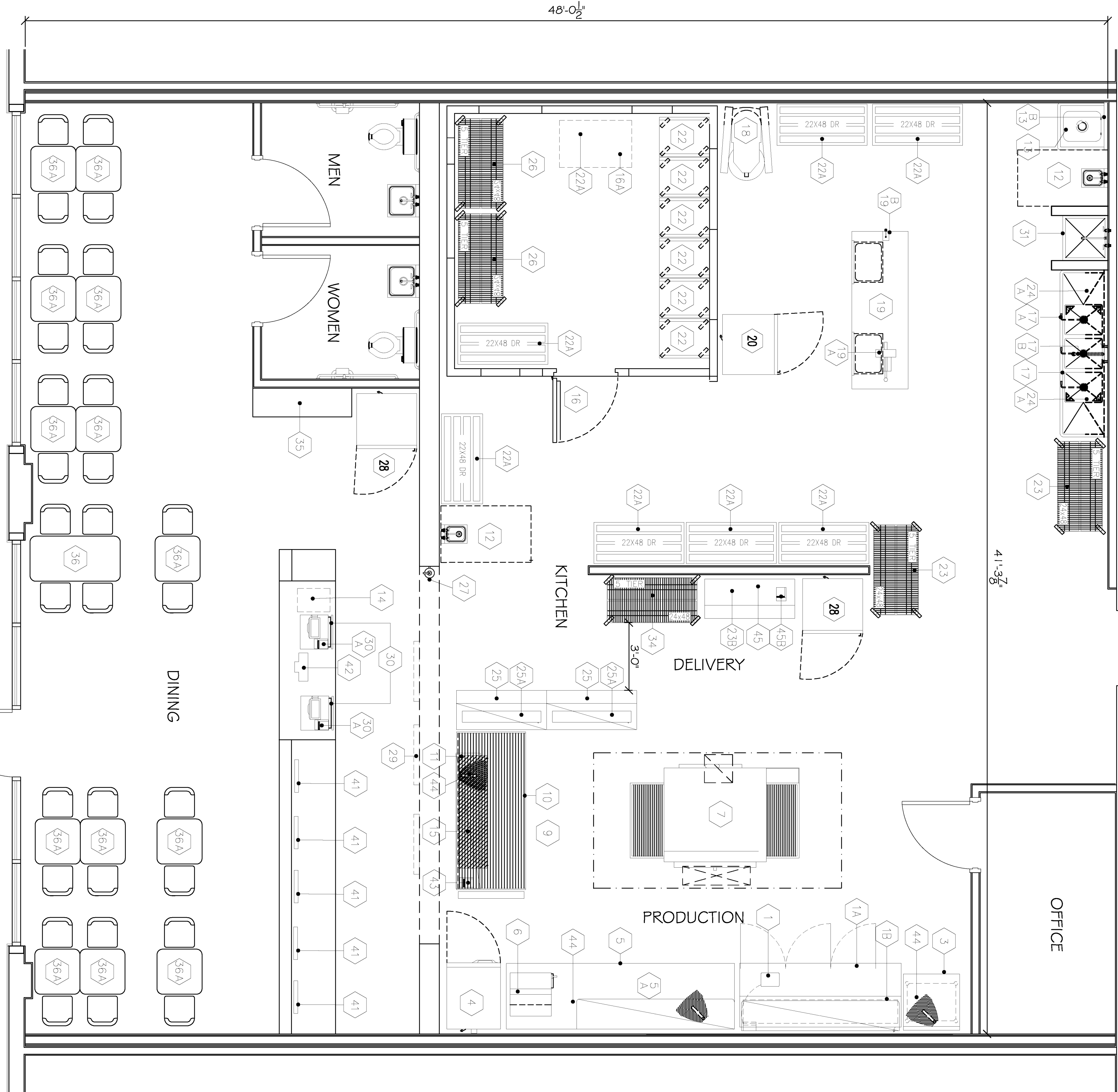

48'-0 1/2"