

## Dammon Engineering

1095 Florida Ave.  
Slidell, LA 70458  
(985) 649-5832  
Fax: (985) 641-5950

FAX NUMBER TRANSMITTED TO: (225) 454-6661

TO: Darian

FROM: David Dammon

Reference: Quiznos Build-out at 17002 Jefferson Hwy. Baton Rouge

DATE: September 29, 2006

No of pages including cover sheet: 45

If you experience any problems receiving this fax, Please call (985) 649-5832 or  
Fax (985) 641-5950



**St. George**  
**FIRE PROTECTION DISTRICT**  
 East Baton Rouge Parish, Louisiana



13686 Perkins Rd, Baton Rouge, LA 70810 (225) 454-6550 Fax: (225) 454-6661 Email: stgeorge@stgeorgefire.com

**HYDRANT APPROVAL APPLICATION**

The following information must be provided to the St. George Fire Department before a hydrant approval review will be conducted:

Applicant Name David Dammon Date 9-29-06  
 Applicant Mailing Address 1095 Florida Ave Slidell La 70458  
 Applicant Phone (985) 649-5807 Fax 985 641-5950  
 Property Location (numerical if available) 17002 Jefferson Hwy Baton Rouge LA 70817-6911  
 Legal Description \_\_\_\_\_  
 New Building, Addition to Existing Building or Interior Modifications Interior Buildout  
 Occupant Name QUIZNOS 11466  
 Building Construction Type 9500 Automatic Fire Sprinklers (Yes or No) NO  
 Total Building Square Footage 9,600 Number of Floors 1  
 Proposed Building Use Resturant 1200sf  
 If building is to be used for storage or as a warehouse, describe the contents and estimated quantities to be stored \_\_\_\_\_

The following items are to be submitted as part of application:

Check if Submitted:

Plot/Site Plan X Subdivision Plats \_\_\_\_\_ Vicinity Map X  
 Building Layout X Complex Layout \_\_\_\_\_

Note: Building Layout must include interior & exterior walls, utility shutoffs and fire protection system connections on 8½" x 14" or 11" x 17" paper.  
 Complex Layout must include proposed building location, driveway and proposed hydrant location(s) on 8½" x 14" or 11" x 17" paper.

Above ground construction cannot commence until a suitable fire fighting water supply is provided and maintained per 1997 Standard Fire Prevention Code F602.6.1

Applicant Signature David Dammon Date 9-29-06

**OFFICE USE ONLY**

Occupancy Hazard Class \_\_\_\_\_ Fire Flow Requirement \_\_\_\_\_ GPM  
 Construction Class \_\_\_\_\_ Occupancy Type \_\_\_\_\_  
 Date Approved \_\_\_\_\_ Called in to \_\_\_\_\_ Letter Sent \_\_\_\_\_

17002 Jefferson Hwy  
Baton Rouge, LA

JEFFERSON HWY.

HIGHLAND ROAD

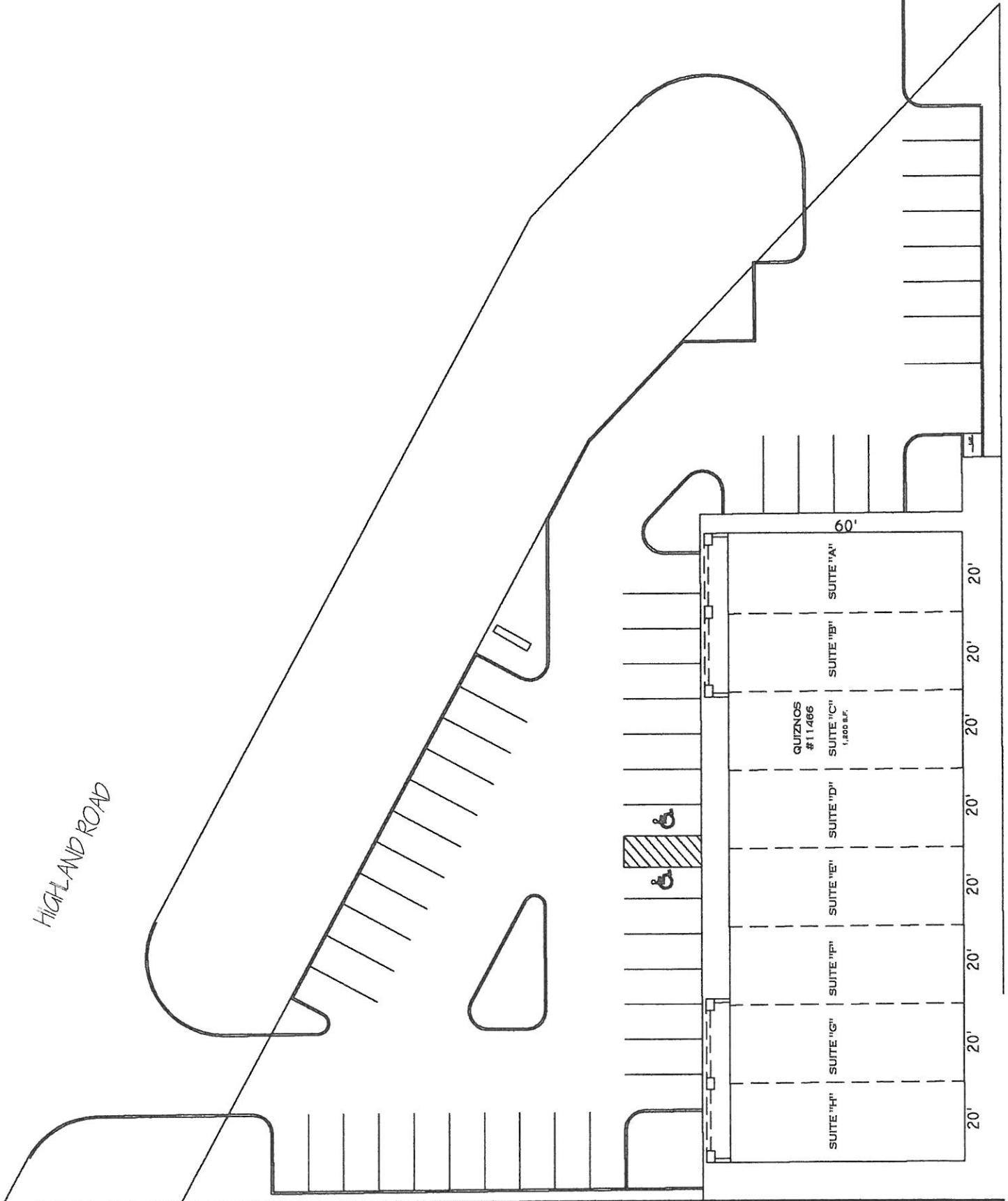

- REMOTE  
COMP.  
FREEZER
- REMOTE  
COMP.  
COOLER
- EXIST.  
4 TON  
SPLIT UNIT  
A/C #1
- NEW  
5 TON  
SPLIT UNIT  
A/C #2

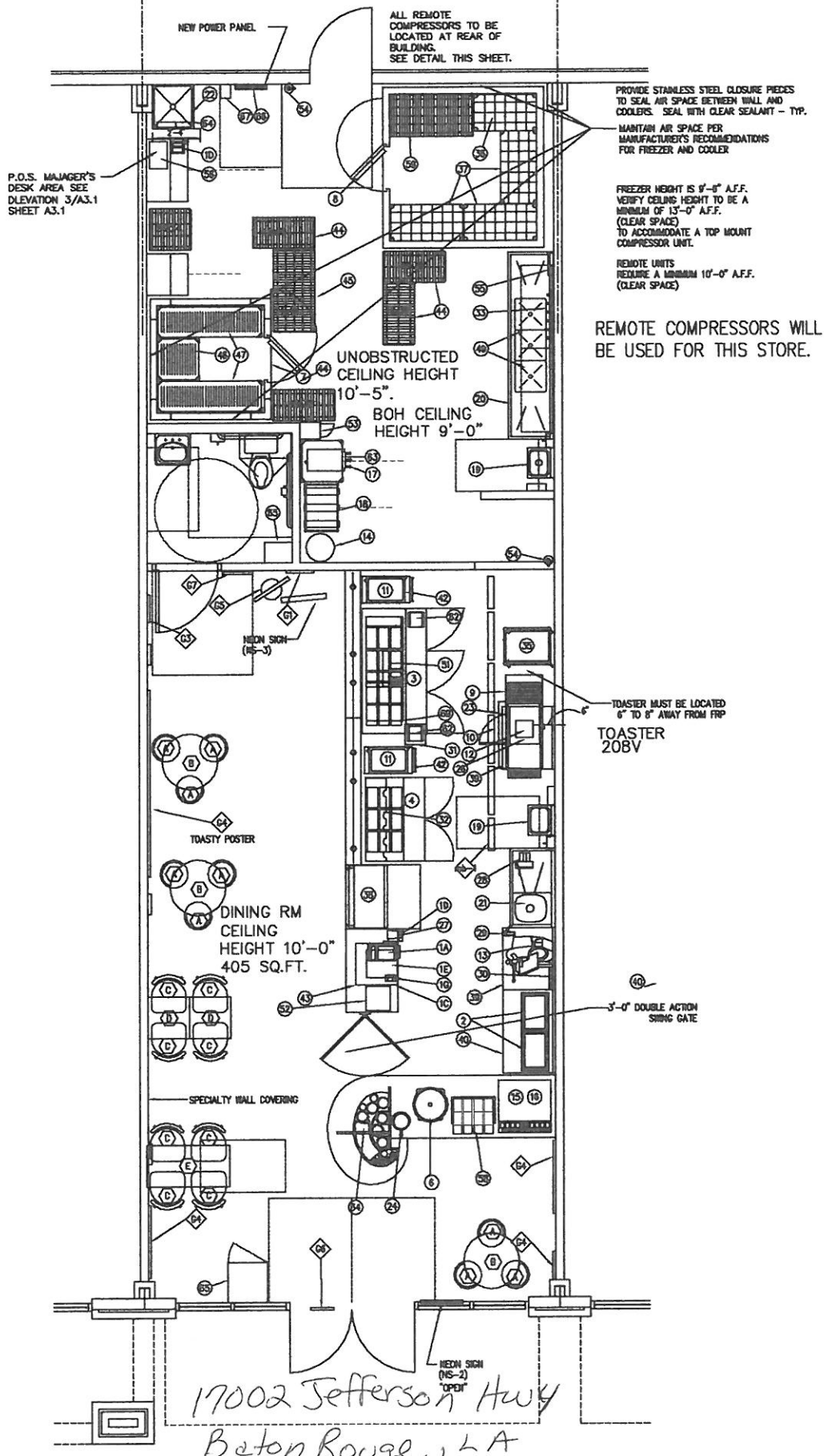

REMOTE COMPRESSORS WILL BE USED FOR THIS STORE.

TOASTER MUST BE LOCATED 6" TO 8" AWAY FROM FRP  
TOASTER  
208V

17002 Jefferson Hwy  
Baton Rouge, LA

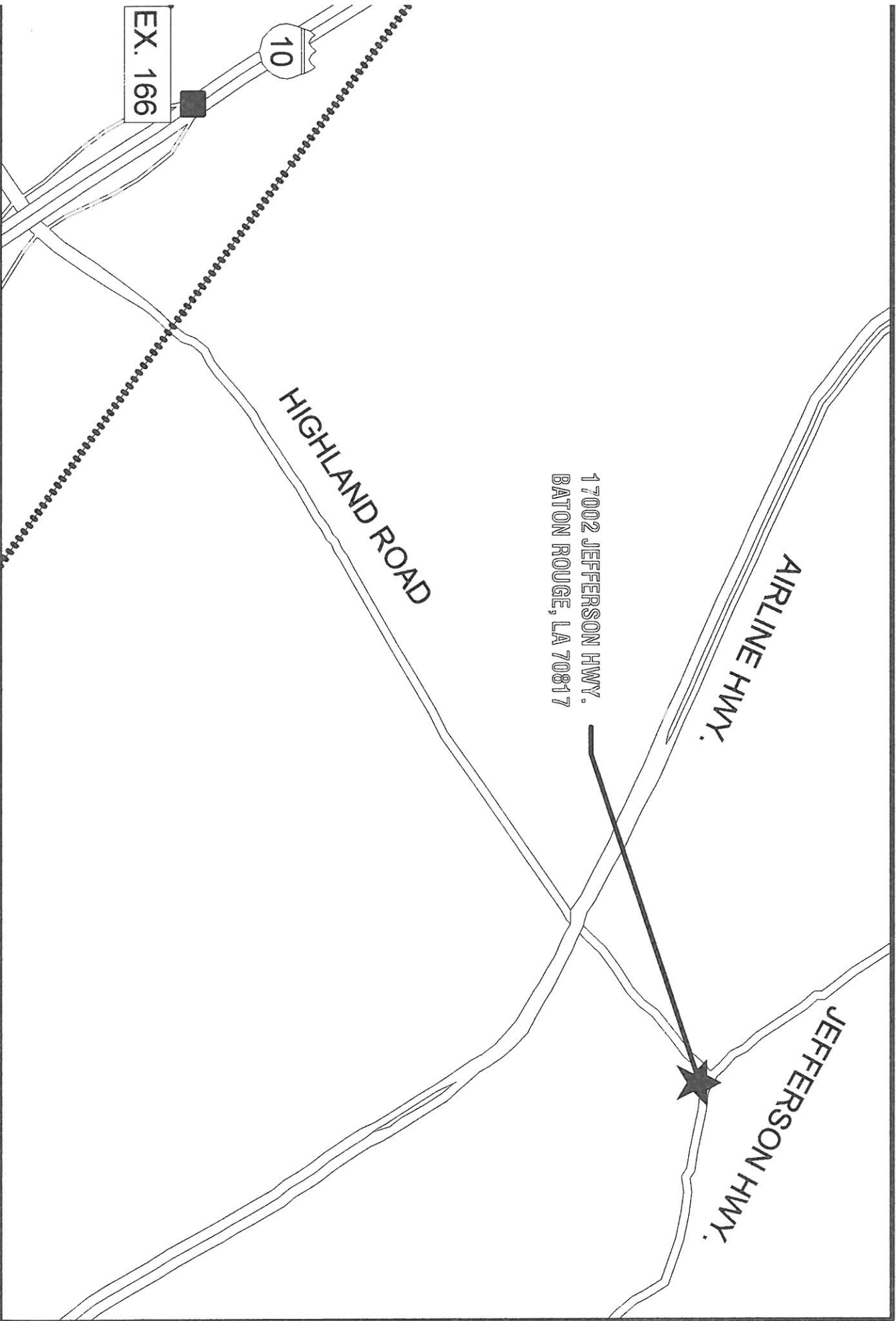

EX. 166

10

HIGHLAND ROAD

AIRLINE HWY.

17002 JEFFERSON HWY.  
BATON ROUGE, LA 70817

JEFFERSON HWY.