

EQUIPMENT SCHEDULE

MARK	QTY	DESCRIPTION	MANUFACTURER	MODEL NO	WATER	GAS	ELECTRICAL	FURN	INSTALL	REMARKS
					C	H	V	A	HP	BY
1A	1	ORDER TERMINAL								OWNER
1B	1	CASH TRAY DRAWER								OWNER
1C	2	TELEPHONE								OWNER
1D	1	EXTRA MACHINE								OWNER
1E	1	RECIPE PRINTER								OWNER

SEE SHEET A1.2 FOR ADDITIONAL POS NOTES

2	2	SOLID STATION	ARTWARK	CM-24			120	1	120/16	KEC*	GC	FLAT LID
3	1	SANDWICH TABLE (27)	DELFIELD	DEL440N-30M-02N1			115	1	6.5	12	GC	FLAT LID
4	1	SANDWICH TABLE (48)	DELFIELD	DEL440N-24M-02N1			115	1	8.5	14	GC	FLAT LID
5	1	MENSINKENSER	STRUCTURAL CONCEPTS	URS5848			115	1	5	12	GC	SEMI-CONTAINED
6	1	SINK W/ DRINK DISPENSER	DELFIELD	52-52-52-52-52-52			115	1	12	12	GC	PROVIDE CLEARANCE ACCORDING TO LOCAL CODES
7	1	WALK IN COOLER	KOOLPAK	52-52-52-52-52-52			208	1	37.5	1	GC	VERIFY OVERHEAD CLEARANCE
8	1	WALK IN FREEZER	KOOLPAK	52-52-52-52-52-52			208	1	37.5	1	GC	VERIFY OVERHEAD CLEARANCE
9	1	CONSIGNMENT TOLSTER	KOOLPAK	52-52-52-52-52-52			208	1	37.5	1	GC	ON LOWER SHELF OF 20, PROVIDE 6" COAD
10	1	MERCHANDISE SIGN	AMANA	RS-100			120	1	10	18	GC	LOCATE ON 20 AND 22
11	2	COOPERWASHER	AMV/INOT	W3-21			115	1	10	18	GC	SUPPLIED W/ SEPARATE 6"X6" SS DUCT
12	1	EXHAUST HOOD	JOHNSON DIVERSIFIED	QVANT			120	1	8.2	12	GC	VERIFY TO PROVIDE ATTACHMENT APPARATUS TO WALL
13	1	SINK	HOBBART	2912			115	1	12.8	12	GC	VERIFY TO PROVIDE ATTACHMENT APPARATUS TO WALL
14	1	ICE MAKER	MANITOWOC	QV444A			115	1	3.8	14	GC	FLANDED BY 1/2" TO FLOOR SINK
15	1	DRINK DISPENSER	CORNELIUS	EDURO 250			120	1	3.8	14	GC	FLANDED BY 1/2" TO FLOOR SINK
16	1	TEA BREWER	CURTIS	GBR 10300			115	1	7	12	GC	SPRINKLED WITH 1/2"
17	1	TEA BREWER	PROFIT MASTERS 4	USA-10-F			115	1	7	12	GC	SPRINKLED WITH 1/2"
18	2	HAND SINKS/WRMMS	ENGL	USA-10-F			115	1	7	12	GC	SPRINKLED WITH 1/2"
19	2	3-COMPARTMENT SINK W/ 2" DB	ENGL	314-64-24			115	1	7	12	GC	SEE NOTE 1. SILICONE SEALANT AT WALL
20	1	VEGETABLE SINK	ENGL	314-64-24			115	1	7	12	GC	SEE NOTE 1. SILICONE SEALANT AT WALL
21	1	VEGETABLE SINK	ENGL	314-64-24			115	1	7	12	GC	SEE NOTE 1. SILICONE SEALANT AT WALL
22	1	RECYCLER FOR TOASTERS	LOMBARD	MB-280-24			115	1	7	12	GC	SEE NOTE 1. SILICONE SEALANT AT WALL
23	1	RECYCLER FOR TOASTERS	LOMBARD	MB-280-24			115	1	7	12	GC	SEE NOTE 1. SILICONE SEALANT AT WALL
24	1	TELEPHONE	PERKINS INDUSTRIES INC.	TC0421			115	1	7	12	GC	SEE NOTE 1. SILICONE SEALANT AT WALL
25	2	STAINLESS STEEL CORNER GUARD	ROBRICK	EQ31-48" TALL			115	1	7	12	GC	SEE NOTE 1. SILICONE SEALANT AT WALL
26	1	STAINLESS STEEL CORNER GUARD	ROBRICK	EQ31-48" TALL			115	1	7	12	GC	SEE NOTE 1. SILICONE SEALANT AT WALL
27	1	CUP DISPENSER	SAV JAMAR	CE2000M			115	1	7	12	GC	SEE NOTE 1. SILICONE SEALANT AT WALL
28	1	VEGETABLE SLICER	ENGL	USA-10-F			115	1	7	12	GC	SEE NOTE 1. SILICONE SEALANT AT WALL
29	1	CAN OPENER	ENGL	USA-10-F			115	1	7	12	GC	SEE NOTE 1. SILICONE SEALANT AT WALL
30	1	KYRIE BAKER	ENGL	USA-10-F			115	1	7	12	GC	SEE NOTE 1. SILICONE SEALANT AT WALL
31	2	SCALE STAND	QUINOS	USA-10-F			115	1	7	12	GC	SEE NOTE 1. SILICONE SEALANT AT WALL
32	1	STAINLESS STEEL SHELF	ENGL	USA-10-F			115	1	7	12	GC	SEE NOTE 1. SILICONE SEALANT AT WALL
33	0	STORAGE SHELF - 18" X 24"	CALIENTAL MASTERS	E26X18			115	1	7	12	GC	SEE NOTE 1. SILICONE SEALANT AT WALL
34	SET	BREAD RACK	PREMIER EUROCASTE	18382			115	1	7	12	GC	SEE NOTE 1. SILICONE SEALANT AT WALL
35	1	DINNAGE RACK FREEZER	METRO	GBR4430			115	1	7	12	GC	SEE NOTE 1. SILICONE SEALANT AT WALL
36	1	DINNAGE RACK FREEZER	METRO	GBR4430			115	1	7	12	GC	SEE NOTE 1. SILICONE SEALANT AT WALL
37	0	STORAGE SHELF - 24" X 30"	ENGL	USA-10-F			115	1	7	12	GC	SEE NOTE 1. SILICONE SEALANT AT WALL
38	0	STORAGE SHELF - 24" X 30"	ENGL	USA-10-F			115	1	7	12	GC	SEE NOTE 1. SILICONE SEALANT AT WALL
39	0	STORAGE SHELF - 24" X 30"	ENGL	USA-10-F			115	1	7	12	GC	SEE NOTE 1. SILICONE SEALANT AT WALL
40	4	SS WORK TABLE - 60" X 30"	ENGL	USA-10-F			115	1	7	12	GC	SEE NOTE 1. SILICONE SEALANT AT WALL
41	0	SS WORK TABLE - 60" X 30"	ENGL	USA-10-F			115	1	7	12	GC	SEE NOTE 1. SILICONE SEALANT AT WALL
42	2	SS CART W/ CASTERS	WINDUOL	1527298			115	1	7	12	GC	SEE NOTE 1. SILICONE SEALANT AT WALL
43	2	STORAGE SHELF - 24" X 30"	ENGL	USA-10-F			115	1	7	12	GC	SEE NOTE 1. SILICONE SEALANT AT WALL
44	1	STORAGE SHELF - 24" X 30"	ENGL	USA-10-F			115	1	7	12	GC	SEE NOTE 1. SILICONE SEALANT AT WALL
45	0	STORAGE SHELF - 24" X 30"	ENGL	USA-10-F			115	1	7	12	GC	SEE NOTE 1. SILICONE SEALANT AT WALL
46	1	SHELF COOLER - 18" X 24"	METRO	2436C			115	1	7	12	GC	SEE NOTE 1. SILICONE SEALANT AT WALL
47	2	SHELF COOLER - 18" X 24"	METRO	2436C			115	1	7	12	GC	SEE NOTE 1. SILICONE SEALANT AT WALL
48	4	STORAGE SHELF - 24" X 30"	ENGL	USA-10-F			115	1	7	12	GC	SEE NOTE 1. SILICONE SEALANT AT WALL
49	4	SHELF WALL HANGS 18" X 48"	ENGL	USA-10-F			115	1	7	12	GC	SEE NOTE 1. SILICONE SEALANT AT WALL
50	1	HOP-UP ORDER	SPENNA	1844C			115	1	7	12	GC	SEE NOTE 1. SILICONE SEALANT AT WALL
51	1	REFRIGERATED BOTTLE COOLER	ELECTROLUX	4710			115	1	8	80H	GC	BOLT TO FLOOR WITH EXPANSION BOLTS (SUPPLIED)
52	1	REFRIGERATED BOTTLE COOLER	ELECTROLUX	4710			115	1	8	80H	GC	BOLT TO FLOOR WITH EXPANSION BOLTS (SUPPLIED)
53	1	REFRIGERATED BOTTLE COOLER	ELECTROLUX	4710			115	1	8	80H	GC	BOLT TO FLOOR WITH EXPANSION BOLTS (SUPPLIED)
54	2	REFRIGERATED BOTTLE COOLER	ELECTROLUX	4710			115	1	8	80H	GC	BOLT TO FLOOR WITH EXPANSION BOLTS (SUPPLIED)
55	1	REFRIGERATED BOTTLE COOLER	ELECTROLUX	4710			115	1	8	80H	GC	BOLT TO FLOOR WITH EXPANSION BOLTS (SUPPLIED)
56	1	REFRIGERATED BOTTLE COOLER	ELECTROLUX	4710			115	1	8	80H	GC	BOLT TO FLOOR WITH EXPANSION BOLTS (SUPPLIED)
57	1	REFRIGERATED BOTTLE COOLER	ELECTROLUX	4710			115	1	8	80H	GC	BOLT TO FLOOR WITH EXPANSION BOLTS (SUPPLIED)
58	1	REFRIGERATED BOTTLE COOLER	ELECTROLUX	4710			115	1	8	80H	GC	BOLT TO FLOOR WITH EXPANSION BOLTS (SUPPLIED)
59	1	REFRIGERATED BOTTLE COOLER	ELECTROLUX	4710			115	1	8	80H	GC	BOLT TO FLOOR WITH EXPANSION BOLTS (SUPPLIED)
60	4	WALL BRACKET/END UNIT 18"X48"	ENGL	USA-10-F			115	1	7	12	GC	SEE NOTE 1. SILICONE SEALANT AT WALL
61	2	WALL BRACKET/END UNIT 18"X48"	ENGL	USA-10-F			115	1	7	12	GC	SEE NOTE 1. SILICONE SEALANT AT WALL
62	2	DIGITAL PORTION SCALE	ENGL	USA-10-F			115	1	7	12	GC	SEE NOTE 1. SILICONE SEALANT AT WALL
63	1	STORAGE SHELF - 24" X 30"	ENGL	USA-10-F			115	1	7	12	GC	SEE NOTE 1. SILICONE SEALANT AT WALL
64	1	STORAGE SHELF - 24" X 30"	ENGL	USA-10-F			115	1	7	12	GC	SEE NOTE 1. SILICONE SEALANT AT WALL
65	2	WASTE RECEPTACLE	AMERICAN SPECIALTIES	0924			115	1	7	12	GC	SEE NOTE 1. SILICONE SEALANT AT WALL
66	0	PANEL BOARD	GE INDUSTRIAL SYSTEMS	TYPE AO (40)			115	1	7	12	GC	SEE NOTE 1. SILICONE SEALANT AT WALL
67	0	TIME CLOCK (EXTERIOR SIGNAGE)	GE INDUSTRIAL SYSTEMS	1 TORQ 110			115	1	7	12	GC	SEE NOTE 1. SILICONE SEALANT AT WALL
68	0	SAFETY SWITCH	GE INDUSTRIAL SYSTEMS	1 TORQ 110			115	1	7	12	GC	SEE NOTE 1. SILICONE SEALANT AT WALL
69	1	DONOR BOTTLE RACK	RESTAURANT INTERIORS	QUINOS DUAL ORGNER BOTTLE RACK			115	1	7	12	GC	SEE NOTE 1. SILICONE SEALANT AT WALL
70	0	SANDWICH TABLE (48)	DELFIELD	DEL440N-24M-02N1			115	1	7	12	GC	SEE NOTE 1. SILICONE SEALANT AT WALL

GRAPHICS SCHEDULE

MARK	QTY	DESCRIPTION	FURN BY	INSTALLED BY	REMARKS
G1	1	ARTWORK - TOASTY PLAQUE	OWNER	GC	BOTTOM OF SIGN 4.0" AFF. CENTER HORIZ.
G2	1	ARTWORK - FRESH ACRONYM	OWNER	GC	2" ABOVE TOP OF TRASH. CENTER HORIZ.
G3	1	ARTWORK - QUIZONS ACRONYM	OWNER	GC	BOTTOM OF SIGN 4.0" AFF. CENTER HORIZ.
G4	4	ARTWORK - BRAGGER STAND	OWNER	GC	CENTER HORIZONTALLY AND ROTATE 90°.
G5	1	OPEN HOURS DECAL	OWNER	GC	TO BE IN CUSTOMER ENTRANCE VIEW. 5'-0" TALL.
G6	1	WOMEN'S RESTROOM SIGN	OWNER	GC	TOP OF DECAL 5'-4" AFF.
G7	1	MEN'S RESTROOM SIGN	OWNER	GC	1" ON DOOR AND 1" ON WALL. ADJ. TO DOOR - ADA COMPLIANT.
G8	1	MEN'S RESTROOM SIGN	OWNER	GC	1" ON DOOR AND 1" ON WALL. ADJ. TO DOOR - ADA COMPLIANT.

SIGN SCHEDULE

MARK	DESCRIPTION	MANUFACTURER	FURN BY	INSTALL BY	VOLT	AMP	REMARKS
MS-1	NEON SIGN - "O OPEN"	ZEON	GC	GC	120	3	TOP OF MENU BOARD 8'-3" AFF.
MS-2	NEON SIGN - "DELIVERY (FUTURE)"	ZEON	GC	GC	120	1.2	NOTE 1: TOP OF SIGN 8'-2" AFF.
MS-3	NEON SIGN - "ORDER MMM..."	ZEON	GC	GC	120	1.2	NOTE 1: TOP OF SIGN 8'-2" AFF.
MS-4	NEON SIGN - "EXTENSION"	ZEON	GC	GC	120	1.2	NOTE 1: BOTTOM OF SIGN 8'-4" AFF.

SIGN SCHEDULE NOTES:
1. HANG FROM STOREFRONT HEAD WITH SUPPLIED CHAINS AND HOOKS.

FURNITURE SCHEDULE

ITEM	QTY	DESCRIPTION	MANUFACTURER	REMARKS
A	1	STOOLS	TOWER ASSOCIATES	NON-FRAME SEATING
B	8	PREMIER SEATING	PREMIER EUROCASTE	NON-FRAME SEATING
C	42	CHAIRS	PREMIER EUROCASTE	NON-FRAME SEATING
D	18	SQUARE TABLE	PREMIER EUROCASTE	NON-FRAME SEATING
E	1	RECTANGLE TABLE	PREMIER EUROCASTE	NON-FRAME SEATING
F	1	SQUARE TABLE	PREMIER EUROCASTE	NON-FRAME SEATING
G	1	SQUARE TABLE	PREMIER EUROCASTE	NON-FRAME SEATING
H	1	EXTERIOR SEATING	AMERICAN TRADING	NON-FRAME SEATING

REQUIRED SCHEMATIC INFORMATION

ITEM	DESCRIPTION	NOTES
ELECTRICAL PANEL	NEW BY L. XX. EXISTING	
SIZE OF WALKERS	COOLER 5'-9"X5'-9"X4'-H. FREEZER 5'-9"X6'-9"X4'-H.	
COMPRESSOR TYPE	TOP MOUNT REMOTE XX.	
MILLWORK DIMENSIONS	SHOWN XX.	
LEFT HAND VEGE SINK	SHOWN XX.	
3-COMPARTMENT SINK	CUSTOM MODEL # 314-64-24.	
CEILING HEIGHT	FRONT OF HOUSE 10'-0" - BACK OF HOUSE 10'-0"	
SQUARE FOOTAGE	TOTAL BUILD OUT 1600 SF.	

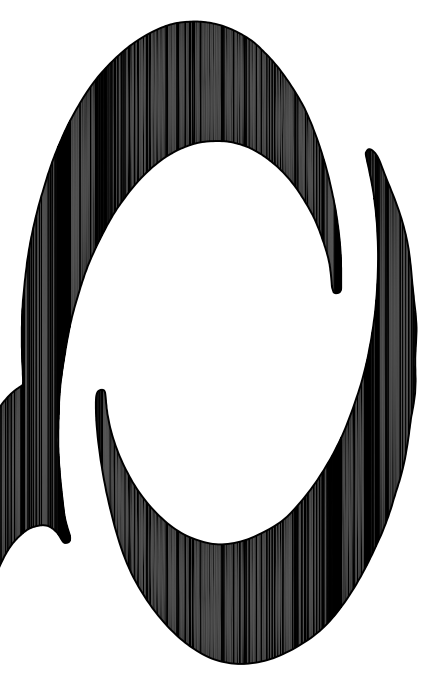
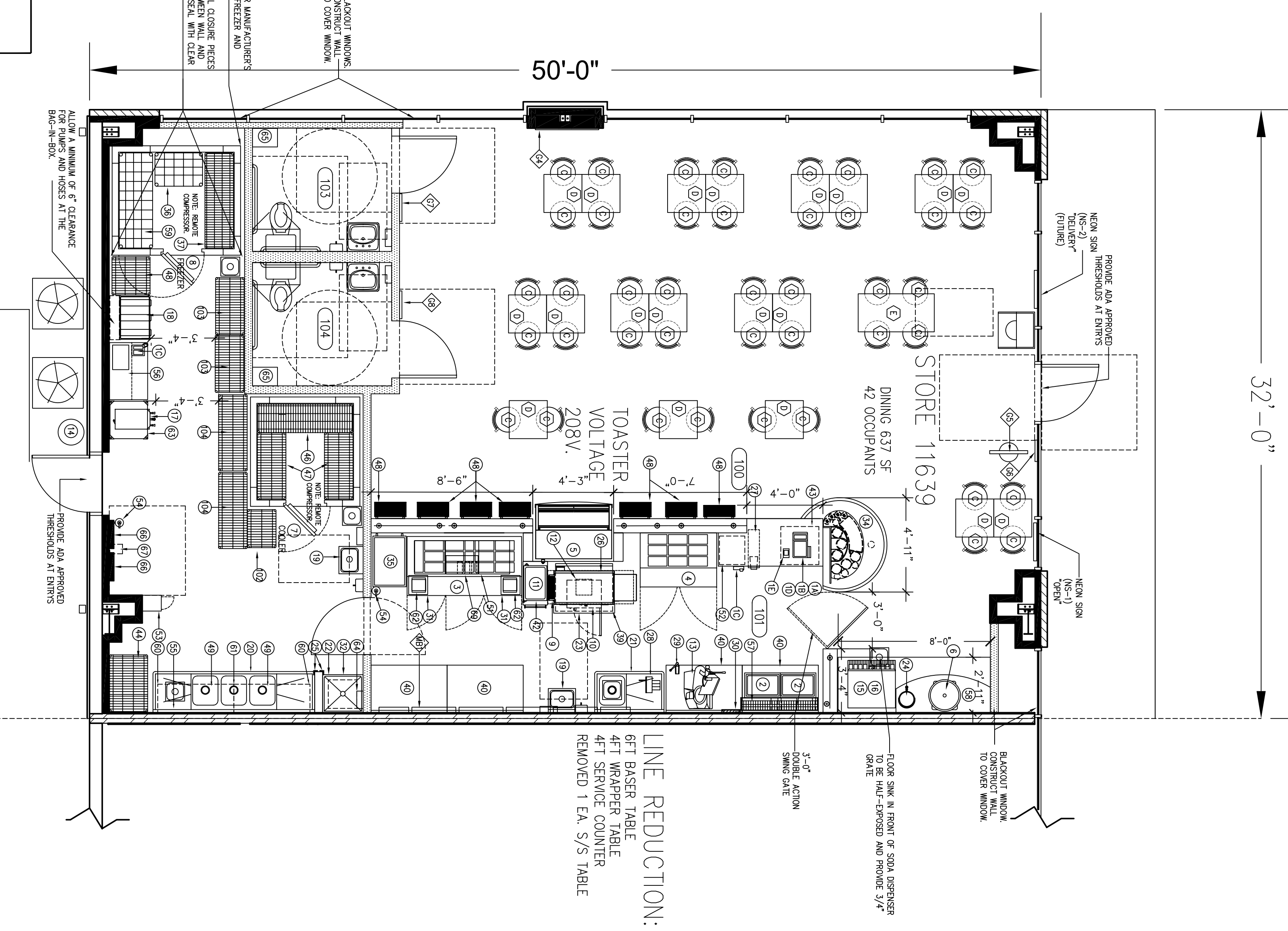

Q2008-PROTOTYPE

Quiznos

STORE # 11639

1880 Rees St.,
Suite A-101

Breaux Bridge, LA 70517

phase:
NOT FOR CONSTRUCTION

project no:
date:
file:
sheet title:

EQUIPMENT PLAN
SCHEDULES

A1.1