



SCHEMATIC REVIEW - APPROVED

March 20, 2007

David Dammon
Dammon Engineering
1095 Florida Ave.
Slidell, LA 70458

RE: QUIZNOS SUB
BP-Hwy. 305 and Church Road - Store # 11816
BP-Hwy. 305 and Church Road
Olive Branch, MS 38654
(Accepted 3-20-07)

Dear David:

I have reviewed the Schematic for the above location, based on The Quiznos Master LLC design criteria, equipment standards, material and general information, and have the following comments and/or concerns:

The schematic plan for the above project is:

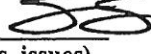
APPROVED X (as noted with changes) 
(Based on compliance with the below comments, concerns, issues)

REQUIRED CHANGES THAT MUST BE REFLECTED ON CD'S: (IF REQUIRED ITEMS ARE NOT REVISED ON CD'S, THE CD'S WILL BE NOT APPROVED) IF CODE OR SITE LIMITATIONS PROHIBIT CHANGES, DOCUMENTATION IS REQUIRED.

- ★ a. Quiznos does not have a complete separation of space therefore the dining room floor finishes, wall finishes and seating must all be provided by the C-Store. (see attached)
- ★ b. Verify if the custom 3-comp sink is to be provided by Quiznos or by the C-Store. (see attached)
- ★ c. Verify if the shelving units shown are to be provided by Quiznos or by the C-Store. Please note that a minimum of (4) 18x36 shelving units are required and must be shown. Verify location of additional dry storage shelving. (see attached)
- ★ d. Show the soup poster (G4) behind the soup station per the prototype. (see attached)

RECOMMENDATIONS FOR REVISIONS THAT SHOULD BE REFLECTED ON CD's:

- a. None.

ADDITIONAL COMMENTS TO BE ADDRESSED:

- a. This store will use the materials, methods and general information that is found and detailed in the Q2006 Architectural and Construction Manual Version One.
- b. Note: **ANY CHANGES TO THE SCHEMATIC DRAWING AFTER APPROVAL HAS BEEN GIVEN MUST BE RESUBMITTED FOR REVIEW**

AND APPROVAL.

- c. All schematics must be drawn per Q2006 Dual Order Design.
- d. Effective immediately, an HVAC form must be completed and submitted with the construction documents, whether the system is new or existing. Construction documents will not be reviewed until it is received.
- e. Quiznos must receive a QVent worksheet, before the construction documents can be reviewed.
- f. All millwork must meet Quiznos' standard specifications.
- *g. **SHARDED COOLER & FREEZER noted per the schematic. Verify.**
- h. A 9'-6" high freezer is standard. Please complete the Kolpak worksheet and return it to our office. Construction documents will not be reviewed until the Kolpak worksheet has been received by the design and construction department.
- i. A 208V toaster has been noted and will be ordered unless otherwise specified. Verify.
- j. Effective immediately- Place the toaster 6" to 8" away from the FRP to prevent the FRP from melting due to high temperatures from the toaster. ***Verify the clearance of the service area due to the toaster moving out 6" to 8".
- k. Effective immediately – two (2) 20-amp circuits are required for the soup station.
- *l. NOTE: The electric panel has been noted (BY LANDLORD) on the schematic. If not noted on CD's then a new electric panel will be ordered regardless. The GE worksheet must be submitted with the CD's.
- m. RDC is responsible for confirming the sign survey work has been started. The final invoice will not be generated until the sign quote has been approved by Quiznos' Design & Construction Department.

This review is performed solely for Quiznos benefit to ensure that the schematic layout meets the requirements of The Quiznos Master LLC and complies with the design and specifications. It shall become incumbent upon you, the Project Architect to insure that the Franchisee have a final architectural plan set that complies with all applicable codes and regulations, as well as mechanical and electrical requirements suited to the restaurant needs.

During the Construction Drawing and Construction Administration phase of the project, keep us informed of any substantial changes and/or problems to the schematic. Copies of any clarifications or addenda's issued, should be sent to The Quiznos Master LLC Design and Construction Department as soon as they are issued.

Should any questions or concerns arise during this project, please contact me at ssorensen@quiznos.com, if I can be of any assistance.

Respectfully,
THE QUIZNOS MASTER LLC



Stan Sorensen
Design & Construction Department

cc: David Lake
cc: Robert Smith

Enclosed: layout for Store # 11816

Store # 11816
 Approved as noted
 with changes

3/20/07

St

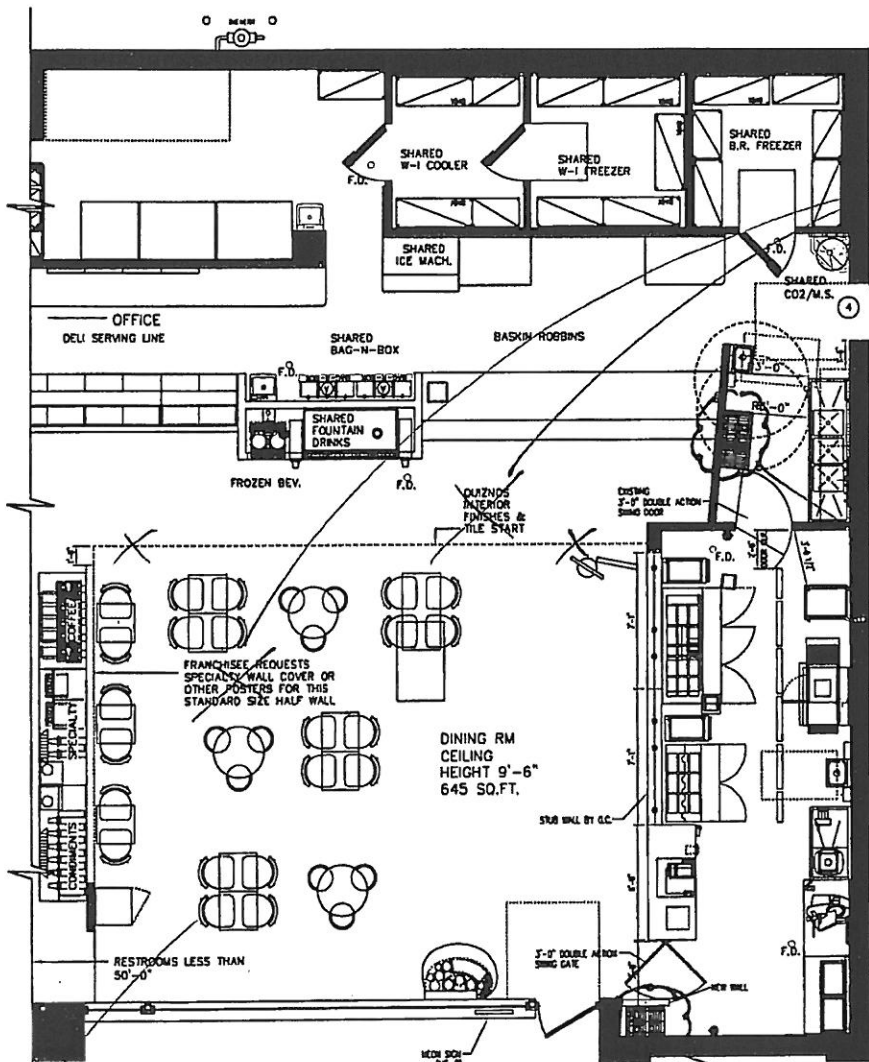
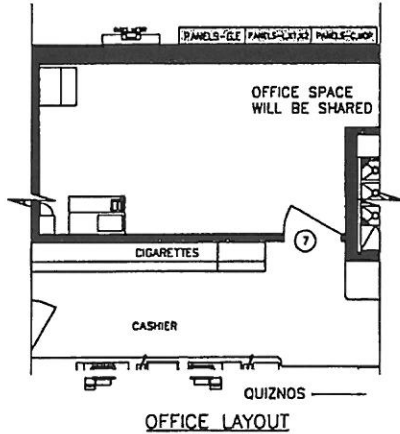

* Quiznos does not have separation of space therefore common finishes are required.
 * Verify if Quiznos or CtG will be providing custom 3-comp sink.

- NOTE:
- THIS STORE WILL BE SHARING THE FOLLOWING:
 - * COOLER - LANDLORD PROVIDED
 - * FREEZERS - LANDLORD PROVIDED
 - * OFFICE - SHARED
 - * RESTROOMS - LANDLORD PROVIDED
 - * A/C - LANDLORD PROVIDED
 - * LIGHTING - LANDLORD PROVIDED
 - * BEVERAGE COUNTER - LANDLORD PROVIDED
 - * BAG-N-BOX - LANDLORD PROVIDED
 - * ELECTRICAL PANEL - LANDLORD PROVIDED
 - * MOP SINK - LANDLORD PROVIDED
 - * CO2 - LANDLORD PROVIDED

NON-STANDARD 3-COMP SINK (26" X 90" MODEL 314-16-3-18)

* By Quiznos? Verify.

TOASTER MUST BE LOCATED 6" TO 8" AWAY FROM FRP

* Slow Soup poster.

* Quiznos does not have a separation of space therefore common seating will be required. Seating will not be provided by Quiznos. 1,045 S.F. #11816 SCHEMATIC

* Shelving By Quiznos? Verify.
 * Verify if additional dry storage will be provided for Quiznos.
 * Please note a minimum of (4) 18x36 shelving units are required and must be shown. Location?