

1. EXTENDED POLYSTYRENE BOARD INSULATION INDICATED SET OF BEAM ONLY IF INSULATION PROTECTION SHALL BE GYPSUM WALLBOARD, 7/16" PLYWOOD, 1 1/2" BOARD.
2. FOLLOW ROOF RASH SCHEDULE FOR WALL FINISHES.
3. EXTERIOR PLYWOOD SHEATHING SHALL BE 5/8"
4. INSULATED ROOF ASSEMBLY AT GROUND FINISH AREA. CEILING FINISHES SHALL BE A COMPOSITE GYPSUM BOARD SYSTEM (GYP/ROCKWOOL/CON OR TECTUM III).
5. FINISHED ROOF SHEATHING AT ROOF THUS AREAS SHALL BE 1/2" CDX PER SPECIFICATIONS WITH PLYWOOD CLIPS INSTALLED BETWEEN SUPPORTS.

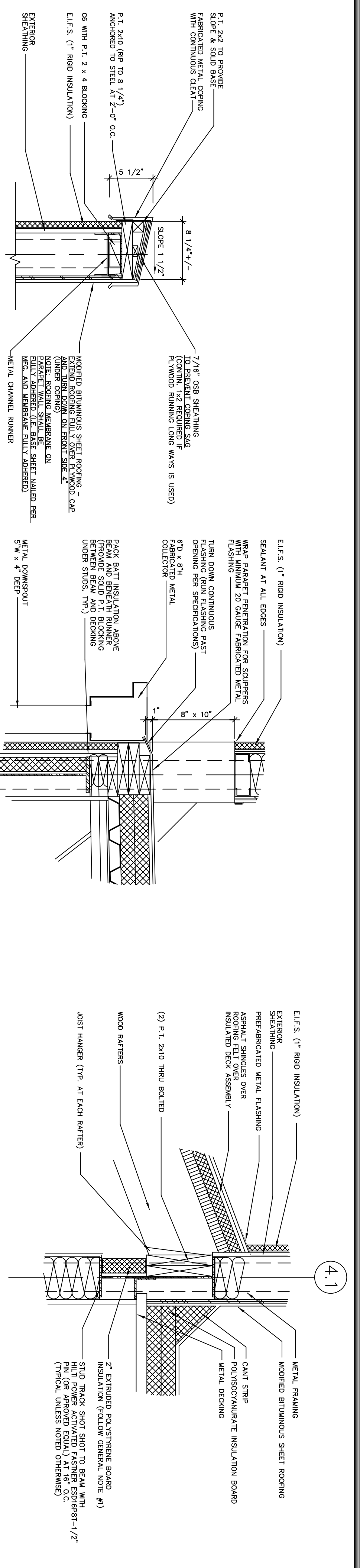

8 COPING DETAIL
SCALE: 1 1/2" = 1'-0"

9 SCUPPER DETAIL
SCALE: 1 1/2" = 1'-0"

10 DETAIL
SCALE: 1 1/2" = 1'-0"

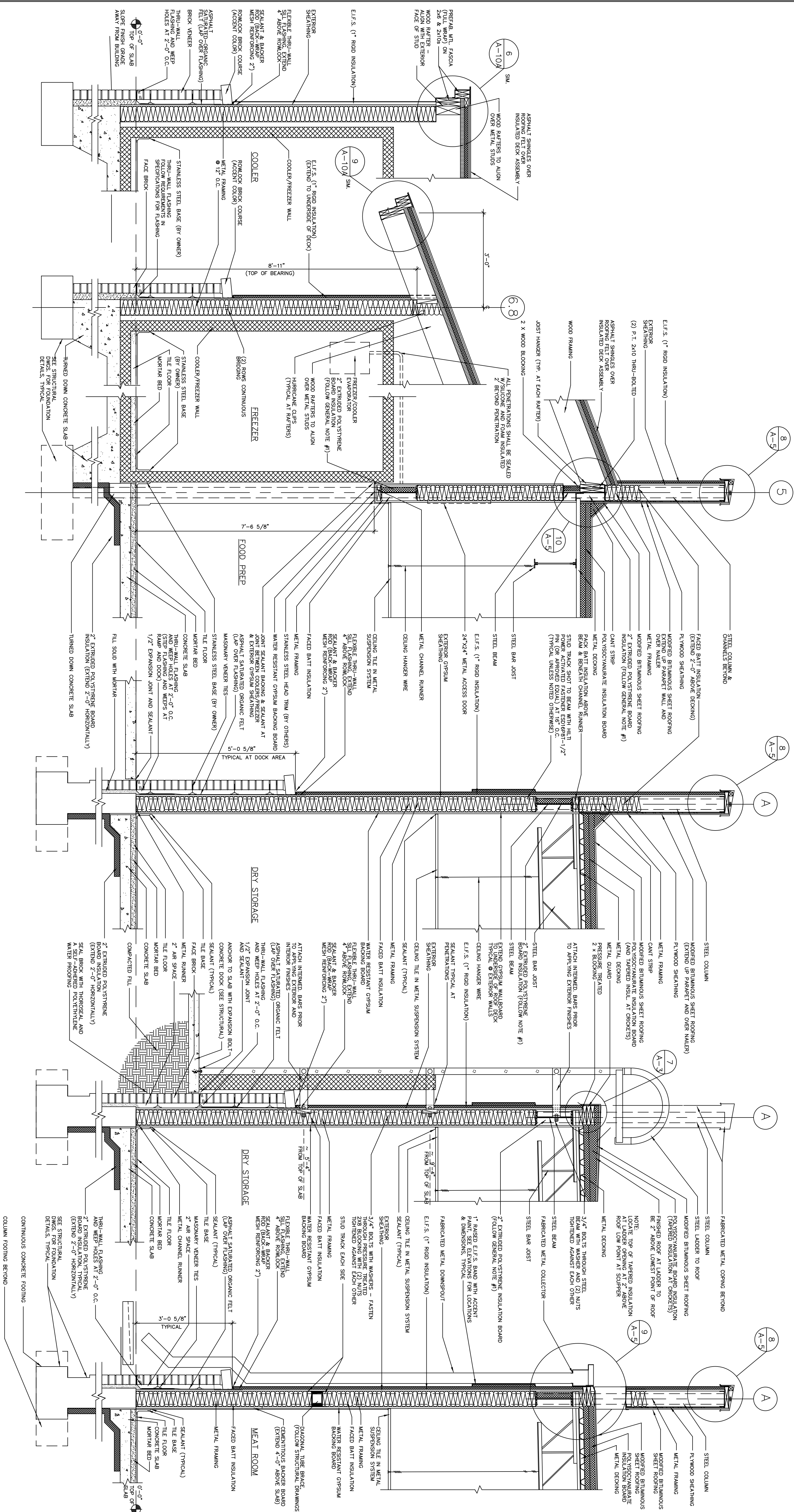

1 WALL SECTION
SCALE: 3/4" = 1'-0"

2 WALL SECTION
SCALE: 3/4" = 1'-0"

3 WALL SECTION
SCALE: 3/4" = 1'-0"

4 WALL SECTION
SCALE: 3/4" = 1'-0"

5 WALL SECTION
SCALE: 3/4" = 1'-0"

6 WALL SECTION
SCALE: 3/4" = 1'-0"

REVISIONS

REV.	DESCRIPTION	DATE	BY
A			R.A.D.

RYAN'S FAMILY STEAK HOUSES, INC.
149 WEST STREET, SUITE 202, NEW YORK, NY 10013

Ryan's
FAMILY
STEAK HOUSE

KITCHEN
WALL
SECTIONS