

Models 383 & 384 Slush Freezers

T

A

Y

L

O

R

OPERATOR'S MANUAL

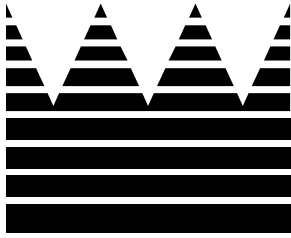

Models 383 & 384

Slush Freezers

Operating Instructions

053083-M



Complete this page for quick reference when service is required:

Taylor Distributor: _____

Address: _____

Phone: _____

Service: _____

Parts: _____

Date of Installation: _____

Information found on the data label:

Model Number: _____

Serial Number: _____

Electrical Specs: Voltage _____ Cycle _____

Phase _____

Maximum Fuse Size: _____ A

Minimum Wire Ampacity: _____ A

© October, 1998 Taylor
All rights reserved.
053083-M



The word Taylor and the Crown design
are registered trademarks in the United States
of America and certain other countries.

Taylor Company
750 N. Blackhawk Blvd.
Rockton, IL 61072



Table of Contents

Section 1	To the Installer	1
	Electrical Connections	1
Section 2	To the Operator	2
	Compressor Warranty Disclaimer	2
Section 3	Safety	3
Section 4	Operator Parts Identification	4
	Beater Door Assembly	5
	Accessories	6
Section 5	Important: To the Operator	7
	Symbol Legend	7
	Control Switch (Item 1)	7
	Fill Switch (Item 2)	8
	Add Mix Light (Item 3)	8
	Mix Out Light (Item 4)	8
	Viscosity Control (Item 5)	8
	Standby Switch (Optional)	8
	Display Light Switch (Item 6) (Optional)	8
	Push-Button Switch	8
Section 6	Operating Procedures	9
	Assembly	9
	Sanitizing	13
	Priming	14
	Closing Procedure	14
	Rinsing	14
	Cleaning	15
	Disassembly	16
	Brush Cleaning	16
Section 7	Important: Operator Checklist	17
	During Cleaning and Sanitizing	17
	Troubleshooting Bacterial Count	17
	Regular Maintenance Checks	17
	Winter Storage	17
Section 8	Troubleshooting Guide	18
Section 9	Parts Replacement Schedule	21
Section 10	Parts List	22
	Wiring Diagrams	28

Note: Continuing research results in steady improvements; therefore, information in this manual is subject to change without notice.

Section 1

To the Installer

This machine is designed for indoor use only.



DO NOT install the machine in an area where a water jet could be used to clean or rinse the machine. Failure to follow this instruction may result in serious electrical shock.

Electrical Connections

Each freezer requires one power supply for each data label. Check the data label on the freezer for fuse, circuit ampacity and electrical specifications. Refer to the wiring diagram provided inside of the electrical box, for proper power connections.

In the United States, this equipment is intended to be installed in accordance with the National Electrical Code (NEC), ANSI/NFPA 70-1987. The purpose of the NEC code is the practical safeguarding of persons and property from hazards arising from the use of electricity. This code contains provisions considered necessary for safety. Compliance therewith and proper maintenance will result in an installation essentially free from hazard!

In all other areas of the world, equipment should be installed in accordance with the existing local codes. Please contact your local authorities.

Stationary appliances which are not equipped with a power cord and a plug or other device to disconnect the appliance from the power source must have an all-pole disconnecting device with a contact gap of at least 3 mm installed in the external installation.



CAUTION: THIS EQUIPMENT MUST BE PROPERLY GROUNDED! FAILURE TO DO SO CAN RESULT IN SEVERE PERSONAL INJURY FROM ELECTRICAL SHOCK!

Beater rotation must be **counterclockwise** as viewed looking into the freezing cylinder of the Model 383/384 dispenser.

To correct rotation on a three-phase unit, exchange any two incoming power supply lines at the freezer main terminal block only.

To correct rotation on a single-phase unit, exchange the leads inside the beater motor. (Follow the diagram printed on the motor.)

Electrical connections are made directly to the splice box. The splice box is located behind the back panel.

IMPORTANT!
Beater rotation on the 380 Series differs from other Taylor equipment.

The slush freezer you have purchased has been carefully engineered and manufactured to give you dependable operation. The Taylor equipment, when properly operated and cared for, will produce a consistent quality product. Like all mechanical products, this machine will require cleaning and maintenance. A minimum amount of care and attention is necessary if the operating procedures outlined in this manual are followed closely.

This Operator's Manual should be read before operating or performing any maintenance on your equipment.

Your 380 Series model will NOT eventually compensate and correct for any errors during the set-up or filling operations. Thus, the initial assembly and priming procedures are of extreme importance. It is strongly recommended that all personnel responsible for the equipment's operation thoroughly read this manual.

If you require technical assistance, please contact your local authorized Taylor Distributor.

Compressor Warranty Disclaimer

The refrigeration compressor(s) on this machine are warranted for the term indicated on the warranty card accompanying this machine. However, due to the Montreal Protocol and the U.S. Clean Air Act Amendments of 1990, many new refrigerants are being tested and developed, thus seeking their way into the service industry. Some of these new refrigerants are being advertised as drop-in replacements for numerous applications. It should be noted that, in the event of ordinary service to this machine's refrigeration system, **only the refrigerant specified on the affixed data label should be used**. The unauthorized use of alternate refrigerants will void your compressor warranty. It will be the owner's responsibility to make this fact known to any technician he employs.

It should also be noted that Taylor does not warrant the refrigerant used in its equipment. For example, if the refrigerant is lost during the course of ordinary service to this machine, Taylor has no obligation to either supply or provide its replacement either at billable or unbillable terms. Taylor does have the obligation to recommend a suitable replacement if the original refrigerant is banned, obsoleted, or no longer available during the five year warranty of the compressor.

The Taylor Company will continue to monitor the industry and test new alternates as they are being developed. Should a new alternate prove, through our testing, that it would be accepted as a drop-in replacement, then the above disclaimer would become null and void. To find out the current status of an alternate refrigerant as it relates to your compressor warranty, call the local Taylor Distributor or the Taylor Factory. Be prepared to provide the Model/Serial Number of the unit in question.

We at Taylor Company are concerned about the safety of the operator when he or she comes in contact with the freezer and its parts. Taylor has gone to extreme efforts to design and manufacture built-in safety features to protect both you and the service technician. As an example, warning labels have been attached to the freezer to further point out safety precautions to the operator.



IMPORTANT - Failure to adhere to the following safety precautions may result in severe personal injury. Failure to comply with these warnings may damage the machine and its components. Component damage will result in part replacement expense and service repair expense.

To Operate Safely:



DO NOT operate the freezer without reading this operator's manual. Failure to follow this instruction may result in equipment damage, poor freezer performance, health hazards, or personal injury.



- **DO NOT** operate the freezer unless it is properly grounded.
- **DO NOT** attempt any repairs unless the main power supply to the freezer has been disconnected.
- **DO NOT** operate the freezer with larger fuses than specified on the freezer data label.

Failure to follow these instructions may result in electrocution. Contact your local authorized Taylor Distributor for service.



DO NOT use a water jet to clean or rinse the freezer. Failure to follow this instruction may result in serious electrical shock.



- **DO NOT** allow untrained personnel to operate this machine.
- **DO NOT** operate the freezer unless all service panels and access doors are restrained with screws.
- **DO NOT** put objects or fingers in door spout.
- **DO NOT** remove the door, beater, scraper blades, drive shaft or torque rotor shaft unless the power switch is in the "OFF" position.

Failure to follow these instructions may result in contaminated product or personal injury from hazardous moving parts.



USE EXTREME CAUTION when removing the beater assembly. The scraper blades are very sharp and may cause injury.



This freezer must be placed on a level surface. Failure to comply may result in personal injury or equipment damage.

DO NOT obstruct air intake and discharge openings: 6" (152 mm) minimum air space on all sides. Failure to follow this instruction may cause poor freezer performance and damage to the machine.

This freezer is designed to operate indoors, under normal ambient temperatures of 70° - 75°F (21° - 24°C). The freezer has successfully performed in high ambient temperatures of 104°F (40°C) at reduced capacities.

NOISE LEVEL: Airborne noise emission does not exceed 78 dB(A) when measured at a distance of 1.0 meter from the surface of the machine and at a height of 1.6 meters from the floor.

Section 4

Operator Parts Identification

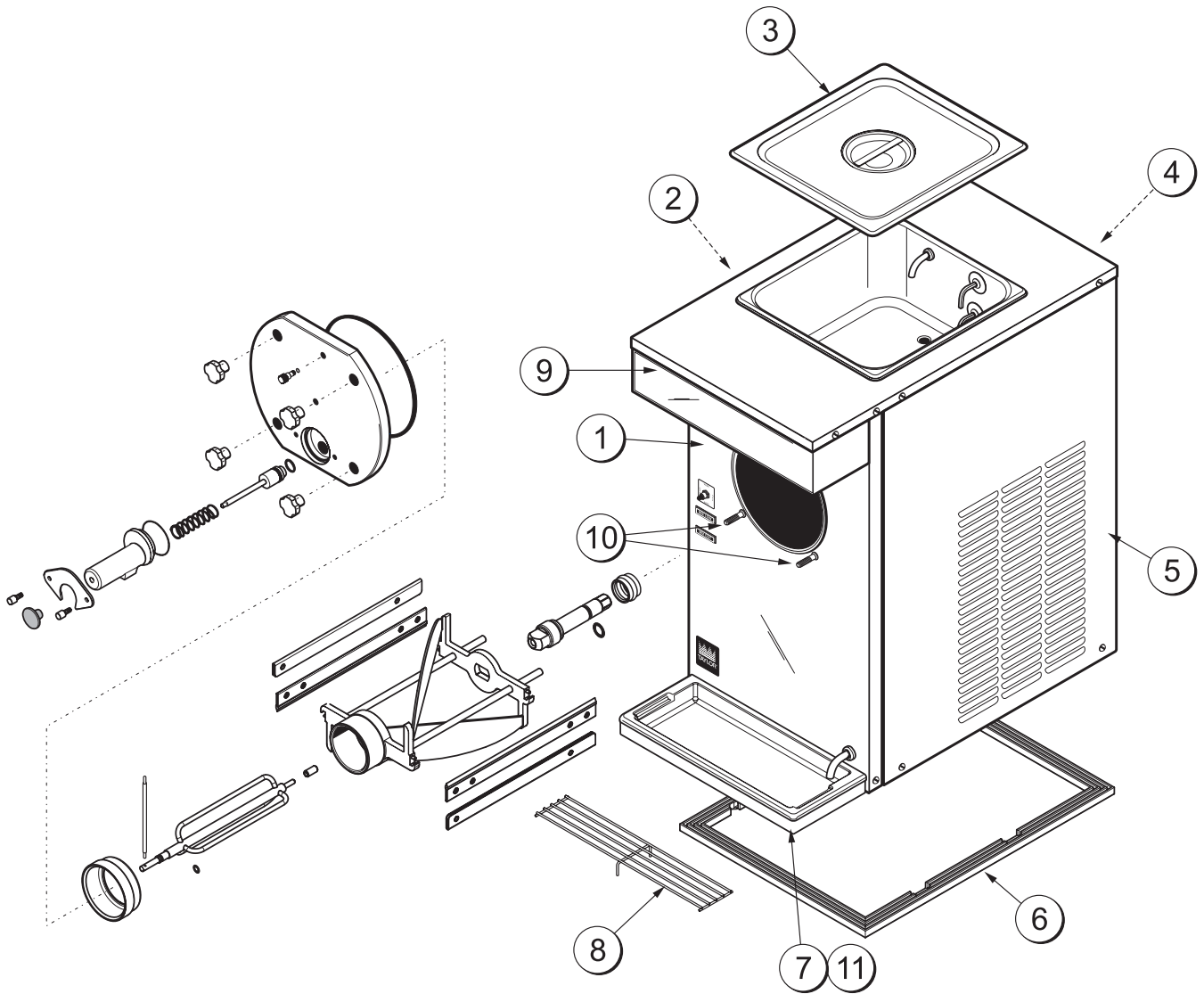

ITEM	DESCRIPTION	PART NO.
1	PANEL-FRONT	051090
2	PANEL-SIDE LEFT	052117
3	COVER-HOPPER 12 QT	045416
4	PANEL A.-REAR	X52116
5	PANEL-SIDE RIGHT	051713
6	GASKET-BASE PAN	051868

ITEM	DESCRIPTION	PART NO.
7	TRAY A.-DRIP	X46848
8	SHIELD-SPLASH	046851
9	DECAL-DEC-FLAVOR - 4	050703
	DECAL-DEC-TAYLOR	045967
10	STUD-FREEZER DOOR	051950
11	SHELF-DRIP TRAY	052065

Beater Door Assembly

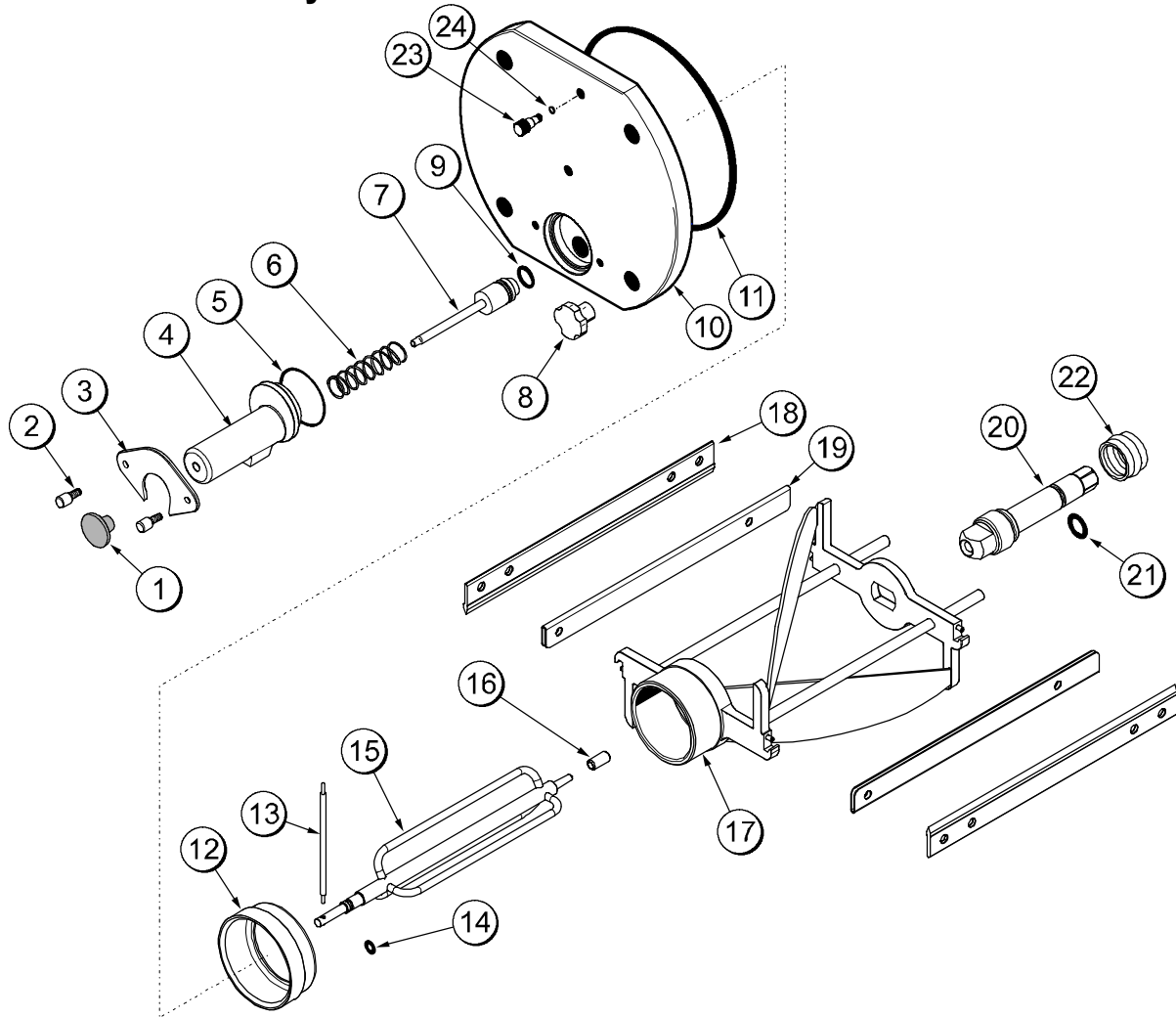

ITEM	DESCRIPTION	PART NO.
1	KNOB-DRAW VALVE-BLACK	047358
2	SCREW-1/4-20X9/16 THUMB	047632
3	PLATE-DRAW SPOUT MOUNT	049275
4	SPOUT-DOOR ZERO WASTE	049276-BLA
5	O-RING-2.375 OD X 1/16W	046830
6	SPRING-COMP.845X.055X3.5	047357
7	VALVE-DRAW	047353
8	NUT-STUD	045644
9	O-RING-7/8 OD X .103W	014402
10	DOOR A.-PARTIAL	X51098
11	O-RING-8-3/8 ODX.105W	027814
12	BEARING-FRONT-TORQUE	052005

ITEM	DESCRIPTION	PART NO.
13	ARM-TORQUE	014500
14	O-RING-.291 ID X .080W	018550
15	TORQUE A.	X51081
16	BEARING-GUIDE	014496
17	BEATER A.-TORQUE	X51105
18	BLADE-SCRAPER	051088
19	CLIP-SCRAPER BLADE	051978
20	SHAFT-BEATER	049270
21	O-RING-7/8 OD X .139W	025307
22	SEAL-DRIVE SHAFT	032560
23	PLUG-PRIME *380/1*	046833
24	O-RING-9/32 OD X 1/16 WALL	029751

Accessories

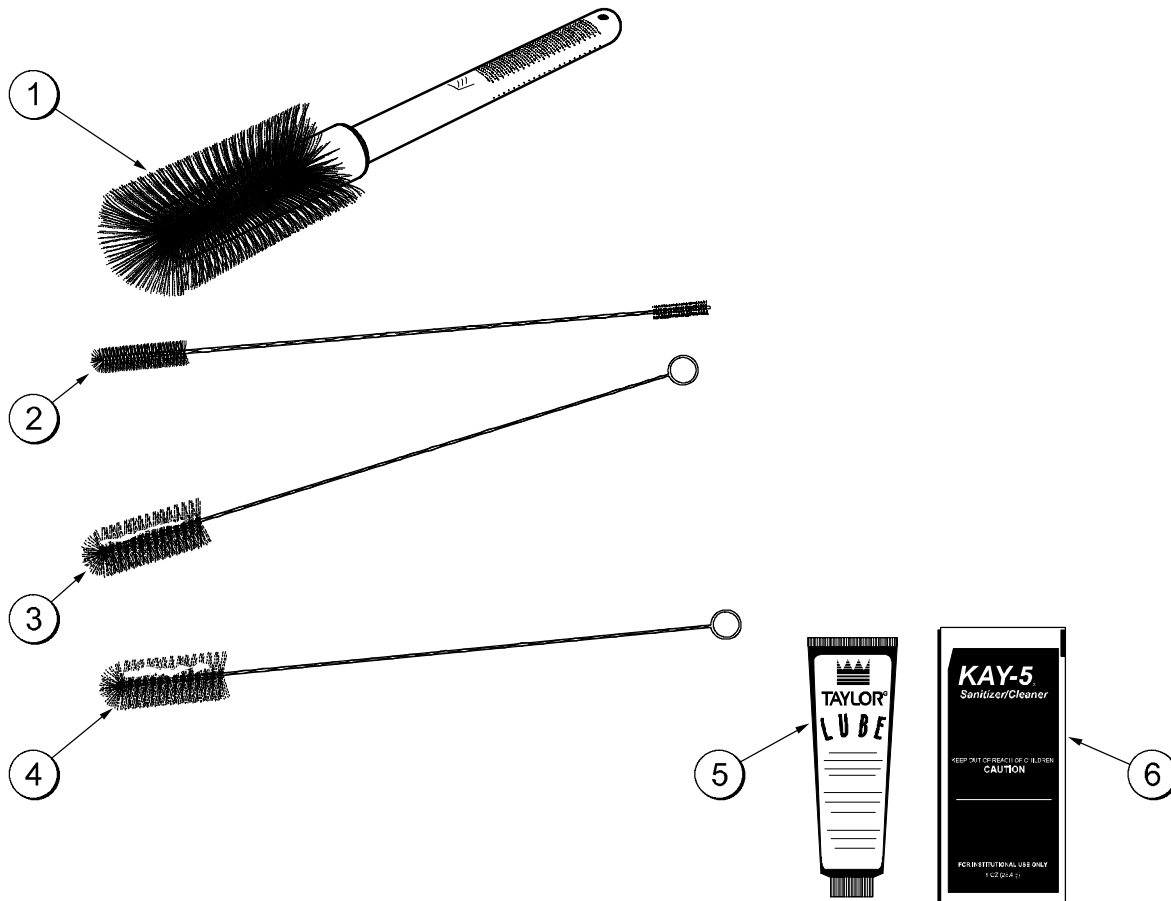

ITEM	DESCRIPTION	PART NO.
1	BRUSH-MIX PUMP BODY-3"X7"	023316
2	BRUSH-DRAW VALVE 1"X2"X17"	013073
3	BRUSH-DOUBLE ENDED	013072
4	BRUSH-REAR BRG 1IN.DX2IN.L	013071

ITEM	DESCRIPTION	PART NO.
5	LUBRICANT-TAYLOR HI PERF-4	048232
6	SANITIZER KAY-5 (CASE OF 125 PACKETS)	041082



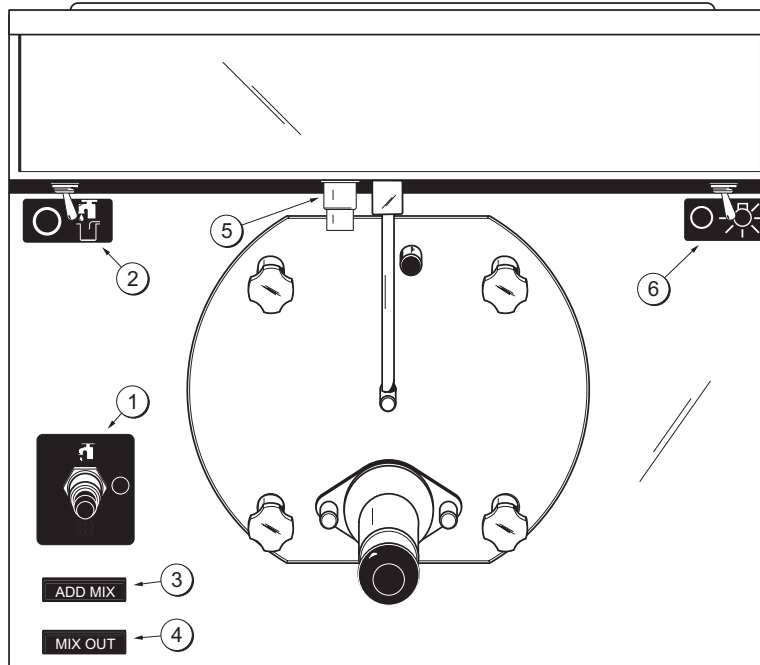

Section 5

Important: To the Operator

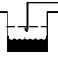

ITEM	DESCRIPTION
1	Control Switch
2	Fill Switch
3	Add Mix Light
4	Mix Out Light
5	Viscosity Control
6	Display Light Switch

Symbol Legend

-  = The "ON/AUTO" symbol.
-  = The "OFF" symbol.
-  = The "WASH" symbol.
-  = The "ADD MIX" symbol.
-  = The "MIX OUT" symbol.

Control Switch (Item 1)

The control switch is located on the front of the machine. The center position is "OFF". The "UP" position is the "WASH" mode and activates the beater motor only. The "DOWN" position is the "AUTO" mode. The "AUTO" mode activates the beater motor and enables refrigeration when the fill switch is in the "ON" position.

Fill Switch (Item 2)

The fill switch is located under the control channel. The “ON” position enables refrigeration when the control switch is in the “AUTO” position. The “ON” position enables the fill system to replenish and maintain product levels in the freezing cylinder and in the hopper. The “OFF” position terminates the fill function. The refrigeration system is disabled when the fill switch is in the “OFF” position.

Add Mix Light (Item 3)

An “ADD MIX” indicating light is located on the front panel. When the light is lit, it indicates that the mix supply in the hopper is low and must be replenished.

Mix Out Light (Item 4)

A “MIX OUT” indicating light is located on the front panel. When the light is lit, it indicates that the hopper is empty and the mix supply must be replenished. When the indicator lights, refrigeration is automatically disabled to prevent component damage. The beater motor continues to run.

Viscosity Control (Item 5)

The viscosity adjustment screw is located under the control channel. The viscosity (thickness) of the slush can be adjusted by turning the adjustment screw clockwise for a thicker product or counterclockwise for a thinner product.

Standby Switch (Optional)

The standby switch is located under the control channel. To maintain a good quality product during long no sale periods, the standby mode will maintain the product at approximately 38°F to 40 °F (3.3°C to 4.4°C).

To operate the standby mode, place the power switch in the “AUTO” position. Place the fill switch in the “FILL” position and the standby switch in the “STANDBY” position.

To resume normal operation, leave the power switch in the “AUTO” position and the fill switch in the “FILL” position. Move the standby switch to the “OFF” position.

Display Light Switch (Item 6) (Optional)

The display light switch is located under the control channel. The left position is “OFF”. The right position is “ON”, and activates the display light.

Push-Button Switch

If an overload condition occurs, the freezer will automatically stop operating. To properly reset the freezer, place the toggle switch in the “OFF” position. Wait two or three minutes; then press the push-button switch. Place the power switch in the “WASH” position and observe the freezer’s performance; place the power switch in the “AUTO” position.

Note: If the freezer is unplugged from the wall receptacle, it will be necessary to press the push-button switch for the freezer to operate once power is re-established.

Section 6

Operating Procedures

We begin our instructions at the point where the parts are disassembled and laid out to dry from the previous night's cleaning.

The following procedures will explain how to assemble the parts into the freezer, sanitize them, and prime the freezer with fresh product.

If you are disassembling the machine for the first time or need information to get to this starting point in our instructions, turn to "Disassembly" on page 16, and start there.

Assembly



MAKE SURE THE CONTROL SWITCH IS IN THE "OFF" POSITION. Failure to do so may cause injury from hazardous moving parts, or electrocution.

Note: When lubricating parts, use an approved food grade lubricant (example: Taylor Lube HP). Every three months discard rubber parts and install new rubber parts.

Step 1

Install the beater drive shaft: Lubricate the groove and shaft portion that comes in contact with the rear shell bearing on the beater drive shaft. **DO NOT** lubricate the hex end of the drive shaft.

Lubricate and install the drive shaft o-ring into its groove.

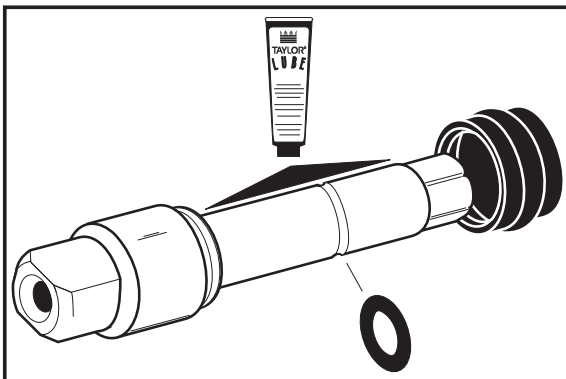

Figure 1

Slide the seal over the shaft until it snaps into the groove. Fill the inside portion of the seal with lubricant and evenly lubricate the flat side of the seal that fits onto the rear shell bearing.

Install the drive shaft into the freezing cylinder, hex end first. The drive shaft seal must fit securely over the rear shell bearing. Be certain the drive shaft fits into the drive coupling without binding.

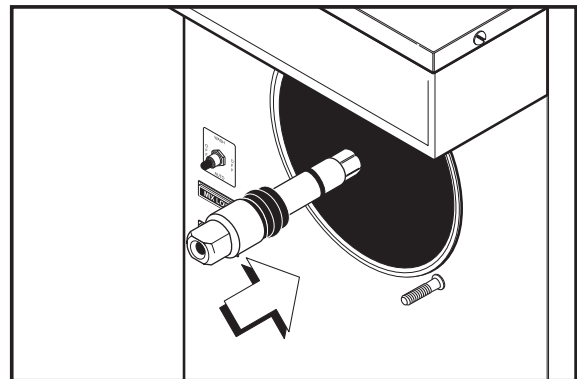

Figure 2

Step 2

Install the beater assembly: First check scraper blades for any nicks or signs of wear. If any nicks are present or if the blades are worn, replace the blades.

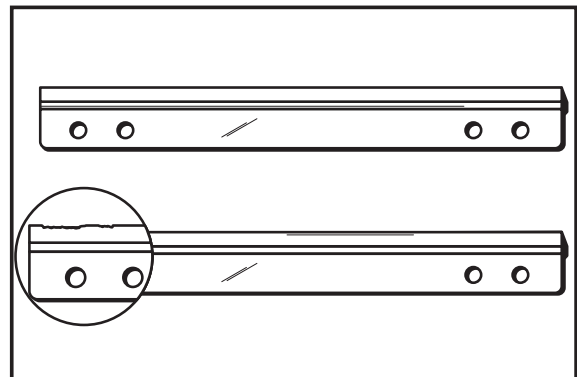

Figure 3

If the blades are in good condition, assemble the clips on the blades. Install one scraper blade and clip over the two holding pins on one side of the beater. Holding the blade and clip on the beater, turn the assembly over and install the second scraper blade and clip.

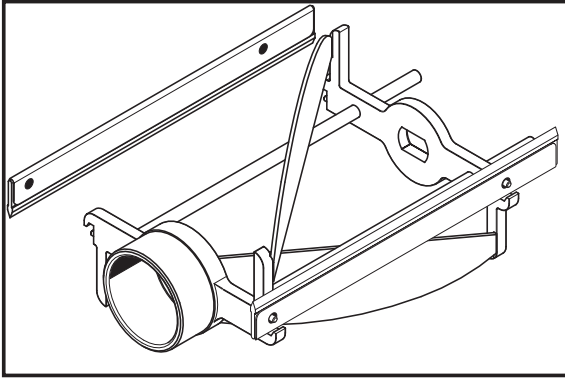

Figure 4

Holding the blades in position, insert the beater assembly into the freezing cylinder, and slide the assembly into position over the drive shaft. Turn the beater slightly to be certain that the beater is properly seated.

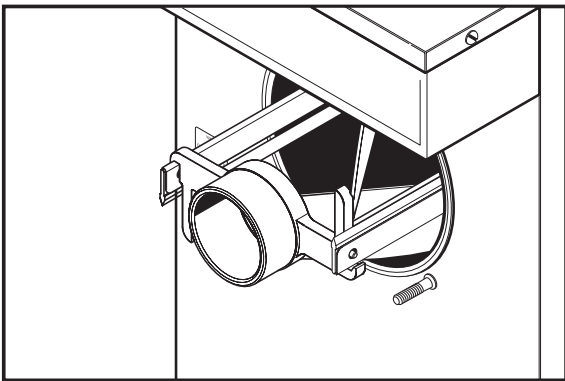

Figure 5

When in position, the beater bearing hub will protrude beyond the front of the freezing cylinder about 1/4 inch (6.35 mm).

Step 3

Install the torque rotor. Install the plastic guide bearing on the short end of the torque rotor. Slide the o-ring into the groove on the long end of the torque rotor and lubricate the o-ring. **Do not** lubricate the guide bearing.

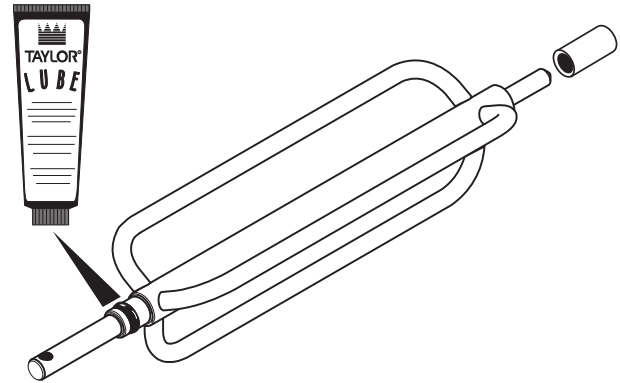

Figure 6

Insert the torque rotor (guide bearing end first) into the pilot hole in the center of the drive shaft. The hole in the torque rotor shaft should be rotated to the 12 o'clock position.

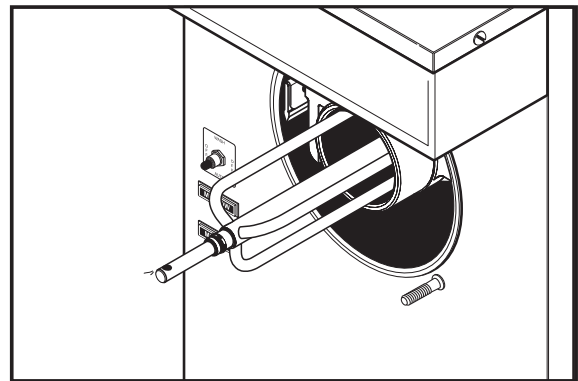

Figure 7

Step 4

Install the freezer door. Slide the draw valve o-ring into the groove on the draw valve and lubricate the o-ring.

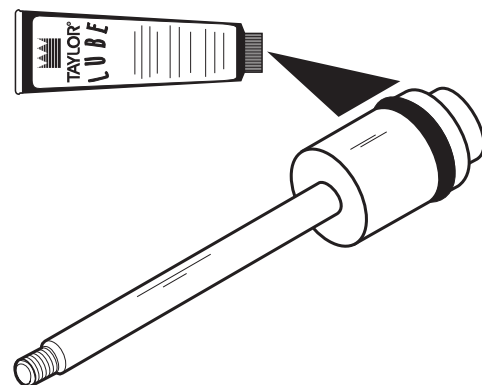

Figure 8

Place the draw valve spring over the shaft end on the draw valve.

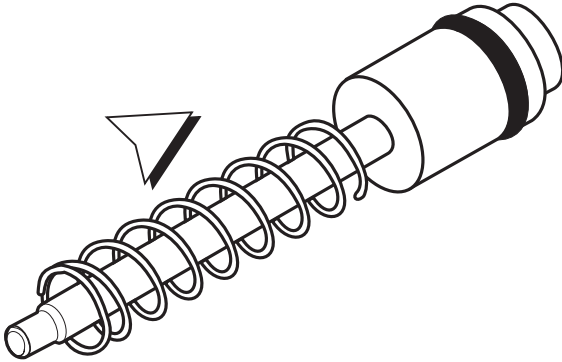

Figure 9

Insert the draw valve and spring into the door spout until the threaded end of the shaft passes through the hole in the end of the door spout. Thread the draw valve knob onto the end of the draw valve shaft.

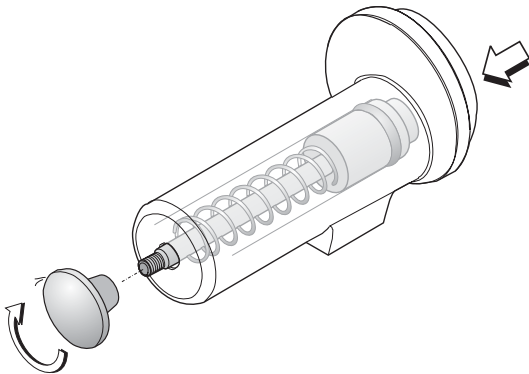

Figure 10

Place the door spout seal o-ring into the groove in the door and lubricate the components.

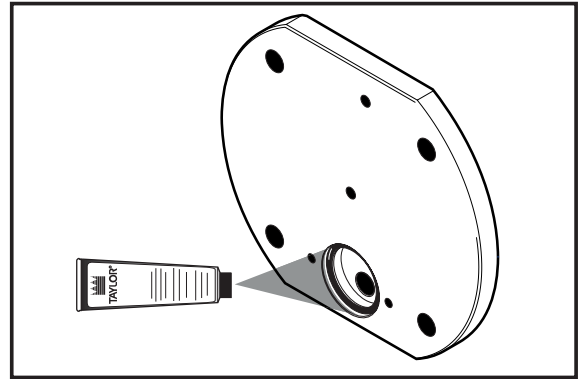

Figure 11

Align the draw spout assembly with the door. Place the draw spout mounting plate over the draw spout assembly and align the holes.

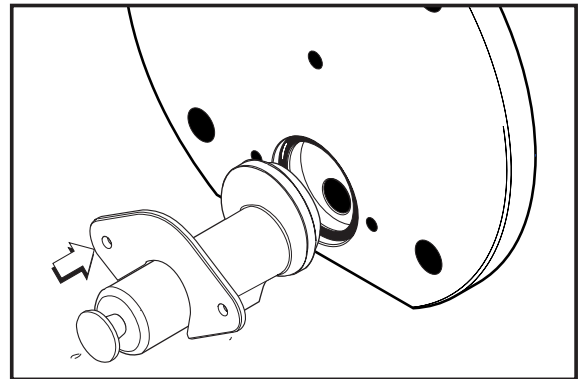

Figure 12

Using the thumb screws, fasten the draw spout assembly and draw spout mounting plate to the door.

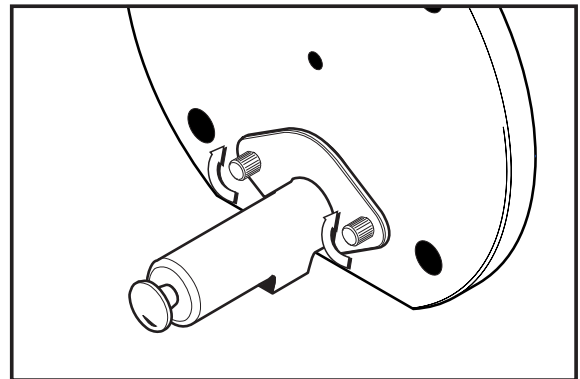

Figure 13

Slide the o-ring into the groove on the prime plug. Apply an even coat of lubricant to the o-ring and shaft.

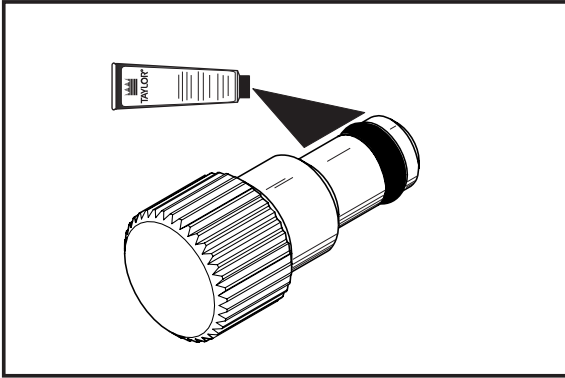

Figure 14

Install the prime plug into the bleed port in the top of the freezer door. Do not over-tighten the prime plug.

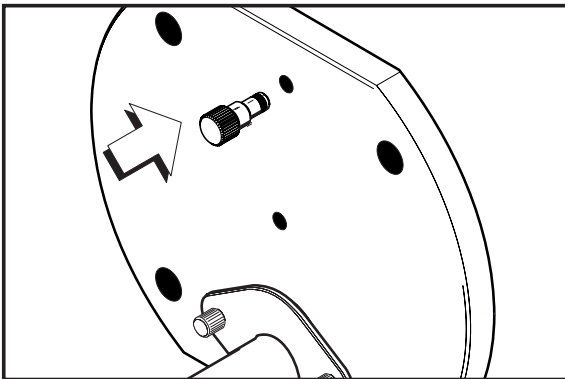

Figure 15

Place the large o-ring into the groove on the back side of the door and lubricate the installed o-ring.

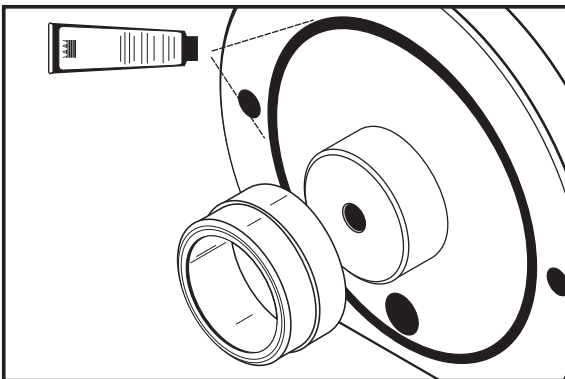

Figure 16

Place the door bearing into the back side of the door.

Note: Do not lubricate the door bearing.

Step 5

Install the freezer door. Position the torque rotor into the hole in the center of the door. Install the door on the four studs on the front of the freezing cylinder. Firmly push the door into place.

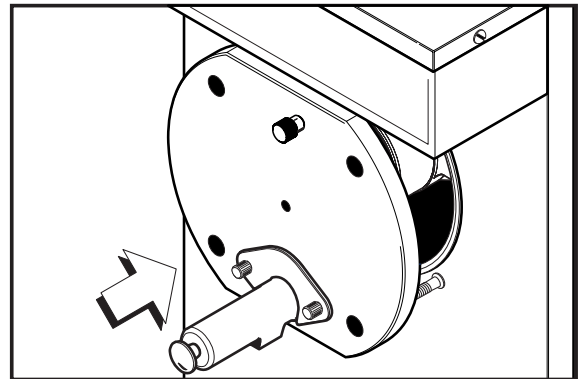

Figure 17

Step 6

Install the four handscrews on the studs. Finger-tighten the screws equally in a crisscross pattern to insure that the door is snug. Do not over-tighten the handscrews.

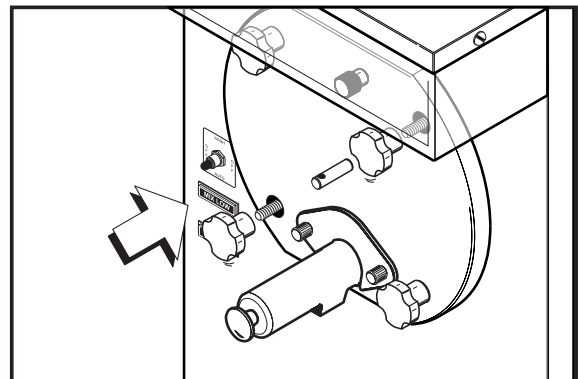

Figure 18

Step 7

Install the torque arm. Position the torque arm by inserting it through the slot in the torque switch arm and down into the hole in the torque rotor which protrudes from the door. Verify proper installation by moving the torque rotor back and forth to be sure it moves freely and easily.

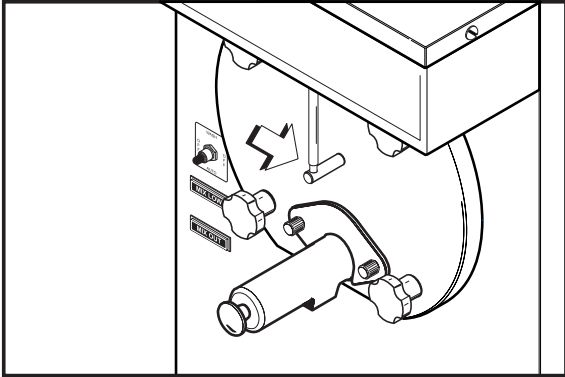

Figure 19

Step 8

Install the front drip tray and the splash shield under the door spout.

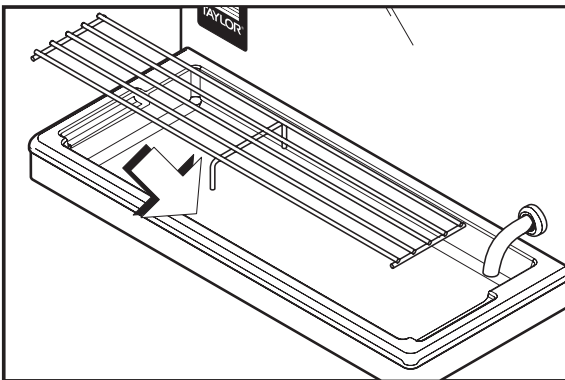

Figure 20

Sanitizing

Step 1

Prepare two gallons (7.6 liters) of an approved 100 PPM sanitizing solution (example: Kay-5). Use WARM WATER AND FOLLOW THE MANUFACTURER'S SPECIFICATIONS.

Step 2

Pour the two gallons (7.6 liters) of sanitizing solution into the hopper and allow it to flow into the freezing cylinder.

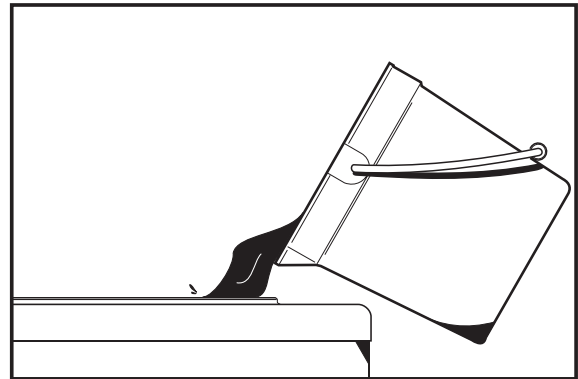

Figure 21

Step 3

While the solution is flowing into the freezing cylinder, brush clean the mix hopper, mix inlet hole, and mix level sensing probe(s).

Step 4

Remove the prime plug and allow all of the solution to flow into the freezing cylinder. Replace the prime plug.

Step 5

Place the control switch in the "WASH" position. This will cause the sanitizing solution in the freezing cylinder to be agitated. Allow the solution to agitate for five minutes.

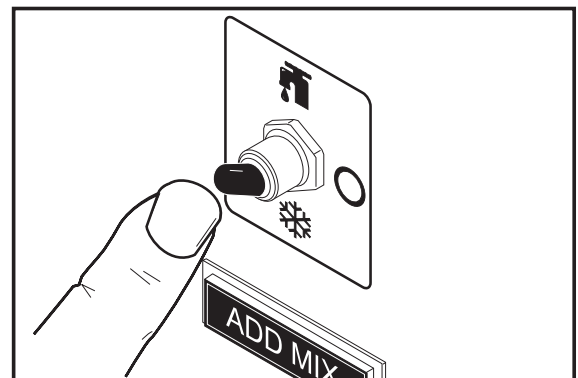

Figure 22

Step 6

Place the control switch in the “OFF” position. Place an empty mix pail beneath the door spout. Open the draw valve and draw off all of the sanitizing solution. When the sanitizer stops flowing from the door spout, close the draw valve.

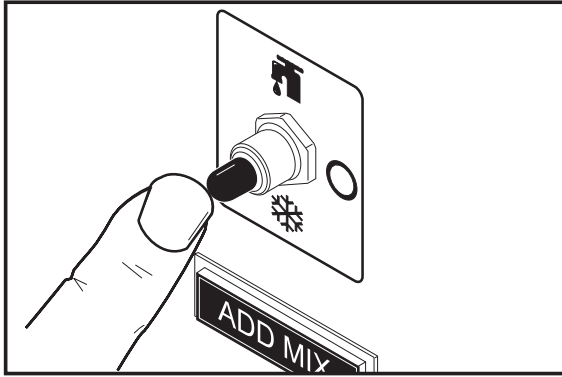

Figure 23

Priming

Step 1

Remove the prime plug from the bleed port. With a mix pail beneath the door spout, open the draw valve. Fill the hopper with **FRESH** product and allow it to flow into the freezing cylinder. This will force out any remaining sanitizing solution. When full strength product is flowing from the door spout, close the draw valve.

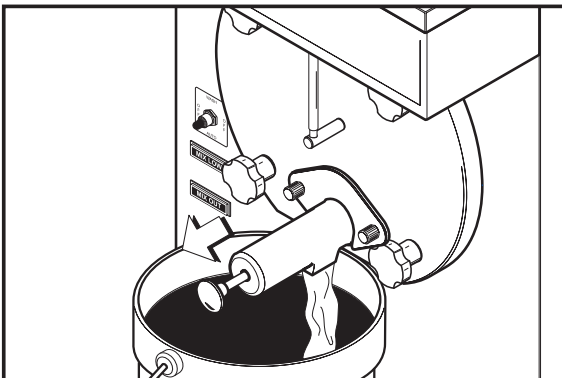

Figure 24

Step 2

When product rises to the bleed port, replace the prime plug. Fill the hopper with fresh mix.

Step 3

Place the hopper cover in position.

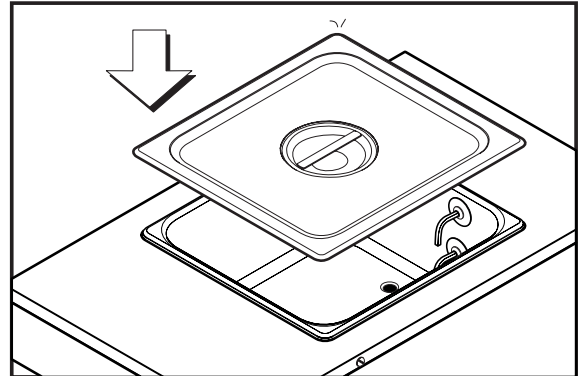

Figure 25

Closing Procedure

To disassemble the units, the following items will be needed:

- Two cleaning pails
- Necessary brushes provided with freezer
- Cleaner
- Single service towels

Rinsing

Step 1

Draw all remaining product from the freezer.

Step 2

Remove the hopper cover.

Step 3

Pour **cool**, clean water into the mix hopper and allow it to flow into the freezing cylinder. With the brushes provided, scrub the mix hopper, mix inlet hole, and mix probes.

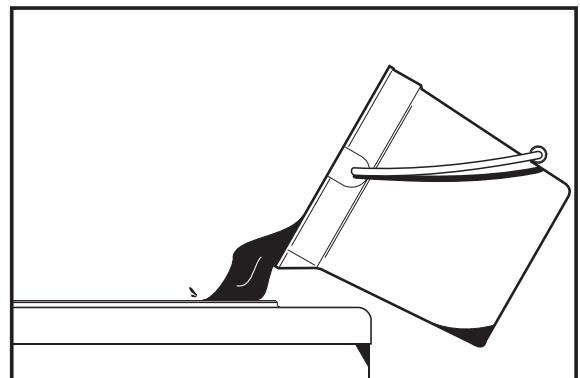

Figure 26

Step 4

Place the control switch in the “WASH” position. With a mix pail beneath the door spout, open the draw valve. Drain all the rinse water from the freezing cylinder. When the rinse water stops flowing from the door spout, close the draw valve and place the control switch in the “OFF” position.

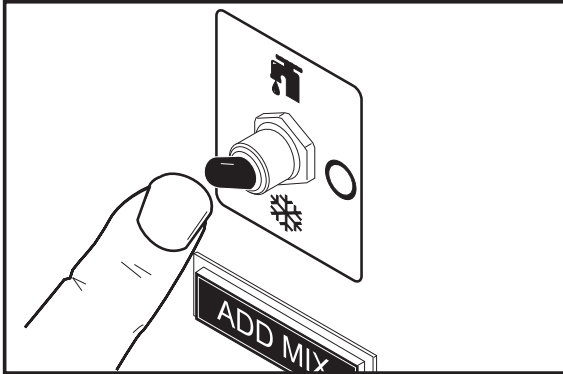

Figure 27

Repeat this procedure until the rinse water being drawn from the freezing cylinder is **clear**.

Cleaning

Step 1

Prepare two gallons (7.6 liters) of an approved cleaning solution (Example: Kay-5®). USE WARM WATER AND FOLLOW THE MANUFACTURER'S SPECIFICATIONS.

Step 2

Pour the cleaning solution into the hopper and allow it to flow into the freezing cylinder.

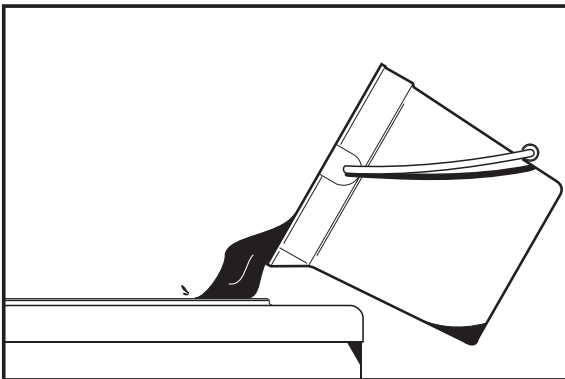

Figure 28

Step 3

Brush clean the mix hopper, the mix inlet hole, and the mix level probes.

Step 4

Place the control switch in the “WASH” position. This will cause the cleaning solution in the freezing cylinder to be agitated. Allow the solution to agitate for five minutes.

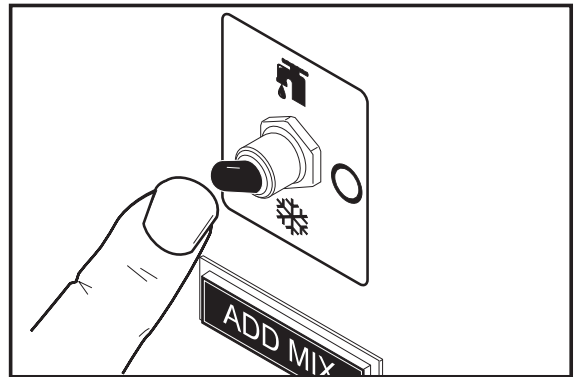

Figure 29

Step 5

Place the control switch in the “OFF” position. Place an empty mix pail beneath the door spout. Open the draw valve and draw off all of the cleaning solution. When the solution stops flowing from the door spout, close the draw valve.

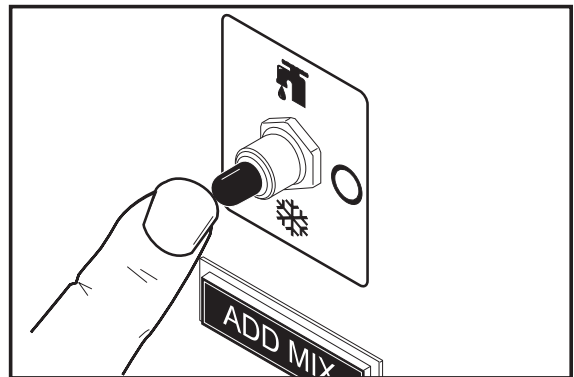

Figure 30

Disassembly



BE SURE THE CONTROL SWITCH IS IN THE “OFF” POSITION. Failure to do so may cause injury from hazardous moving parts, or electrocution.

Step 1

Remove the torque arm, handscrews, freezer door, beater assembly, scraper blades and clips, torque rotor, and the drive shaft, and take these parts to the sink for cleaning.

Step 2

Remove the front drip tray and splash shield and take them to the sink for cleaning.

Brush Cleaning

Step 1

Prepare a sink with an approved cleaning solution. **USE WARM WATER AND FOLLOW THE MANUFACTURER’S SPECIFICATIONS.**

IMPORTANT: Follow the label directions. Too **STRONG** of a solution can cause parts damage, while too **MILD** of a solution will not provide adequate cleaning. Make sure all brushes provided with the freezer are available for brush cleaning. Make sure all brushes provided with the freezer are available for brush cleaning.

Step 2

Remove the:

- seal from the drive shaft.
- o-ring and front bearing from the freezer door.
- door spout from the freezer door.
- draw valve and spring from the door spout.
- o-ring from the draw valve.
- o-ring and guide bearing from the torque rotor.
- prime plug and prime plug o-ring.

Note: To remove o-rings, use a single service towel to grasp the o-ring. Apply pressure in an upward direction until the o-ring pops out of its groove. With the other hand, push the top of the o-ring forward and it will roll out of the groove and can be removed easily .

Step 3

Thoroughly brush clean all disassembled parts in the cleaning solution making sure all lubricant and mix film is removed. Place all the cleaned parts on a clean dry surface to air dry.

Step 4

Return to the freezer with a small amount of cleaning solution. Brush clean the rear shell bearing with the black bristle brush.

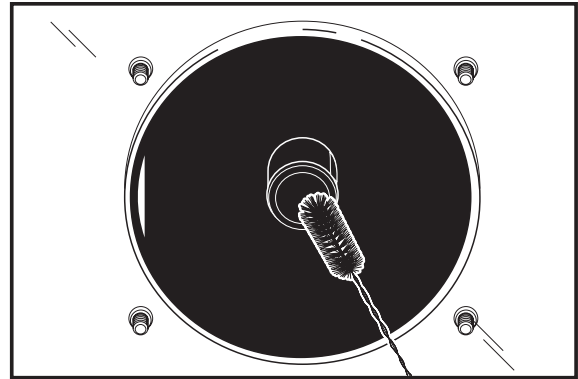

Figure 31

Step 5

Wipe clean all exterior surfaces of the freezer.

Section 7 Important: Operator Checklist

During Cleaning and Sanitizing



ALWAYS FOLLOW LOCAL HEALTH CODES.

Cleaning and sanitizing schedules are governed by your State or local regulatory agencies and must be followed accordingly. The following check points should be stressed during the cleaning and sanitizing operations.

WE RECOMMEND DAILY CLEANING AND SANITIZING.

Troubleshooting Bacterial Count

- 1. Thoroughly clean and sanitize the machine regularly, including complete disassembly and brush cleaning.
- 2. Use all brushes supplied for thorough cleaning. The brushes are specially designed to reach all product passageways.
- 3. Use the white bristle brush to clean the mix inlet hole which extends from the mix hopper down to the rear of the freezing cylinder.
- 4. Use the black bristle brush to thoroughly clean the rear shell bearing located at the rear of the freezing cylinder. Be sure to have a generous amount of cleaning solution on the brush.
- 5. Using a screwdriver and cloth towel, keep the drive socket and rear shell bearing clean and free of lubricant and product deposits.
- 6. Properly prepare the cleaning and sanitizing solutions. Read and follow label directions carefully. Too strong of a solution may damage the parts and too weak of a solution will not do an adequate job of cleaning or sanitizing.

Regular Maintenance Checks

- 1. Replace scraper blades that are nicked or damaged.
- 2. Before installing the beater, be certain that the scraper blades are properly attached over the pins.
- 3. Check the rear shell bearing for signs of wear (excessive product leakage from the rear drip pans to the front drip tray).
- 4. Dispose of o-rings and seals if they are worn, torn, or fit too loosely, and replace with new ones.
- 5. Follow all lubricating procedures as outlined in “Assembly”.
- 6. If your machine is air cooled, check the condenser(s) for accumulation of dirt and lint. Dirty condensers will reduce the efficiency and capacity of the machine. Condensers should be cleaned **monthly**. Use a soft brush to clean between the fins. **Never** use screwdrivers or other metal probes to clean between the fins.

Winter Storage

If the place of business is to be closed during the winter months, it is important to protect the freezer by following certain precautions, particularly if the building is subject to freezing conditions.

Disconnect the freezer from the main power source to prevent possible electrical damage.

Your local Taylor Distributor can perform this service for you.

Wrap detachable parts of the freezer such as beater, blades, drive shaft, and freezer door, and place in a protected dry place. Rubber trim parts and gaskets can be protected by wrapping them with moisture-proof paper. All parts should be thoroughly cleaned of dried mix or lubrication which attract mice and other vermin.

Section 8

Troubleshooting Guide

PROBLEM	PROBABLE CAUSE	REMEDY	PAGE REF.
1. No product is being dispensed with the draw valve open.	a. Product freeze-up due to improper product mixing.	a. Follow directions for mixing product carefully.	--
	b. The torque arm is not installed.	b. Install the torque arm.	13
	c. Bent or improperly installed torque rotor.	c. Replace the bent rotor or follow proper assembly procedures.	10
2. The product is too thin.	a. Improper mixing of product.	a. Follow directions for mixing product carefully.	--
	b. Missing, incorrectly installed, or worn scraper blades.	b. Replace or install the blades correctly.	9
	c. The viscosity adjustment screw needs to be adjusted.	c. Adjust the screw accordingly.	7
	d. The torque rotor is bound leaving the torque arm in the cold position. Therefore, the compressor will not run.	d. Free the torque rotor.	--
3. The product is too stiff.	a. The torque rotor bound leaving the torque arm in the warm position. Therefore, the compressor continually runs.	a. Free the torque rotor.	--
	b. The torque arm is missing or bent.	b. Install or replace the torque arm.	13
	c. The viscosity adjustment screw needs to be adjusted.	c. Adjust the screw accordingly.	7
	d. Improper mixing of product.	d. Follow directions for mixing product carefully.	--

PROBLEM	PROBABLE CAUSE	REMEDY	PAGE REF.
4. The freezing cylinder walls are scored.	a. Broken beater pins.	a. Repair or replace the beater assembly.	--
	b. The bearing unit is out of alignment.	b. Contact a service technician.	--
	c. The beater assembly is bent.	c. Repair or replace the beater assembly.	--
	d. The door bearing is missing.	d. Install the door bearing.	12
5. Unable to remove the drive shaft.	a. There is lubrication on the hex end of the drive shaft.	a. Do not lubricate the hex end of the drive shaft. Contact a service technician for drive shaft removal.	9
	b. Rounded corners of the drive shaft, drive coupling or both components.	b. Replace the drive shaft, drive coupling or both components.	--
6. Excessive mix leakage in the rear drip pan.	a. Improper or inadequate lubrication on the drive shaft o-ring or seal.	a. Use the correct lubricant (Taylor Lube) and follow proper lubrication procedures.	9
	b. Worn or missing o-ring or seal on the drive shaft.	b. Replace rubber parts every 3 months.	9
	c. Worn rear shell bearing.	c. Contact a service technician for component replacement.	--
7. No freezer operation with the unit in the "AUTO" position.	a. The unit is unplugged.	a. Plug the power cord in the wall receptacle.	--
	b. The beater motor has tripped the reset mechanism.	b. Place the toggle switch in the "OFF" position. Allow the motor to cool, then press the reset button and resume normal operation. Contact a service technician if the problem continues.	--
	c. The circuit breaker tripped or the fuse has blown.	c. Reset the circuit breaker or replace the blown fuse.	--

PROBLEM	PROBABLE CAUSE	REMEDY	PAGE REF.
8. The unit is not freezing product when placed in the "AUTO" mode.	a. The torque rotor is bound, leaving the torque arm in the cold position. Therefore the compressor will not run.	a. Free the torque rotor.	--
	b. The torque arm is bent.	b. Replace the torque arm.	--
	c. The condensers are dirty.	c. Clean the condensers monthly.	17
	d. There is a mix out condition.	d. Refill the mix system.	7
	e. The circuit breaker has tripped or the fuse has blown.	e. Reset the circuit breaker or replace the blown fuse.	--
9. The guide bearing is missing.	a. The guide bearing is stuck in the drive shaft.	a. Remove the guide bearing from the hole in the drive shaft.	--
10. There is excessive leakage from the draw spout.	a. There is improper or inadequate lubrication on the draw valve o-rings.	a. Use the correct lubricant (Taylor Lube) and follow proper lubrication procedures.	10
	b. Worn or missing draw valve o-ring.	b. Replace rubber parts every 3 months.	9
11. The door is not easily installed.	a. Position of the beater assembly.	a. Position the beater so that the scraper blades are in the 12:00 o'clock and 6:00 o'clock positions.	9

Section 9

Parts Replacement Schedule

PART DESCRIPTION	EVERY 3 MONTHS	EVERY 6 MONTHS	ANNUALLY
Scraper Blade		Inspect & Replace if Necessary	Minimum
Drive Shaft Seal	X		
Freezer Door O-Ring	X		
Door Port O-Ring	X		
Front Bearing	X		
Door Spout O-Ring	X		
Drive Shaft O-Ring	X		
Torque Arm O-Ring	X		
Brushes		Inspect & Replace if Necessary	Minimum

Section 10

Parts List

DESCRIPTION	PART NUMBER	QTY. 383	QTY. 384	WARR. CLASS	REMARKS	PARTS UPDATE
ACCUMULATOR-COPPER 2" DIA 10"	047062	1		103		
ARM-TORQUE	014500	1	1	103		
BEARING-FRONT-TORQUE*382-384*	052005	1	1	000		
BEARING-GUIDE	014496	1	1	000		
BEARING-SHELL-REAR	051099	1	1	000		
+GUIDE-DRIP SEAL	028992	1	1	000		
+NUT-BRASS BEARING	028991	1	1	000		
+O-RING-1/2OD X .070W	024278	2	2	000		
+WASHER-BEARING LOCK	012864	1	1	000		
BEARING-UNIT REAR	025629	1	1	103		
BEATER A.-TORQUE *382-384*	X51105	1	1	103		
+BLADE-SCRAPER *382*	051088	2	2	000		
+CLIP-SCRAPER BLADE*11-21/32*	051978	2	2	000		
BELT-POLY V-510J10	047049	1	1	000		
BRUSH-DOUBLE ENDED-PUMP & FEED TUBE	013072	1	1	000		
BRUSH-DRAW VALVE 1"ODX2"X17"L	013073	1	1	000		
BRUSH-MIX PUMP BODY-3"X7"WHITE	023316	1	1	000		
BRUSH-REAR BRG 1IN.DX2IN.LGX14	013071	1	1	000		
COMPRESSOR AKA9462ZXA-AK172BT	049302-12	1		512	115/60/1	
+CAPACITOR-RUN- 25UF/370VAC	023739	1		103	115/60/1	
+CAPACITOR-START- 72-88UF/250V	039557-27	1		103	115/60/1	
+RELAY-START-COMPRESSOR	045432-12	1		103	115/60/1	
COMPRESSOR AKA9462ZXD-AK172ET	049302-27	1		512	208-230/60/1	
+CAPACITOR-RUN- 15UF/370V	027087	1		103		
+CAPACITOR-START-72-88UF/330V	039567	1		103		
+RELAY-START-COMPRESSOR	048150	1		103		
COMPRESSOR M51B143BBCA	036880-27		1	512	208-230/60/1	
+CAPACITOR-RUN- 25 UF/440V	037431		1	103		
+CAPACITOR-START-161-193UF/250V	031790		1	103		
+RELAY-START-COMPRESSOR	037430		1	103		
CONDENSER-AC-12LX16HX2.5T3ROW	048935-SP	1		103		
CONDENSER-WC-10-1/4DX5-7/8H	018278		1	103		

383/384

DESCRIPTION	PART NUMBER	QTY. 383	QTY. 384	WARR. CLASS	REMARKS	PARTS UPDATE
CORD-POWER-230V-15A PLUG-75"L	025340-27	1		103	208-230/60/1	
CORD-POWER-125V-NEMA 5-20P-6'L	085093	1		103	115/60/1	
CORD-POWER-250V-NEMA 6-20P-8'L	046088		1	103	208-230/60/1	
COVER-HOPPER-12 QT	045416	1	1	103		
DEC A.-PLATE *382-384*	X51131	1	1	103		
DECAL-CLEAN INST.-HOPPER	019029	1	1	000		
DECAL-DEC-380-FLAVOR SET OF 4	050703	1	1	000		
DECAL-DEC-TAYLOR 380*RD30	045967	1	1	000		
DECAL-POWER SWITCH-SYMBOLS	046089	1	1	000		
DECAL-TROUBLESHOOTING	038374	1	1	000		
DIAGRAM-WIRING *383-384*	051948-	1	1	000		
DOOR A.-PARTIAL *382*	X51098	1	1	103		
+O-RING-8-3/8 ODX.105W	027814	1	1	000	GASKET	
+KNOB-DRAW VALVE-BLACK PLASTIC	047358	1	1	103		
+PLATE-DRAW SPOUT MOUNTING	049275	1	1	103		
+SCREW-1/4-20X9/16 THUMB-300	047632	2	2	103		
+PLUG-PRIME *380/1*	046833	1	1	103		
+O-RING-9/32 OD X 1/16 WALL	029751	1	1	000		
+SPOUT-DOOR ZERO WASTE	049276-BLA	1	1	103		
+O-RING-2.375 OD X 1/16W	046830	1	1	000		
+SPRING-COMP.845X.055X3.5-SS	047357	1	1	103		
+VALVE-DRAW *380/1*ZERO WASTE	047353	1	1	103		
+O-RING-7/8 OD X .103W	014402	1	1	000		
DRYER-FILTER 3/8 X 1/4 SOLDER	045866		1	000		
DRYER-FILTER-HP62-3/8 X 1/4S	048901	1		000		
GASKET-BASE PAN *382-384*	051868	1	1	000		
KIT A.-TUNE UP *382*	X51255	1	1	000		
BEARING-FRONT-TORQUE*382-384	052005	1	1	000		
BEARING-GUIDE	014496	1	1	000		
O-RING-.291 ID X .080W	018550	1	1	000	TORQUE ASSEMBLY	
O-RING-2.375 OD X 1/16W	046830	1	1	000	DOOR SPOUT	
O-RING-7/8 OD X .103W	014402	2	2	000	DRAW VALVE	
O-RING-8-3/8 ODX.105W	027814	1	1	000	DOOR GASKET	

DESCRIPTION	PART NUMBER	QTY. 383	QTY. 384	WARR. CLASS	REMARKS	PARTS UPDATE
O-RING-9/32 OD X 1/16 WALL	029751	1	1	000	PRIME PLUG	
O-RING-7/8 O.D. X .139W	025307	1	1	000	DRIVE SHAFT	
SEAL-DRIVE SHAFT	032560	1	1	000		
LABEL-DOOR CAUTION	032749	1	1	000		
LABEL-SWITCH-POWER-INT'L SYM	046089-BLA	1	1	000		
LABEL-WARN-ELEC-SGL-ENG/SPN	024313	2	2	000		
LABEL-WARN-MOVING PARTS-ENG/SP	024315	3	3	000		
LABEL-WARNING-COVER	051433	5	5	000		
LABEL-WARNING-PANEL-MOVE PARTS	036529	3	3	000		
LENS-LIGHT *382-384*	051129	1	1	103		
+BRACKET-LIGHT *382-384*	051870	1	1	103		
LIGHT A.-ADD MIX-AMBER	X47218-	1	1	103		129
LIGHT-AMBER-RECTANGULAR-250VAC	047141-	1	1	103	*ADD MIX*	
TERMINALS	026962	2	2	000		
LIGHT-AMBER-RECT-MIX OUT	050036-	1	1	103	*MIX LOW*	
LUBRICANT-TAYLOR HI PERF-4 OZ	048232	1	1	000		
MAN-OPER 383/384	053083-M	1	1	000		
MOTOR-1/2 HP	024839-	1	1	212		
MOTOR-FAN 35W-40"LEADS	027817-	1	1	103		
+FAN-5 BLADE 11 " PUSH 24DEG CW	035966	1	1	103		
NUT-STUD *380*RD30*	045644	4	4	103	HANDSCREWS	
PAN-DRIP *380/1*	046852	1	1	103		
+TUBE-VINYL 3/8 ID X 9/16 OD	020943-30	1	1	000	DRAIN	
PANEL A.-FRONT *382*	X51097	1	1	103		
PANEL A.-REAR*383-384*	X52116	1	1	103	INCLUDES 2-021106 NUTSERTS	
PANEL-SIDE *382-3-4*RIGHT	051713	1	1	103		
+CLIP-SPRING-SIDE PANEL	050877	2	2	103		
PANEL-SIDE LEFT	052117	1	1	103		
+CLIP-SPRING-SIDE PANEL	050877	2	2	103		
PCB A.-DUAL MIX LV/CONT. FILL	X41420-SER	1	1	212		
PROBE A.-MIX *SQUARE*	X30922	1	1	103		
PROBE A.-MIX OUT-SQUARE HOLE	X41348	1	1	103		
PULLEY-10J- 1.125PD-5/8BORE	028857	1	1	103		

DESCRIPTION	PART NUMBER	QTY. 383	QTY. 384	WARR. CLASS	REMARKS	PARTS UPDATE
PULLEY-10J-11"PD-5/8BORE	025570	1	1	103		
RELAY-3 POLE-20A-208/240 50/60	012725-	1	1	103		
RELAY-DPDT-20 A-230 V	026581-	1	1	103		
SANITIZER KAY-5 125 PACKETS	041082	1	1	000		
SHAFT-BEATER W/BAFFLE GUIDE	049270	1	1	103	ADDED GROOVE - 7/15/98	133
+O-RING 7/8 O.D. X .139W	025307	1	1	000		133
+SEAL-DRIVE SHAFT	032560	1	1	000		
SHELF-DRIP TRAY*382-384*	052065	1	1	103		
SHELL A.-INSULATED *382*TORQ	X51112	1	1	512		
+STUD-FREEZER DOOR *383-384*	051950	4	4	103		
SHIELD-SPLASH *380/1*	046851	1	1	103		
SWITCH A.-TORQUE *382*	X51100	1	1	103		
ARM-SWITCH-TORQUE *382*	051101	1	1	103		
BRACKET-TORQUE CONTROL *382*	051086	1	1	103		
BUSHING A.-TORQUE	X50399	1	1	103		
BUSHING-ARM-TORQUE	049737	1	1	103		
BUSHING-PIVOT-TORQUE ARM	049739	1	1	103		
SPRING-TORQUE*BLACK*	015007	1	1	103		
SWITCH-LEVER-SPDT-20A-125-48	027026	1	1	103		
SWITCH-PRESSURE 350 PSI-SOLDER	048231	1	1	103	W/C	
SWITCH-PRESSURE 440 PSI-SOLDER	048230	1	1	103	A/C	
SWITCH-PUSHBUTTON-SPST	016530	1	1	103		
SWITCH-TOGGLE-DPDT*ON-OFF-ON	014464	1	1	103		
+BOOT-TOGGLE SWITCH	043398	1	1	000		
TORQUE A. *382*	X51081	1	1	103		
O-RING-TORQUE	018550	1	1	000		
TRAY A.-DRIP *380*	X46848	1	1	103		
TUBE A.-FILL *340*CONT. FILL	X43081	1	1	103	FRONT PANEL DRAIN	
+WASHER-FILL TUBE .531"IDX/780D	043135	1	1	103		
TUBE-CAPILLARY .021ID X 9 FT	020059	1	1	103		
VALVE-ACCESS 1/4 X 3/8 SOLDER	029406	2	2	103		
VALVE-ACCESS 1/4FL X 1/4SOLD	044404	1	1	103		
VALVE-ACCESS 1/4FL X 3/8SDR-90	044455	1	1	103		

DESCRIPTION	PART NUMBER	QTY. 383	QTY. 384	WARR. CLASS	REMARKS	PARTS UPDATE
VALVE-ACCESS-1/4 MFLX1/4 S-90	047016	1	1	103		
VALVE-EPR 1/4S	022665	1	1	103		
VALVE-EXP-THERMO-1/4S X 1/4F	051578	1	1	103		
+BOOT-EXPANSION VALVE	050900	1	1	000		
VALVE-WATER 3/8 REG/HEAD PRESS	046686		1	103		
CONTINUOUS FILL						
DIAGRAM-WIRING *383-4*CONT.FIL	051949-	1	1	000		
LABEL-SWITCH-OFF/FILL-INTL SYM	051971-BLA	1	1	000		
PROBE A.-MIX LOW-HOPPER	X51804	1	1	103		
RELAY-DPDT-20 A-230 V	026581-27		3	103	208-240/60/1	
RESISTOR A.-DELAY TIMER*383-4*	X52008-	1	1	103		
SHELL A.-INS.*383-384*TORQUE	X51112-SP	1	1	512		
SWITCH-TOGGLE-DPST	075772	1	1	103		
TIMER A.-DELAY ON MAKE-2 MIN.	X49541-	1	1	103		
TUBE A.-FILL *340*CONT. FILL	X43081	1	1	103		
VALVE A.-SOLENOID*383-384*C/F	X52011-	1	1	103		
ADAPTOR-1/4MPT X 1/4BARB-NYL	021630	1	1	103		
CLAMP-HOSE	010031	1	1	000		
ARMAFLEX-5/8 ID X 3/8WALL	032650-16	1	1	000		
ELBOW-1/4MP X 3/8BARB-PLASTIC	016487	1	1	000		
HOSE-BEVERAGE-3/8 ID X 5/8 O	020565-16	1	1	000		
VALVE-SOLENOID SYRUP	051396-	1	1	103		
VARISTOR A.-130VAC	X49300	1		103	115/60/1	
VARISTOR A.-280VAC	X34664	1	1	103	208-240/60/1	
GENERIC DECALS						
PANEL A.-FRONT *382-384*	X51097-GEN	1	1	103		
PANEL-SIDE *382-384*RIGHT	051713-GEN	1	1	103		
PANEL-SIDE L.*382-384*GENERIC	052117-GEN	1	1	103		

DESCRIPTION	PART NUMBER	QTY. 383	QTY. 384	WARR. CLASS	REMARKS	PARTS UPDATE
WATER COOLED						
CONDENSER-WC-COAX	048287	1	1	103		
HOSE-RUBBER 1/2"ID X 7/8"OD	R50200	4Ft	4Ft	000		
RECEIVER A. *383*WC*HP62*	X51452	1	1	103		
SWITCH-PRESSURE 350 PSI-SOLDER	048231	1	1	103		
VALVE-WATER 3/8 REG/HEAD PRESS	046686	1	1	103		
(384 is available as a water cooled unit only)						
50 Hz						
COMPRESSOR AKA9462ZXC-AK172JT	049302-40	1		512	220-240/50/1	
+CAPACITOR-RUN- 15UF/370V	027087	1		103		
+CAPACITOR-START- 72-88UF/330V	039567	1		103		
+RELAY-START-COMPRESSOR	041064	1		103		
COMPRESSOR M51B143BBKA	036880-34		1	512	220-240/50/1	
+CAPACITOR-RUN- 20UF/440V	012906		1	103		
+CAPACITOR-START-124-149UF/250V	047069		1	103		
+RELAY-START-COMPRESSOR	038146		1	103		
DIAGRAM-WIRING *383-384*	051948-40	1	1	000		
MOTOR-1/2 HP	024839-34	1	1	212		
MOTOR-FAN 23.2 WATT	027817-34	1	1	103		

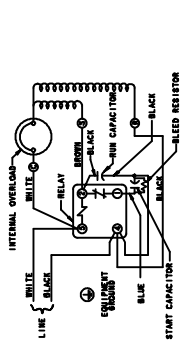

FIG. 1
TECUMSEH COMPRESSOR WIRING

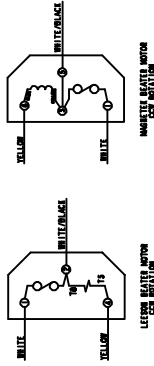
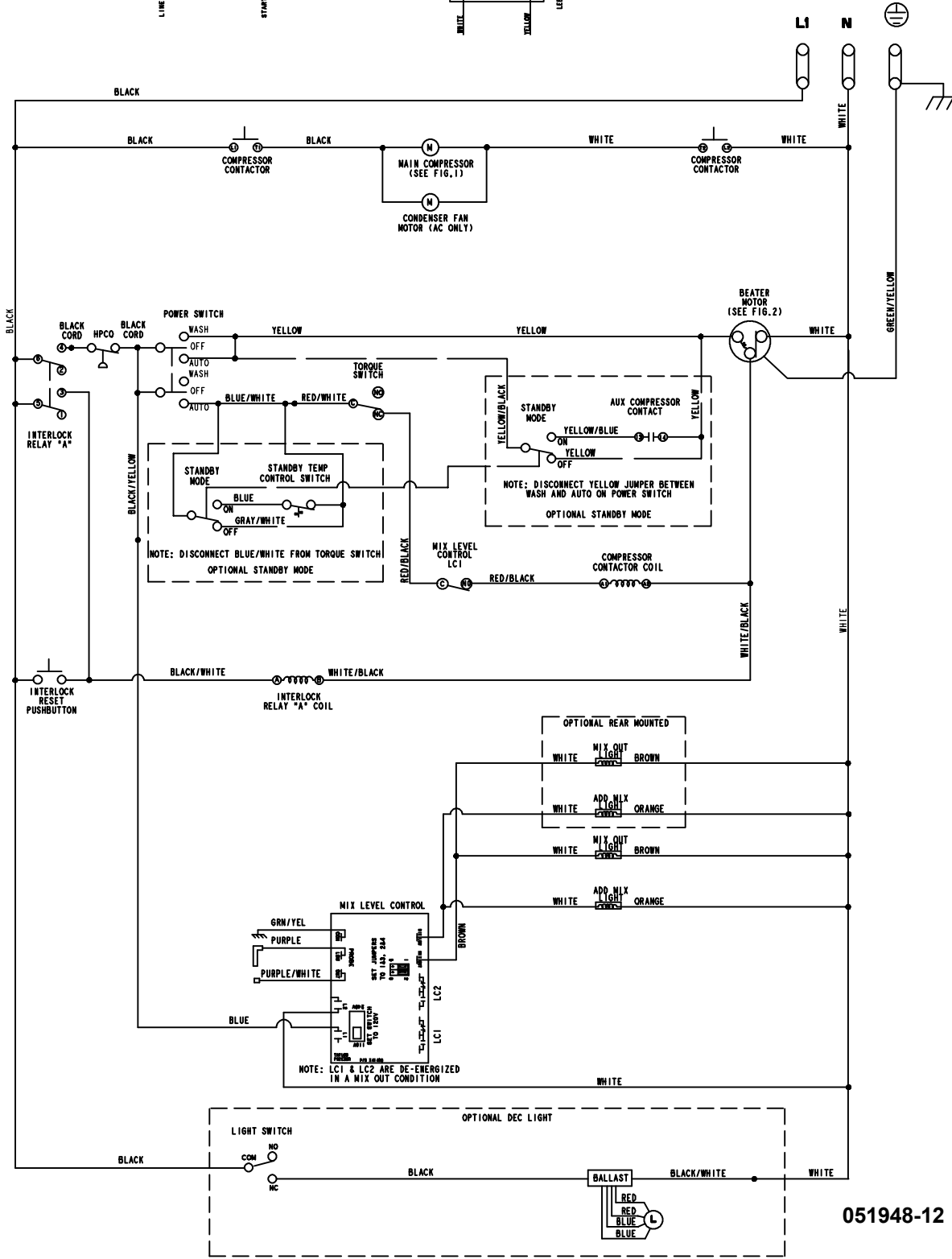

FIG. 2



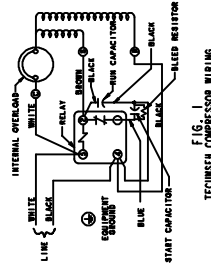

FIG. 1
TECUMSEH COMPRESSOR WIRING

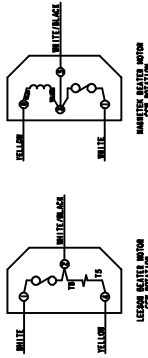
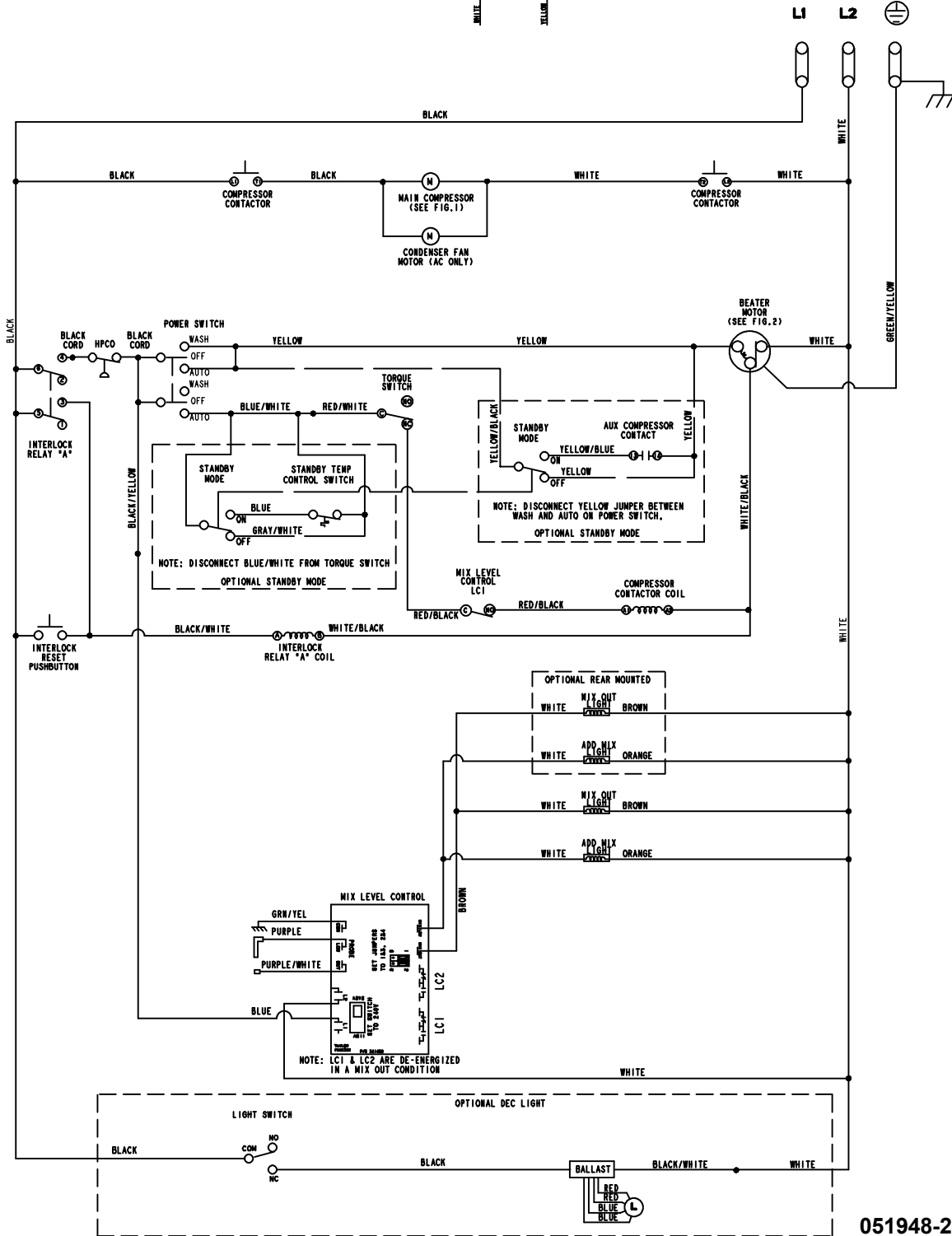

FIG. 2



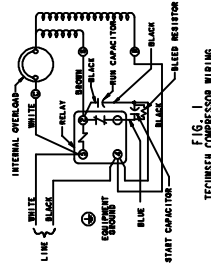

FIG. 1
TECUMSEH COMPRESSOR WIRING

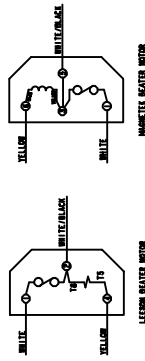

FIG. 2

