

M-K ENGINEERING, INC.  
 CONSULTING ENGINEERS  
 HVAC-PLUMBING-FIRE PROTECTION-ELECTRICAL  
 4323 DIVISION STREET, SUITE 211  
 METAIRIE, LOUISIANA 70002  
 TEL. (504)887-2376, FAX(504) 887-2302

REVISIONS	BY

**ELECTRICAL NOTES:**

1. PROVIDE NEW LIGHTING FIXTURES IN NEW ATTIC SPACE (EXISTING ROOF). THE FIXTURES SHALL BE SUPPORTED FROM NEW METAL ROOF STRUCTURE. LOCATE THE FIXTURES IN CENTER OF METAL ROOF. THE NEW LIGHT FIXTURES SHALL BE CONNECTED TO EXISTING PANELS ON ROOF AS INDICATED.
2. PROVIDE TWO SWITCHES, ONE FOR AREAS "A" AND "B" AND OTHER ONE FOR AREAS "C" AND "D".
3. CONTRACTOR SHALL VERIFY THE EXACT LOCATION OF EXISTING PANELS FOR NEW CIRCUITS.

LIGHTING FIXTURE SCHEDULE							
TYPE	MANUFACTURER	CATALOG NO.	LAMPS		VOLTS	MOUNTING	REMARKS
			NO.	WATTS			
FI	LITHONIA	C24852120	1	32	F032TB	120	SURFACE

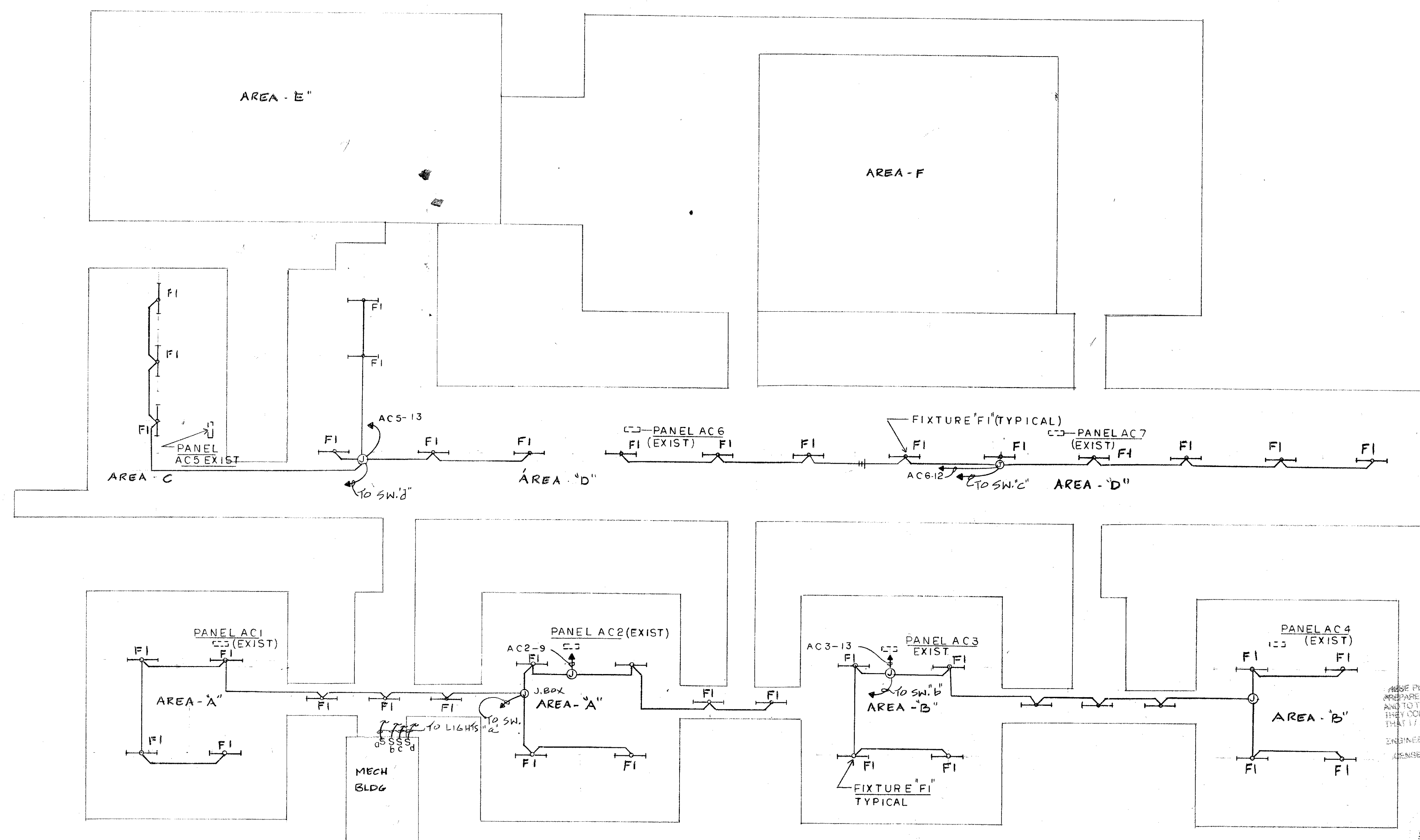

THESE PLANS AND SPECIFICATIONS HAVE BEEN PREPARED BY OR UNDER MY CLOSE SUPERVISION AND TO THE BEST OF MY KNOWLEDGE AND BELIEF THEY COMPLY WITH ALL CITY REQUIREMENTS AND THAT I AM NOT PROVIDING THE SERVICE OF AN ENGINEER.  
 ENGINEER: *Richard C. Johnson*  
 LICENSE NO. 22634

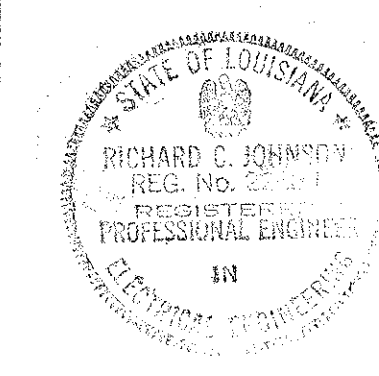

**ROOF PLAN- LIGHTING**  
 SCALE: 1"=20'-0"

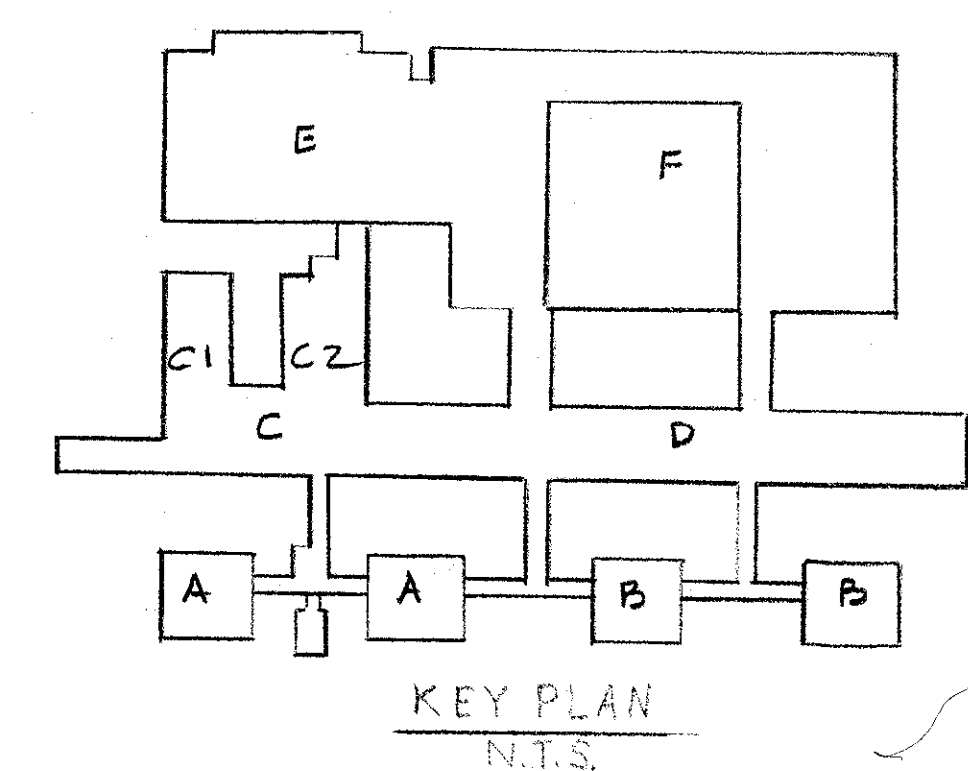

CONSULTANT  
 BYRON J. STEWART & ASSOC.  
 ARCHITECTS & PLANNERS  
 2300 MARENGO ST.  
 NEW ORLEANS, LA. 70115  
 (504) 897-5339

CLIENT  
 NEW ORLEANS PARISH  
 SCHOOL BOARD  
 4300 ALMONASTER AVE  
 NEW ORLEANS, LA.

PROJECT  
 CARTER G. WOODSON MIDDLE SCHOOL  
 RE-ROOFING & MECHANICAL REPAIRS

DRAWN	SJR
CHECKED	RJ
DATE	4-21-97
SCALE	AS NOTED
JOB NO.	
SHEET	E-1
OF	2 SHEETS