

ELECTRICAL NOTES

- ALL WORK SHALL CONFORM TO THE LATEST EDITION OF THE NATIONAL ELECTRICAL CODE, THE GOVERNING ELECTRICAL CODE AND ALL OTHER INSPECTION DEPARTMENTS HAVING JURISDICTION. OBTAIN CERTIFICATES OR APPROVAL WHERE REQUIRED.
- ALL MATERIALS FURNISHED SHALL BE NEW AND SHALL BE U.L. LISTED.
- THE DRAWINGS INDICATE SIZE AND GENERAL LOCATION OF WORK. SCALE DIMENSIONS SHALL NOT BE USED. THE EXACT LOCATION AND LOCATION OF ALL LIGHTING FIXTURES, RECEPTACLES AND TELEPHONE OUTLETS, ETC. SHALL BE DETERMINED BY ACTUAL CONDITIONS IN THE FIELD.
- PRIOR TO BIDDING, CONTRACTOR SHALL VISIT THE JOB SITE AND FAMILIARIZE THEMSELVES WITH THE EXISTING CONDITIONS.
- ELECTRICAL CONTRACTOR SHALL COORDINATE HIS WORK WITH OTHER TRADES AND WITH OTHER CONTRACTORS WHOSE WORK MAY AFFECT THIS INSTALLATION.
- ELECTRICAL CONTRACTOR SHALL COORDINATE INCOMING ELECTRICAL SERVICE WITH UTILITY COMPANY AND INCLUDE IN HIS BID ALL CHARGES AND FEES INCURRED IN MODIFICATIONS.
- WHERE MORE THAN ONE SWITCH OCCURS IN THE SAME LOCATION, THEY SHALL BE INSTALLED IN A GANG TYPE BOX UNDER ONE COVER PLATE.
- ELECTRICAL CONTRACTOR SHALL COORDINATE THE TELEPHONE INSTALLATION WITH THE TELEPHONE COMPANY AND THE GENERAL CONTRACTOR.
- ELECTRICAL CONTRACTOR, BEFORE INSTALLING ANY OF THE WORK, SHALL SEE THAT IT DOES NOT INTERFERE WITH CLEARANCES REQUIRED FOR FINISHED COLUMNS, HUNG CEILINGS, PLASTER, PARTITIONS, WALLS, ETC. AS SHOWN IN THE ARCHITECTURAL DRAWINGS AND DETAILS. IF ANY WORK IS INSTALLED AND IT LATER DEVELOPS THAT SUCH DETAILS OR DESIGN CANNOT BE FOLLOWED, THE CONTRACTOR, AT HIS OWN EXPENSE, SHALL MAKE SUCH CHANGES IN THE WORK AS DIRECTED BY THE ARCHITECT, AS WELL AS TO PERMIT THE INSTALLATION OF THE ARCHITECTURAL WORK AS SHOWN ON THE PLANS AND DETAILS.
- PERFORM TEST REQUIRED BY THE OWNER OR THE ENGINEER IN CONNECTION WITH THE OPERATION OF THE ELECTRICAL SYSTEM IN THE BUILDING.
- ALL TESTS SHALL BE MADE IN ACCORDANCE WITH THE LATEST STANDARD OF THE IEEE AND THE NATIONAL ELECTRICAL CODE.
- MINIMUM CONDUCTOR SIZE SHALL BE #12, 600V INSULATION PER ARTICLE 300.22B; DUCTS SPECIFICALLY FABRICATED FOR ENVIRONMENTAL AIR. MINIMUM SIZE CONDUIT SHALL BE 3/4" EMT FOR INTERIOR USE, AND 3/4" RIGID ALUMINUM FOR EXTERIOR USE. USE TYPE NMC CABLE COPPER, FOR LIGHTS AND RECEPTACLE CIRCUITS. EXTERIOR FITTINGS SHALL BE CAST BOXES AND COVERS. INTERIOR FITTINGS SHALL BE CAST WHERE EXPOSED ON WALLS.
- CONTRACTOR SHALL INSTALL WIRING AND OTHER CIRCUIT COMPONENTS TO MATCH EQUIPMENT ACTUALLY INSTALLED.
- INSTALL GROUND FAULT RECEPTACLES AT RECEPTACLE LOCATIONS WITHIN 5' OF SINKS OR LAVATORIES, AND AT EXTERIOR LOCATIONS. EXTERIOR RECEPTACLES SHALL ALSO BE WATERPROOF.
- BONDING AND GROUNDING SHALL BE IN ACCORDANCE WITH NFPA 70:230-63, NFPA 250-23, 250-71, & 250-72.
- GROUND NEUTRAL IN ACCORDANCE WITH NFPA 70:250-23b.
- FUSES SHALL BE ITT CLASS K5, 250 VOLT, 200,000 AMP INTER-RUPTING CAP.
- PROVIDE SERVICES OF A FIRE/SMOKE DETECTION AND ALARM COMPANY TO DESIGN AND INSTALL ALARM SYSTEM TO THE REQUIREMENTS OF THE STATE FIRE MARSHAL.
- ALL ELECTRICAL, MECHANICAL, AND PLUMBING PENETRATING FIRE PARTITIONS SHALL BE FIRE CAULKED. (PENETRATIONS THROUGH RATED CONSTRUCTION SHALL BE SEALED WITH A MATERIAL CAPABLE OF PREVENTING THE PASSAGE OF FLAMES AND HOT GASES WHEN TESTED IN ACCORDANCE WITH ASTM-E814.)

LIGHTING FIXTURE SCHEDULE

SYMBOL	DESCRIPTION	MANUFACTURER PRODUCT #	LAMPS
□	2x2' RECESSED FLOURESCENT W/ HIGH PERFORMANCE LOUVER	LIGHTOLIER GOS2G217277 WITH 32W BALLAST	2 EA- 1x8 17W FLOURESCENT 277V
●	6" RECESSED FLOURESCENT DOWNLIGHT - CALCULITE SERIES	LIGHTOLIER 8051CLP WITH 13W BALLAST	2 EA- 1x8 QUAD TUBE FLOURESCENT 277V
⊕	EMERGENCY EGRES: LIGHT W/ 90 MIN. BATTERY BACKUP	EELP LIGHTING EM1	2-5.4W HALOGEN
⊕	WALL MOUNTED LED EXIT SIGN	EELP LIGHTING XE 2 R W EM	LED
⊕	WALL MOUNTED LED EXIT SIGN WITH DIRECTIONAL ARROW		LED
⊕	HORN / STROBE EMERGENCY CONNECT TO EXISTING FIRE ALARM	(BY OTHERS)	
⊕	OCCUSWITCH CLASSIC CLG MOUNT SENSOR W/ ZONE #	PHILIPS LRM2255 WITH LCA SERIES POWER PACK	
⊕	OCCUSWITCH CLASSIC WALL MOUNT SENSOR	PHILIPS LRS2220	
⊕	SWITCH (THREE-WAY) 20 AMP 277	EQUAL	
⊕	SWITCH 20 AMP 277	EQUAL	

NOTES:
1. CONNECT ALL EMERGENCY / EXIT LIGHT FIXTURES TO NEAREST CONSTANT POWER SOURCE.

NEW PANEL: HV-1
LOCATION: WAREHOUSE WALL
FEEDER SOURCE: ENTERGY

VOLTAGE: 480/277V, ---A 3Ø, 4W MLO LOAD CENTER
ENCLOSURE: RECESSED W/EQUIPMENT GND BAR
WITH BOLT-ON BREAKERS: 22,000 AIC

CKT. NO.	THHN WIRE SIZE	LOAD DESCRIPTION	BREAKER		LOAD (VA)	WIRING		LOAD (VA)	BREAKER		LOAD DESCRIPTION	THHN WIRE SIZE	CKT. NO.
			AMP	POLE		AØ	BØ		AMP	POLE			
1													2
3													4
5													6
7													8
9													10
11													12
13													14
15													16
17													18
19													20
21													22
23													24
25													26
27													28
29													30
31													32
33													34
35													36
37													38
39													40
41		SPARE											42

TOTAL CONNECTED LOAD (VA) = ----

SOLID NEUTRAL NEUTRAL WIRE (W)
AØ = --- BØ = --- CØ = ---

GROUND BUS GROUND WIRE (G)

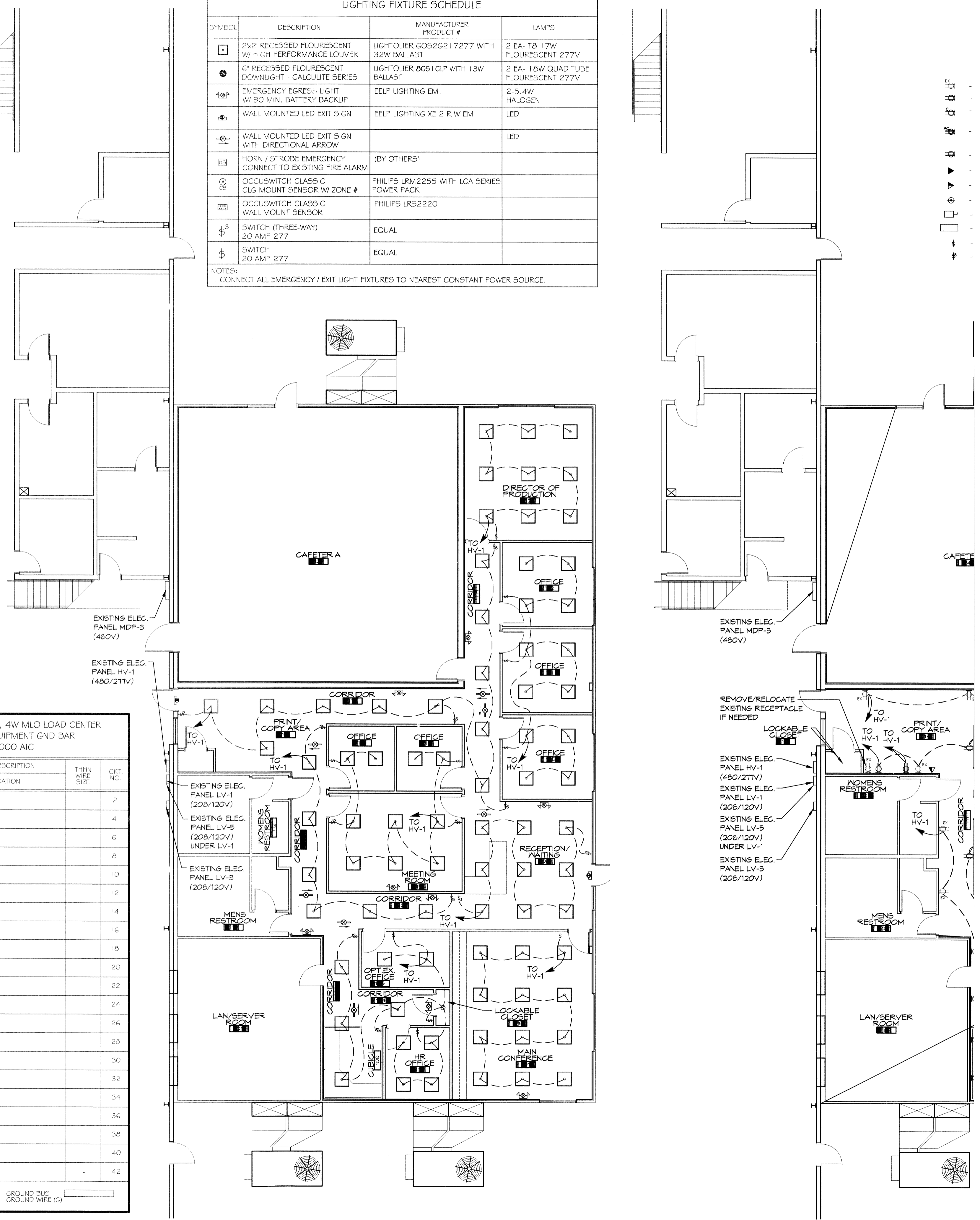

2 ELECTRICAL LIGHTING PLAN
SCALE: 1/8" = 1'-0"

1 ELECTRICAL LIGHTING PLAN
SCALE: 1/8" = 1'-0"