

ALTERNATE NO. 1

IF ALTERNATE NO. 1 NOT ACCEPTED, CONTRACTOR SHALL TERMINATE PIPING THIS LOCATION AND INSTALL LOOP WITH BLIND FLANGES AS NOTED AT END OF RUN. IF ALTERNATE NO. 1 ACCEPTED THESE VALVES AND BLIND FLANGES NOT REQUIRED AND CONTRACTOR TO EXTEND PIPING AS SHOWN WITH ALL REQUIRED VALVES AND FITTINGS AS NOTED AT END OF RUN.

**1 PARTIAL 1st FLOOR PLAN - MECHANICAL PIPING**  
Scale: 3/32" = 1'-0"

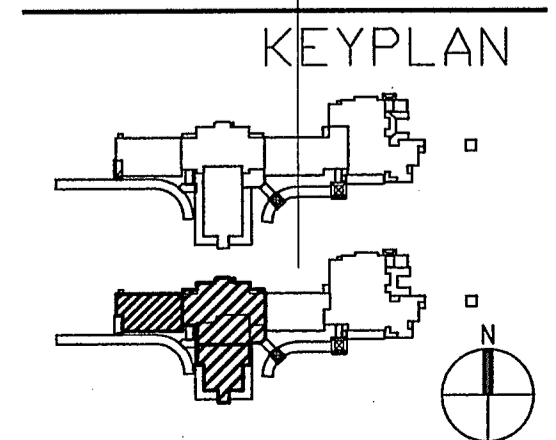

**JOSEPH B. LANCASTER**  
**ELEMENTARY SCHOOL**  
 ST. TAMMANY PARISH SCHOOL BOARD  
 MADISONVILLE, LOUISIANA  
 STPSB PROJECT #0825

**GGB**  
 Gasaway | Gasaway | Bankston  
 Architects + Planners  
 1007 W. THOMAS ST., SUITE G  
 HAMMOND, LA 70401  
 985.345.5047  
 985.345.5040

ANDREW GASAWAY, JR., ARCHITECT, AIA, APA  
 BRET GASAWAY, ARCHITECT, AIA, NCARB  
 CHRIS BANKSTON, ARCHITECT, AIA, NCARB, LEED AP

PROJ. NO.	0825
DATE	06.25.09
REVISED	
REVISION	

THIS DRAWING IS AN INSTRUMENT OF SERVICE, IS AND SHALL REMAIN THE PROPERTY OF THE ARCHITECT AND SHALL NOT BE REPRODUCED, PUBLISHED OR USED IN ANY WAY WITHOUT THE EXPRESS PERMISSION OF THE ARCHITECT.

© GASAWAY | GASAWAY | BANKSTON - ARCHITECTS & PLANNERS  
 PROFESSIONAL OF RECORD

STATE OF LOUISIANA  
 HENRY EYRE, JR.  
 No. 06802  
 PROFESSIONAL ENGINEER  
 MECHANICAL ENGINEERING

**M201**