

1-1/2" CWS/R DN TO AHU-6  
 SPRINKLER RISERS  
 8" CWS/R LINES UP FROM UNDERGROUND, PROVIDE ALUMINUM JACKET (WITH LABELS) ON EXPOSED CHILLED WATER PIPING IN RISER ROOM #1529.  
 CONTRACTOR SHALL COORDINATE INSTALLATION OF CHILLED WATER PIPING WITH SPRINKLER PIPING.  
 THRUST BLOCK, TYPICAL ALL TURNS AND FITTINGS, REFER TO TYPICAL DETAIL NO. 11, SHEET M604

4" CWS/R LINES UP THRU FLOOR, SEAL W/ FIRE RATED CAULKING

2-1/2" CWS/R LINES UP FROM UNDERGROUND

THRUST BLOCK, TYPICAL ALL TURNS AND FITTINGS, REFER TO TYPICAL DETAIL NO. 11, SHEET M604

REFER TO ENLARGED PLAN, DETAIL NO. 1, SHEET M205

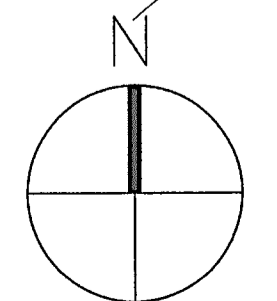

1

**PARTIAL 1st FLOOR PLAN - MECHANICAL PIPING**

Scale: 3/32"=1'-0"

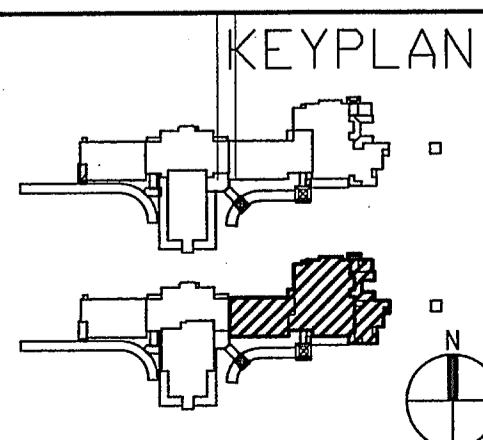

ANDREW GASAWAY, JR., ARCHITECT, AIA, APA  
 BRET GASAWAY, ARCHITECT, AIA, NCARB  
 CHRIS BANKSTON, ARCHITECT, AIA, NCARB, LEED AP

**GGB**  
 Gasaway | Gasaway | Bankston  
 Architects + Planners  
 1007 W. THOMAS ST., SUITE G  
 HAMMOND, LA 70401  
 985.345.5047  
 985.345.5040

**JOSEPH B. LANCASTER  
 ELEMENTARY SCHOOL**  
 ST. TAMMANY PARISH SCHOOL BOARD  
 MADISONVILLE, LOUISIANA  
 STPSB PROJECT #0825

THIS DRAWING IS AN INSTRUMENT OF SERVICE, IT AND SHALL REMAIN THE PROPERTY OF THE ARCHITECT AND SHALL NOT BE REPRODUCED, PUBLISHED OR USED IN ANY WAY WITHOUT THE EXPRESS PERMISSION OF THE ARCHITECT.

PROJ. NO.	0825
DATE	06.25.09
REVISED	

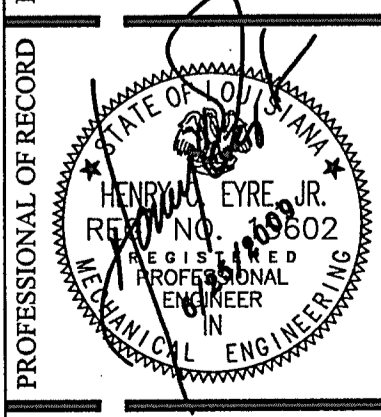

**M202**