

IF ALTERNATE NO. 1 NOT ACCEPTED, CONTRACTOR SHALL TERMINATE PIPING THIS LOCATION AND INSTALL BLIND FLANGES AS NOTED AT END OF RUN, IF ALTERNATE NO. 1 ACCEPTED BLIND FLANGES NOT REQUIRED AND CONTRACTOR TO EXTEND PIPING AS SHOWN.

GENERAL SPRINKLER NOTES:

- A. SPRINKLER CONTRACTOR SHALL HYDRAULICALLY CALCULATE AND DESIGN THE SPRINKLER SYSTEM TO CONFORM TO INSURANCE COMPANY REQUIREMENTS, STATE FIRE MARITAL NFPA 13 ALL APPLICABLE CODES. THE SYSTEM SHALL BE (4) DRY PIPE SYSTEMS AND SHALL BE ARRANGED AS NOT BE ARRANGED AS NOT TO INTERFERE WITH LIGHTS AND CEILING PLATES AND SHALL NOT BE IN CONTACT WITH ANY PART OF THE CEILING SUPPORTS. ALL PIPING SIZING AND SPACING SHALL BE IN STRICT ACCORDANCE WITH NFPA REQUIREMENTS.
- B. ALL SPRINKLER HEADS SHALL BE LOCATED IN THE CENTER OF CEILING TILES WHERE APPLICABLE. ANY RELOCATION OF HEADS SHALL BE AT CONTRACTORS EXPENSE IN ORDER TO CENTER HEADS IN TILE. SPRINKLER HEAD LAYOUT IS A GUIDE ONLY. CONTRACTOR SHALL ADD OR DELETE HEADS AS REQUIRED TO MEET ALL REQUIREMENTS OF NFPA 13.
- C. THE FIRE PROTECTION CONTRACTOR SHALL COORDINATE WITH HVAC, PLUMBING, ELECTRICAL, STRUCTURAL MEMBERS, ETC. AS REQUIRED FOR A PROPER INSTALLATION.
- D. PROVIDE INSPECTOR'S TEST TEE AT ALL POINTS REQUIRED IN SYSTEM.
- E. FIRE PROTECTION CONTRACTOR SHALL SEAL AROUND ALL PENETRATIONS OF FIRE AND SMOKE PARTITIONS, FLOORS, ETC. BY ALL SPRINKLER PIPING, CONTROL WIRING ECT. WITH FIRE RESISTANT MATERIAL.
- F. PROVIDE THRUST BLOCKS AT ALL UNDERGROUND TURNS OF SPRINKLER PIPING, RE: TYPICAL DETAIL.
- G. CONTRACTOR TO REFER TO ARCHITECT DRAWINGS FOR DIFFERENT CEILING HEIGHT, COORDINATE AND PROVIDE ALL OFFSETS.
- H. CONTRACTOR TO PLACE SPRINKLER HEADS IN ALL FURRINGS WHERE THE UNDERSIDE WILL NOT BE COVERED BY OTHER SPRINKLER HEADS TO INSURE ADEQUATE COVERAGE OF ALL AREAS. CONTRACTOR TO REFER TO ARCHITECTURAL DRAWINGS FOR FURRING LOCATIONS.
- I. DUE TO THE COMPLEXITY OF THE CEILING HEIGHTS, CONTRACTOR SHALL REFER TO ARCH. DRAWINGS IN ROUTING OF MAIN SPRINKLER PIPING. CONTRACTOR SHALL ALSO PROVIDE FOR MULTIPLE DRAIN LOCATIONS DUE TO THE VARYING CEILING HEIGHTS. NO ADDITIONAL COMPENSATION TO BE ALLOWED FOR CONTRACTOR NOT REFERRING TO ARCH. DRAWINGS REGARDING THIS MATTER.
- J. ALL SPRINKLER HEADS ARE TO BE CONCEALED TYPE. PROVIDE CUT SHEET TO ARCHITECT PRIOR TO CONSTRUCTION FOR AESTHETIC APPROVAL, NO EXCEPTION.

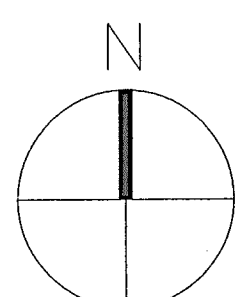
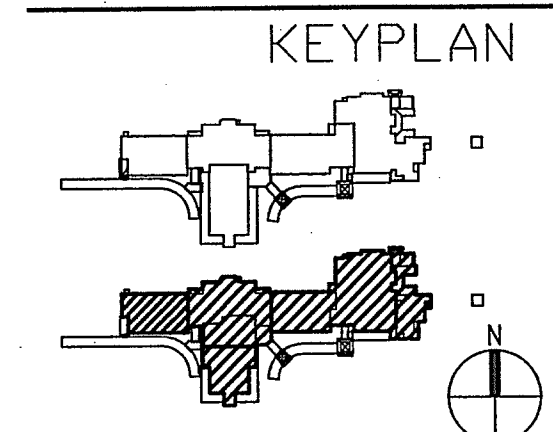

1 1st FLOOR PLAN - SPRINKLER
Scale: 1"=20'-0"

ANDREW GASAWAY, JR., ARCHITECT, AIA, APA
BRETT GASAWAY, ARCHITECT, AIA, NCARB
CHRIS BANKSTON, ARCHITECT, AIA, NCARB, LEED AP

GGB
Gasaway | Gasaway | Bankston
Architects + Planners
1007 W. THOMAS ST., SUITE 6
HAMMOND, LA 70401
985.345.5047
985.345.5000

JOSEPH B. LANCASTER
ELEMENTARY SCHOOL
ST. TAMMANY PARISH SCHOOL BOARD
MADISONVILLE, LOUISIANA
SPSB PROJECT #0825

THIS DRAWING IS AN INSTRUMENT OF SERVICE, IS AND SHALL REMAIN THE PROPERTY OF THE ARCHITECT AND SHALL NOT BE REPRODUCED, PUBLISHED OR USED IN ANY WAY WITHOUT THE EXPRESS PERMISSION OF THE ARCHITECT.

PROJ. NO.	0825
DATE	06.25.09
REVISED	

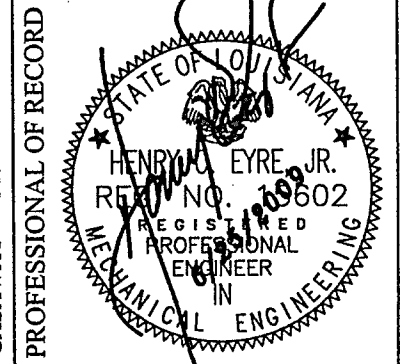

SP101