

NOTE:
THIS ELECTRICAL PLAN IS TYPICAL FOR ALL RENTAL UNITS, IN BUILDINGS 1-6. SEE SITE PLAN FOR BUILDING LOCATIONS. (SHEET C-1)

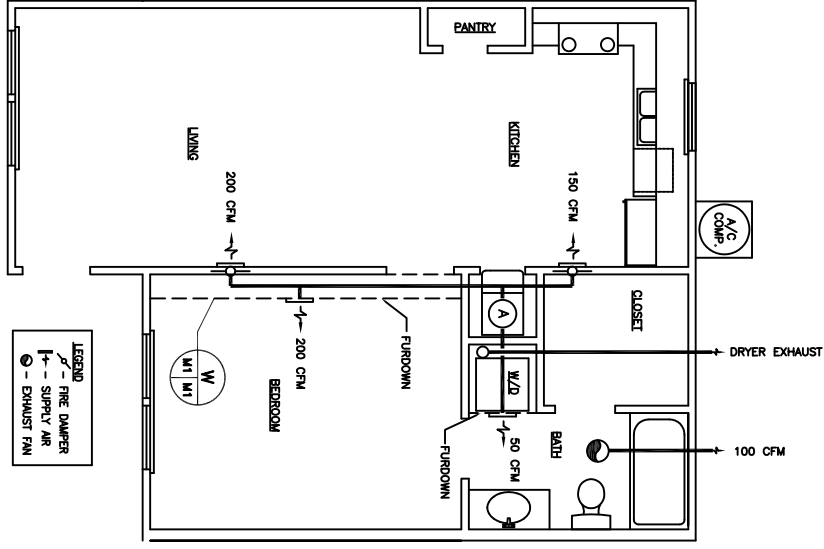

MECHANICAL PLAN
SCALE: N.T.S.

- IMC NOTES**
1. CONCEALED DUCTWORK TO BE UL-181, CLASS 1 FIBERGLASS DUCTBOARD. DUCTS SHALL BE SIZED TO LIMIT MAIN DUCTS TO 1000 CFM & SECONDARY DUCTS TO 600 CFM. TO BE INSTALLED PER SMCA STANDARDS. SMCA STANDARDS FOR FIBERGLASS DUCTWORK SHALL BE USED FOR ALL DUCTWORK. ALL DUCTWORK SHALL BE LINED WITH INSULATION. INSULATION SHALL BE 1.5 POUNDS PER CUBIC FOOT INSULATION. ROUND FLEXIBLE DUCT TO BE UL-181, CLASS 1 AIR DUCT MATERIALS.
 2. PROVIDE UL LISTED 125°F FIRESTOP IN RETURN AIR OF EACH SYSTEM UNDER 2000 CFM TO SHUT DOWN FAN IN THE EVENT OF FIRE AT ALL DUCT PENETRATIONS OF FIRE-RESISTANT SEPARATORS AND WHERE REQUIRED BY LOCAL AND/OR OUTSIDE AIR INLETS. CONDENSATE DRAINS TO BE PVC PIPE RUN TO PLUMBER'S P-TRAP WITHIN FIVE FEET OF AIR HANDLING UNITS.
 3. ALL SUPPLY AIR VENTS SHALL BE EQUIPPED WITH AIR CONTROL DAMPERS. CONTRACTOR SHALL PROVIDE DOWNCOMERS SHALL BE MARKED FROM EACH CONDENSING UNIT.
 4. REFRIGERANT LINES SHALL BE SIZED BY UNIT MANUFACTURER AND INSTALLED ACCORDING TO MANUFACTURER'S INSTRUCTIONS. STRAPPING FIRE WALLS SHALL BE WITH A MATERIAL CAPABLE OF PREVENTING THE PASSAGE OF FLAMES AND HOT GASES IN THE EVENT OF A FIRE.
 5. DRYER EXHAUST SHALL NOT EXCEED 25 FEET IN LENGTH.
 6. PROVIDE AND INSTALL WATER PROOF GRILLE VENT ON ROOF FOR TOILET EXHAUST.
 7. PROVIDE AND INSTALL WATER PROOF GRILLE VENT ON ROOF FOR TOILET EXHAUST.
 8. PROVIDE AND INSTALL WATER PROOF GRILLE VENT ON ROOF FOR TOILET EXHAUST.
 9. PROVIDE AND INSTALL WATER PROOF GRILLE VENT ON ROOF FOR TOILET EXHAUST.
 10. PROVIDE AND INSTALL WATER PROOF GRILLE VENT ON ROOF FOR TOILET EXHAUST.
 11. PROVIDE AND INSTALL WATER PROOF GRILLE VENT ON ROOF FOR TOILET EXHAUST.
 12. PROVIDE AND INSTALL WATER PROOF GRILLE VENT ON ROOF FOR TOILET EXHAUST.
 13. PROVIDE AND INSTALL WATER PROOF GRILLE VENT ON ROOF FOR TOILET EXHAUST.
 14. PROVIDE AND INSTALL WATER PROOF GRILLE VENT ON ROOF FOR TOILET EXHAUST.
 15. PROVIDE AND INSTALL WATER PROOF GRILLE VENT ON ROOF FOR TOILET EXHAUST.
 16. PROVIDE AND INSTALL WATER PROOF GRILLE VENT ON ROOF FOR TOILET EXHAUST.

BATHROOM VENT FAN

VENDOR	MODEL	DESCRIPTION
BRONX	I-100	100 CFM CEILING MT. VENT FAN

A/C SCHEDULE

MARK/SIZE	INDOOR UNIT	OUTDOOR UNIT
	COOL (BTU)	HEAT (BTU)
(A) 1.5 TON	18,000	600
	5kW	18,000
		240V, 1φ

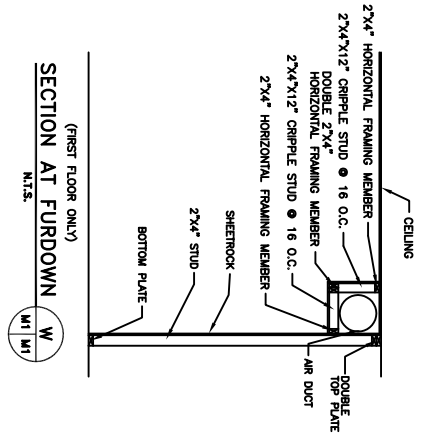

MECHANICAL PLAN
BRIAN RIENE
JOSEPH STREET
SLIDELL, LOUISIANA

SUN VALLEY APARTMENTS PHASE 2
DAMMON ENGINEERING, INC.
1095 FLORIDA AVENUE 985-649-5832 SLIDELL, LA. 70468
DAMMONENGINEERING.COM

SCALE(S) NOTED
FILE:
JOB NO. 1697
DATE: 01-06-06
SHEET 22
M-1
OF 27