

**DAMMON
ENGINEERING, INC.**

CHIEF ENGINEER
EMMETT
DAMMON, P.E.

CHIEF ARCHITECT
ROBERT
WILTSE

1095 FLORIDA AVENUE
SLIDELL, LA. 70458
OFFICE: 985-649-5832
FAX: 985-641-5950

WEBSITE:
WWW.DAMMONENGINEERING.COM

EMAIL:
DAMMONENG@BELLSOUTH.NET

ARCHITECTURE
ENGINEERING
STUDIES
PLANNING
INVESTIGATION
EXPERT WITNESS

ANDERSON
MEMORY CARE
RON DUHE
4104 DAUPHINE ST
SLIDELL, LA

MWFRS
PLAN

REV:

SCALE: AS NOTED

JOB#:

-DATE: 07-15-10

SHEET

A-1

OF

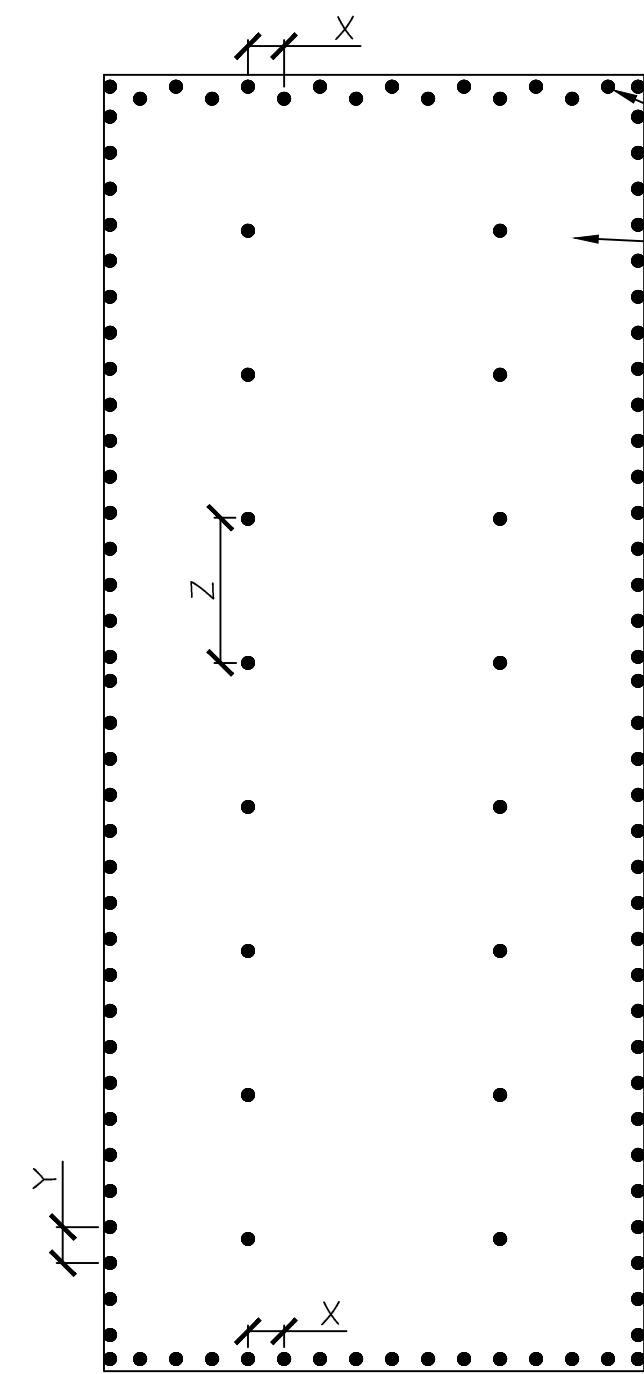

NAILING MAY BE STAGGERED
ACROSS BOTH TOP PLATES

WINSTORM PANELS
RUN VERTICALLY FULL-HEIGHT

SEE MANUFACTURER'S REQUIREMENTS FOR
ADDITIONAL DETAILS AND NOTES

NAIL SPACING
X= 3" O.C.
Y= 6" O.C.
Z= 12" O.C.

X= PLATE EDGE NAIL SPACING
Y= LONG EDGE NAIL SPACING
Z= FIELD NAIL SPACING

NOTE:
NAILING SHOWN ON DRAWING N.T.S.
USE NAIL SPACING AS SHOWN

**WINDSTORM STRUCTURAL
SHEATHING DETAIL**

SCALE: N.T.S.

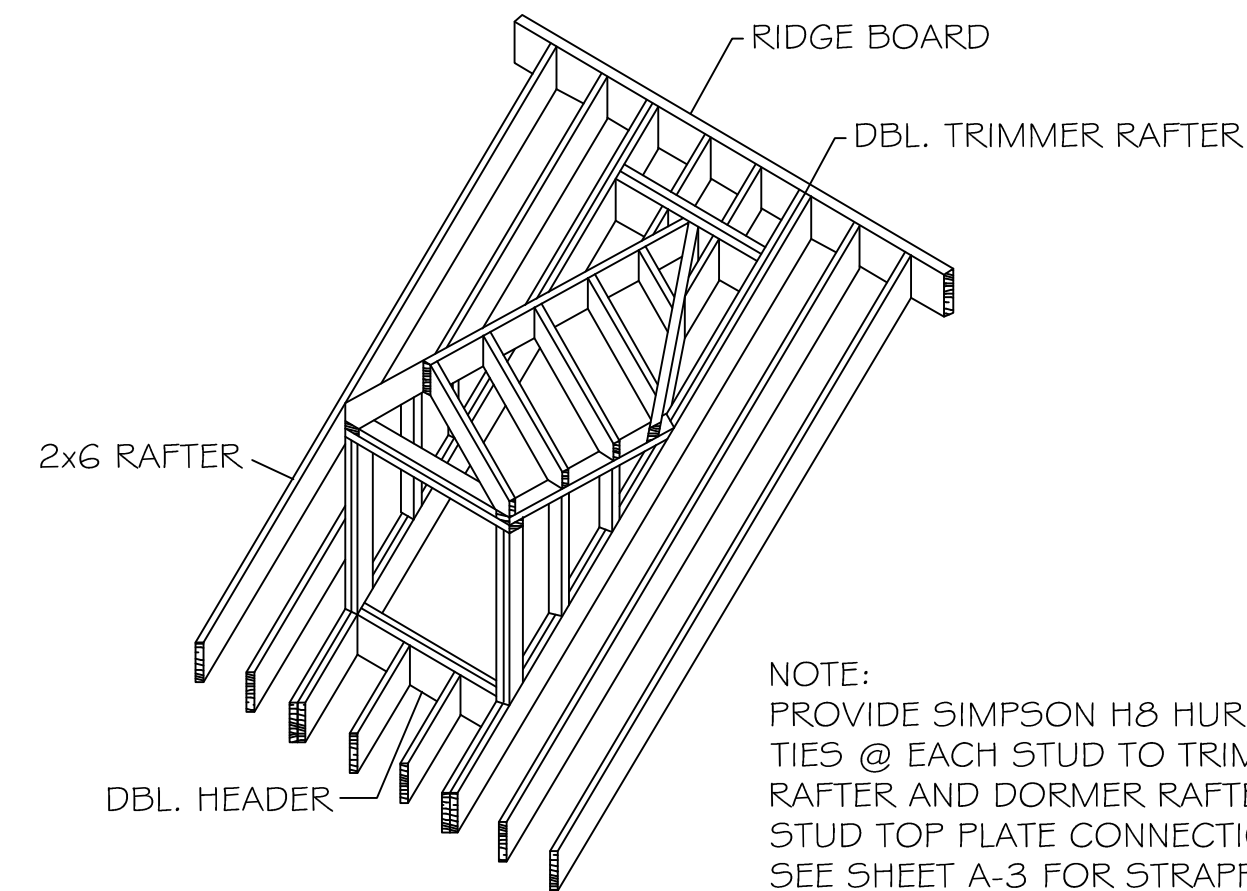

NOTE:
PROVIDE SIMPSON H8 HURRICANE
TIES @ EACH STUD TO TRIMMER
RAFTER AND DORMER RAFTER TO
STUD TOP PLATE CONNECTION.
SEE SHEET A-3 FOR STRAPPING
DETAILS

DORMER FRAMING DETAIL

SCALE: N.T.S.

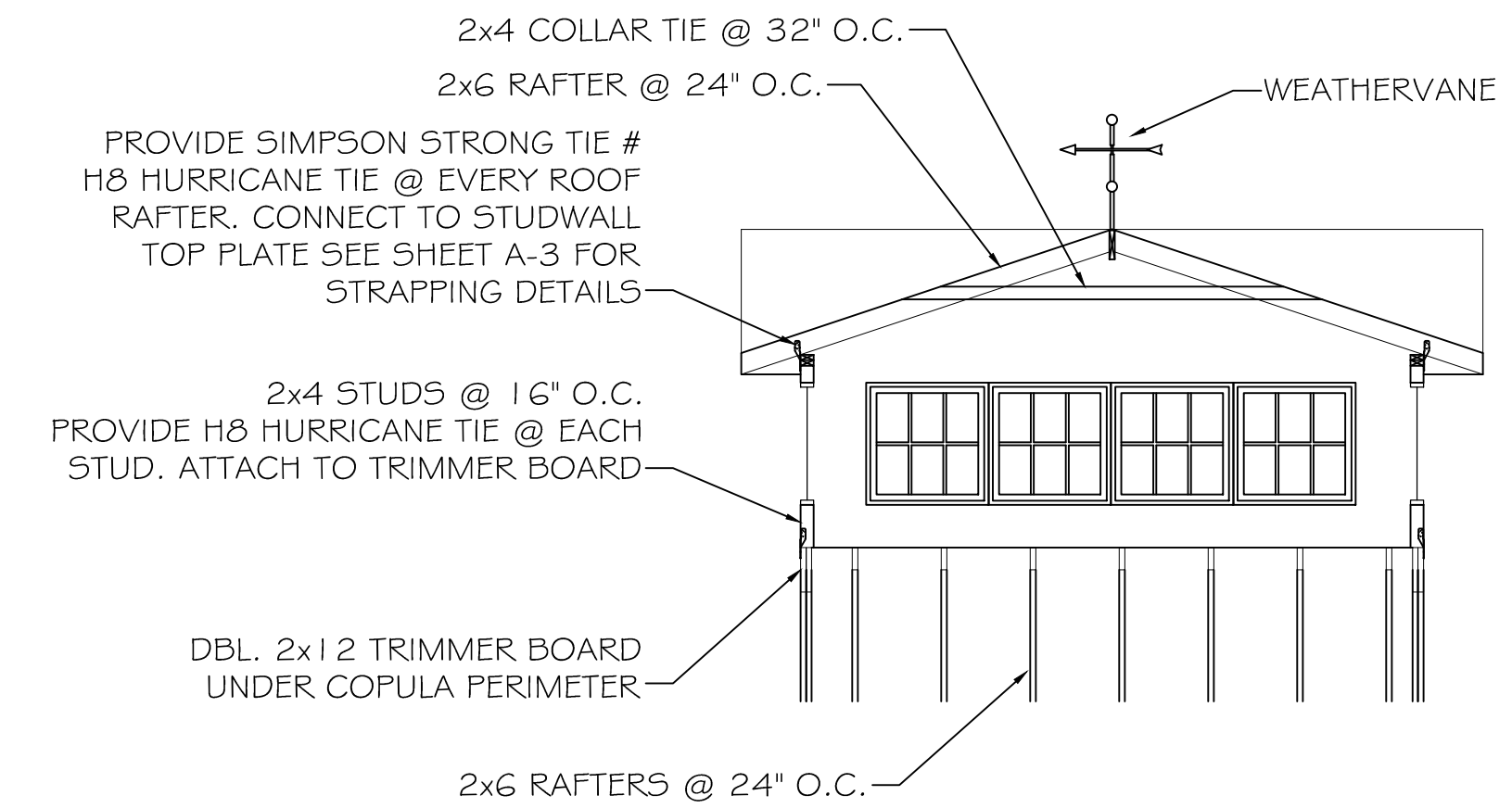

PROVIDE SIMPSON STRONG TIE #
H8 HURRICANE TIE @ EVERY ROOF
RAFTER. CONNECT TO STUDWALL
TOP PLATE SEE SHEET A-3 FOR
STRAPPING DETAILS

2x4 STUDS @ 16" O.C.
PROVIDE H8 HURRICANE TIE @ EACH
STUD. ATTACH TO TRIMMER BOARD

DBL. 2x12 TRIMMER BOARD
UNDER COPULA PERIMETER

2x6 RAFTERS @ 24" O.C.

COPULA FRAMING SECTION

SCALE: N.T.S.

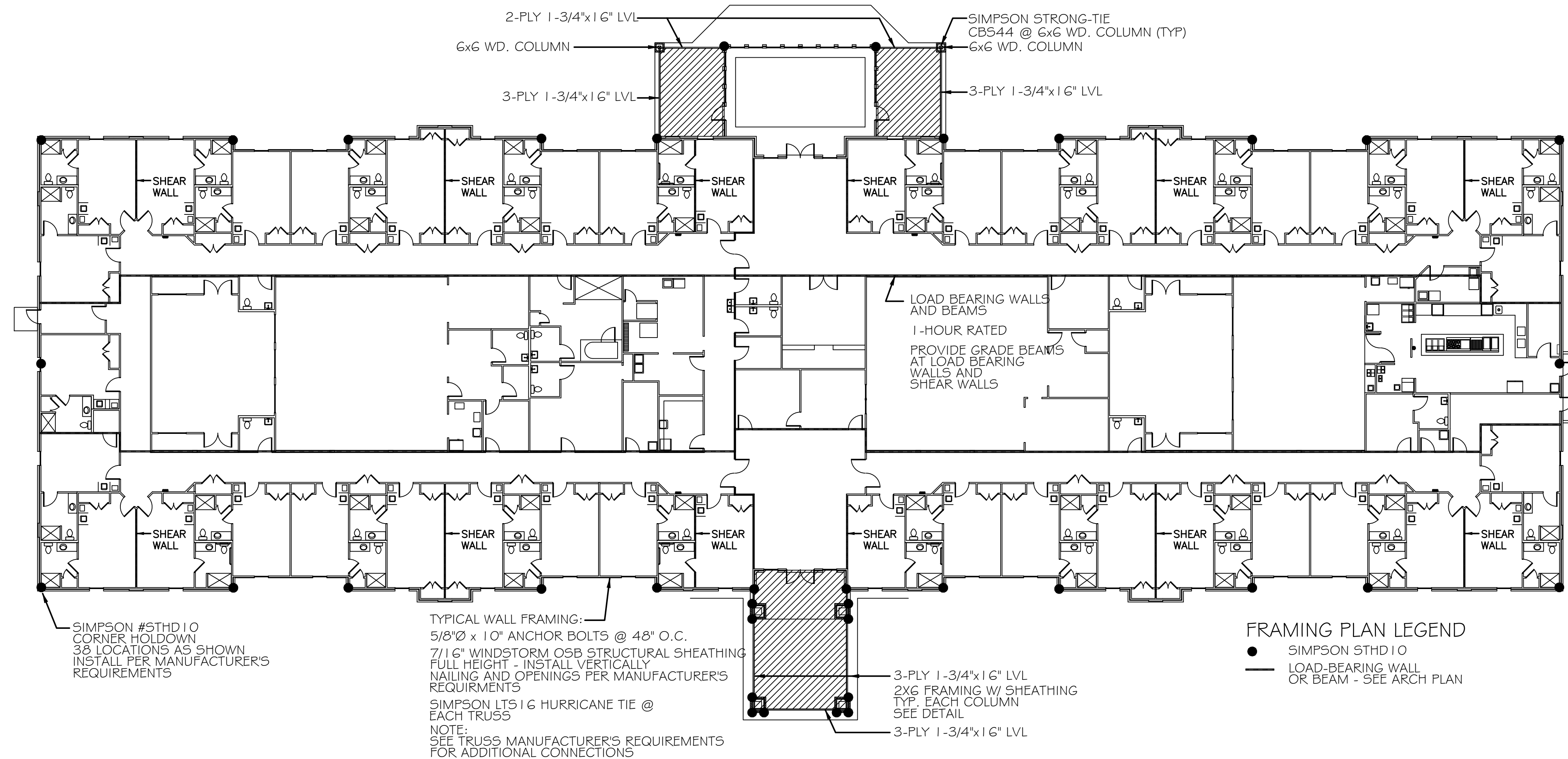

SIMPSON #5THD10
CORNER HOLDOWN
38 LOCATIONS AS SHOWN
INSTALL PER MANUFACTURER'S
REQUIREMENTS

TYPICAL WALL FRAMING:
5/8"Ø x 10" ANCHOR BOLTS @ 48" O.C.
7/16" WINSTORM OSB STRUCTURAL SHEATHING
FULL HEIGHT - INSTALL VERTICALLY
NAILING AND OPENINGS PER MANUFACTURER'S
REQUIREMENTS

SIMPSON LTS16 HURRICANE TIE @
EACH TRUSS
NOTE:
SEE TRUSS MANUFACTURER'S REQUIREMENTS
FOR ADDITIONAL CONNECTIONS

3-PLY 1-3/4x16" LVL
2X6 FRAMING W/ SHEATHING
TYP. EACH COLUMN
SEE DETAIL

FRAMING PLAN LEGEND

● SIMPSON 5THD10
— LOAD-BEARING WALL
OR BEAM - SEE ARCH PLAN

FRAMING CONNECTION PLAN

SCALE: 1/16"=1'-0"