

elev. top of roof rafters = 52'-5"

- METAL FLASHING
- NONE ELEVATORY WINDOW (SEE DWG. A-15)
- ASBESTOS CHINGLES
- ELDS. PAPER
- FRIGID INSULATION
- 3X6 1/2" WT. T&G WOOD DECK
- LAMINATED WOOD RAFTERS

- WOOD LIGHT TROUGH (SEE DWG. A-15)
- METAL FLASHING
- BUILT UP ROOF
- FRIGID INSULATION
- 3X6 1/2" WT. T&G WOOD DECK
- METAL GRAVEL GUARD
- ALUMINUM FLASHING

- WOOD TRIM (CUT FROM 4" x 4" W.V. MEMBER)
- CONC. BEAMS (SEE STRUCT. DWG'S)
- SUSPENDED CEILING PLASTER CLG.
- FIXED GLASS W/ALUM. FRAMES
- CONC. COLS (SEE STRUCT. DWG'S)
- SELEBY FILL
- TRIM WALL FLASHING
- 12" CAVITY BRICK WALL
- 7/32" CRYS. SH. GLASS
- SUSPENDED PLASTER CLG.
- DUST SPACE
- METAL FASCIA FLASHING
- TRUSSING
- CONC. SLAB & FOUNDATION (SEE STRUCT. DWG'S)

NOTE: MATERIALS ON OPP. SIDE OF BUILDING ARE NOTED ON THIS SIDE OF BUILDING.

- elev. top of conc. beams = 12'-9"
- elev. top of conc. columns = 9'-7"
- elev. top of brick walls = 7'-0"
- elev. fin. floor = 0'-0"
- elev. fin. grade varies (see plot plan)

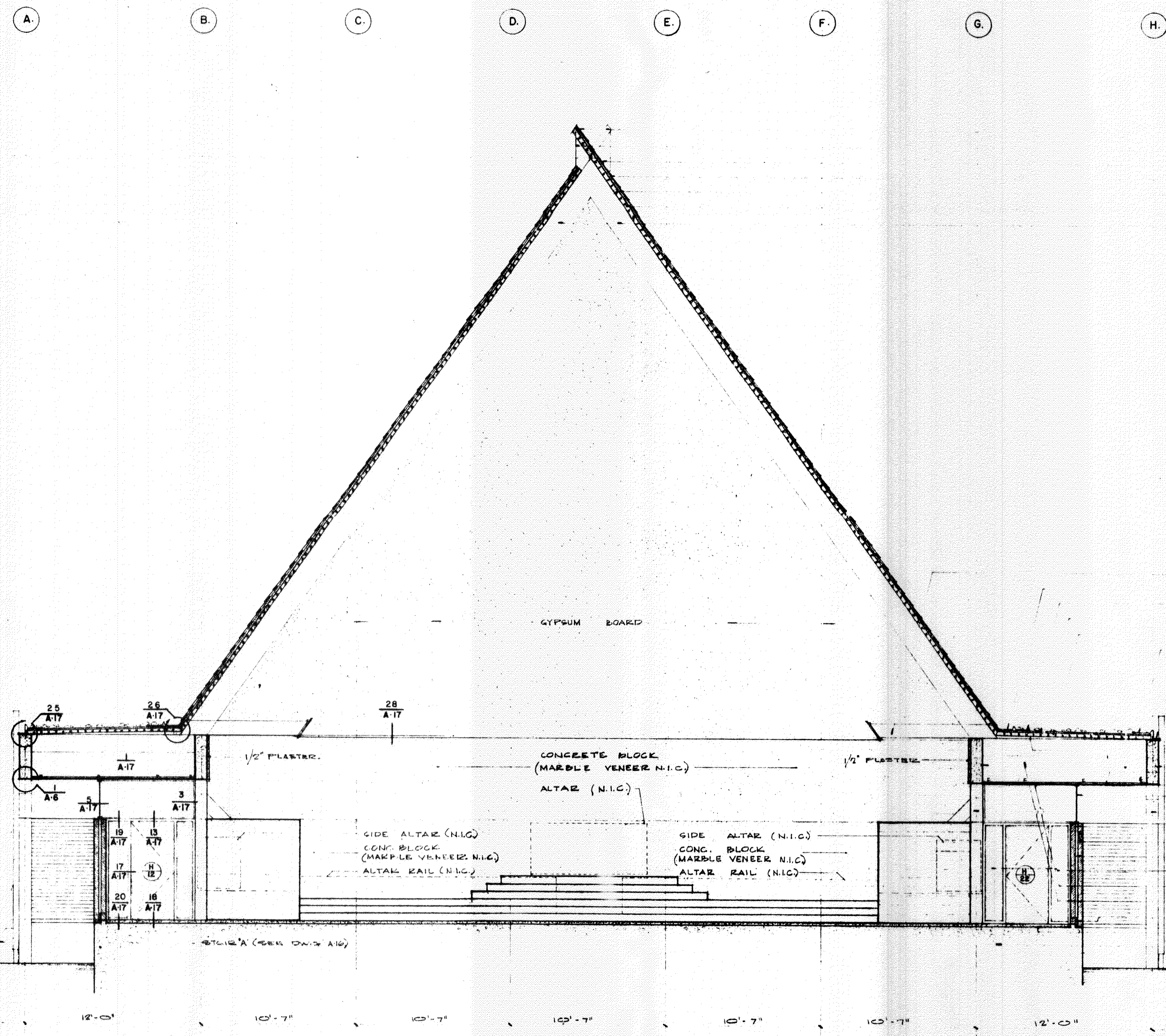

section "C-C"

scale 1/4" = 1'-0"

our lady of lourdes catholic church and rectory
slidell, louisiana

date	1-12-61
scale	1/4" = 1'-0"
drawn	G.M.E.
checked	J.W.L.

sheet no. **A-12**

insurance and estimates architects
metairie, louisiana