

HEADER SPANS—FOR INT. LOADBEARING WALLS

HEADER SUPPORTING	SIZE	BLDG. WIDTH (ft.)		
		12	24	36
(2)2x4S	4'-4"	3'-1"	2'-6"	
(2)2x6S	6'-5"	4'-6"	3'-8"	
(2)2x8S	8'-1"	5'-9"	4'-8"	
(2)2x10S	9'-11"	7'-0"	6'-9"	
(2)2x12S	10'-2"	8'-2"	7'-10"	
(3)2x10S	12'-4"	9'-2"	8'-10"	
(3)2x12S	14'-4"	10'-2"	9'-3"	
(4)2x10S	11'-6"	8'-3"	6'-8"	
(4)2x12S	14'-4"	10'-1"	8'-3"	
(2)2x4S	2'-10"	2'-1"	1'-6"	
(2)2x6S	4'-2"	3'-1"	2'-6"	
(2)2x8S	5'-4"	3'-11"	3'-3"	
(2)2x10S	6'-6"	4'-9"	3'-11"	
(2)2x12S	7'-6"	5'-6"	4'-0"	
(3)2x10S	8'-1"	6'-10"	4'-11"	
(3)2x12S	9'-5"	6'-11"	5'-9"	
(4)2x10S	7'-8"	5'-8"	4'-8"	
(4)2x12S	9'-4"	6'-10"	5'-8"	
(4)2x10S	10'-10"	8'-0"	6'-7"	

* MAX. SPAN EXCEEDS 16' (SPANS LIM. TO 16').

NOTE: ALL HEADERS SHALL HAVE SOLID BLOCKING.

JACK STUD REQUIREMENTS—FOR INTERIOR LOADBEARING WALLS

HEADER SUPPORTING	SPAN (ft.)	ROOF SPAN (ft.)		
		12 FEET	24 FEET	36 FEET
ROOF AND CEILING	2	1	1	1
	4	1	1	1
	6	1	1	1
	8	1	1	1
	10	1	1	1
	12	1	1	1
	14	2	2	2
	16	2	2	2
	18	2	2	2
	20	2	2	2
	22	2	2	2
	24	2	2	2
ROOF CEILING AND 1 CENTER BEARING FLR.	8	2	1	1
	10	2	1	1
	12	2	1	1
	14	3	2	2
	16	3	2	2
	18	4	3	3
	20	4	3	3
	22	5	4	4
	24	5	4	4
	26	6	5	5
	28	6	5	5
	30	7	6	6
HEADER WIDTH—3" (2-2x), 4.5" (3-2x), 5" (4-2x), 5.5" (4-2x)	4	1	1	1
	6	1	1	1
	8	2	2	2
	10	2	2	2
	12	3	2	2
	14	4	3	2
	16	4	3	2
	18	5	4	3
	20	5	4	3
	22	6	5	4
	24	6	5	4
	26	7	6	5

UPLIFT CONNECTIONS—130MPH WINDS EXP. "B"

CONNECTION	FRAMING SPACING (in.)	ROOF SPAN (ft.)	U	L	S	NUM. OF 8d COM. NAILS OR 10d BOX NAILS IN EA. END OF 1-1/4"x20 GA. STRAP
ROOF ASSEMBLY TO WALL ASSEMBLY	16" O.C.	17	386	246	109R	4
WALL ASSEMBLY TO WALL ASSEMBLY	16" O.C.	17	386	246	109R	4
WALL ASSEMBLY TO FOUNDATION	16" O.C.	17	170	185	436	4

THERMAL COMPONENT CRITERIA (U-FACTOR AND R-VALUE)

MAX. GLAZING U-FACTOR	MINIMUM INSULATION R-VALUE			CRAWL SPACE WALLS
	CEILING	WALLS	FLOORS	
.75	R-26	R-13	R-11	R-5

WINDBORNE DEBRIS PROTECTION FASTENING SCHEDULE FOR WOOD STRUCTURAL PANELS

FASTENER TYPE	FASTENER SPACING		
	4 FOOT PANEL SPAN	6 FOOT PANEL SPAN	8 FOOT PANEL SPAN
2-1/2" #8 WOOD SCREWS	≤ 4 FOOT	≤ 6 FOOT	≤ 8 FOOT
2-1/2" #8 WOOD SCREWS	16"	12"	9"
2-1/2" #8 WOOD SCREWS	16"	16"	12"

WINDOWS IN BUILDINGS LOCATED IN WIND BORNE DEBRIS REGIONS SHALL HAVE GLAZED OPENINGS PROTECTED FROM WINDBORNE DEBRIS. WOOD STRUCTURAL PANELS WITH A MIN. THICKNESS OF 1/8" AND A MAX. SPAN OF 8 FEET SHALL BE PERMITTED FOR PROTECTION OF GLAZED OPENINGS WITH ATTACHMENT HARDWARE PROVIDED TO COVER THE GLAZED OPENINGS WITH ATTACHMENT HARDWARE PROVIDED.

HEADER SPANS—EXPOSURE B FOR EXTERIOR LOADBEARING WALLS

HEADER SIZE	SPAN	NO. FULL HGT. STUDS REQ. AT EA. END
(2)2x4S	4'-7"	2
(2)2x6S	5'-6"	2
(2)2x8S	6'-1"	3
(2)2x10S	6'-8"	3
(2)2x12S	7'-1"	3
(3)2x10S	7'-5"	3
(3)2x12S	8'-3"	3
(4)2x10S	8'-7"	3
(4)2x12S	9'-6"	3
(4)2x10S	10'-0"	4

NOTE: 130MPH WINDS—EXPOSURE "B" (TP) EACH W/ 1/2" PLYWD. SPACER BETWEEN BUILDING WIDTH IS MEASURED PERPENDICULAR TO THE FACE OF THE WALL. SPANS ARE PERMITTED TO BE INTERPOLATED.

NOTE: ALL HEADERS SHALL HAVE SOLID BLOCKING.

JACK STUD REQ.—EXP. B FOR EXT. LOADBEARING WALLS

HEADER SUPPORTING	HEADER SPAN (ft.)	HEADER WIDTH	NO. JACK STUDS REQ.		
			3"	4.5"	6.5"
ROOF AND CEILING	2	1	1	1	1
	4	1	1	1	1
	6	2	2	2	2
	8	2	2	2	2
	10	3	2	2	2
	12	3	2	2	2
	14	4	3	2	2
	16	4	3	2	2
	18	5	4	3	2
	20	5	4	3	2
	22	6	5	4	3
	24	6	5	4	3

DESIGN CRITERIA:

THE CONSTRUCTION FOR SAID BUILDING, WHERE BASIC WIND SPEED IS 130 MILES PER HOUR, IS DESIGNED IN ACCORDANCE WITH: AMERICAN FOREST AND PAPER ASSOCIATION (AF&PA) WOOD FRAME CONSTRUCTION MANUAL (WFCM) 2001 EDITION AND THE INTERNATIONAL BUILDING CODE (IBC) 2006 EDITION.

ROOF UNDERLAYMENT APPLICATION

FOR ROOF SLOPES FROM TWO UNITS VERTICAL IN 12 UNITS HORIZONTAL (17-PERCENT SLOPE) UP TO FOUR UNITS VERTICAL IN 12 UNITS HORIZONTAL (33-PERCENT SLOPE), UNDERLAYMENT SHALL BE TWO LAYERS APPLIED IN THE FOLLOWING MANNER:
 APPLY A 19 INCH STRIP OF UNDERLAYMENT FELT PARALLEL WITH AND STARTING AT THE EAVES, FASTENED SUFFICIENTLY TO HOLD IN PLACE, STARTING AT THE EAVE, APPLY 36 INCH WIDE SHEETS OF UNDERLAYMENT, OVERLAPPING SUCCESSIVE SHEETS 19 INCHES, AND FASTENED SUFFICIENTLY TO HOLD IN PLACE.

SINGLE APPLICATION/FASTENING

ASPHALT STRIP SHINGLES SHALL HAVE A MINIMUM OF SIX FASTENERS PER SHINGLE WHERE THE ROOF IS IN ONE OF THE FOLLOWING CATEGORIES:
 1. THE BASIC WIND SPEED IS 110 MPH OR GREATER AND THE EAVE IS 20 FEET OR HIGHER ABOVE GRADE.
 2. THE BASIC WIND SPEED IS 120 MPH OR GREATER.
 3. SPECIAL WIND ZONES.

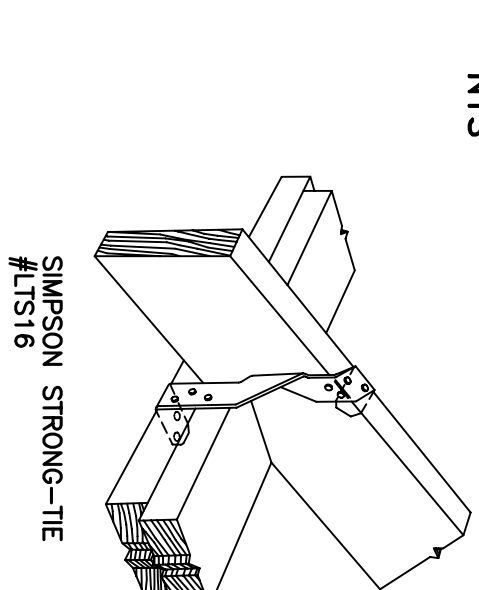

HEADER TO TOP PLATE DETAIL
NTS

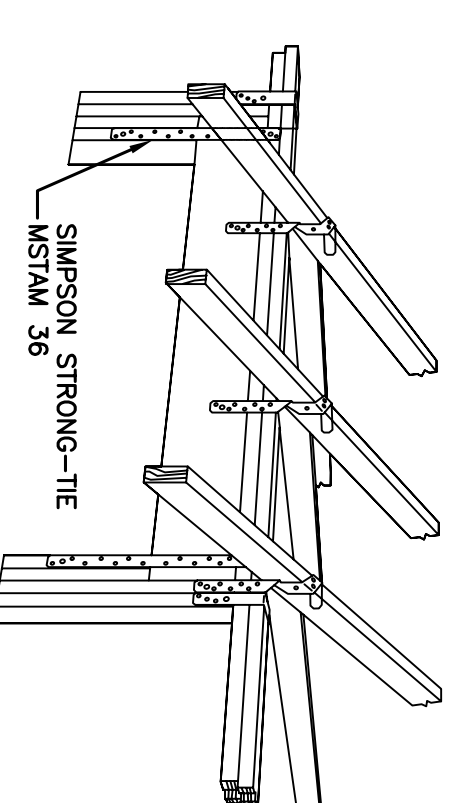

MINIMUM INSULATION R-VALUE

TOP PLATE TO RAFTER DETAIL
NTS

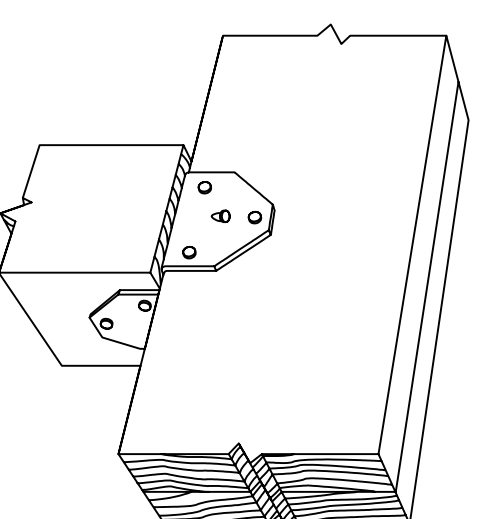

COLUMN CAP TO BEAM DETAIL
NTS

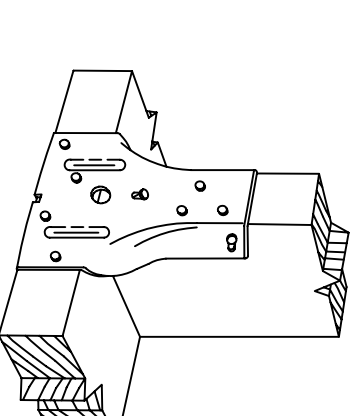

STUD TO TOP PLATE DETAIL
NTS

COLUMN TO FOUNDATION DETAIL
NTS

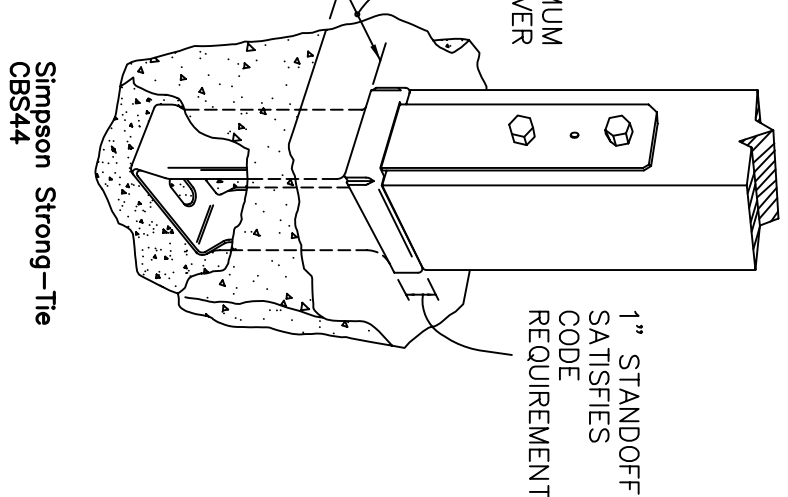

COLUMN TO FOUNDATION DETAIL
NTS

REV: _____
 SCALE: AS NOTED
 JOB#: 1910
 DATE: 12-14-07
 SHEET 12

BUILDING DETAILS

BEULAH LAND
 BAPTIST CHURCH
 2436 ST. MAURICE AVE.
 NEW ORLEANS, LA

NEW BAPTIST CHURCH

ARCHITECTURE
 ENGINEERING
 STUDIES
 PLANNING
 INVESTIGATION
 EXPERT WITNESS

ARCHITECT
 ROBERT WILTSE
 1095 FLORIDA AVENUE
 SLIDELL, LA, 70458
 985-649-5832

DAMMON ENGINEERING, INC.
 EMMETT DAMMON

