

DAMMON ENGINEERING, INC.
 CHIEF ENGINEER
 EMMETT DAMMON, P.E.

CHIEF ARCHITECT
 ROBERT WALTSE

1095 FLORIDA AVENUE
 SUDBEL, LA, 70458
 OFFICE: 985-649-5832
 FAX: 985-641-5950

WWW.DAMMONENGINEERING.COM
 EMAIL: DAMMONENG@BLSOUTH.NET

ARCHITECTURE
 ENGINEERING
 STUDIES
 PLANNING
 INVESTIGATION
 EXPERT WITNESS

NEW CHURCH

TABERNACLE
 BAPTIST CHURCH
 2445 FOURTH AVE
 SUDBEL, LA

SITE PLAN

REV:

SCALE AS NOTED

JOB#: 1978

DATE: 8-27-08

SHEET

C-2

INTERNATIONAL BUILDING CODE 2006 REQUIREMENTS

OCCUPANCY CLASSIFICATION: BUSINESS (B) 2,380 s.f. (SEC. 303.1)
 OCCUPANT LOAD: (TBL. 1004.1.1) (A-3) 1004.1 FIBER SEATING = 229 (A-3) 1004.1 UNCONCENTRATED 15 s.f. / OCCUPANT = 159 (B) 1004.1.1 100 s.f. / OCCUPANT = 24
 TOTAL LOAD = 412

EXIT ACCESS REQUIREMENTS: (SEC. 1014.1) FROM RESISTANCE RATING WALL TO EXIT: OCCUPANTS IN BUSINESS / ASSEMBLY OCCUPANCY (TBL. 1014.1.1) 6 EXITS PROVIDED
 EXIT ACCESS TRAVEL DISTANCE = 200' SPRINKLED
 EXIT ACCESS TRAVEL DISTANCE = 250' UNSPRINKLED
 TABLE 1016.1

ALLOWABLE HEIGHT AND BLDG. AREA: (TBL. 503) A-3 = 9,500 s.f. / 2 STORY ALLOWED. THIS PROJECT 7,264 s.f. / 1 STORY
 B = 23,000 s.f. / 4 STORY. THIS PROJECT 2,380 s.f. / 1 STORY
 CONSTRUCTION CLASSIFICATION: (SEC. 602.2) TYPE II-B

FIRE RESISTANCE RATING REQUIREMENTS FOR BLDG. ELEMENTS: (TBL. 601) STRUCTURAL FRAMES: 0 HRS. BEARING WALLS (INTERIOR AND EXTERIOR) = 0 HRS. NON-BEARING WALLS: 0 HRS. FLOOR CONSTRUCTION: 0 HRS. ROOF CONSTRUCTION: 0 HRS.

FIRE RESISTANCE RATING REQUIREMENTS FOR EXTERIOR WALLS: (TBL. 602) EXTERIOR WALLS WITH $\frac{A}{s} < 30$ THE SEPARATION DISTANCE = 0 HRS.

MAX. AREA OF EXTERIOR WALL OPENINGS: (TBL. 704) BLDGS. W/ AUTOMATIC SPRINKLER SYSTEM, MAXIMUM ALLOWABLE AREA OF UNPROTECTED OPENINGS SHALL BE THE SAME AS FOR PROTECTED OPENINGS (SECTION 704.9.1). BLDG. W/ > 20' FIRE SEPARATION DISTANCE ALLOWED UNLIMITED PROTECTED & UNPROTECTED OPENINGS. (TABLE 704.8)

FIRE ALARM SYSTEM REQUIREMENTS: (SEC. 907) THIS BLDG. DOES REQUIRE A FIRE ALARM SYSTEM IN ACCORDANCE WITH SECTION 907.2.1

FIRE PROTECTION SYSTEM REQUIREMENTS: (SEC. 903) THIS BLDG. DOES REQUIRE A FIRE PROTECTION SYSTEM IN ACCORDANCE WITH SECTION 903.2.1.3 GROUP A-3

CONSTRUCTION DOCUMENTS: (SEC. 1603) THIS BLDG. SHALL BE DESIGNED IN ACCORDANCE WITH IBC SECTION 1609 AS A FULLY ENCLOSED BLDG. USING THE FOLLOWING INFORMATION:
 BASIC WIND SPEED (3 SECOND GUSTS) = 130 MPH (FIG. 1609)
 IMPRUVANCE FACTOR: CATEGORY III BLDG., IE = 1.00, IS = 1.0, IW = 1.00 (TBL. 1604.5) DETERMINATION OF WIND LOADS SHALL BE IN ACCORDANCE WITH SECTION 1609.
 MINIMUM LIVE LOADS SHALL BE DETERMINED IN ACCORDANCE WITH TBL. 1607.1
 GROUND SNOW LOADS = 5 PSF (FIG. 1608.2)

BASED ON THE SURVEY OF THIS PROPERTY BY J.V. BURKES & ASSOC., INC. REGISTERED LAND SURVEYOR NO. 4785, F.L.R.M. COMMUNITY NO. 220204, PARCEL NO. 0010, SURF. C. F.L.R.M. DATE 4/27/1999. BUILDING IS NOT LOCATED IN A SPECIAL FLOOD HAZARD AREA. IT IS DESIGNATED IN FLOOD ZONE X BASE FLOOD ELEVATION 9'

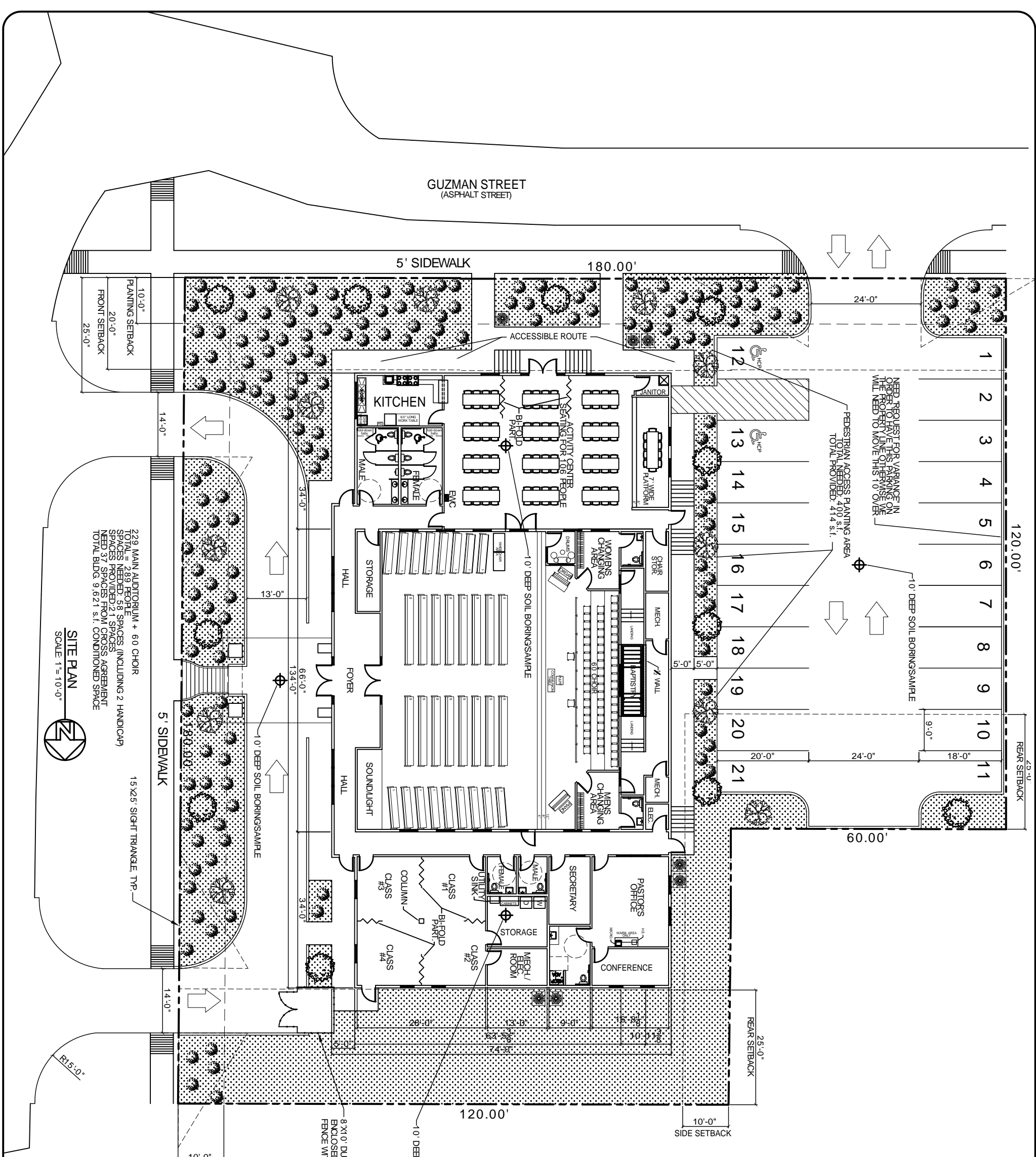

229 MAIN AUDITORIUM + 60 CHOIR
 SEATING = 289 SEATING SPACES (INCLUDING 2 HANDICAP)
 SPACES PROVIDED = 2 SPACES
 NEED 37 SPACES FROM CROSS AGREEMENT
 TOTAL BLDG. 9,621 s.f. CONDITIONED SPACE

SITE PLAN
 SCALE 1" = 10'-0"

