

LOCATED IN COOLER ROOM.

LOCATED IN ELECTRICAL MEZZANINE

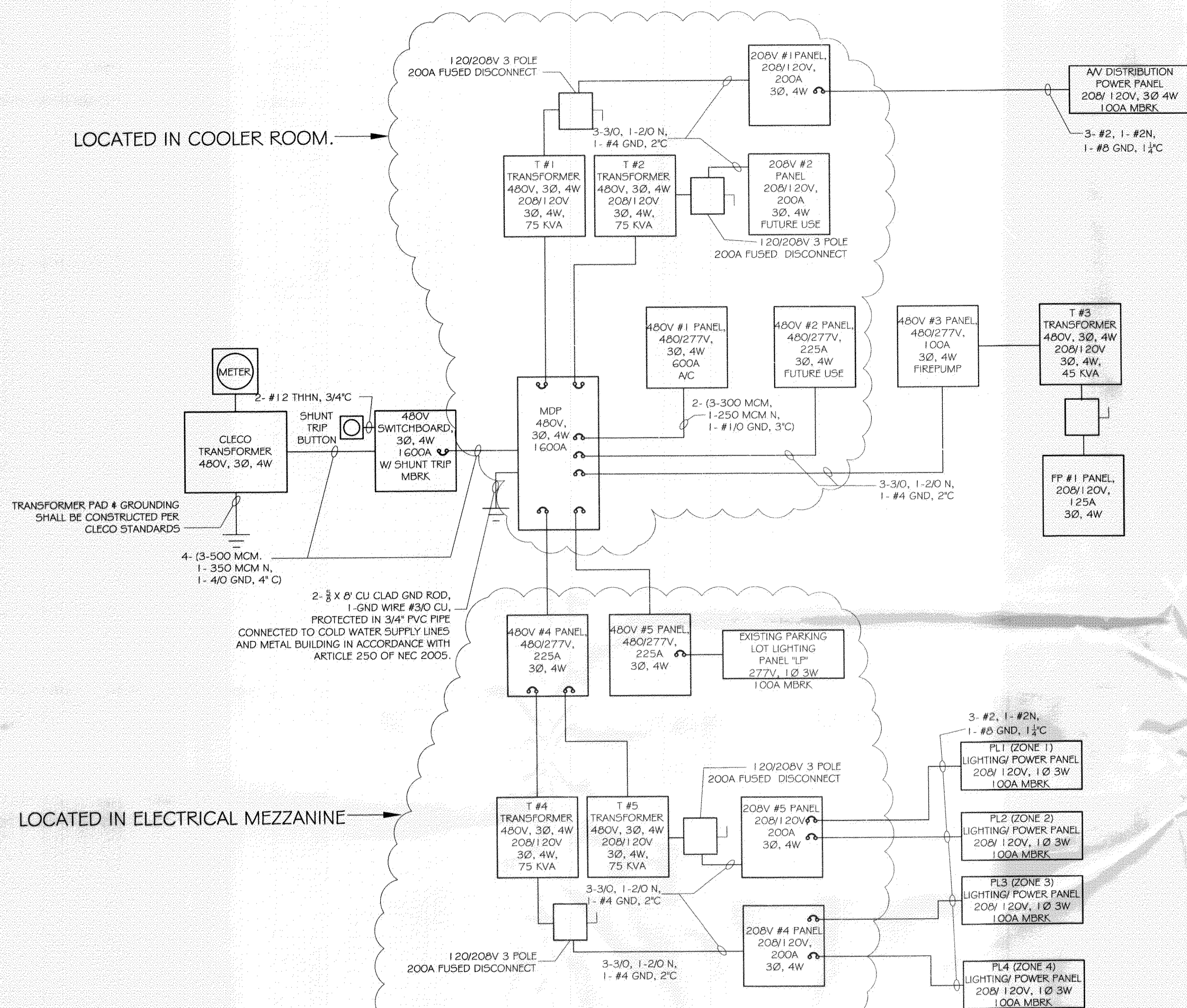

ELECTRICAL ONE LINE DIAGRAM
N.T.S.

GENERAL NOTES:

1. LOCATE SHUNT TRIP BUTTON NEAR CLECO TRANSFORMER. BUTTON SHALL BE MARKED AS "EMERGENCY TRIP". MOUNTED ON BUILDING WALL.
2. ALL INTERIOR WIRING SHALL BE TYPE THHN.
3. ALL EXTERIOR WIRING SHALL BE TYPE THWN.
4. ALL INTERIOR CONDUIT SHALL BE EMT. SEE DRAWINGS FOR SIZES.
5. ALL EXTERIOR CONDUIT SHALL BE GALVANIZED OR SCHED. 80 PVC. SEE DRAWINGS FOR SIZES.
6. CONTRACTOR SHALL SIZE EQUIPMENT CIRCUIT BREAKERS TO MATCH EQUIPMENT FURNISHED.
7. SERVICE ENTRANCE SHALL BE IDENTIFIED IN ACCORDANCE WITH 70:230.71#70.
8. REMOVE WIRE AND ABANDON EXISTING SERVICE CONDUIT FROM EXISTING TRANSFORMER "A" SUPPLYING NEW PROJECT AREA.

EXISTING PANEL USAGE SCHEDULE- MAIN FLOOR

PANEL	SERVICE FOR:	DISPOSITION
HN	WAREHOUSE LIGHTS	IN USE
LZ	REFRIGERATOR/ FREEZER	ABANDONED
LH	MEN'S WASHROOM	
CRM I	DIST. TO PNL'S HG, LE, HE, HF, HH, HJ, LP, LN	IN USE
HN	LIGHTING CONTACTOR	
HEN	LIGHTING CONTACTOR	
HEW	LIGHTING CONTACTOR	
"PNI"	OUTLETS	
LP	PARKING LOT LIGHTING	IN USE

RM. 115
RM. 132
RM. 126
RM. 107
RM. 113
RM. 113
RM. 113
RM. 130
EXTERIOR- NW CORNER OF BLDG.

EXISTING PANEL USAGE SCHEDULE- AC/ ELEC. RM. 1

PANEL	SERVICE FOR:	DISPOSITION
H5	CONDENSER, COMPACTOR	
HR	CONDENSER, EXHAUST FANS, REFRIGERATOR	
HAB-LT	STORE LIGHTS	
HX	LIGHTS	
HAB-RT	MAIN FLOOR OUTLETS	
LX	2ND FLOOR OUTLETS	
LD		

EXISTING PANEL USAGE SCHEDULE- AC/ ELEC. RM. 2

PANEL	SERVICE FOR:	DISPOSITION
LW		
LH		
PH	WAREHOUSE EXHAUST	
HJ	WAREHOUSE FANS	
HH	WAREHOUSE HEATERS	
LG		
LF	PHARMACY OUTLETS	
HEW	LIGHTING CONTACTOR	
HF	RENTAL LIGHTS	
HP	HEATERS	ABANDONED

EXISTING PANEL USAGE SCHEDULE- 202 OFFICE

PANEL	SERVICE FOR:	DISPOSITION
LU	COMPUTER OUTLETS	IN USE
LY	CASH REGISTERS	ABANDONED
LW	CHECKOUT CONVEYORS	ABANDONED

DEMOLISH ALL EXISTING PANELS NOT BEING USED

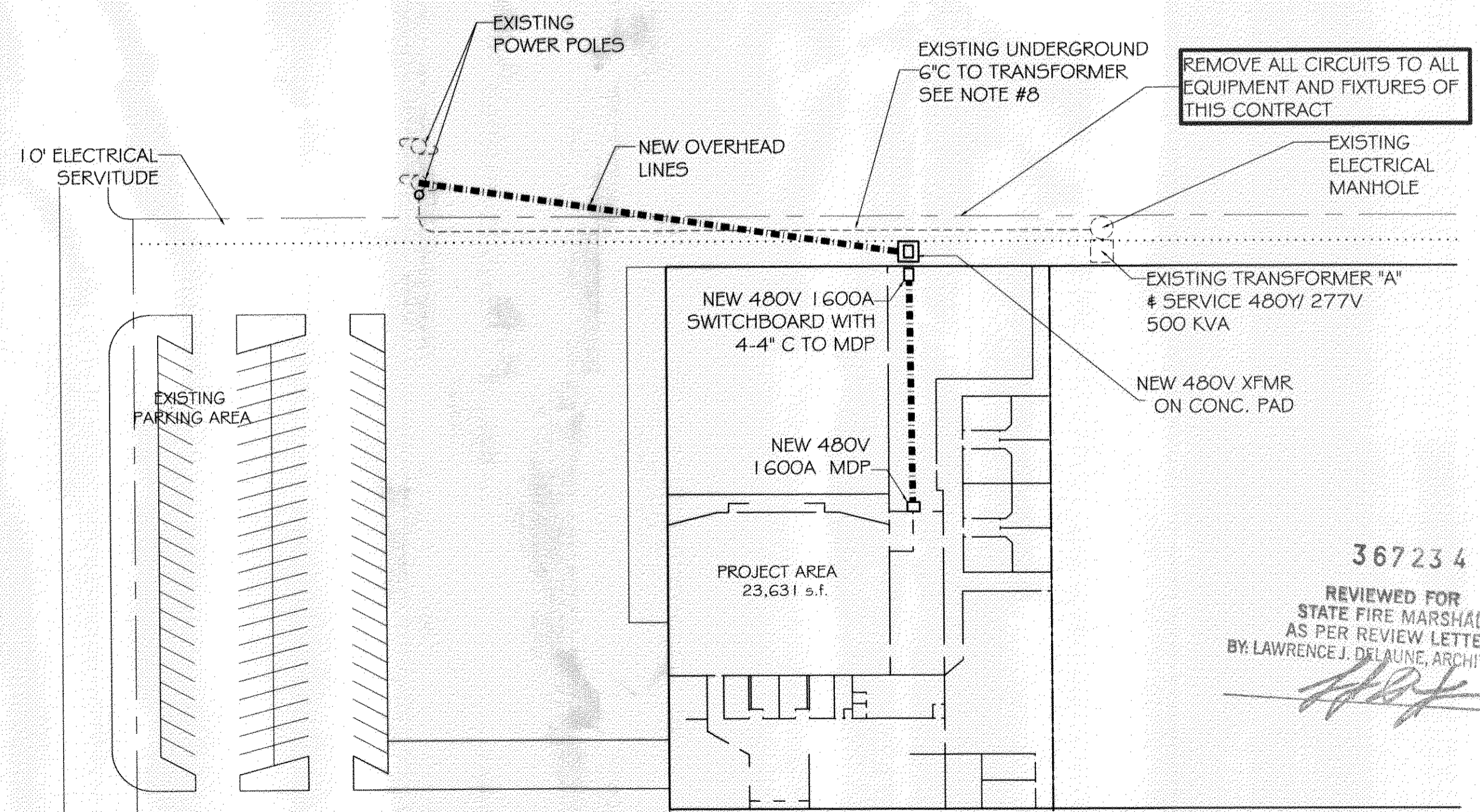

PARTIAL SITE PLAN
SCALE: 1/16"=1'-0"

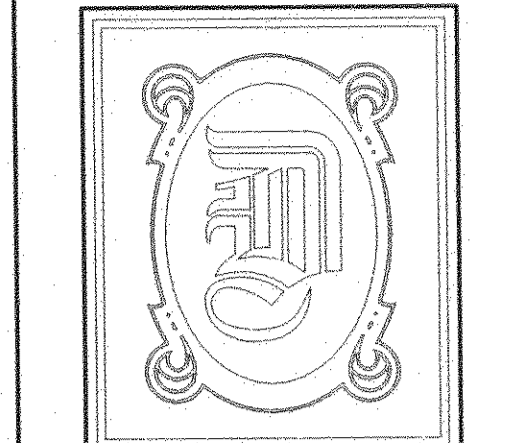

DAMMON ENGINEERING, INC.

CHIEF ENGINEER
EMMETT DAMMON, P.E.

CHIEF ARCHITECT
ROBERT WILTSE

1095 FLORIDA AVENUE
SLIDELL, LA. 70458
OFFICE: 985-649-5832
FAX: 985-641-5950

WEBSITE:
WWW.DAMMONENGINEERING.COM

EMAIL:
DAMMONENG@BELLSOUTH.NET

- ARCHITECTURE
- ENGINEERING
- STUDIES
- PLANNING
- INVESTIGATION
- EXPERT WITNESS

NORTHSHORE
CHURCH
KENSINGTON DR.
SLIDELL, LA

ONE LINE DIAGRAM
&
PARTIAL SITE PLAN

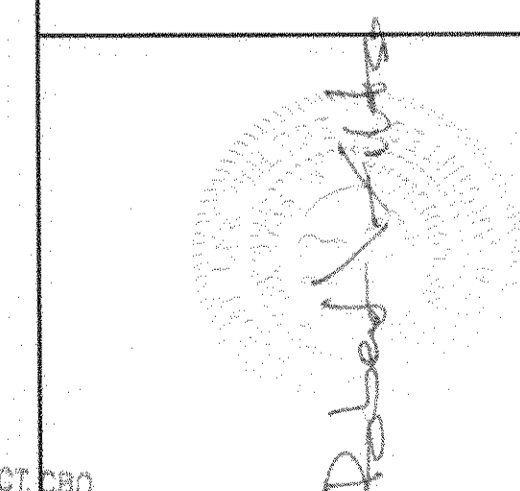

367234
REVIEWED FOR
STATE FIRE MARSHAL
AS PER REVIEW LETTER
BY: LAWRENCE J. DELAUNE, ARCHITECT, CBO

REV:01-30-09

SCALE: AS NOTED

JOB#: 1988

DATE: 09-30-08

SHEET

E-8

OF