

DOOR SCHEDULE							
MK	WIDTH	HEIGHT	THK	DOOR MAT	FRAME MAT	FR	REMARKS
100A	(2)3'-0"	6'-8"	1-3/4"	ALUM/GLASS	ALUM	NR	ALUMINUM STOREFRONT WITH DOOR CLOSURE
100B	(2)3'-0"	6'-8"	1-3/4"	INSUL MTL	STEEL	NR	WITH DOOR CLOSURE
100C	3'-0"	6'-8"	1-3/4"	INSUL MTL	STEEL	NR	WITH DOOR CLOSURE
101	3'-0"	6'-8"	1-3/4"	MASONITE	WOOD	NR	WITH DOOR CLOSURE
102	2'-8"	6'-8"	1-3/4"	MASONITE	WOOD	NR	MASONITE
103	(2)3'-0"	6'-8"	1-3/4"	MASONITE	WOOD	NR	WITH DOOR CLOSURE
104	(2)3'-0"	6'-8"	1-3/4"	MASONITE	WOOD	NR	MASONITE
105	3'-0"	6'-8"	1-3/4"	MASONITE	WOOD	NR	WITH DOOR CLOSURE
105F	3'-0"	6'-8"	1-3/4"	SOLID WOOD	STEEL	1-1/2 HR	WITH DOOR CLOSURE (1-1/2 HR FIRE RATINGS)
106	2'-0"	6'-8"	1-3/4"	INSUL MTL	WOOD	NR	MASONITE
106F	2'-0"	6'-8"	1-3/4"	SOLID WOOD	STEEL	1-1/2 HR	WITH DOOR CLOSURE (1-1/2 HR FIRE RATINGS)
107	3'-0"	3'-6"	1-3/4"	MASONITE	WOOD	NR	HALF-HEIGHT DOOR WITH COUNTER ON TOP TO MATCH ADJACENT

FINISH SCHEDULE						
MK	SIZE	FRAME	TYPE	REMARKS		
A	3'-0"X x 5'-0"X	ALUM	SLIDER	EXISTING TO REMAIN		
B	11'-0"X x 5'-0"X	ALUM	FIXED	NEW WINDOW		
C	3'-0"X x 5'-0"X	ALUM	FIXED	NEW WINDOW		

ROOM NAME	ROOM NO	FLOOR	BASE	WALL	CEILING	REMARKS
FOYER	100	VCT	VINYL	5/8" GYP BD	ACT	
JANITOR'S SUPPLIES	101	VCT	VINYL	5/8" GYP BD	ACT	
WOMENS RESTROOM	102	CERAMIC TILE	CERAMIC TILE	5/8" GYP BD	ACT	MOISTURE RESISTANT
MENS RESTROOM	103	CERAMIC TILE	CERAMIC TILE	5/8" GYP BD	ACT	MOISTURE RESISTANT
ELECTRICAL CLOSET	104	VCT	VINYL	5/8" GYP BD	ACT	
SOUND VIDEO ROOM	105	VCT	VINYL	5/8" GYP BD	ACT	
CAMERA BOOTH	106	VCT	VINYL	5/8" GYP BD	ACT	
CHURCH STORE	107	VCT	VINYL	5/8" GYP BD	ACT	
CORRIDOR	108	VCT	VINYL	5/8" GYP BD	ACT	

ROOM NAME	ROOM NO	FLOOR	BASE	WALL	CEILING	REMARKS
CRY ROOM	109	VCT	VINYL	5/8" GYP BD	ACT	
USHER CLOSET	110	VCT	VINYL	5/8" GYP BD	ACT	
CORRIDOR	111	VCT	VINYL	5/8" GYP BD	ACT	
SANCTUARY	112	VCT	VINYL	5/8" GYP BD	ACT	
MUSICIAN'S AREA	113	VCT	VINYL	5/8" GYP BD	ACT	
PULPIT/STAGE	114	VCT	VINYL	5/8" GYP BD	ACT	
COMM. CLOSET	115	VCT	VINYL	5/8" GYP BD	ACT	
ALCOVE	116	VCT	VINYL	5/8" GYP BD	ACT	
BAPTISTRY	117	CONCRETE	NONE	5/8" GYP BD	ACT	MOISTURE RESISTANT
BAPTISTRY PLUMP	118	CONCRETE	NONE	5/8" GYP BD	ACT	
VESTIBULE	119	VCT	VINYL	5/8" GYP BD	ACT	
CLOSET	120	VCT	VINYL	5/8" GYP BD	ACT	
TOILET	121	CERAMIC TILE	CERAMIC TILE	5/8" GYP BD	ACT	MOISTURE RESISTANT
CLOSET	122	VCT	VINYL	5/8" GYP BD	ACT	
PASTOR'S OFFICE	123	VCT	VINYL	5/8" GYP BD	ACT	
CLERK'S OFFICE	124	VCT	VINYL	5/8" GYP BD	ACT	
CLASSROOM	125	VCT	VINYL	5/8" GYP BD	ACT	
CORRIDOR	126	VCT	VINYL	5/8" GYP BD	ACT	
CLASSROOM	127	VCT	VINYL	5/8" GYP BD	ACT	
CORRIDOR	128	VCT	VINYL	5/8" GYP BD	ACT	
WOMENS RESTROOM	129	CERAMIC TILE	CERAMIC TILE	5/8" GYP BD	ACT	MOISTURE RESISTANT
MENS RESTROOM	130	CERAMIC TILE	CERAMIC TILE	5/8" GYP BD	ACT	MOISTURE RESISTANT
CORRIDOR	131	VCT	VINYL	5/8" GYP BD	ACT	
FELLOWSHIP HALL	132	VCT	VINYL	5/8" GYP BD	ACT	
CLASSROOM	133	VCT	VINYL	5/8" GYP BD	ACT	
CHOIR SUPPLIES	134	VCT	VINYL	5/8" GYP BD	ACT	
KITCHEN SUPPLIES	135	VCT	VINYL	5/8" GYP BD	ACT	
HARMING KITCHEN	136	VCT	VINYL	5/8" GYP BD	ACT	

GENERAL PLAN NOTES

- INSULATION AND INSULATION ASSEMBLIES SHALL MEET THE REQUIREMENTS OF IBC 2015 SECTION 120.
 - CONCEALED INSULATION SHALL HAVE A FLAME SPREAD OF 0-25 AND SMOKE DEVELOPED INDEX OF 0-450. EXCEPT THAT IN COMBUSTIBLE (WOOD FRAME) CONSTRUCTION.
 - FACINGS SHALL COMPLY WITH IBC 2015.
- ALL MATERIALS SHALL BE NEW AND UL LISTED.
- NO WORK SHALL BE CONCEALED UNTIL APPROVED BY LOCAL INSPECTORS.
- CONSTRUCTION SHALL COMPLY WITH ALL PARISH, STATE, AND LOCAL CODES.
- CONTRACTOR TO GUARANTEE WORK FOR ONE YEAR FROM DATE OF SUBSTANTIAL COMPLETION.
- CONTRACTOR SHALL FURNISH WATER AND POWER FROM EXISTING SOURCES.
- EXTERIOR CAULKING SHALL BE THICK CAULK.
- PAINT SHALL BE SHERWIN WILLIAMS OR EQUIVALENT AND APPROPRIATE FOR THE SUBSTRATE TO WHICH IT IS APPLIED AS RECOMMENDED BY PAINT MANUFACTURER. ALL WORK TO RECEIVE THREE COATS (ONE PRIMER COAT, TWO FINISH COATS) UNLESS OTHERWISE RECOMMENDED BY PAINT MANUFACTURER. COLORS TO BE SELECTED BY OWNER.
- PROVIDE CLEANUP ON A REGULAR BASIS. NO TRASH SHALL BE STORED INSIDE BUILDING PREMISES.
- ALL BATT INSULATION SHALL HAVE A CLASS "A" (0-25) FLAME SPREAD IN COMPLIANCE WITH IBC 2015.
- USE 2X6 WOOD STUDS, OR TWO 2X4 WOOD STAGGERED STUDS WITH 2X6 SILL FLATE AT ALL WALLS WHERE 4" PIPE IS INDICATED. SEE PLUMBING RISER DIAGRAM FOR PIPE SIZE.
- PROVIDE GALVANIZED METAL PAN WITH DRAIN AT ALL WATER HEATERS.
- ALL FLOORING SHALL MEET OR EXCEED ADA GUIDELINES REQUIREMENTS FOR SLIP RESISTANCE.
- INTERIOR LOCKS ON DOORS IN MEANS OF EGRESS SHALL NOT REQUIRE THE USE OF A KEY, SPECIAL KNOWLEDGE, OR SPECIAL DEVICE TO OPEN IN THE DIRECTION OF EGRESS. ALL DOORS SHALL HAVE LEVER TYPE HANDLES.
- INTERIOR WALLS AND CEILING SHALL HAVE A FLAME SPREAD OF 0-200 AND A SMOKE DEVELOPMENT RATING OF 0-450.
- ALL NEW WORK SHALL COMPLY WITH THE LATEST EDITION OF ALL LOCAL, STATE, AND NATIONAL CODES COVERING THE TYPE OF WORK BEING PERFORMED.
- PROVIDE PORTABLE FIRE EXTINGUISHERS IN ACCORDANCE WITH NFPA 101, SEE APPENDIX 'E' OF NFPA 101 FOR DISTRIBUTION OF EXTINGUISHERS.
- ALL FIRE WALLS SHALL EXTEND TIGHT TO ROOF DECK AND BE SEALED WITH AN APPROVED FIRE CAULK.
- ALL ELECTRICAL, MECHANICAL, AND PLUMBING MATERIALS PENETRATING FIRE WALLS SHALL BE FIRE CAULKED. (PENETRATIONS THROUGH RATED CONSTRUCTION SHALL BE SEALED WITH A MATERIAL CAPABLE OF PREVENTING THE PASSAGE OF FLAMES AND HOT GASES WHEN TESTED IN ACCORDANCE WITH ASTM-E814.)
- SERVICE COUNTERS SHALL HAVE AN ACCESSIBLE WRITING SURFACE IN COMPLIANCE WITH ADAAG ACCESSIBILITY GUIDELINES 2010, SECTION 902.3.

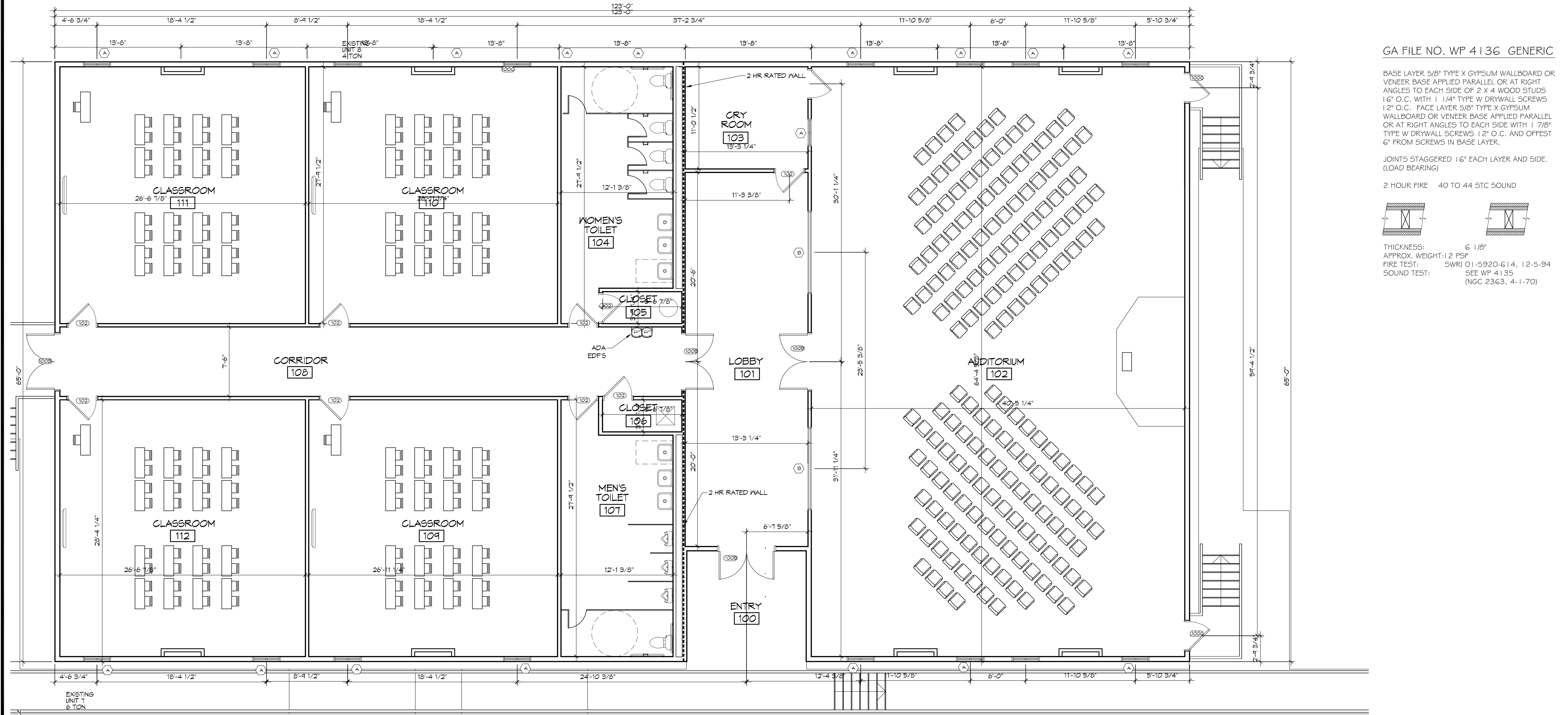

GA FILE NO. WP 4136 GENERIC

BASE LAYER 5/8" TYPE X GYPSUM WALLBOARD OR VENEER BASE APPLIED PARALLEL OR AT RIGHT ANGLES TO EACH SIDE OF 2 X 4 WOOD STUDS 16" O.C. WITH 1 1/4" TYPE W DRYWALL SCREWS 1 1/2" O.C. FACE LAYER 5/8" TYPE X GYPSUM WALLBOARD OR VENEER BASE APPLIED PARALLEL OR AT RIGHT ANGLES TO EACH SIDE WITH 1 7/8" TYPE W DRYWALL SCREWS 12" O.C. AND OFFSET 6" FROM SCREWS IN BASE LAYER.

JOINTS STAGGERED 16" EACH LAYER AND SIDE. (LOAD BEARING)

2 HOUR FIRE 40 TO 44 STC SOUND

THICKNESS: 6 1/8"
 APPROX. WEIGHT: 1.2 PSF
 FIRE TEST: SWRI 01-5920-G14, 12-5-94
 SOUND TEST: SEE WP 4135 (NGC 2363, 4-1-70)

DAMMON ENGINEERING, INC.
 LOUISIANA & MISSISSIPPI

Chief Engineer: Brian Metch, PE
 554 Old Spanish Trail
 Slidell, LA 70688
 www.dammonengineering.com
 info@dammonengineering.com
 Phone: 985.649.8832 F: 985.641.9950

Missing or invalid File: P:\Stamps\Sheet: 1

THE CROSSING

SHEET TITLE: FLOOR PLAN

DRAWING NUMBER: **A101**

SHEET No: 7 of 15

