

CUT BACK EXIST.
TRUSSES AND
ATTACH TO 24" BEAM

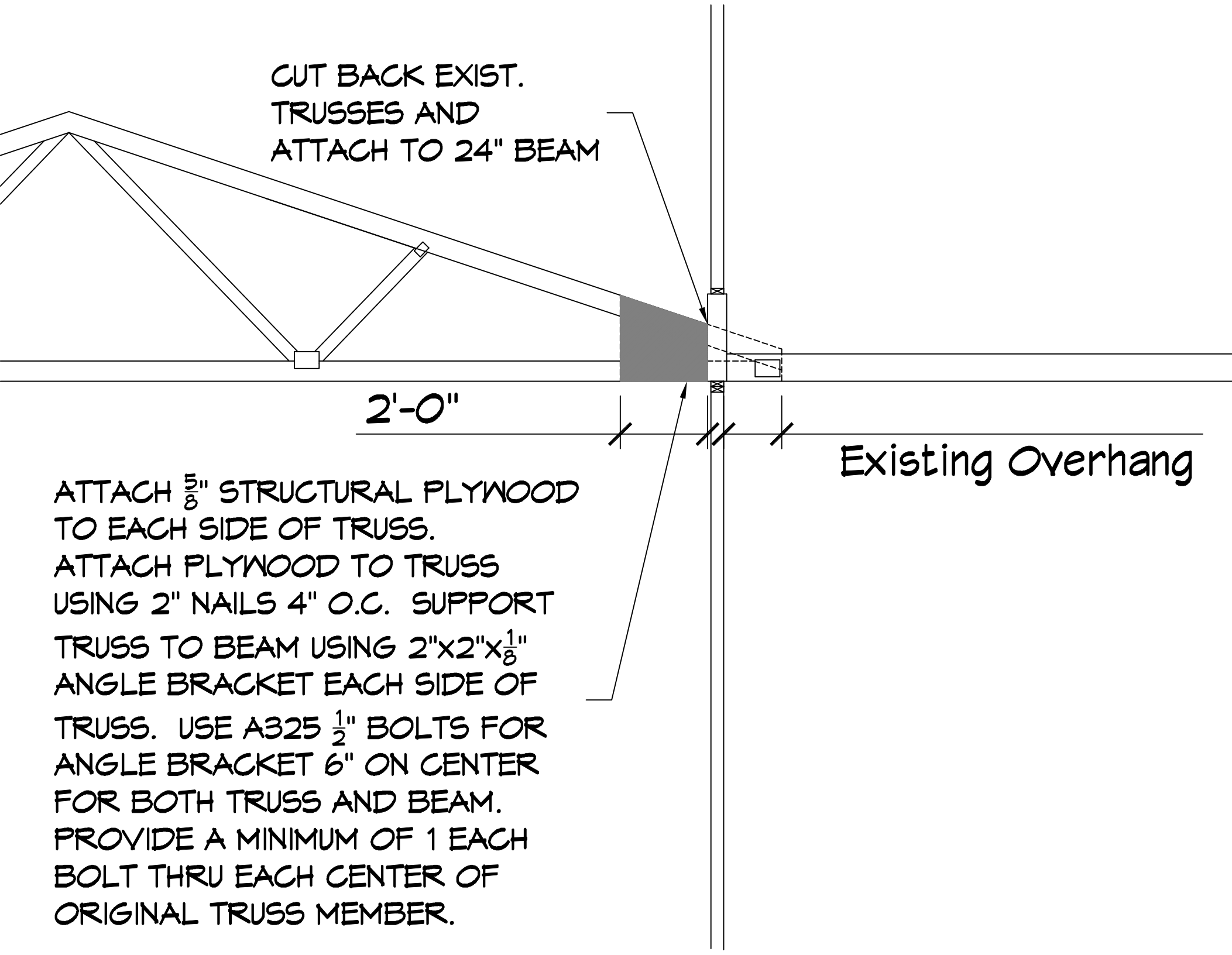

2'-0"

Existing Overhang

ATTACH $\frac{5}{8}$ " STRUCTURAL PLYWOOD
TO EACH SIDE OF TRUSS.
ATTACH PLYWOOD TO TRUSS
USING 2" NAILS 4" O.C. SUPPORT
TRUSS TO BEAM USING 2"x2"x $\frac{1}{8}$ "
ANGLE BRACKET EACH SIDE OF
TRUSS. USE A325 $\frac{1}{2}$ " BOLTS FOR
ANGLE BRACKET 6" ON CENTER
FOR BOTH TRUSS AND BEAM.
PROVIDE A MINIMUM OF 1 EACH
BOLT THRU EACH CENTER OF
ORIGINAL TRUSS MEMBER.